

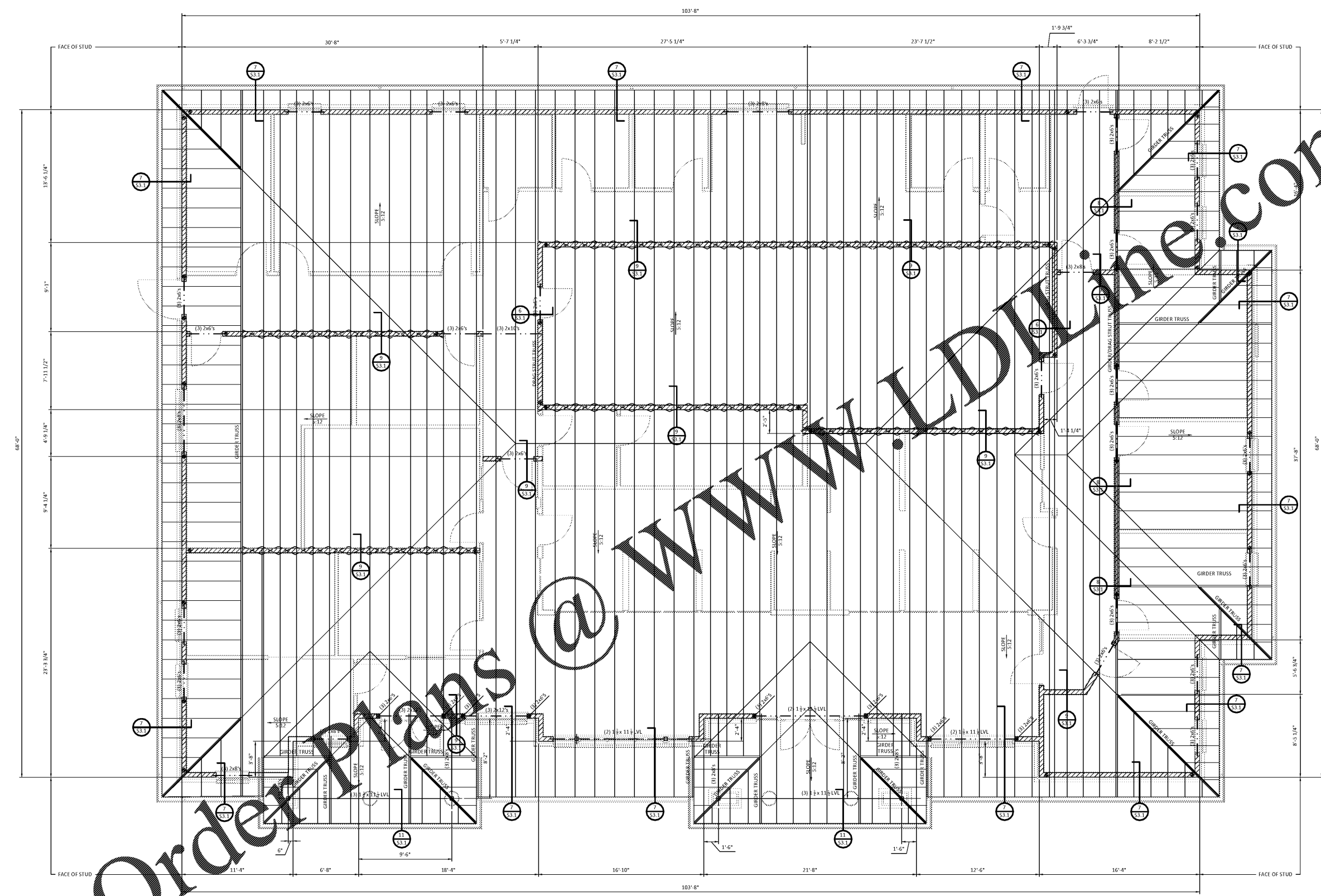

Copyright © 2019
Ellis Architects, Inc.
Ellis Architects, Inc. maintains all intellectual rights and ownership of all information contained on these documents. Ellis Architects, Inc. and its consultants shall be deemed the authors and owners of their respective instruments of service and shall retain all common law, statutory and other reserved rights, including copyrights. This document shall not be reproduced without the written authorization of Ellis Architects.
Do Not Scale from Drawings.
Contractor must verify all dimensions prior to construction.

JOB No.	18004
DOCUMENT	DATE
FINAL CDS	09/06/2019
DRAWN BY:	SJD
ROOF FRAMING PLAN	
S1.2	



Order Plans @ WWW.DVDLINE.COM

ROOF FRAMING PLAN

- NOTES: 1/4" = 1'-0"
- ROOF RAFTER BEARING (PLATE HEIGHT): 12'-4" A.F.F. VARIES UNLESS NOTED OTHERWISE.
 - ROOF FRAMING CONSTRUCTION: 2" PLYWOOD DECKING ON PREFABRICATED WOOD ROOF TRUSSES THAT ARE LOCATED AT 2'-0" O.C. MAXIMUM.
 - FOR ROOF DECK FASTENING INFORMATION, SEE GENERAL NOTES.
 - LOAD BEARING/SHEAR WALL (BELOW) - 2x6 STUDS AT 16" O.C. U.N.O. (REF. TYPICAL DETAILS ON S0.2 FOR NAILING SCHEDULE, NAILING LAYOUT, AND SHEAR WALL REQUIREMENTS).
 - NON-LOAD BEARING WALL - REFERENCE ARCHITECTURAL DRAWINGS.
 - REFERENCE TYPICAL DETAIL ON S0.2 FOR ATTACHMENT OF WOOD BEAM TO STEEL COLUMN.
 - APPROXIMATE LOCATION OF SIMPSON HOLDDOWNS. REFERENCE TYPICAL SHEAR WALL ELEVATION ON S0.2.
 - UNLESS NOTED OTHERWISE PROVIDE A MINIMUM OF 2 STUDS AT ALL HEADER AND GIRDER TRUSS BEARING LOCATIONS.
 - CONTINUOUS SHEAR WALL BRACING - REFERENCE TYPICAL DETAIL ON S0.2.