

ISSUANCES		
No.	Drawing Issue Description	Date
A	ISSUE FOR BID	11/04/19

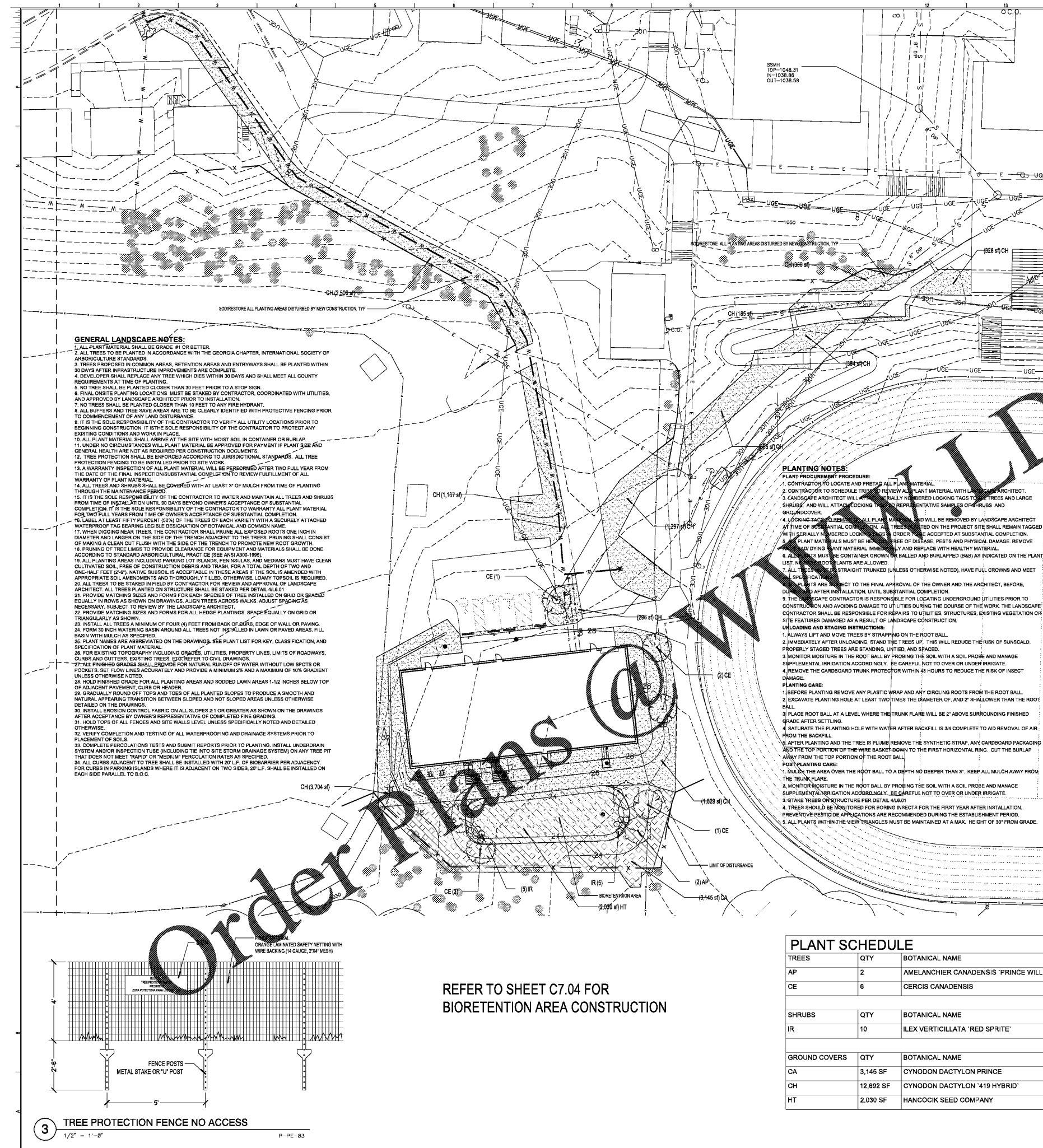

GENERAL LANDSCAPE NOTES:

1. ALL PLANT MATERIAL SHALL BE GRADE #1 OR BETTER.
2. ALL TREES TO BE PLANTED IN ACCORDANCE WITH THE GEORGIA CHAPTER, INTERNATIONAL SOCIETY OF ARBORICULTURE STANDARDS.
3. TREES PROPOSED IN COMMON AREAS, RETENTION AREAS AND ENTRYWAYS SHALL BE PLANTED WITHIN 30 DAYS AFTER INFRASTRUCTURE IMPROVEMENTS ARE COMPLETE.
4. DEVELOPER SHALL REPLACE ANY TREE WHICH DIES WITHIN 30 DAYS AND SHALL MEET ALL COUNTY REQUIREMENTS AT TIME OF REPLANTING.
5. NO TREE SHALL BE PLANTED CLOSER THAN 30 FEET PRIOR TO A STOP SIGN.
6. FINAL SITE PLANTING LOCATIONS MUST BE STAKED BY CONTRACTOR, COORDINATED WITH UTILITIES, AND APPROVED BY LANDSCAPE ARCHITECT PRIOR TO INSTALLATION.
7. NO TREES SHALL BE PLANTED CLOSER THAN 10 FEET TO ANY FIRE HYDRANT.
8. ALL BUFFERS AND TREE SAVES AREAS ARE TO BE CLEARLY IDENTIFIED WITH PROTECTIVE FENCING PRIOR TO COMMENCEMENT OF ANY LAND DISTURBANCE.
9. IT IS THE SOLE RESPONSIBILITY OF THE CONTRACTOR TO VERIFY ALL UTILITY LOCATIONS PRIOR TO BEGINNING CONSTRUCTION. IT IS THE SOLE RESPONSIBILITY OF THE CONTRACTOR TO PROTECT ANY EXISTING CONDITIONS AND WORK IN PLACE.
10. ALL PLANT MATERIAL SHALL ARRIVE AT THE SITE WITH MOIST SOIL IN CONTAINER OR BURLAP.
11. UNDER NO CIRCUMSTANCES WILL PLANT MATERIAL BE APPROVED FOR PAYMENT IF PLANT SIZE AND GENERAL HEALTH ARE NOT AS REQUIRED PER CONSTRUCTION DOCUMENTS.
12. TREE PROTECTION SHALL BE ENFORCED ACCORDING TO JURISDICTIONAL STANDARDS. ALL TREE PROTECTION FENCING TO BE INSTALLED PRIOR TO SITE WORK.
13. A WARRANTY INSPECTION OF ALL PLANT MATERIAL WILL BE PERFORMED AFTER TWO FULL YEARS FROM THE DATE OF THE FINAL INSPECTION/SUBSTANTIAL COMPLETION TO REVIEW FULFILLMENT OF ALL WARRANTY OF PLANT MATERIAL.
14. ALL TREES AND SHRUBS SHALL BE COVERED WITH AT LEAST 3" OF MULCH FROM TIME OF PLANTING THROUGH THE MAINTENANCE PERIOD.
15. IT IS THE SOLE RESPONSIBILITY OF THE CONTRACTOR TO WATER AND MAINTAIN ALL TREES AND SHRUBS FROM TIME OF INSTALLATION UNTIL 90 DAYS BEYOND OWNER'S ACCEPTANCE OF SUBSTANTIAL COMPLETION. IT IS THE SOLE RESPONSIBILITY OF THE CONTRACTOR TO WARRANTY ALL PLANT MATERIAL FOR THE FULL YEARS FROM TIME OF OWNER'S ACCEPTANCE OF SUBSTANTIAL COMPLETION.
16. LABEL AT LEAST FIFTY PERCENT (50%) OF THE TREES OF EACH VARIETY WITH A SECURELY ATTACHED WATERPROOF TAG BEARING LEGIBLE DESIGNATION OF BOTANICAL AND COMMON NAME.
17. WHEN DIGGING NEAR TREES, THE CONTRACTOR SHALL PRUNE ALL EXPOSED ROOTS ONE INCH IN DIAMETER AND LARGER ON THE SIDE OF THE TRENCH ADJACENT TO THE TREES. PRUNING SHALL CONSIST OF MAKING A CLEAN CUT FLUSH WITH THE SIDE OF THE TRENCH TO PROMOTE NEW ROOT GROWTH.
18. PRUNING OF TREE LIMBS TO PROVIDE CLEARANCE FOR EQUIPMENT AND MATERIALS SHALL BE DONE ACCORDING TO STANDARD ARBORICULTURAL PRACTICE (SEE ANSI A300-1995).
19. ALL PLANTING AREAS INCLUDING PARKING LOT ISLANDS, PENINSULAS, AND MEDIAN MUST HAVE CLEAN CULTIVATED SOIL, FREE OF CONSTRUCTION DEBRIS AND TRASH, FOR A TOTAL DEPTH OF TWO AND ONE-HALF FEET (2'-6"). NATIVE SUBSOIL IS ACCEPTABLE IN THESE AREAS IF THE SOIL IS AMENDED WITH APPROPRIATE SOIL AMENDMENTS AND THOROUGHLY TILLED. OTHERWISE, LOAMY TOPSOIL IS REQUIRED.
20. ALL TREES TO BE STAKED IN FIELD BY CONTRACTOR FOR REVIEW AND APPROVAL OF LANDSCAPE ARCHITECT. ALL TREES PLANTED ON STRUCTURE SHALL BE STAKED PER DETAIL 4LE.01.
21. PROVIDE MATCHING SIZES AND FORMS FOR EACH SPECIES OF TREE INSTALLED ON GRID OR SPACED EQUALLY IN ROWS AS SHOWN ON DRAWINGS. ALIGN TREES ACROSS WALKS. ADJUST SPACING AS NECESSARY. SUBJECT TO REVIEW BY THE LANDSCAPE ARCHITECT.
22. PROVIDE MATCHING SIZES AND FORMS FOR ALL HEDGE PLANTINGS. SPACE EQUALLY ON GRID OR TRIANGULARLY AS SHOWN.
23. INSTALL ALL TREES A MINIMUM OF FOUR (4) FEET FROM BACK OF CURB, EDGE OF WALL OR PAVING.
24. FORM 30 INCH WATERING BASIN AROUND ALL TREES NOT INSTALLED IN LAWN OR PAVED AREAS. FILL BASIN WITH MULCH AS SPECIFIED.
25. PLANT NAMES ARE ABBREVIATED ON THE DRAWINGS. SEE PLANT LIST FOR KEY, CLASSIFICATION, AND SPECIFICATION OF PLANT MATERIAL.
26. FOR EXISTING TOPOGRAPHY INCLUDING GRADES, UTILITIES, PROPERTY LINES, LIMITS OF ROADWAYS, CURBS AND GUTTERS, EXISTING TREES, ETC. REFER TO CIVIL DRAWINGS.
27. GRADUALLY ROUND OFF TOPS AND TOES OF ALL PLANTED SLOPES TO PRODUCE A SMOOTH AND NATURAL APPEARING TRANSITION BETWEEN SLOPED AND NOT SLOPED AREAS UNLESS OTHERWISE DETAILED ON THE DRAWINGS.
28. HOLD FINISHED GRADE FOR ALL PLANTING AREAS AND SODDED LAWN AREAS 1-1/2 INCHES BELOW TOP OF ADJACENT PAVEMENT, CURB OR HEADER.
29. GRADUALLY ROUND OFF TOPS AND TOES OF ALL PLANTED SLOPES TO PRODUCE A SMOOTH AND NATURAL APPEARING TRANSITION BETWEEN SLOPED AND NOT SLOPED AREAS UNLESS OTHERWISE DETAILED ON THE DRAWINGS.
30. INSTALL EROSION CONTROL FABRIC ON ALL SLOPES 2:1 OR GREATER AS SHOWN ON THE DRAWINGS AFTER ACCEPTANCE BY OWNER'S REPRESENTATIVE OF COMPLETED FINE GRADING.
31. HOLD TOPS OF ALL FENCES AND SITE WALLS LEVEL UNLESS SPECIFICALLY NOTED AND DETAILED OTHERWISE.
32. VERIFY COMPLETION AND TESTING OF ALL WATERPROOFING AND DRAINAGE SYSTEMS PRIOR TO PLACEMENT OF SOILS.
33. COMPLETE PERCOLATION TESTS AND SUBMIT REPORTS PRIOR TO PLANTING. INSTALL UNDERDRAIN SYSTEM AND/OR INSPECTION TUBE (INCLUDING TIE INTO SITE STORM DRAINAGE SYSTEM) ON ANY TREE PIT THAT DOES NOT MEET "TRAP" OR "MEDIAN" PERCOLATION TESTS AS SPECIFIED.
34. ALL CURBS ADJACENT TO TREE SHALL BE INSTALLED WITH 20" L.F. OF BIODEGRADABLE ADJACENCY FOR CURBS IN PARKING ISLANDS WHERE IT IS ADJACENT ON TWO SIDES. 20" L.F. SHALL BE INSTALLED ON EACH SIDE PARALLEL TO B.C.

PLANTING NOTES:

PLANT PROCUREMENT PROCEDURE:

1. CONTRACTOR TO LOCATE AND PREPARE ALL PLANT MATERIAL.
2. CONTRACTOR TO SCHEDULE TRIP TO REVIEW ALL PLANT MATERIAL WITH LANDSCAPE ARCHITECT.
3. LANDSCAPE ARCHITECT WILL AFFIX SERIALY NUMBERED LOOKING TAGS TO ALL TREES AND LARGE SHRUBS AND WILL ATTACH LOOKING TAGS TO REPRESENTATIVE SAMPLES OF GRASSES AND GROUNDCOVER.
4. LOOKING TAGS TO REMAIN ON ALL PLANT MATERIAL AND WILL BE REMOVED BY LANDSCAPE ARCHITECT AT TIME OF SUBSTANTIAL COMPLETION. ALL TREES STAGED ON THE PROJECT SITE SHALL REMAIN TAGGED WITH SERIALY NUMBERED LOOKING TAGS. TREES NOT ACCEPTED AT SUBSTANTIAL COMPLETION.
5. PLANT MATERIALS MUST BE HEALTHY, FREE OF DISEASE, PESTS AND PHYSICAL DAMAGE. REMOVE AND RE-DYING PLANT MATERIAL IMMEDIATELY AND REPLACE WITH HEALTHY MATERIAL.
6. ALL PLANTS MUST BE CONTAINER GROWN OR BALLED AND BURLAPPED (BAB) AS INDICATED ON THE PLANT LIST. ALL PLANTS TO BE PLANTED ARE ALLOWED.
7. ALL TREES MUST BE STRAIGHT TRUNKED (UNLESS OTHERWISE NOTED), HAVE FULL CROWNS AND MEET THE FOLLOWING SPECIFICATIONS:

PLANTING SPECIFICATIONS:

1. ALL TREES ARE SUBJECT TO THE FINAL APPROVAL OF THE OWNER AND THE ARCHITECT, BEFORE, DURING AND AFTER INSTALLATION, UNTIL SUBSTANTIAL COMPLETION.
2. THE LANDSCAPE CONTRACTOR IS RESPONSIBLE FOR LOCATING UNDERGROUND UTILITIES PRIOR TO CONSTRUCTION AND AVOIDING DAMAGE TO UTILITIES DURING THE COURSE OF THE WORK. THE LANDSCAPE CONTRACTOR SHALL BE RESPONSIBLE FOR REPAIRS TO UTILITIES, STRUCTURES, EXISTING VEGETATION OR SITE FEATURES DAMAGED AS A RESULT OF LANDSCAPE CONSTRUCTION.
3. UNLOADING AND STAGING INSTRUCTIONS:

1. ALWAYS LIFT AND MOVE TREES BY STRAPPING ON THE ROOT BALL.
2. IMMEDIATELY AFTER UNLOADING, STAND THE TREES UP. THIS WILL REDUCE THE RISK OF SUNSCALD. PROPERLY STAGED TREES ARE STANDING, UNTIED, AND SPACED.
3. MONITOR MOISTURE IN THE ROOT BALL BY PROBING THE SOIL WITH A SOIL PROBE AND MANAGE SUPPLEMENTAL IRRIGATION ACCORDINGLY. BE CAREFUL NOT TO OVER OR UNDER IRRIGATE.
4. REMOVE THE CARDBOARD TRUNK PROTECTOR WITHIN 48 HOURS TO REDUCE THE RISK OF INSECT DAMAGE.

PLANTING CARE:

1. BEFORE PLANTING REMOVE ANY PLASTIC WRAP AND ANY CIRCLING ROOTS FROM THE ROOT BALL.
2. EXCAVATE PLANTING HOLE AT LEAST TWO TIMES THE DIAMETER OF, AND 2" SHALLOWER THAN THE ROOT BALL.
3. PLACE ROOT BALL AT A LEVEL WHERE THE TRUNK FLARE WILL BE 2" ABOVE SURROUNDING FINISHED GRADE AFTER SETTLING.
4. SATURATE THE PLANTING HOLE WITH WATER AFTER BACKFILL IS 3/4 COMPLETE TO AID REMOVAL OF AIR FROM THE BACKFILL.
5. AFTER PLANTING AND THE TREE IS PLUMB, REMOVE THE SYNTHETIC STRAP, ANY CARDBOARD PACKAGING AND THE TOP PORTION OF THE WIRE BASKET DOWN TO THE FIRST HORIZONTAL RING. CUT THE BURLAP AWAY FROM THE TOP PORTION OF THE ROOT BALL.

POST-PLANTING CARE:

1. MULCH THE AREA OVER THE ROOT BALL TO A DEPTH NO DEEPER THAN 3". KEEP ALL MULCH AWAY FROM THE TRUNK FLARE.
2. MONITOR MOISTURE IN THE ROOT BALL BY PROBING THE SOIL WITH A SOIL PROBE AND MANAGE SUPPLEMENTAL IRRIGATION ACCORDINGLY. BE CAREFUL NOT TO OVER OR UNDER IRRIGATE.
3. STAKE TREES ON STRUCTURE PER DETAIL 4LE.01.
4. TREES SHOULD BE MONITORED FOR BORING INSECTS FOR THE FIRST YEAR AFTER INSTALLATION. PREVENTIVE PESTICIDE APPLICATIONS ARE RECOMMENDED DURING THE ESTABLISHMENT PERIOD.
5. ALL PLANTS WITHIN THE VIEW TRIANGLES MUST BE MAINTAINED AT A MAX. HEIGHT OF 30" FROM GRADE.

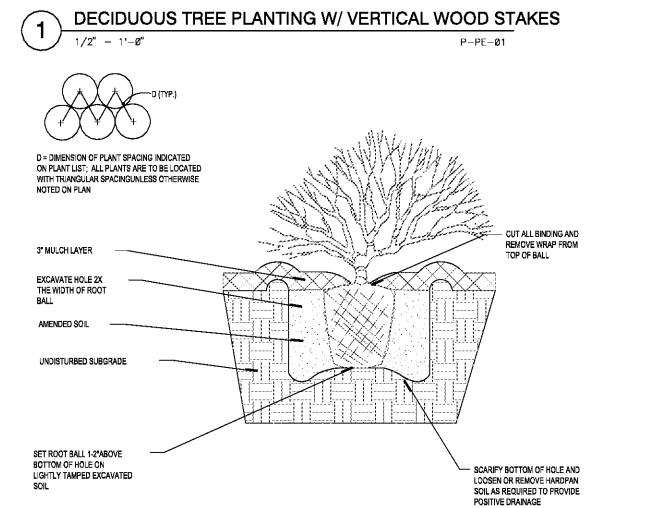
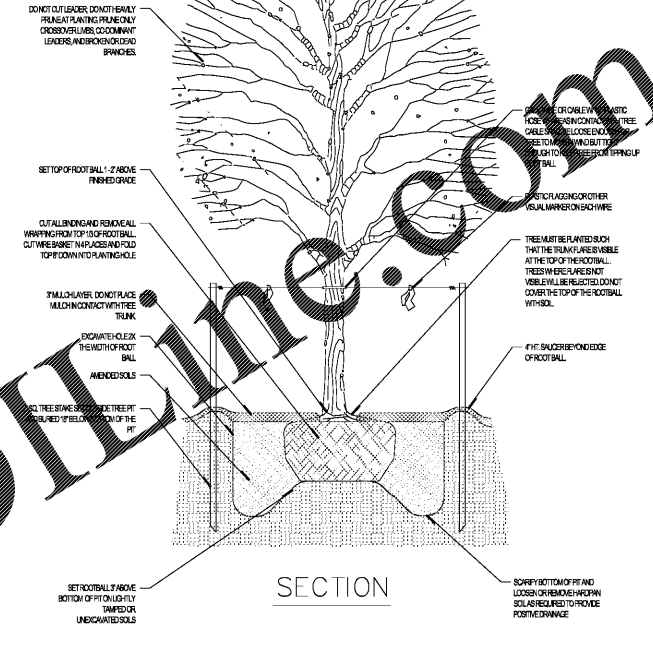

REFER TO SHEET C7.04 FOR
BIORETENTION AREA CONSTRUCTION

PLANT SCHEDULE

TREES	QTY	BOTANICAL NAME	COMMON NAME	CONT	SIZE	SPACING	REMARKS
AP	2	AMELANCHIER CANADENSIS 'PRINCE WILLIAM'	PRINCE WILLIAM SERVICEBERRY	B & B	3" CAL, 8-10' HT	AS SHOWN	UPRIGHT, MULTI-STEM
CE	6	CERCIS CANADENSIS	EASTERN REDBUD MULTI-TRUNK	B & B	3" CAL, 14-16' HT	AS SHOWN	
SHRUBS	QTY	BOTANICAL NAME	COMMON NAME	CONT	SIZE	SPACING	REMARKS
IR	10	ILEX VERTICILLATA 'RED SPRITE'	RED SPRITE WINTERBERRY	5 GAL			
GROUND COVERS	QTY	BOTANICAL NAME	COMMON NAME	CONT	SIZE	SPACING	REMARKS
CA	3,145 SF	CYNODON DACTYLON PRINCE	BERMUDA PRINCESS 77	SEED			
CH	12,892 SF	CYNODON DACTYLON '419 HYBRID'	BERMUDA GRASS	SOD			
HT	2,030 SF	HANCOCK SEED COMPANY	WET MEADOW SEED MIX	SEED			

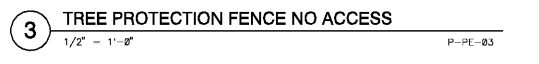

ROBERT JUST
Principal/Designer
11/04/19
Date

ZHEN FENG
Staff Architect

20190224.01
Project Manager
Project Architect
Staff Architect