

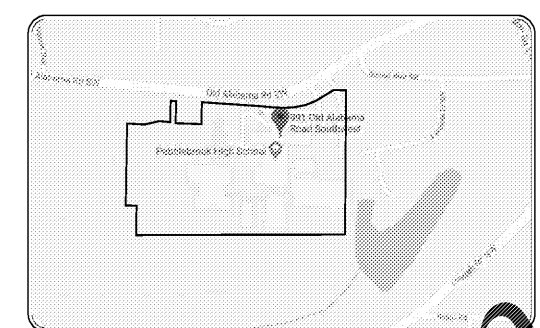

TEL 770.452.7849 FAX 770.452.0086  
2951 FLOWERS RD S, SUITE 119  
ATLANTA, GEORGIA 30341  
WWW.EBERLY.NET



ISSUANCES		
No.	Drawing Issue Description	Date
A	ISSUE PRELIMINARY SUBMITTAL	2/16/2019
B	ISSUED FOR BID	2/19/2019



LOCATION MAP  
N.T.S.

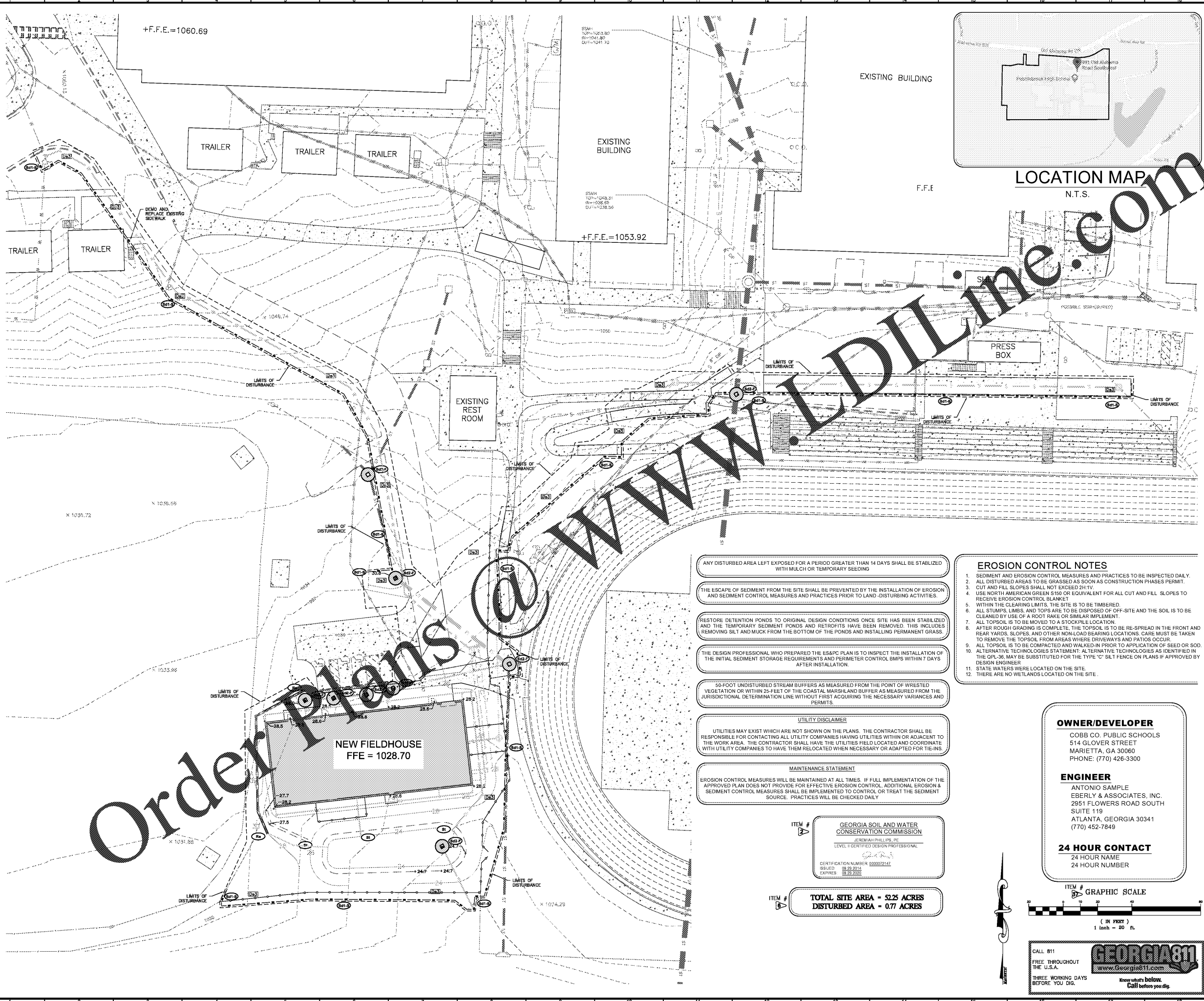

- ANY DISTURBED AREA LEFT EXPOSED FOR A PERIOD GREATER THAN 14 DAYS SHALL BE STABILIZED WITH MULCH OR TEMPORARY SEEDING
- THE ESCAPE OF SEDIMENT FROM THE SITE SHALL BE PREVENTED BY THE INSTALLATION OF EROSION AND SEDIMENT CONTROL MEASURES AND PRACTICES PRIOR TO LAND-DISTURBING ACTIVITIES.
- RESTORE DETENTION PONDS TO ORIGINAL DESIGN CONDITIONS ONCE SITE HAS BEEN STABILIZED AND THE TEMPORARY SEDIMENT PONDS AND RETROFITS HAVE BEEN REMOVED. THIS INCLUDES REMOVING SILT AND MUCK FROM THE BOTTOM OF THE PONDS AND INSTALLING PERMANENT GRASS.
- THE DESIGN PROFESSIONAL WHO PREPARED THE ES&PC PLAN IS TO INSPECT THE INSTALLATION OF THE INITIAL SEDIMENT STORAGE REQUIREMENTS AND PERIMETER CONTROL BMPs WITHIN 7 DAYS AFTER INSTALLATION.
- 50-FOOT UNDISTURBED STREAM BUFFERS AS MEASURED FROM THE POINT OF WRESTED VEGETATION OR WITHIN 25-FEET OF THE COASTAL MARSHLAND BUFFER AS MEASURED FROM THE JURISDICTIONAL DETERMINATION LINE WITHOUT FIRST ACQUIRING THE NECESSARY VARIANCES AND PERMITS.

- EROSION CONTROL NOTES**
- SEDIMENT AND EROSION CONTROL MEASURES AND PRACTICES TO BE INSPECTED DAILY.
  - ALL DISTURBED AREAS TO BE GRASSED AS SOON AS CONSTRUCTION PHASES PERMIT.
  - CUT AND FILL SLOPES SHALL NOT EXCEED 2H:1V.
  - USE NORTH AMERICAN GREEN S150 OR EQUIVALENT FOR ALL CUT AND FILL SLOPES TO RECEIVE EROSION CONTROL BLANKET
  - WITHIN THE CLEARING LIMITS, THE SITE IS TO BE TIMBERED.
  - ALL STUMPS, LIMBS, AND TOPS ARE TO BE DISPOSED OF OFF-SITE AND THE SOIL IS TO BE CLEANED BY USE OF A ROOT RAKE OR SIMILAR IMPLEMENT.
  - ALL TOPSOIL IS TO BE MOVED TO A STOCKPILE LOCATION.
  - AFTER ROUGH GRADING IS COMPLETE, THE TOPSOIL IS TO BE RE-SPREAD IN THE FRONT AND REAR YARDS, SLOPES, AND OTHER NON-LOAD BEARING LOCATIONS. CARE MUST BE TAKEN TO REMOVE THE TOPSOIL FROM AREAS WHERE DRIVEWAYS AND PATIOS OCCUR.
  - ALL TOPSOIL IS TO BE COMPACTED AND WALKED-IN PRIOR TO APPLICATION OF SEED OR SOD.
  - ALTERNATIVE TECHNOLOGIES STATEMENT: ALTERNATIVE TECHNOLOGIES AS IDENTIFIED IN THE OPL-35, MAY BE SUBSTITUTED FOR THE TYPE "C" Silt FENCE ON PLANS IF APPROVED BY DESIGN ENGINEER.
  - STATE WATERS WERE LOCATED ON THE SITE.
  - THERE ARE NO WETLANDS LOCATED ON THE SITE.

**UTILITY DISCLAIMER**  
UTILITIES MAY EXIST WHICH ARE NOT SHOWN ON THE PLANS. THE CONTRACTOR SHALL BE RESPONSIBLE FOR CONTACTING ALL UTILITY COMPANIES HAVING UTILITIES WITHIN OR ADJACENT TO THE WORK AREA. THE CONTRACTOR SHALL HAVE THE UTILITIES FIELD LOCATED AND COORDINATE WITH UTILITY COMPANIES TO HAVE THEM RELOCATED WHEN NECESSARY OR ADAPTED FOR TIE-INS.

**MAINTENANCE STATEMENT**  
EROSION CONTROL MEASURES WILL BE MAINTAINED AT ALL TIMES. IF FULL IMPLEMENTATION OF THE APPROVED PLAN DOES NOT PROVIDE FOR EFFECTIVE EROSION CONTROL, ADDITIONAL EROSION & SEDIMENT CONTROL MEASURES SHALL BE IMPLEMENTED TO CONTROL OR TREAT THE SEDIMENT SOURCE. PRACTICES WILL BE CHECKED DAILY.

ITEM #

**GEORGIA SOIL AND WATER CONSERVATION COMMISSION**  
JEREMIAH PHILLIPS, PE  
LEVEL II CERTIFIED DESIGN PROFESSIONAL  
ISSUED: 09/25/2014  
EXPIRES: 09/25/2020

ITEM # **TOTAL SITE AREA = 52.25 ACRES  
DISTURBED AREA = 0.77 ACRES**

**OWNER/DEVELOPER**  
COBB CO. PUBLIC SCHOOLS  
514 GLOVER STREET  
MARIETTA, GA 30060  
PHONE: (770) 426-3300

**ENGINEER**  
ANTONIO SAMPLE  
EBERLY & ASSOCIATES, INC.  
2951 FLOWERS ROAD SOUTH  
SUITE 119  
ATLANTA, GEORGIA 30341  
(770) 452-7849

**24 HOUR CONTACT**  
24 HOUR NAME  
24 HOUR NUMBER

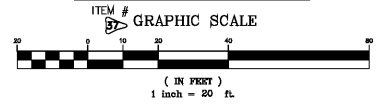

CALL 811  
FREE THROUGHOUT THE U.S.A.  
THREE WORKING DAYS BEFORE YOU DIG.

**GEORGIA811**  
www.Georgia811.com  
Know what's below. Call before you dig.

**PEBBLEBROOK HS B007 - FIELDHOUSE**  
DOE Facility Code 4086  
FTE = 2787  
IU = 143  
991 OLD ALABAMA ROAD  
MABLETON, GA 30126  
COBB COUNTY SCHOOL DISTRICT

**FINAL ES & PC PLAN**

JEREMIAH PHILLIPS	19-110.10
ANTONIO SAMPLE	10/25/2019
DYLAN LEE	
ROBERT NIEBESKI	

**EC2.02**

PROJECT NUMBER: 20190224.01 PROJECT NAME: PEBBLEBROOK HS B007 -  
FIELDHOUSE G0.00 - COVER  
DATE: 02/19/2019 7:48:55 AM  
FILE: 20190224.01\_Pebblebrook B007\_Fieldhouse\_2019\_central\_detached.rvt