

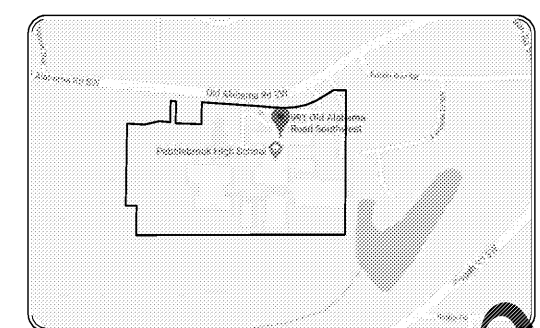

TEL 770.452.7849 FAX 770.452.0086
2951 FLOWERS RD S, SUITE 119
ATLANTA, GEORGIA 30341
WWW.EBERLY.NET



ISSUANCES		
No.	Drawing Issue Description	Date
A	ISSUE PRELIMINARY SUBMITTAL	2/18/21
B	ISSUED FOR BID	2/19/21



LOCATION MAP
N.T.S.

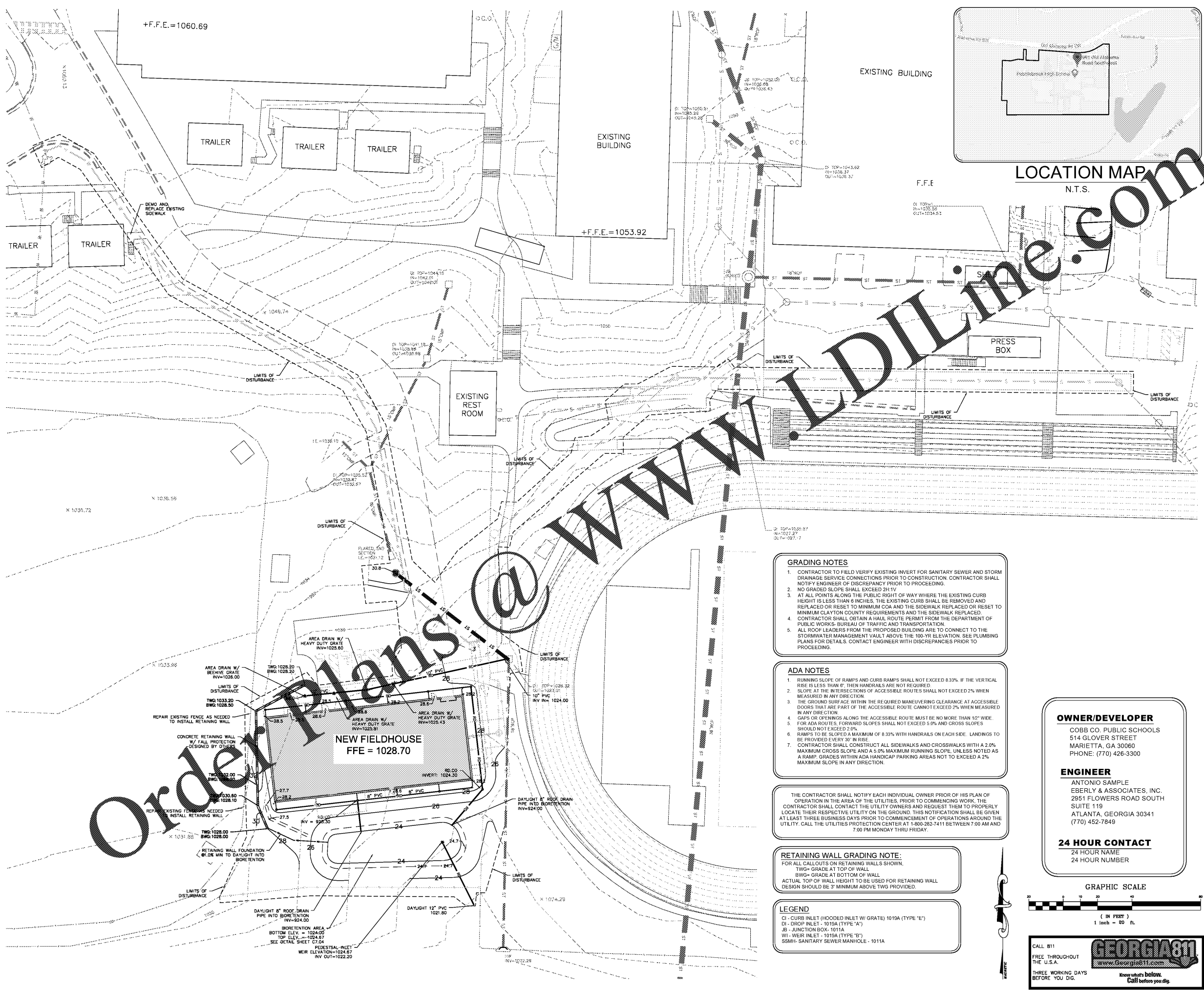

GRADING NOTES

- CONTRACTOR TO FIELD VERIFY EXISTING INVERT FOR SANITARY SEWER AND STORM DRAINAGE SERVICE CONNECTIONS PRIOR TO CONSTRUCTION. CONTRACTOR SHALL NOTIFY ENGINEER OF DISCREPANCY PRIOR TO PROCEEDING.
- NO GRADED SLOPE SHALL EXCEED 2H:1V
- AT ALL POINTS ALONG THE PUBLIC RIGHT OF WAY WHERE THE EXISTING CURB HEIGHT IS LESS THAN 6 INCHES, THE EXISTING CURB SHALL BE REMOVED AND REPLACED OR RESET TO MINIMUM COA AND THE SIDEWALK REPLACED OR RESET TO MINIMUM CLAYTON COUNTY REQUIREMENTS AND THE SIDEWALK REPLACED.
- CONTRACTOR SHALL OBTAIN A HAUL ROUTE PERMIT FROM THE DEPARTMENT OF PUBLIC WORKS, BUREAU OF TRAFFIC AND TRANSPORTATION.
- ALL ROOF LEADERS FROM THE PROPOSED BUILDING ARE TO CONNECT TO THE STORMWATER MANAGEMENT VAULT ABOVE THE 100-YR ELEVATION. SEE PLUMBING PLANS FOR DETAILS. CONTACT ENGINEER WITH DISCREPANCIES PRIOR TO PROCEEDING.

ADA NOTES

- RUNNING SLOPE OF RAMPS AND CURB RAMPS SHALL NOT EXCEED 8.33% IF THE VERTICAL RISE IS LESS THAN 6" THEN HANDRAILS ARE NOT REQUIRED.
- SLOPE AT THE INTERSECTIONS OF ACCESSIBLE ROUTES SHALL NOT EXCEED 2% WHEN MEASURED IN ANY DIRECTION.
- THE GROUND SURFACE WITHIN THE REQUIRED MANEUVERING CLEARANCE AT ACCESSIBLE DOORS THAT ARE PART OF THE ACCESSIBLE ROUTE CANNOT EXCEED 2% IN ANY DIRECTION.
- GAPS OR OPENINGS ALONG THE ACCESSIBLE ROUTE MUST BE NO MORE THAN 1/2" WIDE.
- FOR ADA ROUTES, FORWARD SLOPES SHALL NOT EXCEED 5.0% AND CROSS SLOPES SHOULD NOT EXCEED 2.0%.
- RAMPS TO BE SLOPED A MAXIMUM OF 8.33% WITH HANDRAILS ON EACH SIDE. LANDINGS TO BE PROVIDED EVERY 30' IN RISE.
- CONTRACTOR SHALL CONSTRUCT ALL SIDEWALKS AND CROSSWALKS WITH A 2.0% MAXIMUM CROSS SLOPE AND A 5.0% MAXIMUM RUNNING SLOPE, UNLESS NOTED AS A RAMP. GRADES WITHIN ADA HANDICAP PARKING AREAS NOT TO EXCEED A 2% MAXIMUM SLOPE IN ANY DIRECTION.

THE CONTRACTOR SHALL NOTIFY EACH INDIVIDUAL OWNER PRIOR OF HIS PLAN OF OPERATION IN THE AREA OF THE UTILITIES. PRIOR TO COMMENCING WORK, THE CONTRACTOR SHALL CONTACT THE UTILITY OWNERS AND REQUEST THEM TO PROPERLY LOCATE THEIR RESPECTIVE UTILITY ON THE GROUND. THIS NOTIFICATION SHALL BE GIVEN AT LEAST THREE BUSINESS DAYS PRIOR TO COMMENCEMENT OF OPERATIONS AROUND THE UTILITY. CALL THE UTILITIES PROTECTION CENTER AT 1-800-282-7411 BETWEEN 7:00 AM AND 7:00 PM MONDAY THRU FRIDAY.

RETAINING WALL GRADING NOTE:
FOR ALL CALL OUTS ON RETAINING WALLS SHOWN,
TWG+ GRADE AT TOP OF WALL
BWG+ GRADE AT BOTTOM OF WALL
ACTUAL TOP OF WALL HEIGHT TO BE USED FOR RETAINING WALL DESIGN SHOULD BE 3" MINIMUM ABOVE TWG PROVIDED.

LEGEND

- CI - CURB INLET (HOODED INLET W/ GRATE) 1019A (TYPE 'E')
- DI - DROP INLET - 1019A (TYPE 'A')
- JB - JUNCTION BOX - 1011A
- WI - WEIR INLET - 1019A (TYPE 'B')
- SSMH - SANITARY SEWER MANHOLE - 1011A

OWNER/DEVELOPER
COBB CO. PUBLIC SCHOOLS
514 GLOVER STREET
MARIETTA, GA 30060
PHONE: (770) 426-3300

ENGINEER
ANTONIO SAMPLE
EBERLY & ASSOCIATES, INC.
2951 FLOWERS ROAD SOUTH
SUITE 119
ATLANTA, GEORGIA 30341
(770) 452-7849

24 HOUR CONTACT
24 HOUR NAME
24 HOUR NUMBER

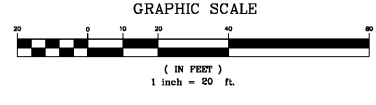

CALL 811
FREE THROUGHOUT THE U.S.A.
THREE WORKING DAYS BEFORE YOU DIG.

Know what's below.
Call before you dig.

PEBBLEBROOK HS B007 - FIELDHOUSE
DOE Facility Code 4066
FTE = 2787
IU = 143
991 OLD ALABAMA ROAD
MABLETON, GA 30126
COBB COUNTY SCHOOL DISTRICT

SITE GRADING & DRAINAGE PLAN

JEREMIAH PHILLIPS	19-110.10
ANTONIO SAMPLE	10/25/2019
DYLAN LEE	
ROBERT NIEBESKI	

C4.00

ISSUED FOR CONSTRUCTION

PROJECT NUMBER: 20190224.01 PROJECT NAME: PEBBLEBROOK HS B007 - FIELDHOUSE
DRAWING NUMBER: G0.00 - COVER
DATE: 02/18/21
10/7/2019 7:48:55 AM