

ENLARGED ELECTRICAL ROOM A119
1/4" = 1'-0"

- KEYNOTES**
- ◇ PROVIDE CIRCUITING TO RECEPTACLES SIMILAR TO CLASSROOM 2115, ADJUST FOR ROOM ORIENTATION.
 - ◇ CONNECT TO EXISTING CIRCUIT SERVING AREA.
 - ◇ 3/4"C. (2) #12 AWG + #12 GROUND TO SPARE 20A 1P CIRCUIT BREAKER IN PANEL INDICATED BY HOMERUN
 - ◇ 3/4"C. (4) #12 AWG + #12 GROUND TO 2 SPARE 20A 1P CIRCUIT BREAKERS IN PANEL INDICATED BY HOMERUN
 - ◇ POWER FOR LIFT TABLE. COORDINATE LOCATION WITH ARCHITECT.
 - ◇ FIELD VERIFY LOCATION OF RECEPTACLES WITH ARCHITECT.
 - ◇ POWER FOR TRACK SYSTEM. COORDINATE FINAL LOCATION IN THE FIELD WITH LIFT INSTALLER.

FIRST LEVEL FLOOR PLAN - CLASSROOM ADDITION - ELECTRICAL
1/8" = 1'-0"

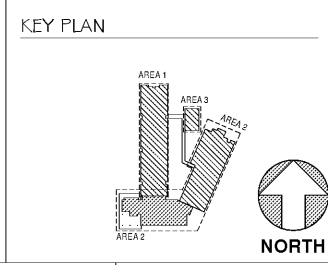

GMC

1219 Wayne Street
Columbia, SC 29201
T 803.766.1235
GMCNETWORK.COM

SOUTH CAROLINA
REGISTERED PROFESSIONAL ENGINEER
BUFORD GOFF & ASSOCIATES, INC.
No. 000022
DATE OF AUTHORIZATION

SOUTH CAROLINA
REGISTERED PROFESSIONAL ENGINEER
Brian Curtiss Nelson
10/24/2019
BRIAN CURTISS NELSON

ISSUE	DATE
BID DOCUMENTS	10.24.19

DRAWN BY: MTFH
 CHECKED BY: BCM

MILLBROOK ELEMENTARY SCHOOL - ADDITIONS AND RENOVATIONS
 255 E PINE LOG RD., AIKEN, SC 29803
 GMC # ACOL180004

FIRST LEVEL FLOOR PLAN - CLASSROOM ADDITION - ELECTRICAL
E2.11

10/28/2019 2:57:31 PM