

10/28/2019 5:05:54 PM

K
J
H
G
F
E
D
C
B
A

DEMOLITION - FIRST FLOOR PLAN - ELECTRICAL
1/16" = 1'-0"

Order Plans @

WWW.LDILine.com

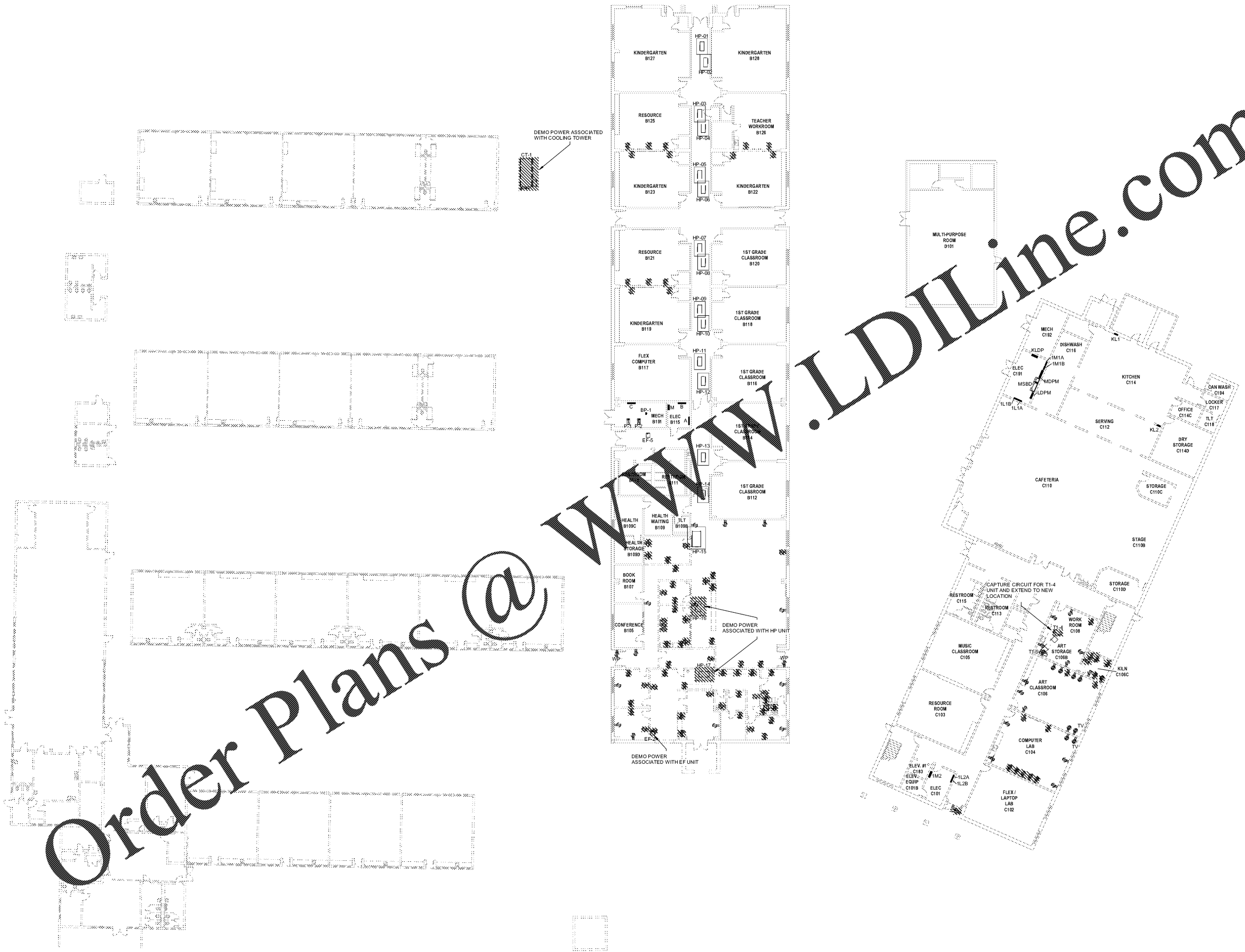

FIRST LEVEL FLOOR PLAN - ELECTRICAL DEMOLITION

ED2.01

MILLBROOK ELEMENTARY SCHOOL - ADDITIONS AND RENOVATIONS
255 E PINE LOG RD,
AIKEN, SC 29803
GMC # ACOL180004

ISSUE	DATE
BID DOCUMENTS	10.24.19

Burford & Goff
Associates, Inc.
Engineers & Planners
1433 Boulevard Ave.
Columbia, SC 29204
Phone: 803.786.1235

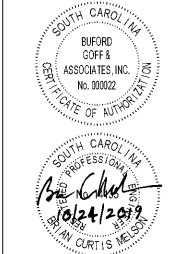

GMC

1219 Wayne Street
Columbia, SC 29201
T 803.786.1235
GMCNETWORK.COM



K
J
H
G
F
E
D
C
B
A