

10/28/2019 3:05:52 PM

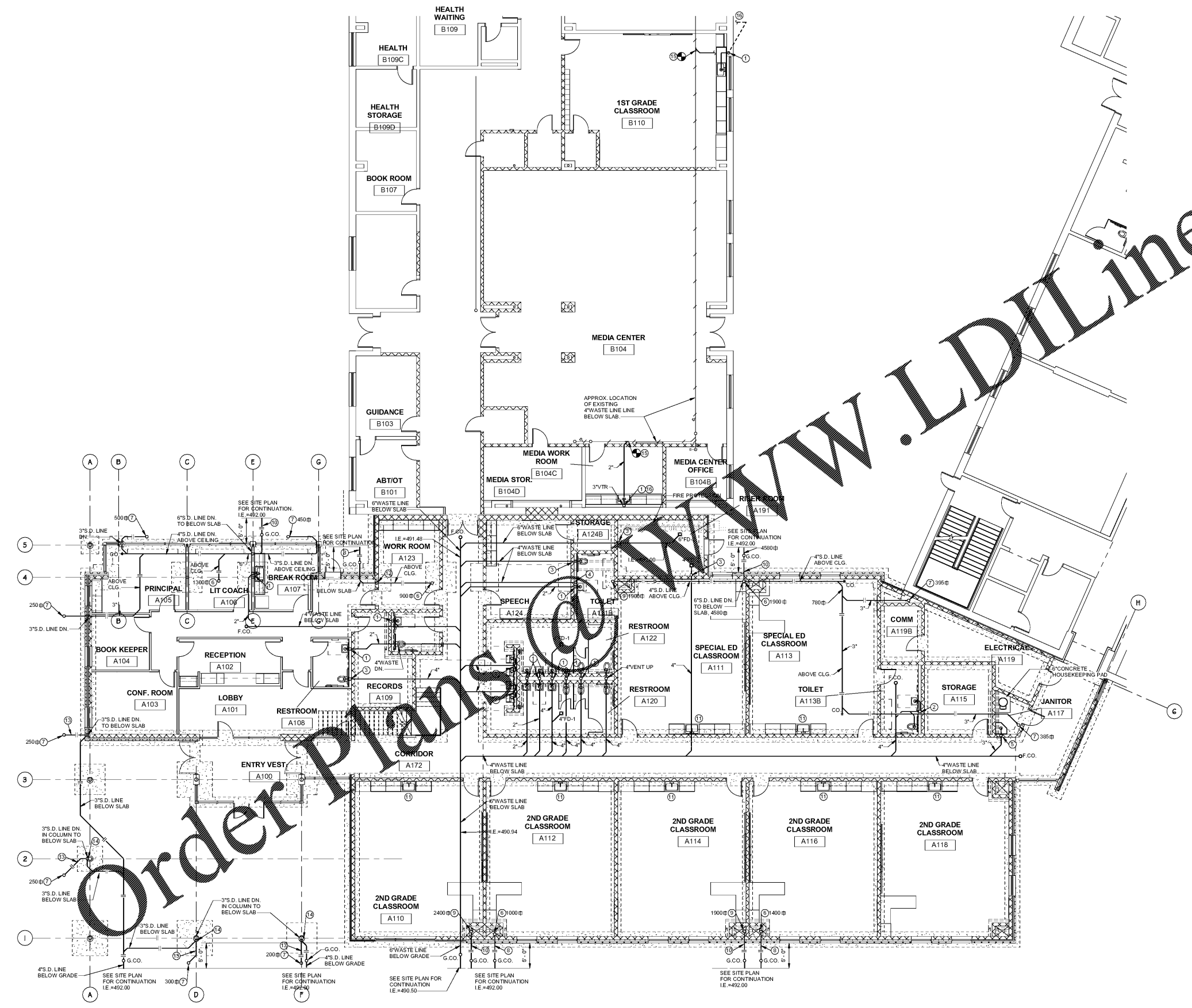

**1 FIRST FLOOR PLAN - PLUMBING WASTE & VENT (F.F.=493.8)**  
 SCALE: 1/8" = 1'-0"

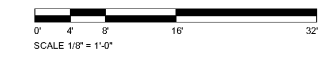

KEY PLAN

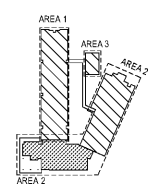

NOTES

- ① 2" WASTE LINE DN. & 2" VENT LINE UP.
- ② 3" WASTE LINE DN. & 3" VENT LINE UP.
- ③ 3" VENT LINE UP.
- ④ 4" WASTE LINE FROM ABOVE & DN. TO BELOW SLAB.
- ⑤ 3" COMBINATION WASTE/VENT RISER UP & DN.
- ⑥ 4" S.D. LINE FROM ABOVE.
- ⑦ 3" S.D. LINE FROM ABOVE.
- ⑧ 4" S.D. LINE BELOW GRADE.
- ⑨ 6" S.D. LINE FROM ABOVE.
- ⑩ 6" S.D. LINE BELOW GRADE.
- ⑪ FIXTURE AND PIPING ARE PART OF ALTERNATE. REFER TO ALTERNATE DRAWINGS.
- ⑫ 4" S.D. LINE DN. TO BELOW SLAB.
- ⑬ PIPING OVERHEAD.
- ⑭ REFER TO ARCHITECTURAL DRAWINGS FOR FINISH ROUTING.
- ⑮ TIE-IN NEW 2" WASTE LINE TO EXISTING WASTE LINE BELOW SLAB.
- ⑯ TIE-IN NEW 2" VENT LINE TO EXISTING VENT MAIN APPROX. 28' FROM THIS VENT CONNECTION.

GENERAL NOTES

- ① PROVIDE TRAP SEAL PROTECTION DEVICE IN ALL FLOOR DRAINS.
- ② FOR PIS REFER TO SHEET P1.1
- ③ FOR VENT PIPING REFER TO SHEET P2.0

MILLBROOK ELEMENTARY SCHOOL - ADDITIONS AND RENOVATIONS  
 255 E PINE LOG RD, AIKEN, SC 29803  
 GMC # ACOL180004

FIRST FLOOR PLAN - PLUMBING WASTE & VENT

**P1.1A**

ISSUE DATE	DATE	BY	REVISION
BID DOCUMENTS	10.24.19		

DRAWN BY: BSM  
 CHECKED BY: IMWW

**Buford & Goff**  
 Engineers & Planners  
 4125 Blenheim Ave.  
 Suite 200  
 Columbia, SC 29204  
 Phone 803.724.5532

**SOUTH CAROLINA PROFESSIONAL ENGINEER**  
 No. 10556  
 DAN E. REIDER

**SOUTH CAROLINA PROFESSIONAL PLUMBER**  
 No. 000022  
 BUFORD GOFF & ASSOCIATES, INC.



1219 Wayne  
 Columbia, SC  
 GMCNETWORK.CO