

1 FIRST FLOOR PLAN - PLUMBING SUPPLY
SCALE: 1/8" = 1'-0"

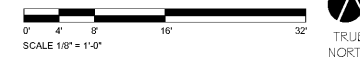

KEY PLAN

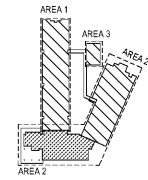

- NOTES**
- 1 3/4" W. LINE BELOW GRADE.
 - 2 3" MAIN SHUT-OFF VALVE LOCATED IN VALVE BOX BELOW GRADE.
 - 3 3/4" W. LINE UP.
 - 4 3" DOUBLE CHECK VALVE BACKFLOW PREVENTER.
 - 5 1/2" W. & 1/2" H. DN.
 - 6 2" W. DN.
 - 7 FUTURE AND PIPING IS PART OF ALTERNATE. REFER TO ALTERNATE DRAWINGS.
 - 8 1" W. DN.
 - 9 FOR PIPING TO WATER HEATER REFER TO WATER HEATER PIPING DETAIL ON SHEET P003.
 - 10 RUN 3/4" W. R. LINE TO WATER HEATER. REFER TO WATER HEATER PIPING DETAIL ON SHEET P003.
 - 11 1 1/4" W. DN. TO WATER HEATER. REFER TO WATER HEATER PIPING DETAIL ON SHEET P003.
 - 12 TE-IN NEW 1/2" W. LINE TO EXISTING C.W. MAIN ABOVE CLG.
 - 13 1/2" W. LINE DN. TO WH AND IN 1/2" W. LINE FROM WH TO R. LINE ABOVE CEILING.
 - 14 WOOD CEILING. NOT TO PIPING ABOVE THIS AREA.
 - 15 INST. THIS SPEC. WATER HEATER MOUNTED ON WALL ABOVE CEILING SHALL BE EEMAX MODEL EX100T, 10KW, 208V SINGLE PHASE.
 - 16 IN NEW 3/4" W. LINE TO EXISTING C.W. MAIN.
 - 17 ELECTRIC WATER HEATER SHALL BE A.O. SMITH MODEL EM72.5 WITH PLUB-IN CONNECTION. WATER HEATER LOCATED IN CABINET. SECURE WATER HEATER IN BACK OF CABINET. RUN WATER HEATER DRAIN LINE THRU EXTERIOR WALL & SPILL ON GRADE. PROVIDE BUG SCREEN @ END OF PIPE.

GENERAL NOTES

- 1 COLD AND HOT WATER LINES SHOWN IN THE AREA OF A FIXTURE AND/OR TOILET GROUP SHALL BE RUN FULL SIZE OF HEADER INDICATED IN WALL AND/OR CHASE. PROVIDE CONNECTION TO FIXTURES, HOSE BIBB AND TRAP PRIMERS AS PLUMBING CONNECTION SCHEDULES AND DETAILS INDICATE.
- 2 ALL SHUT-OFF VALVE UP TO 2 1/2" SHALL BE BALL VALVES.
- 3 ALL VALVES SHALL BE LOCATED A MAX. 10'-0" A.F.F. OR 2'-0" ABOVE CLG. UNLESS APPROVED BY OWNER.
- 4 ALL VALVES, TRAP PRIMERS AND SHOCK ABSORBERS ARE TO BE INSTALLED SO THEY ARE ACCESSIBLE.
- 5 PROVIDE AN ASSE-1070 APPROVED MIXING VALVE FOR ALL HAND WASHING STATIONS P-35.

GMC

1219 Wayne
Columbia, SC
T
GMCNETWORK.CO

SOUTH CAROLINA
Buford Goff & Associates, Inc.
No. 000022
STATE OF SOUTH CAROLINA
REGISTERED PROFESSIONAL ENGINEER
No. 10556
181.247.05
DAN E. REIDER

SOUTH CAROLINA
Buford Goff & Associates, Inc.
Engineers & Planners
1433 Blountwood Ave.
Columbia, SC 29204
Phone: 803.724.4332

ISSUE	DATE	DESCRIPTION
BID DOCUMENTS	10.24.19	

DRAWN BY: **ESM**
CHECKED BY: **IMWW**

MILLBROOK ELEMENTARY SCHOOL - ADDITIONS AND RENOVATIONS
255 E PINE LOG RD, AIKEN, SC 29803
GMC # ACOL180004

P1.1

FIRST FLOOR PLAN - PLUMBING SUPPLY

10/28/2019 3:05:29 PM