

GENERAL NOTES

- A GENERAL CONTRACTOR TO FIELD VERIFY ALL EXISTING CONDITIONS. BRING ALL DISCREPANCIES TO THE ARCHITECT'S ATTENTION PRIOR TO PROCEEDING WITH THE WORK.
- B REFER TO ELECTRICAL, MECHANICAL, AND FIRE PROTECTION DRAWINGS FOR LOCATIONS AND QUANTITIES OF LIGHTS, SUPPLY AND RETURN AIR GRILLS, FIRE SPRINKLERS, AND OTHER DEVICES. DEVICES ARE SHOWN ON ARCHITECTURAL DRAWINGS FOR COORDINATION AND REFERENCE ONLY.
- C REFER TO ELECTRICAL AND MECHANICAL DRAWINGS FOR DEMOLITION OF EXISTING DEVICES AND FIXTURES.
- D ALL EXISTING LIGHT FIXTURES, MECHANICAL GRILLS, AND ALL OTHER DEVICES ARE TO REMAIN, UNLESS OTHERWISE NOTED. PROVIDE TEMPORARY SUPPORT FOR SUCH ITEMS AS REQUIRED.
- E THE CEILING LAYOUT AND CONFIGURATION OF DEVICES SHOWN IN THIS RCP IS FOR REFERENCE ONLY AND MUST BE FIELD VERIFIED. ALL DEVICES SHOULD BE LOCATED IN THEIR EXISTING LOCATIONS, UNLESS OTHERWISE NOTED. IN THE FIELD, SUPERSEDE THOSE SHOWN ON THIS PLAN.
- F THE PROJECT IS SEISMIC DESIGN CATEGORY C, AS REFERENCED ON SHEET 011. ALL CEILING BY-TIME AND SUSPENDED FIXTURES MUST MEET ALL REQUIREMENTS AS MANDATED UNDER SEISMIC DESIGN CATEGORY C.
- G UL 489, 4-HOUR HORIZONTAL ASSEMBLY ABOVE ENTIRE CORRIDOR BTL CEILING. PER SECTION 0914. RATED CEILING CONSISTS OF: STRUCTURAL STUDS, THIS SYSTEM IS A DELEGATED DESIGN SUBMITTAL. FRAMING TO BE DESIGNED AND SUBMITTED BY GENERAL CONTRACTOR'S DIVISION 5 LIGHT CHASE FRAMING SUBCONTRACTOR. SEE STRUCTURAL SPECIFICATIONS.
- H THE GENERAL CONTRACTOR IS RESPONSIBLE FOR MAINTAINING THE INTEGRITY OF ALL FIRE RATED CONSTRUCTION SCHEDULED TO REMAIN.

RCP LEGEND

- EXISTING DOOR
- EXISTING WALL
- LINE OF OBJECT ABOVE
- 2X2 ACT CEILING
- 10'-0" AFF CEILING HEIGHT
- 1-HOUR RATED CEILING ASSEMBLY ABOVE ACT CEILING @ 11'-5 3/8" AFF. UL 419 HORIZONTAL ASSEMBLY.
- QWS CEILING
- LWC-1
- 2X4 LIGHT FIXTURE
- 1X4 SUSPENDED LIGHT FIXTURE
- RETURN AIR GRILL
- SUPPLY AIR GRILL
- EXIT SIGN, SEE ELECTRICAL
- 1-HR FIRE BARRIER / FIRE PARTITION
- EXISTING RATED CONSTRUCTION
- 3-HR FIRE WALL
- EXISTING RATED CONSTRUCTION

EQUIPMENT KEY NOTE LEGEND

Key Value	Keynote Text
E5	CEILING MOUNTED PATIENT LIFT SYSTEM AND HARNESS, SEE SPECIFICATION SECTION 1117300. PATH FROM DOOR TO CHANGING BENCH (E5).
E9	CEILING MOUNTED ADAPTIVE SWING. GENERAL CONTRACTOR TO PROVIDE SWING MOUNT (ANCHORED TO STRUCTURE ABOVE) SWING ATTACHMENT, AND ADJUSTABLE ROTATING HARNESS. SEE SPECIFICATION SECTION 1117300. SEE STRUCTURAL FOR TYPICAL MOUNT DETAIL.

RCP KEYNOTE LEGEND

Key Value	Keynote Text
C15	CEILING NOT SHOWN IN AREA 2 ARE EXISTING TO REMAIN, TYPICAL.
C16	PROVIDE NEW DIFFUSERS IN EXISTING CEILING PER MECHANICAL DRAWINGS.
C17	LINEAR SOFFIT VENT, TYPICAL. SEE DETAILS AND SPECIFICATIONS.
C18	4-INCH ROUND SOFFIT VENT AGAINST STOREFRONT CONDITIONS, TYPICAL.
C19	PREFINISHED ALUMINUM COLUMN COVER, SEE SPECIFICATIONS. PROVIDE 3/4" REVEAL TRIM AROUND COLUMN TOP, TYPICAL.
C20	LIGHT FIXTURE, TYPICAL. SEE ELECTRICAL.
C21	PREFINISHED METAL FASCIA, SEE SECTION DETAILS.
C22	DEFS CONTROL JOINT, TYPICAL.
C23	SPlice JOINT IN METAL FASCIA, TYPICAL.
C24	2-INCH SEISMIC EXPANSION JOINT.

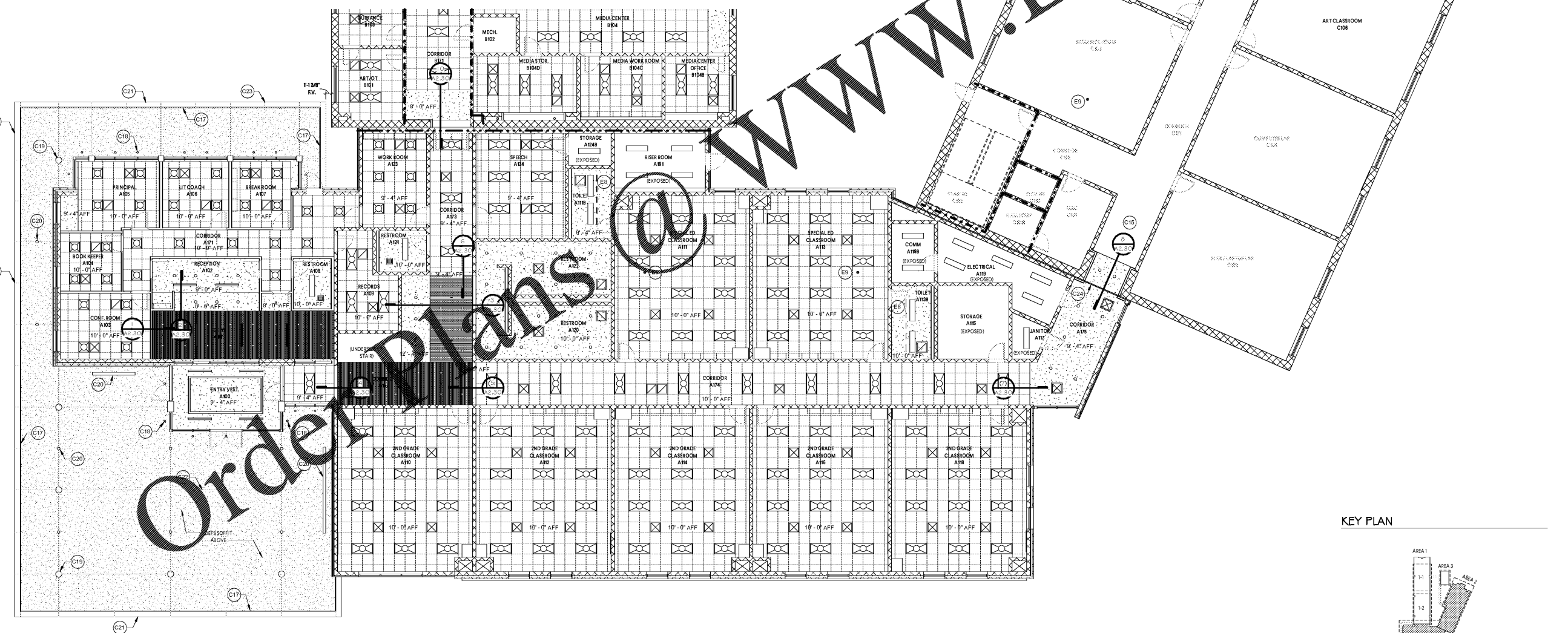

1 FIRST LEVEL - RCP - CLASSROOM ADDITION
SCALE: 1/8" = 1'-0"



1219 Wayne Street
Columbia, SC 29201
T: 803.766.1235
gmcnetwork.com

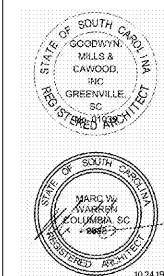

ISSUE DATE	BID DOCUMENTS
10.24.19	

MILLBROOK ELEMENTARY SCHOOL -
ADDITION AND RENOVATIONS
255 E PINE LOG RD., AIKEN, SC 29803
GMC # ACOL180004

FIRST LEVEL - RCP - CLASSROOM ADDITION
A2.10

10/29/2019 5:02:34 AM