

1 FIRST LEVEL - RCP - LOCATION PLAN

SCALE: 1/16" = 1'-0"

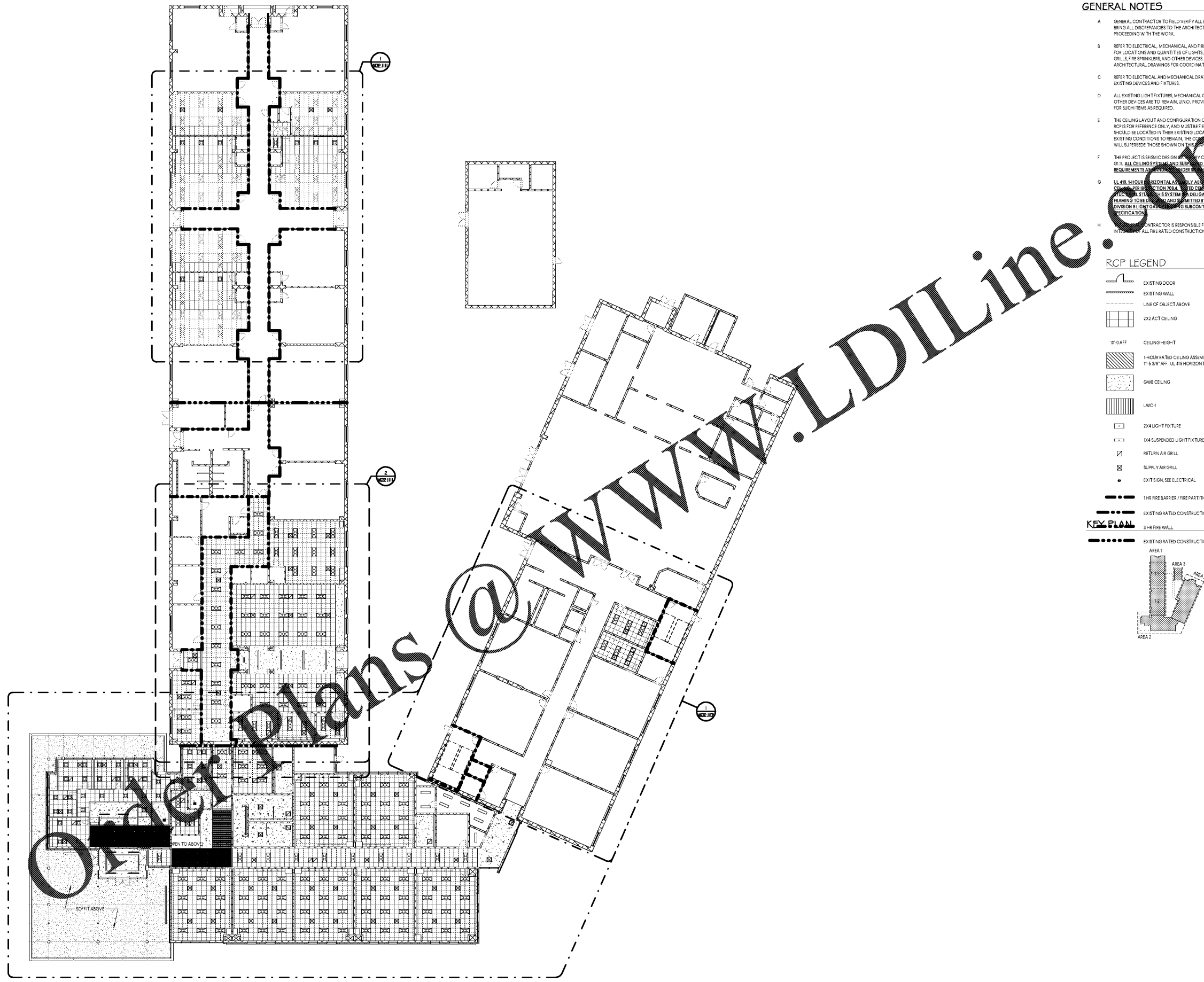

GENERAL NOTES

- A GENERAL CONTRACTOR TO FIELD VERIFY ALL EXISTING CONDITIONS, BRING ALL DISCREPANCIES TO THE ARCHITECT'S ATTENTION PRIOR TO PROCEEDING WITH THE WORK.
- B REFER TO ELECTRICAL, MECHANICAL, AND FIRE PROTECTION DRAWINGS FOR LOCATIONS AND QUANTITIES OF LIGHTS, SUPPLY AND RETURN AIR GRILLS, FIRE SPRINKLERS, AND OTHER DEVICES. DEVICES ARE SHOWN ON ARCHITECTURAL DRAWINGS FOR COORDINATION AND REFERENCE ONLY.
- C REFER TO ELECTRICAL AND MECHANICAL DRAWINGS FOR DEMOLITION OF EXISTING DEVICES AND FIXTURES.
- D ALL EXISTING LIGHT FIXTURES, MECHANICAL GRILLS, AND ALL OTHER DEVICES ARE TO REMAIN UNDO. PROVIDE TEMPORARY SUPPORT FOR SUCH ITEMS AS REQUIRED.
- E THE CEILING LAYOUT AND CONFIGURATION OF DEVICES SHOWN IN THIS RCP IS FOR REFERENCE ONLY AND MUST BE FIELD VERIFIED. DEVICES SHOULD BE LOCATED IN THEIR EXISTING LOCATION AND EXISTING CONDITIONS TO REMAIN, THE CONDITIONS IN THE FIELD WILL SUPERSSEDE THOSE SHOWN ON THIS RCP.
- F THE PROJECT IS SEISMIC DESIGN CATEGORY C, AS REQUIRED ON SHEET 01. ALL CEILING SYSTEMS AND SUPPORT FIXTURES MUST MEET ALL REQUIREMENTS AS SHOWN AND PER SEISMIC DESIGN CATEGORY C.
- G UL #19, 1-HOUR HORIZONTAL ASSEMBLY ABOVE FIRE CORRIDOR WITH 1-HOUR FIRE RATED PARTITION. CEILING CONSISTS OF 1-HOUR RATED CEILING ASSEMBLY ABOVE ACT CEILING. THIS SYSTEM IS A DELAGATED DESIGN SUBMITTAL FRAMING TO BE DESIGNED AND SUBMITTED BY GENERAL CONTRACTOR'S DIVISION 5 ELECTRICIAN AND MECHANICAL SUBCONTRACTOR. SEE STRUCTURAL SPECIFICATION.
- H GENERAL CONTRACTOR IS RESPONSIBLE FOR MAINTAINING THE ALL FIRE RATED CONSTRUCTION SCHEDULED TO REMAIN.

RCP LEGEND

- EXISTING DOOR
- EXISTING WALL
- LINE OF OBJECT ABOVE
- 2X2 ACT CEILING
- 10' 0" SOFF CEILING HEIGHT
- 1-HOUR RATED CEILING ASSEMBLY ABOVE ACT CEILING @ IT IS 3/8" AFF. UL #19 HORIZONTAL ASSEMBLY.
- GW5 CEILING
- LWC-1
- 2X4 LIGHT FIXTURE
- 1X4 SUSPENDED LIGHT FIXTURE
- RETURN AIR GRILL
- SUPPLY AIR GRILL
- EXIT SIGN, SEE ELECTRICAL
- 1-HR FIRE BARRIER / FIRE PARTITION
- EXISTING RATED CONSTRUCTION
- 3-HR FIRE WALL
- EXISTING RATED CONSTRUCTION

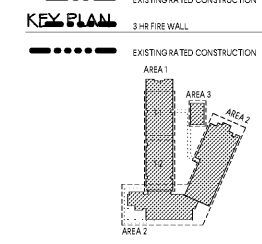

ISSUE	DATE
BID DOCUMENTS	10.24.19

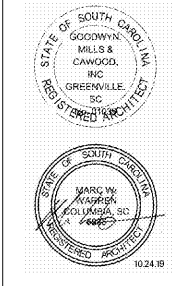

1219 Wayne Street
Columbia, SC 29201
T 803.766.1235
GMCNETWORK.COM

