

GENERAL NOTES

- A SEE SPECIFICATIONS FOR METAL PAN STAIR. METAL PAN STAIR IS A DELIGATED DESIGN SUBMITTAL. METAL PAN STAIR PROVIDER IS TO PROVIDE SHOP DRAWINGS DETAILING STEEL MEMBER SIZES, SUPPORT REQUIREMENTS, DETAILS, AND OTHER CONDITIONS RELATED TO THE DESIGN OF THE STAIR. SEE SPECIFICATIONS.
- B PLAM 3 BASIS OF DESIGN IS FORMICA HARDTOP. SEE SPECIFICATIONS. PLAM 3 IS INSTALLED OF GYPSUM WALLBOARD. ALL JOINTS, END CONDITIONS (END OF WALL, TOP OF PANEL, BOTTOM OF PANEL), AND CORNERS UTILIZE MANUFACTURER'S STANDARD TRIM PICES. PROVIDE BRUSHED ALUMINUM FINISH.
- C GLASS HANDRAIL SYSTEM BASIS OF DESIGN IS CR LAURENCE TAPER LOCK DRY GLAZED RAILING SYSTEM W/ CONTINUOUS BASE/RAIL ANCHORED TO STEEL PLATE WELDED TO STEEL TUBE STRINGER. FOR HANDRAIL TO BE CONTINUOUS, GLASS PLANE MUST ALIGN WITH THE PLANE OF THE PLAM 3 WALL, IN PLAN. THIS ALIGNMENT REQUIRES A CONTINUOUS STEEL PLATE WELDED TO THE STRINGER TO BRING THE RAILING SYSTEM INTO ALIGNMENT.
- D STAIR HANDRAIL IS A BRUSHED STAINLESS STEEL CUSTOM HANDRAIL, CONTINUOUS FROM THE PLAM 3 WALL TO THE GLASS RAILING SYSTEM. WHERE DISTANCE FROM WALL VARIES, PROVIDE EXPOSED BLOCKING FOR MOUNTING. EXPOSED BLOCKING SHALL BE 3-1/2" DIA. PAINT GRADE POPLAR, PAINTED TO MATCH WALL, W/ CONCEALED FASTENERS.
- E PROVIDE VINYL TREADS AND RISERS, TYPICAL. PROVIDE MATCHING VINYL LANDING.

FLOOR PLAN LEGEND

- NEW DOOR
- NEW WALL
- EXISTING DOOR
- EXISTING WALL
- LINE OF OBJECT ABOVE
- FEC FIRE EXTINGUISHER CABINET
- FE BRACKET MOUNTED FIRE EXTINGUISHER
- 1HR FIRE BARRIER / FIRE PARTITION
- EXISTING RATED CONSTRUCTION
- 3HR FIRE WALL
- EXISTING RATED CONSTRUCTION

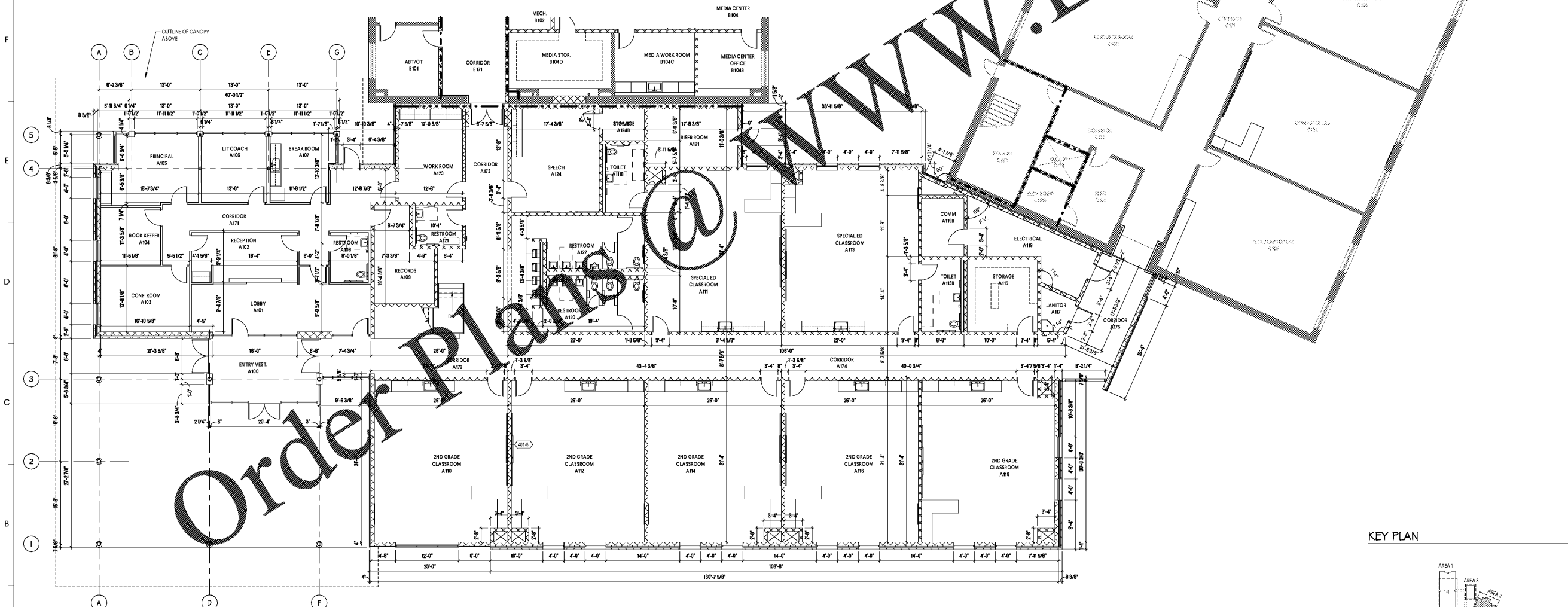

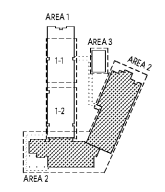

KEY PLAN



1 FIRST LEVEL - DIMENSION PLAN - CLASSROOM ADDITION
SCALE: 1/8" = 1'-0"



1219 Wayne Street
Columbia, SC 29201
T: 803.766.1235
GMCNETWORK.COM

102419

ISSUE DATE
BID DOCUMENTS 10.24.19

DRAWN BY: JMW
CHECKED BY: JMW

FIRST LEVEL - DIMENSION PLAN - CLASSROOM ADDITION
MILLBROOK ELEMENTARY SCHOOL - ADDITION AND RENOVATIONS
255 E PINE LOG RD, AIKEN, SC 29803
GMC # ACOL180004

A1.10D

10/29/2019 4:39:23 AM