

10/29/2019 4:36:55 AM

1 FIRST LEVEL - LOCATION PLAN
SCALE: 1/16" = 1'-0"

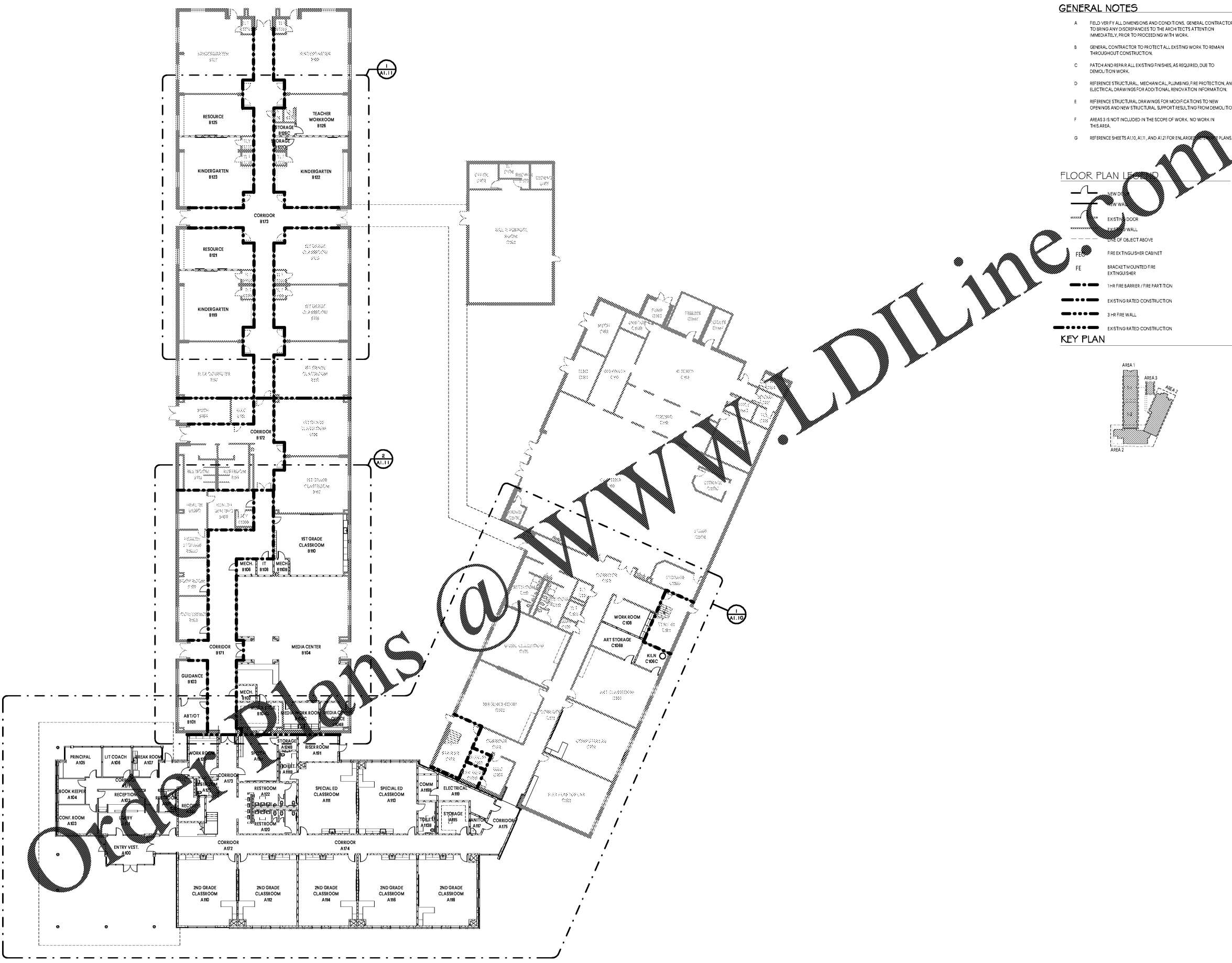

GENERAL NOTES

- A FIELD VERIFY ALL DIMENSIONS AND CONDITIONS. GENERAL CONTRACTOR TO BRING ANY DISCREPANCIES TO THE ARCHITECT'S ATTENTION IMMEDIATELY PRIOR TO PROCEEDING WITH WORK.
- B GENERAL CONTRACTOR TO PROTECT ALL EXISTING WORK TO REMAIN THROUGHOUT CONSTRUCTION.
- C PATCH AND REPAIR ALL EXISTING FINISHES, AS REQUIRED, DUE TO DEMOLITION WORK.
- D REFERENCE STRUCTURAL, MECHANICAL, PLUMBING, FIRE PROTECTION, AND ELECTRICAL DRAWINGS FOR ADDITIONAL RENOVATION INFORMATION.
- E REFERENCE STRUCTURAL DRAWINGS FOR MODIFICATIONS TO NEW OPENINGS AND NEW STRUCTURAL SUPPORT RESULTING FROM DEMOLITION.
- F AREAS 1 IS NOT INCLUDED IN THE SCOPE OF WORK. NO WORK IN THIS AREA.
- G REFERENCE SHEETS A1.0, A1.1, AND A1.2 FOR ENLARGED FINISH PLANS.

FLOOR PLAN LEGEND

- NEW DOOR
- EXISTING DOOR
- EXISTING WALL
- LINE OF OBJECT ABOVE
- FIRE EXTINGUISHER CABINET
- BRACKET MOUNTED FIRE EXTINGUISHER
- 1-HR FIRE BARRIER / FIRE PARTITION
- EXISTING RATED CONSTRUCTION
- 3-HR FIRE WALL
- EXISTING RATED CONSTRUCTION

KEY PLAN

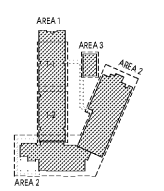

1219 Wayne Street
Columbia, SC 29201
T 803.766.1235
GMCNETWORK.COM

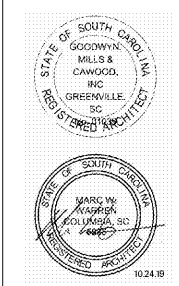

ISSUE DATE	DATE
BID DOCUMENTS	10.24.19

MILLBROOK ELEMENTARY
SCHOOL - ADDITION AND
RENOVATIONS
255 E PINE LOG RD, AIKEN, SC 29803
GMC # ACOL180004

FIRST LEVEL -
LOCATION PLAN
A1.01

DRAWN BY: JM/W
CHECKED BY: JM/W