

10/29/2019 10:51:03 AM

# 1 ARCHITECTURAL SITE PLAN

SCALE: 1" = 40'-0"

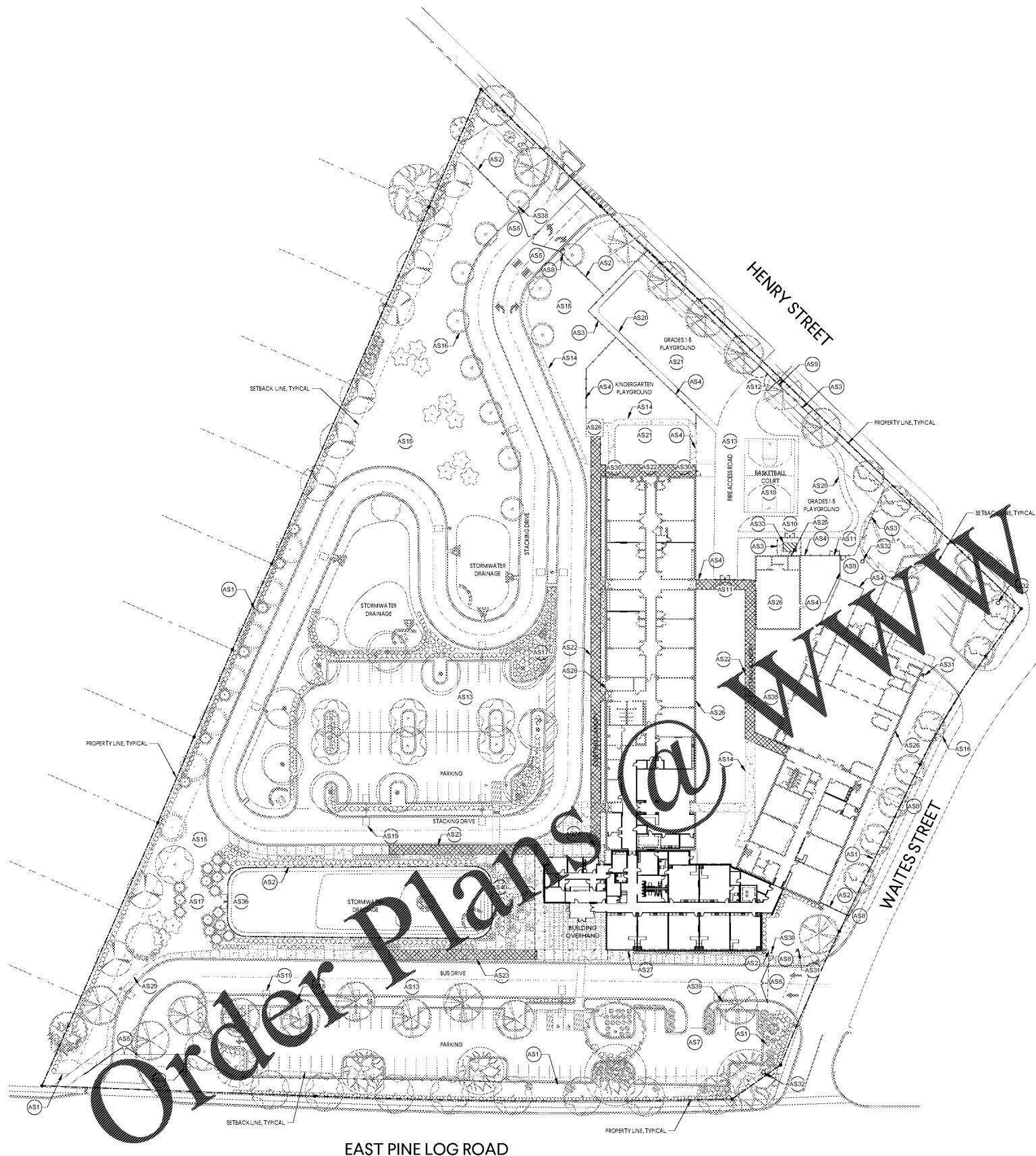

### GENERAL NOTES

- A THE ARCHITECTURAL SITE PLAN SERVES AS A COORDINATION AND REFERENCE DRAWING. REFERENCE CIVIL, LANDSCAPE, FIRE PROTECTION, AND ELECTRICAL DRAWINGS FOR DETAILED SITE INFORMATION.
- B REFERENCE CIVIL DRAWINGS FOR DETAILED SITE INFORMATION, SITE UTILITIES, AND DEMOLITION SCOPE.
- C REFERENCE LANDSCAPE DRAWINGS FOR PLANTING PLAN, IRRIGATION PLAN, AND THE SCORES OF SEEDING. ALL DISTURBED AREAS ARE TO BE SEEDED - SEE LANDSCAPE AND CIVIL DRAWINGS.
- D REFERENCE FIRE PROTECTION DRAWINGS FOR FIRE PROTECTION SITE SCOPE.
- E REFERENCE ELECTRICAL DRAWINGS FOR ELECTRICAL SITE SCOPE.
- F REFERENCE CIVIL DRAWINGS FOR LIMITS OF CONSTRUCTION.
- G SCORE JOINT LOCATIONS ARE DESIGNATED ON THIS SHEET W/ GRAY LINES DRAWN OVER CONCRETE PAVING AREAS. GENERAL CONTRACTOR TO PROVIDE FOR SCORE JOINT LOCATIONS AS DESIGNATED ON THIS SHEET IN THEIR BASE BID PRICING. REFERENCE (AS) 20 FOR SCORE JOINT QUANTITIES, LOCATION, AND ALIGNMENT W/ PLANTING BED LOCATIONS AND OTHER SITE ELEMENTS. IF NO SCORE JOINTS ARE SHOWN, PROVIDE SCORE JOINTS @ 5'-0" O.C. MAX. ARCHITECT TO PROVIDE SCORE JOINT DIMENSION PLANS PRIOR TO INSTALLATION. COORDINATE W/ ARCHITECT IN THE FIELD.
- H GENERAL CONTRACTOR TO PROTECT EXISTING CONSTRUCTION TO REMAIN WHILE PERFORMING SITE WORK.
- I FIELD VERIFY ALL DIMENSION AND CONDITIONS. BRING ANY DISCREPANCIES TO THE ARCHITECT PRIOR TO PERFORMING ASSOCIATED WORK.
- J ALL CONCRETE SCORE JOINTS ARE TO BE TOOLED JOINTS.
- K REVIEW SOD/WALK LAYOUTS AND SCORE JOINT LOCATIONS ON SITE W/ ARCHITECT PRIOR TO PERFORMING THE WORK.
- L REVIEW LAYOUTS ON SITE W/ ARCHITECT PRIOR TO PERFORMING THE WORK.
- M EXISTING UNDERGROUND STORAGE TANKS ARE TO BE REMOVED AND BACKFILLED BY OWNER PRIOR TO WORK IN THOSE AREAS. GENERAL CONTRACTOR TO COORDINATE W/ OWNER AS REQUIRED.
- N THE SITE IS TO REMAIN OCCUPIED DURING CONSTRUCTION. REFERENCE THE CONSTRUCTION LIFE SAFETY PHASING PLANS ON SHEETS AX11-AX15 FOR ADDITIONAL INFORMATION.
- O THE GENERAL CONTRACTOR IS TO PROVIDE ALL TEMPORARY INFRASTRUCTURE MODIFICATIONS REQUIRED TO MAINTAIN FUNCTIONALITY OF EXISTING INFRASTRUCTURE ON SITE DURING CONSTRUCTION. INTERMEDIATE MEASURES WILL BE REQUIRED TO SUPPORT THE PHASING OF THIS WORK. THE GENERAL CONTRACTOR IS RESPONSIBLE FOR ALL FENCING, SIGNAGE, INFRASTRUCTURE REQUIREMENTS, POSITION CONTROL, AND STORMWATER MEASURES AND ALL OTHER MEASURES TO SUPPORT THE PHASING OF THE WORK AS PART OF THE BASE BID. THE GENERAL CONTRACTOR IS RESPONSIBLE FOR PERMITTING AND REQUIRED DEMOLITION AND SITE PREP RELATED TO ALL THE NEW WORK.

### SITE PLAN LEGEND

- NEW DOOR
- NEW WALL
- EXISTING DOOR
- EXISTING WALL
- PROPERTY LINE
- SETBACK LINE
- LINE OF OBJECT ABOVE
- FENCE - SEE KEY NOTES FOR TYPE
- 6" ALUMINUM PICKET FENCE
- SOD / SEED - SEE LANDSCAPE AND CIVIL DRAWINGS
- ASPHALT - SEE CIVIL DRAWINGS
- TOOLED SCORE JOINT
- CONCRETE JOINT
- CONCRETE WALKWAY

### KEYNOTE LEGEND

Keynote	Keynote Text
AS2	NEW 6'-0" TALL BLACK CHAIN LINK FENCE W/ FUSED AND BONDED FINISH LAYER, TYPICAL. SEE SPECIFICATIONS.
AS3	NEW 6'-0" TALL BLACK CHAIN LINK FENCE W/ FUSED AND BONDED FINISH LAYER, TYPICAL. SEE SPECIFICATIONS.
AS4	NEW, 6'-0" TALL BLACK ALUMINUM PICKET FENCE, SEE SPECIFICATIONS.
AS5	(PAIR) 11'-0" WIDE MANUAL SWING BARRIER GATES W/ RECEIVER POSTS, PAINTED BLACK, TYPICAL. 22'-0" WIDE CLEAR OPENING. SEE SPECIFICATIONS. GENERAL CONTRACTOR TO PROVIDE LOCKING HARDWARE TO SECURE GATES. LOCK MUST BE KEYPED TO MATCH SCHOOL MASTER.
AS6	(PAIR) 16'-0" WIDE MANUAL SWING BARRIER GATES W/ RECEIVER POSTS, PAINTED BLACK, TYPICAL. 32'-0" WIDE CLEAR OPENING. SEE SPECIFICATIONS. GENERAL CONTRACTOR TO PROVIDE LOCKING HARDWARE TO SECURE GATES. LOCK MUST BE KEYPED TO MATCH SCHOOL MASTER.
AS7	(1) 12'-0" WIDE, ELECTRICALLY OPERATED, PARKING BARRIER LIFT GATES. SEE SPECIFICATIONS. GATE TO BE PROVIDED W/ TIMER AND ACCESS CONTROL DEVICE COMPATIBLE W/ THE SCHOOL'S EXISTING CREDENTIALS SYSTEM. TIMER MUST BE ABLE TO BE BYPASSED FOR HOLIDAYS AND OTHER OFF SCHEDULE TIMES. GATES MUST BE PROVIDED W/ MANUAL OVERRIDE FUNCTION AND EGRESS LOOP DETECTOR.
AS8	4'-0" WIDE X 4'-0" TALL BLACK CHAIN LINK GATE W/ FUSED AND BONDED FINISH LAYER, TYPICAL. SEE SPECIFICATIONS. GATE TO BE PROVIDED WITH KEYPED LOCK TO MATCH SCHOOL MASTER. GATE IS ALSO TO BE PROVIDED WITH PANIC HARDWARE AND SOLID TAMPER PANEL ON EXTERIOR FACE OF GATE. SEE DETAILS.
AS9	4'-0" WIDE X 6'-0" TALL BLACK CHAIN LINK GATE W/ FUSED AND BONDED FINISH LAYER, TYPICAL. SEE SPECIFICATIONS. GATE TO BE PROVIDED WITH KEYPED LOCK TO MATCH SCHOOL MASTER. GATE IS ALSO TO BE PROVIDED WITH PANIC HARDWARE AND SOLID TAMPER PANEL ON EXTERIOR FACE OF GATE. SEE DETAILS.
AS10	(PAIR) 4'-0" WIDE X 6'-0" TALL BLACK CHAIN LINK GATE W/ FUSED AND BONDED FINISH LAYER, TYPICAL. SEE SPECIFICATIONS. GATE TO BE PROVIDED WITH KEYPED LOCK TO MATCH SCHOOL MASTER. GATE IS ALSO TO BE PROVIDED WITH PANIC HARDWARE AND SOLID TAMPER PANEL ON EXTERIOR FACE OF GATE. SEE DETAILS. GATE SHALL HAVE REMOVABLE CENTER POST SET IN STEEL SLEEVE.
AS11	(PAIR) 4'-0" WIDE X 6'-0" TALL BLACK ALUMINUM PICKET GATE, TYPICAL. SEE SPECIFICATIONS. GATE TO BE PROVIDED WITH KEYPED LOCK TO MATCH SCHOOL MASTER. GATE IS ALSO TO BE PROVIDED WITH PANIC HARDWARE AND SOLID TAMPER PANEL ON EXTERIOR FACE OF GATE. SEE DETAILS. GATE SHALL HAVE REMOVABLE CENTER POST SET IN STEEL SLEEVE.
AS12	(PAIR) 10'-0" WIDE X 6'-0" TALL BLACK CHAIN LINK GATE W/ FUSED AND BONDED FINISH LAYER, TYPICAL. SEE SPECIFICATIONS. GATE SHALL BE PROVIDED WITH DIAGONAL BRACING SO THAT CENTER POST IS NOT REQUIRED.
AS13	ASPHALT PAVING, TYPICAL. SEE CIVIL DRAWINGS.
AS14	CONCRETE PAVING, TYPICAL. SEE CIVIL DRAWINGS.
AS15	SEED OR SOD, TYPICAL. SEE LANDSCAPE AND CIVIL DRAWINGS. ALL DISTURBED AREAS ARE TO BE STABILIZED AND SEEDED, IF NOT SPECIFIED TO RECEIVE SOD.
AS16	TREE, TYPICAL. SEE LANDSCAPE PLANS FOR EXISTING AND NEW TREES AND ASSOCIATED IRRIGATION.
AS17	PLANTING BED, TYPICAL. SEE LANDSCAPE PLANS FOR PLANTING AND IRRIGATION.
AS18	GENERAL CONTRACTOR TO PROVIDE BASKETBALL COURT STRIPING AS SHOWN. ARCHITECT TO PROVIDE CONSTRUCTION SKETCH DIMENSIONING COURT STRIPING. GENERAL CONTRACTOR TO CONFIRM DIMENSIONS W/ ARCHITECT PRIOR TO PERFORMING THE WORK.
AS19	LIGHT POLE, TYPICAL. SEE ELECTRICAL DRAWINGS.
AS20	ASPHALT WALKING PATH, SEE CIVIL DRAWINGS.
AS21	OWNER PROVIDED, OWNER INSTALLED PLAYGROUND EQUIPMENT. COORDINATE SITEWORK W/ OWNER'S PLAYGROUND EQUIPMENT PROVIDER.
AS22	EXISTING PREMANUFACTURED ALUMINUM COVERED WALKWAY TO REMAIN. PROTECT DURING CONSTRUCTION.
AS23	NEW PREMANUFACTURED ALUMINUM COVERED WALKWAY. SEE SHEET AS1.1.0. SYSTEM TO BE SELF DRAINING. SEE SHEET AS1.1.0 AND SPECIFICATIONS.
AS24	PROVIDE CANOPY FASCIA TO REPAIR LOCATION WHERE CANOPY WAS REMOVED. PROVIDE (2) NEW COLUMNS AND ANY OTHER ASSOCIATED ELEMENTS REQUIRED TO SUPPORT REMAINING CANOPY.
AS25	EXISTING WATER METER IS TO BE RAISED SO THAT METER IS INTEGRATED W/ NEW COOLING TOWER SLAB. MAINTAIN ALL REQUIRED ACCESS AND CLEARANCE REQUIREMENTS FOR EXISTING WATER METER.
AS26	EXISTING BUILDING TO REMAIN, TYPICAL. PROTECT DURING CONSTRUCTION.
AS27	NEW CONSTRUCTION.
AS28	PATCH EXISTING CONCRETE REMOVED FOR INSTALLATION OF NEW MECHANICAL UTILITIES.
AS29	PROVIDE TOOLED SCORE JOINTS @ 5'-0" O.C. WHERE NOT SPECIFICALLY SPECIFIED.
AS30	4'-0" WIDE X 6'-0" TALL BLACK ALUMINUM GATE, TYPICAL. SEE SPECIFICATIONS. GATE TO BE PROVIDED WITH KEYPED LOCK TO MATCH SCHOOL MASTER. GATE IS ALSO TO BE PROVIDED WITH PANIC HARDWARE AND SOLID TAMPER PANEL ON EXTERIOR FACE OF GATE. SEE DETAILS.
AS31	FDC CONNECTION, SEE CIVIL DRAWINGS.
AS32	FIRE HYDRANT, SEE CIVIL DRAWINGS.
AS33	NEW COOLING TOWER, CONCRETE PAD, AND ASSOCIATED STEEL SUPPORT STRUCTURE. SEE MECHANICAL AND STRUCTURAL DRAWINGS.
AS34	RELOCATED DIGITAL SCHOOL SIGN. GENERAL CONTRACTOR RESPONSIBLE FOR EXTENDING EXISTING INFRASTRUCTURE AS REQUIRED. GENERAL CONTRACTOR RESPONSIBLE FOR PERMITTING NEW SIGN LOCATION W/ THE CITY OF AIKEN AND MEETING ALL ORDINANCE REQUIREMENTS.
AS35	EXISTING CONCRETE PATIO TO REMAIN.
AS36	(PAIR) 4'-0" WIDE X 4'-0" TALL BLACK CHAIN LINK GATE W/ FUSED AND BONDED FINISH LAYER, TYPICAL. SEE SPECIFICATIONS. GATE SHALL HAVE REMOVABLE CENTER POST SET IN STEEL SLEEVE.
AS38	PEDESTAL MOUNTED KNOX BOX, SEE SPECIFICATIONS.
AS39	ACCESS CONTROL PEDESTAL.
AS40	NEW 25'-0" FLAG POLE. PROVIDE FOOTING PER MANUFACTURER'S STANDARD INSTRUCTIONS.



1219 Wayne Street  
Columbia, SC 29201  
T 803.766.1235  
GMCNETWORK.COM

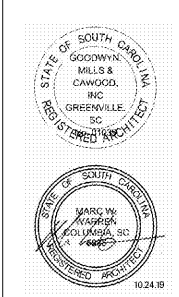

ISSUE DATE	DATE
BID DOCUMENTS	10.24.19

DRAWN BY: JLVW  
CHECKED BY: JLVW

MILLBROOK ELEMENTARY  
SCHOOL - ADDITION AND  
RENOVATIONS  
255 E PINE LOG RD., AIKEN, SC 29803  
GMC # ACOL180004

ARCHITECTURAL SITE  
PLAN  
**AS1.00**