

KEY PLAN

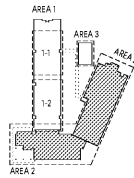

DEMOLITION RCP KEYNOTE LEGEND	
Key Value	Keynote Text
CD 1 2	REMOVE EXISTING EXIT SIGN.
CD 1 3	REMOVE EXISTING EXTERIOR SOFFIT.
CD 1 4	MODIFY EXISTING CEILING AS REQUIRED TO ACCOMODATE NEW CONSTRUCTION.
CD 1 5	REMOVE EXISTING CEILING. SEE MECHANICAL, ELECTRICAL, AND FIRE PROTECTION DRAWINGS FOR EXISTING INFRASTRUCTURE TO REMAIN OR TO BE REMOVED.
CD 1 6	CEILING NOT SHOWN IN AREA 2 ARE EXISTING TO REMAIN, TYPICAL.

DEMOLITION RCP LEGEND

- EXISTING DOOR
- EXISTING WALL
- LINE OF OBJECT ABOVE
- 2x4 ACT CEILING
- 2x2 ACT CEILING
- GWS CEILING
- CONCRETE CEILING
- DEMOLISH
- 2x4 LIGHT FIXTURE
- 1x4 SUSPENDED LIGHT FIXTURE
- RETURN AIR GRILL
- SUPPLY AIR GRILL
- EXIT SIGN, SEE ELECTRICAL
- 1HR FIRE BARRIER / FIRE PARTITION
- EXISTING RATED CONSTRUCTION
- 3HR FIRE WALL
- EXISTING RATED CONSTRUCTION

GENERAL NOTES

- A REFERENCE SHEETS AD11 AND AD12 FOR ENLARGED DEMOLITION PLAN.
- B REFERENCE SHEETS AD11 AND 212 FOR REFLECTED CEILING DEMOLITION PLAN.
- C REFERENCE SHEETS A2, A21, AND A22 FOR COORDINATION W/ RENOVATION WORK.
- D REFERENCE ELECTRICAL, MECHANICAL, FIRE PROTECTION, AND PLUMBING DRAWINGS FOR DEMOLITION OF EXISTING INFRASTRUCTURE.
- E GENERAL CONTRACTOR TO FIELD VERIFY ALL EXISTING CONDITIONS. BRING ALL DISCREPANCIES TO THE ARCHITECT'S ATTENTION PRIOR TO PROCEEDING WITH THE WORK. GENERAL CONTRACTOR TO PROTECT EXISTING CONSTRUCTION TO REMAIN DURING DEMOLITION AND CONSTRUCTION.
- F WHERE EXISTING CONSTRUCTION AND FINISHES ARE TO BE DEMOLISHED, THE GENERAL CONTRACTOR IS RESPONSIBLE FOR PATCHING AND REPAIRING ALL WORK TO REMAIN, AND PREPPING SURFACES TO RECEIVE NEW WORK.
- G THE SCHOOL WILL BE OCCUPIED DURING CONSTRUCTION. THE GENERAL CONTRACTOR IS TO KEEP ALL CONSTRUCTION ACTIVITIES SEPARATE FROM SCHOOL ACTIVITIES. THE GENERAL CONTRACTOR IS TO PROVIDE ADVANCED NOTICE TO THE ARCHITECT AND SCHOOL DISTRICT PRIOR TO ANY ACTIVITIES THAT MAY IMPIDE ON SCHOOL ACTIVITIES.
- H THE GENERAL CONTRACTOR IS RESPONSIBLE FOR MAINTAINING THE INTERIOR OF ALL RATED CONSTRUCTION SCHEDULED TO REMAIN.

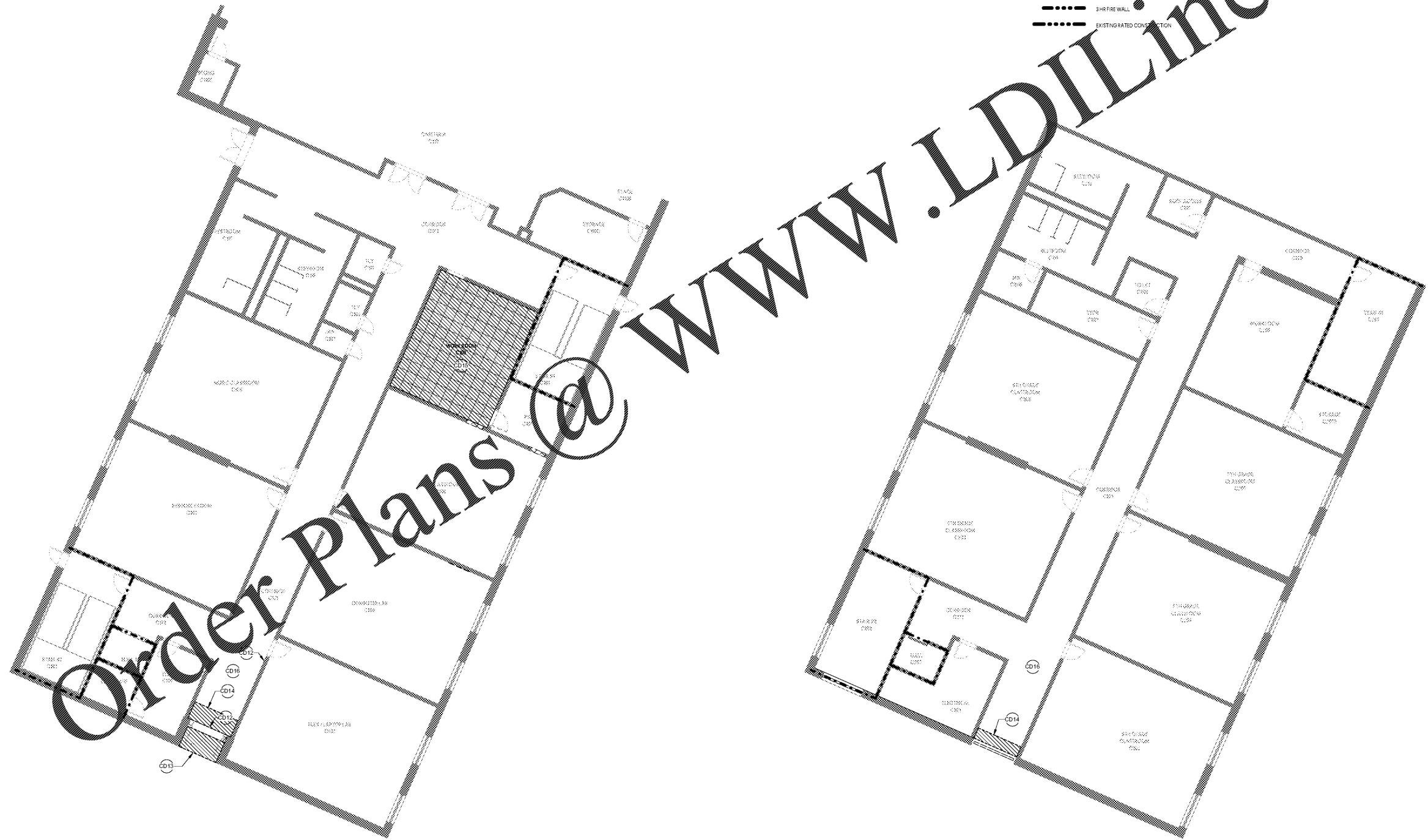

**1 FIRST LEVEL - AREA 2 - DEMOLITION RCP**  
SCALE: 1/8"=1'-0"

**2 FIRST LEVEL - AREA 2 - DEMOLITION RCP**  
SCALE: 1/8"=1'-0"

**GMC**

1219 Wayne Street  
Columbia, SC 29201  
T: 803.766.1235  
gmcnetwork.com



ISSUE DATE	DATE
BID DOCUMENTS	10.24.19

MILLBROOK ELEMENTARY SCHOOL -  
ADDITION AND RENOVATIONS  
255 E PINE LOG RD., AIKEN, SC 29803  
GMC # ACOL180004

**DEMOLITION REFLECTED CEILING  
PLAN - FIRST LEVEL - AREA 2**  
**AD2.12**

DRAWN BY: MJW  
CHECKED BY: JMW