

# Order Plans @

# WWW.DILING.COM

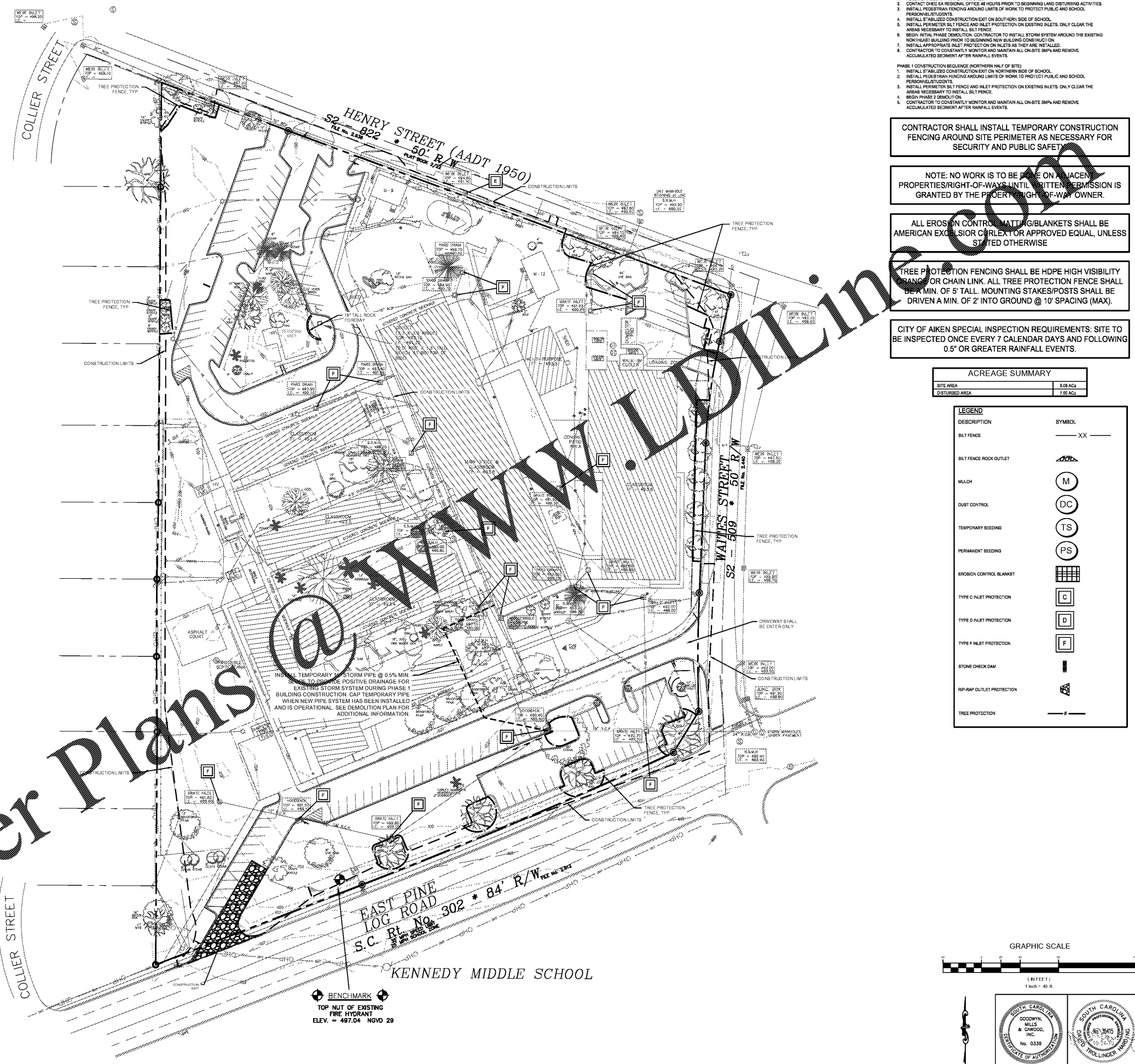

- PHASE 1 CONSTRUCTION SEQUENCE**  
**PHASE 1 CONSTRUCTION SEQUENCE (SOUTHERN HALF OF SITE)**
1. RECEIVE WORKS APPROVAL FROM DHEC.
  2. CONTACT DHEC EA REGIONAL OFFICE 48 HOURS PRIOR TO BEGINNING LAND DISTURBING ACTIVITIES.
  3. INSTALL PEDESTRIAN FENCING AROUND LIMITS OF WORK TO PROTECT PUBLIC AND SCHOOL PERSONNEL/STUDENTS.
  4. INSTALL STABILIZED CONSTRUCTION EIT ON SOUTHERN SIDE OF SCHOOL.
  5. INSTALL PERIMETER SILT FENCE AND INLET PROTECTION ON EXISTING INLETS. ONLY CLEAR THE AREAS NECESSARY TO INSTALL SILT FENCE.
  6. BEGIN INITIAL PHASE DEMOLITION. CONTRACTOR TO INSTALL STORM SYSTEM AROUND THE EXISTING NORTH/EAST BUILDING PRIOR TO BEGINNING NEW BUILDING CONSTRUCTION.
  7. INSTALL APPROPRIATE INLET PROTECTION ON INLETS AS THEY ARE INSTALLED.
  8. CONTRACTOR TO CONSTANTLY MONITOR AND MAINTAIN ALL ON-SITE BMPs AND REMOVE ACCUMULATED SEDIMENT AFTER RAINFALL EVENTS.
- PHASE 1 CONSTRUCTION SEQUENCE (NORTHERN HALF OF SITE)**
1. INSTALL STABILIZED CONSTRUCTION EIT ON NORTHERN SIDE OF SCHOOL.
  2. INSTALL PEDESTRIAN FENCING AROUND LIMITS OF WORK TO PROTECT PUBLIC AND SCHOOL PERSONNEL/STUDENTS.
  3. INSTALL PERIMETER SILT FENCE AND INLET PROTECTION ON EXISTING INLETS. ONLY CLEAR THE AREAS NECESSARY TO INSTALL SILT FENCE.
  4. BEGIN PHASE 2 DEMOLITION.
  5. CONTRACTOR TO CONSTANTLY MONITOR AND MAINTAIN ALL ON-SITE BMPs AND REMOVE ACCUMULATED SEDIMENT AFTER RAINFALL EVENTS.
- CONTRACTOR SHALL INSTALL TEMPORARY CONSTRUCTION FENCING AROUND SITE PERIMETER AS NECESSARY FOR SECURITY AND PUBLIC SAFETY.**
- NOTE: NO WORK IS TO BE DONE ON ADJACENT PROPERTIES/RIGHT-OF-WAYS UNTIL WRITTEN PERMISSION IS GRANTED BY THE PROPERTY RIGHT-OF-WAY OWNER.**
- ALL EROSION CONTROL MATTING/BANKETS SHALL BE AMERICAN EXPLORER CORP. OR APPROVED EQUAL, UNLESS STATED OTHERWISE.**
- TREE PROTECTION FENCING SHALL BE HDPE HIGH VISIBILITY BANDING OR CHAIN LINK. ALL TREE PROTECTION FENCE SHALL BE A MIN. OF 5' TALL. MOUNTING STAKES/POSTS SHALL BE DRIVEN A MIN. OF 2' INTO GROUND @ 10' SPACING (MAX).**
- CITY OF AIKEN SPECIAL INSPECTION REQUIREMENTS. SITE TO BE INSPECTED ONCE EVERY 7 CALENDAR DAYS AND FOLLOWING 0.5" OR GREATER RAINFALL EVENTS.**

ACREAGE SUMMARY	
SITE AREA	9.08 AC.
DISTURBED AREA	7.82 AC.

LEGEND	
DESCRIPTION	SYMBOL
SILT FENCE	XX
SILT FENCE ROCK OUTLET	[Symbol]
MULCH	(M)
DUST CONTROL	(DC)
TEMPORARY SEEDING	(TS)
PERMANENT SEEDING	(PS)
EROSION CONTROL BLANKET	[Symbol]
TYPE C INLET PROTECTION	(C)
TYPE D INLET PROTECTION	(D)
TYPE F INLET PROTECTION	(F)
STONE CHECK DAM	[Symbol]
RIP-RAP OUTLET PROTECTION	[Symbol]
TREE PROTECTION	[Symbol]

ISSUE	DATE
BID DOCUMENTS	10.24.19

MILLBROOK ELEMENTARY SCHOOL - ADDITIONS AND RENOVATIONS  
255 E PINE LOG RD., AIKEN, SC 29803  
GMC # CGRE190013

INITIAL PHASE SEDIMENT & EROSION CONTROL PLAN  
C-401



617 East McBee Ave  
Suite 200  
Greenville, SC 29601  
T 864.527.0480  
GMCNETWORK.COM

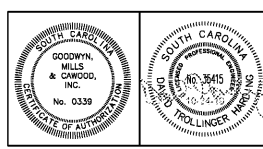

DRAWING FILE W:\Projects\192000\192000-01\192000-01.dwg  
PLOTTED: 06/25/2019 1:52:00 PM