

EXST7-EXST1
 Horizontal Scale: 1" = 40'
 Vertical Scale: 1" = 4'

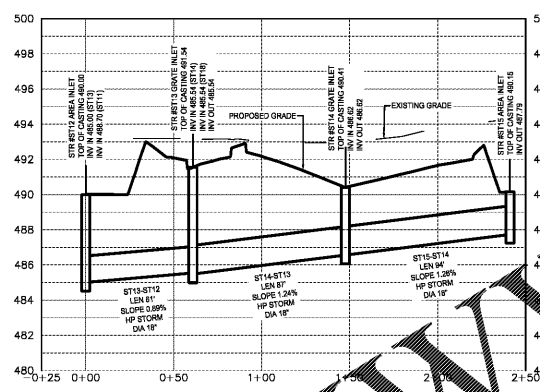

ST15-ST12
 Horizontal Scale: 1" = 40'
 Vertical Scale: 1" = 4'

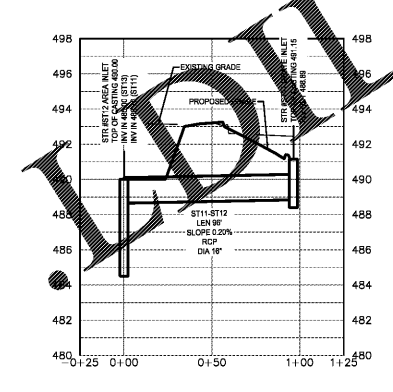

ST11-ST12
 Horizontal Scale: 1" = 40'
 Vertical Scale: 1" = 4'

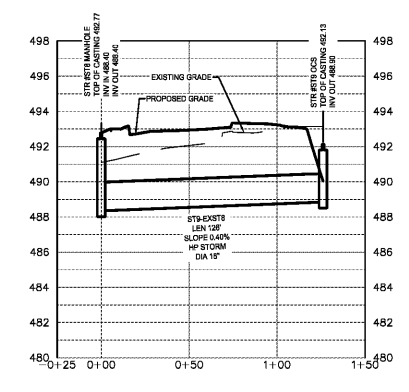

ST9-ST8
 Horizontal Scale: 1" = 40'
 Vertical Scale: 1" = 4'

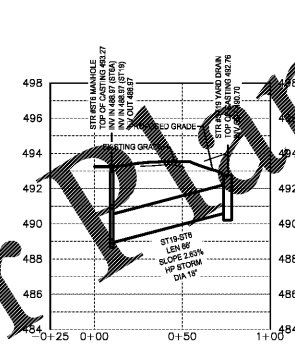

ST19-ST6
 Horizontal Scale: 1" = 40'
 Vertical Scale: 1" = 4'

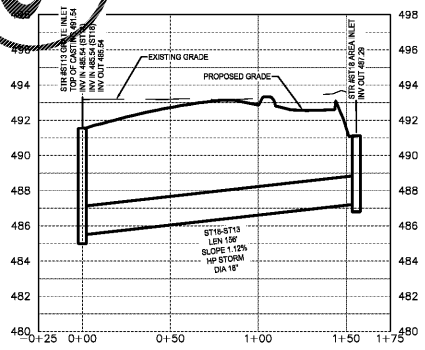

ST18-ST13
 Horizontal Scale: 1" = 40'
 Vertical Scale: 1" = 4'

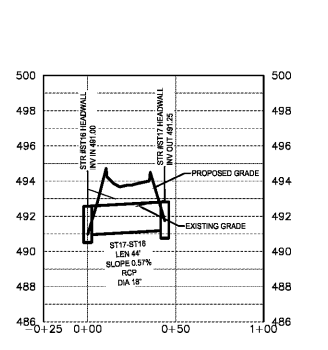

ST17-ST16
 Horizontal Scale: 1" = 40'
 Vertical Scale: 1" = 4'

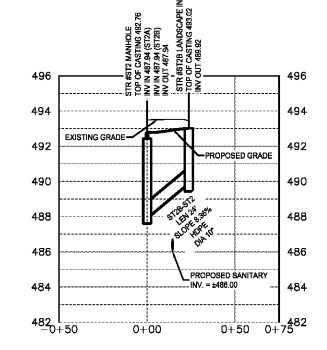

ST2B-ST2
 Horizontal Scale: 1" = 40'
 Vertical Scale: 1" = 4'

Order Plans @ www.dolline.com



617 East McBee Ave
 Suite 200
 Greenville, SC 29601
 T 864.527.0480
 GMCNETWORK.COM

ISSUE	DATE
BID DOCUMENTS	10.24.19

MILLBROOK ELEMENTARY
 SCHOOL - ADDITIONS AND
 RENOVATIONS
 255 E PINE LOG RD., AIKEN, SC 29803
GMC # CGRE190013

STORM PROFILES

C-203

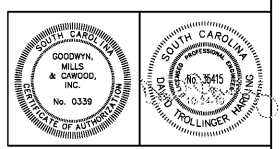

DRAWING FILE: W:\Projects\..._and Development\32797\CAD\DWG\CAD\32797_32797.dwg
 PLOT FILE: C:\Users\..._and Development\32797\CAD\DWG\CAD\32797_32797.dwg