

KEY PLAN

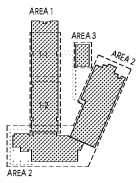

GENERAL NOTES

- A THE SITE WILL BE OCCUPIED DURING CONSTRUCTION WHICH WILL REQUIRE THE GENERAL CONTRACTOR TO PERFORM THEIR WORK IN PARALLEL WITH SCHOOL OPERATIONS. IN ORDER TO COORDINATE THESE EFFORTS AND TO ESTABLISH LIFE SAFETY STANDARDS DURING CONSTRUCTION, THE PHASING DIAGRAMS ON SHEETS G5.01-05 HAVE BEEN PROVIDED. THESE PHASING DIAGRAMS OUTLINE KEY PHASES DURING CONSTRUCTION, ESTABLISHING WHICH AREAS OF THE SITE THE GENERAL CONTRACTOR WILL HAVE ACCESS TO, DURING EACH OF THESE PHASES. THE GENERAL CONTRACTOR MUST MAINTAIN EMERGENCY EGRESS PATHS AND A SAFE SEPARATION BETWEEN THE WORK AND SCHOOL ACTIVITIES AS DETAILED IN THESE DIAGRAMS. THE GENERAL CONTRACTOR MUST ALSO PROVIDE TEMPORARY SIGNAGE TO MANAGE CIRCULATION THROUGHOUT THE SITE.
- B IT IS THE GENERAL CONTRACTOR'S SOLE RESPONSIBILITY TO ESTABLISH AND ACCOUNT FOR THE MEANS AND METHODS THAT WILL BE REQUIRED TO PERFORM THE WORK DETAILED IN THE CONSTRUCTION DOCUMENTS WHILE THE SITE IS OCCUPIED. THE GENERAL CONTRACTOR IS RESPONSIBLE FOR IDENTIFYING ALL TEMPORARY MEASURES TO ENSURE THAT UTILITIES SERVING THE SCHOOL ARE UNINTERRUPTED DURING CONSTRUCTION. THESE UTILITIES INCLUDE, BUT ARE NOT LIMITED TO, ELECTRICAL SERVICE, HVAC, PLUMBING, STORM WATER MANAGEMENT, AND GAS. THE GENERAL CONTRACTOR IS ALSO RESPONSIBLE FOR MAINTAINING EROSION CONTROL DURING EACH PHASE. ALL WORK ASSOCIATED WITH THESE REQUIREMENTS MUST BE INCLUDED IN THE BIDDING DOCUMENTS.
- C PRIOR TO THE START OF THE WORK, THE GENERAL CONTRACTOR WILL LEAD A COORDINATION MEETING WITH THE OWNER, ARCHITECT, AND THEIR CONSULTANTS TO REVIEW THE CONSTRUCTION DOCUMENTS AND THE PROJECT. AT THIS TIME, THE GENERAL CONTRACTOR MUST IDENTIFY ANY INFRASTRUCTURE OR CONSTRUCTION CONDITIONS SO THAT THOSE ITEMS CAN BE IDENTIFIED AND COORDINATED WITH THE OWNER AS REQUIRED.
- D SHOULD ANY UNEXPECTED CONDITIONS BE ENCOUNTERED THAT REQUIRE A CHANGE TO THE CONSTRUCTION DOCUMENTS, THE GENERAL CONTRACTOR MUST PROVIDE ADVANCED NOTICE TO THE OWNER AND COORDINATE A TIME FOR THE WORK TO OCCUR. ANY SERVICE TO THE EXISTING CAMPUS THAT IS INTERRUPTED WILL REQUIRE OWNER APPROVAL.
- E THE PHASING DIAGRAMS ARE FOR REFERENCE AND COORDINATION PURPOSES ONLY. IT IS THE GENERAL CONTRACTOR'S RESPONSIBILITY TO IDENTIFY ALL WORK COSTS AND THE TIME THAT WILL BE REQUIRED TO PHASE AND PERFORM THE WORK OUTLINED IN THE CONSTRUCTION DOCUMENTS WHILE THE SITE IS OCCUPIED.
- F REFERENCE SHEET 04.00 FOR THE LIFE SAFETY PLAN AND OCCUPANCY / EGRESS LOADS.
- G GENERAL CONTRACTOR RESPONSIBLE FOR COORDINATING SEQUENCING OF DEMOLITION REQUIRED TO ACCOMMODATE TEMPORARY PARKING AREAS AND BUS LOOP.

NARRATIVE - PHASE 4

PHASE 4: FEBRUARY 2021 - JUNE 2021 (DATES ARE APPROXIMATE AND SHALL BE ESTABLISHED BY THE GENERAL CONTRACTOR)

DURING THIS PHASE, THE FOLLOWING ITEMS WILL OCCUR:

- LIMITS OF CONSTRUCTION - THE CONSTRUCTION LIMITS WILL BE REVISED TO INCLUDE THE BUILDINGS ON THE WESTERN PORTION OF THE SITE TO BE DEMOLISHED.
- TEMPORARY BUS LOOP - THE TEMPORARY BUS LOOP WILL BE INACTIVE DURING THIS TIME. THE EXISTING BUS LOOP WILL BE UTILIZED INSTEAD.
- SCHOOL ACTIVITIES - THE SCHOOL, INCLUDING ALL SPACES TO REMAIN AND THE NEW CLASSROOM ADDITION, IS FULLY OCCUPIED AND FUNCTIONING.
- TEMPORARY FACILITIES - THE GENERAL CONTRACTOR WILL BE RESPONSIBLE FOR PROVIDING RESTROOM FACILITIES, INDEPENDENT OF THE SCHOOL FACILITIES, FOR ALL CONSTRUCTION STAFF. A TEMPORARY SPACE IN THE EXISTING BUILDING WILL BE PROVIDED AS A FIELD OFFICE.
- CONSTRUCTION ACTIVITIES - ALL CONSTRUCTION ACTIVITIES RELATED TO THE EXISTING BUILDINGS TO REMAIN AND THE NEW CLASSROOM ADDITION IS COMPLETE. DEMOLITION OF BUILDINGS AND SITE COMPONENTS WITHIN THE CONSTRUCTION LIMITS TO OCCUR DURING THIS PHASE. RENOVATION WORK SHOULD BEGIN, WITH THE FINAL WORK TO BE COMPLETED DURING PHASE 5.

REFERENCE 106.04 FOR ADDITIONAL INFORMATION. IT IS THE GENERAL CONTRACTOR'S RESPONSIBILITY TO ESTABLISH THE MEANS AND METHODS NOT DETAILED IN THIS DIAGRAM, BUT REQUIRED TO ACCOMPLISH THE WORK, AS OUTLINED IN THE CONSTRUCTION DOCUMENTS.

FLOOR PLAN LEGEND

- NEW DOOR
- NEW WALL
- EXISTING DOOR
- EXISTING WALL
- LINE OF OBJECT ABOVE
- GENERAL CONTRACTOR AREA
- TEMPORARY BUS LOOP: 4" #57 STONE UNDERLAID BY FILTER FABRIC
- TEMPORARY ACPSD ADMINISTRATION OFFICE
- TEMPORARY OWNER STORAGE
- TEMPORARY STAFF PARKING: 4" #57 STONE UNDERLAID BY FILTER FABRIC
- STUDENT / STAFF CIRCULATION
- EXISTING 2-HOUR RATED CONSTRUCTION
- NEW 1-HOUR RATED CONSTRUCTION
- CONSTRUCTION FENCING
- CONSTRUCTION BARRICADE PER IBC SECTION 3306.6

PHASING KEYNOTE LEGEND

Key Value	Keynote Text
P1	GENERAL CONTRACTOR'S FIELD OFFICE.
P2	GENERAL CONTRACTOR'S TOILET FACILITIES (LOCATED AT GENERAL CONTRACTOR'S DISCRETION WITHIN CONSTRUCTION ZONE).
P13	WORK IN THIS AREA IS COMPLETE PER THE CONSTRUCTION DOCUMENTS.

**1 LIFE SAFETY DURING CONSTRUCTION DIAGRAM - PHASE 4**

SCALE: 1" = 30'-0"

MILLBROOK ELEMENTARY SCHOOL - ADDITION AND RENOVATIONS  
255 E PINE LOG RD., AIKEN, SC 29803

**LIFE SAFETY DURING CONSTRUCTION DIAGRAM - PHASE 4**

**G5.04**

GMC # ACOL180004  
DRAWN BY: MJK/W  
CHECKED BY: MW/W

ISSUE DATE	BID DOCUMENTS
10/24/19	

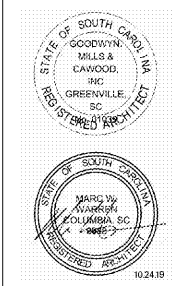

1219 Wayne Street  
Columbia, SC 29201  
T: 803.766.1235  
gmcNETWORK.COM



10/29/2019 4:33:21 AM