

10/29/2019 4:31:02 AM

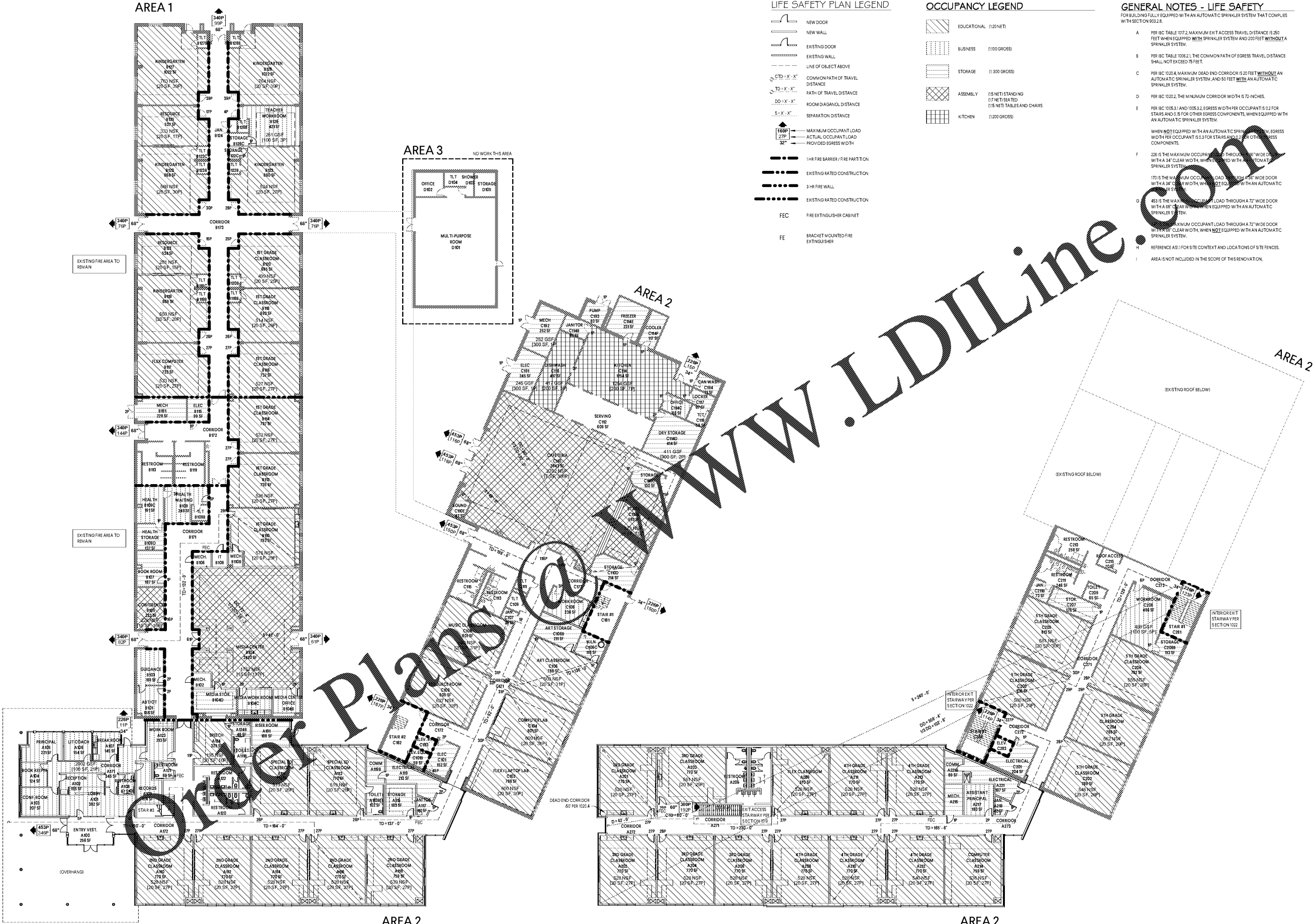

LIFE SAFETY PLAN LEGEND

- NEW DOOR
- NEW WALL
- EXISTING DOOR
- EXISTING WALL
- LINE OF OBJECT ABOVE
- COMMON PATH OF TRAVEL DISTANCE
- PATH OF TRAVEL DISTANCE
- ROOM DIAGONAL DISTANCE
- SEPARATION DISTANCE
- MAXIMUM OCCUPANT LOAD
- ACTUAL OCCUPANT LOAD
- PROVIDED EGRESS WIDTH
- 1-HR FIRE BARRIER / FIRE PARTITION
- EXISTING RATED CONSTRUCTION
- 3-HR FIRE WALL
- EXISTING RATED CONSTRUCTION
- FEC FIRE EXTINGUISHER CABINET
- FE BRACKET MOUNTED FIRE EXTINGUISHER

OCCUPANCY LEGEND

- EDUCATIONAL (120 NET)
- BUSINESS (100 GROSS)
- STORAGE (1,500 GROSS)
- ASSEMBLY (0.5 NET) STANDING (0.5 NET) TABLES AND CHAIRS
- KITCHEN (1200 GROSS)

GENERAL NOTES - LIFE SAFETY

- FOR BUILDING FULLY EQUIPPED WITH AN AUTOMATIC SPRINKLER SYSTEM THAT COMPLIES WITH SECTION 903.2.8.
- PER IBC TABLE 1017.2, MAXIMUM EXIT ACCESS TRAVEL DISTANCE IS 250 FEET WHEN EQUIPPED WITH SPRINKLER SYSTEM AND 200 FEET WITHOUT A SPRINKLER SYSTEM.
- PER IBC TABLE 1006.2.1, THE COMMON PATH OF EGRESS TRAVEL DISTANCE SHALL NOT EXCEED 75 FEET.
- PER IBC 1022.4, MAXIMUM DEAD END CORRIDOR IS 20 FEET WITHOUT AN AUTOMATIC SPRINKLER SYSTEM, AND 50 FEET WITH AN AUTOMATIC SPRINKLER SYSTEM.
- PER IBC 1022.2, THE MINIMUM CORRIDOR WIDTH IS 72 INCHES.
- PER IBC 1005.3.1 AND 1005.3.2, EGRESS WIDTH PER OCCUPANT IS 0.2 FOR STAIRS AND 0.5 FOR OTHER EGRESS COMPONENTS, WHEN EQUIPPED WITH AN AUTOMATIC SPRINKLER SYSTEM.
- WHEN NOT EQUIPPED WITH AN AUTOMATIC SPRINKLER SYSTEM, EGRESS WIDTH PER OCCUPANT IS 0.3 FOR STAIRS AND 0.5 FOR OTHER EGRESS COMPONENTS.
- 226 IS THE MAXIMUM OCCUPANT LOAD THROUGH A 36" WIDE DOOR WITH A 34" CLEAR WIDTH, WHEN EQUIPPED WITH AN AUTOMATIC SPRINKLER SYSTEM.
- 170 IS THE MAXIMUM OCCUPANT LOAD THROUGH A 36" WIDE DOOR WITH A 34" CLEAR WIDTH, WHEN NOT EQUIPPED WITH AN AUTOMATIC SPRINKLER SYSTEM.
- 453 IS THE MAXIMUM OCCUPANT LOAD THROUGH A 72" WIDE DOOR WITH A 68" CLEAR WIDTH, WHEN EQUIPPED WITH AN AUTOMATIC SPRINKLER SYSTEM.
- MAXIMUM OCCUPANT LOAD THROUGH A 72" WIDE DOOR WITH THE CLEAR WIDTH, WHEN NOT EQUIPPED WITH AN AUTOMATIC SPRINKLER SYSTEM.
- REFERENCE AS(1) FOR SITE CONTEXT AND LOCATIONS OF SITE FENCES.
- AREA IS NOT INCLUDED IN THE SCOPE OF THIS RENOVATION.

1 LIFE SAFETY PLAN - FIRST FLOOR
SCALE: 1/16"=1'-0"

2 LIFE SAFETY PLAN - SECOND FLOOR
SCALE: 1/16"=1'-0"



1219 Wayne Street
Columbia, SC 29201
T 803.766.1235
GMCNETWORK.COM

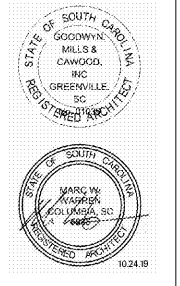

ISSUE DATE	DATE
BID DOCUMENTS	10.24.19

MILLBROOK ELEMENTARY SCHOOL - ADDITION AND RENOVATIONS
255 E PINE LOG RD., AIKEN, SC 29803
GMC # ACOL180004

LIFE SAFETY PLANS
G4.00