

Order Plans @ WWW.LDILine.com

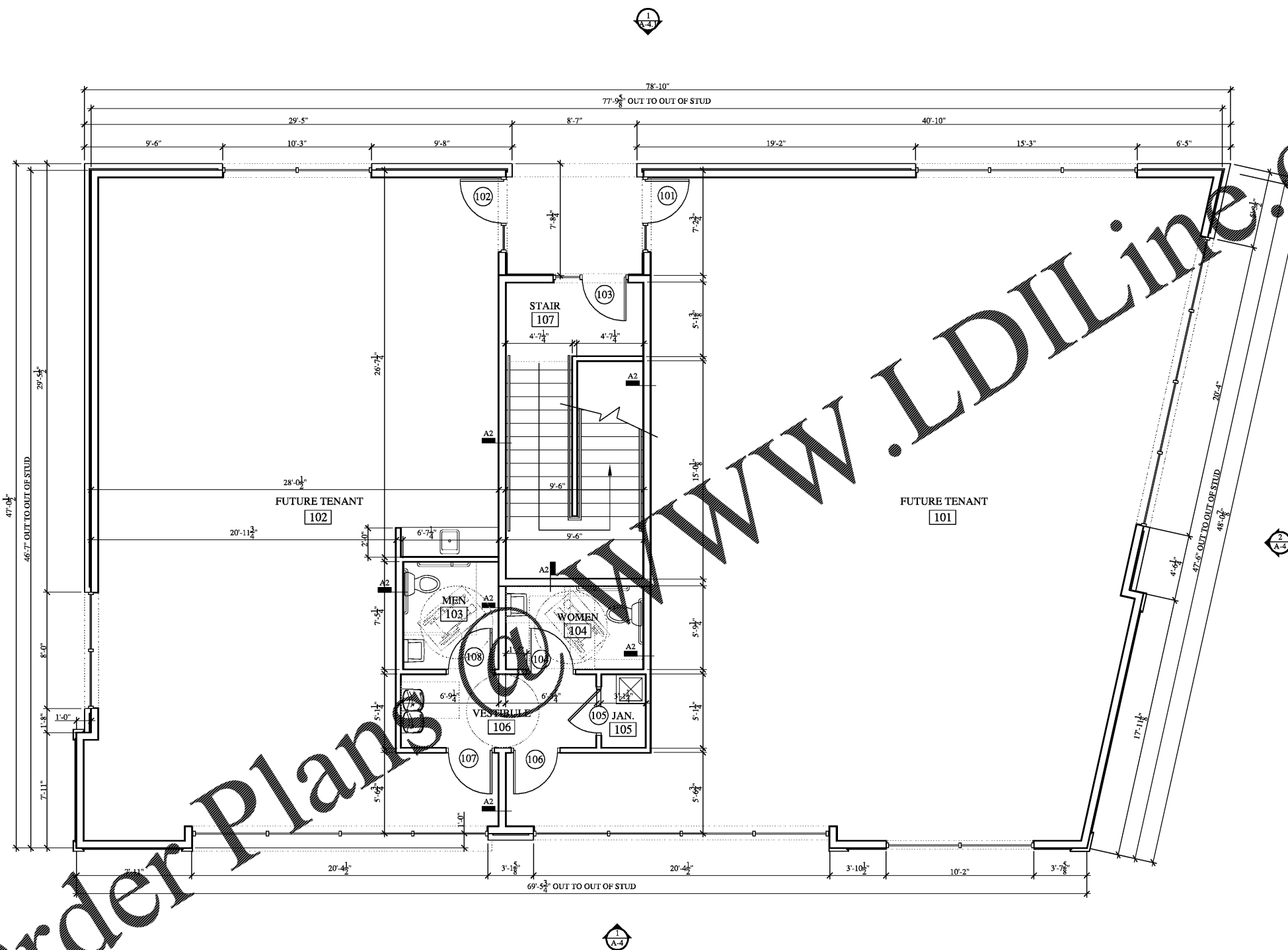

1
A-1

FIRST FLOOR PLAN
1/4" = 1'-0"

- GENERAL NOTES:**
1. INTERIOR DIMENSIONS ARE FACE TO FACE OF STUD.
 2. EXTERIOR DIMENSIONS ARE OUT TO OUT OF STUD OR OUT TO OUT OF BRICK.
 3. FIELD VERIFY ALL DIMENSIONS.
 4. BULKHEADS ARE SHOWN ON THIS PLAN AS DASHED LINES - SEE REFLECTED CEILING PLAN.

WALL LEGEND

A1 = 2 x 4 WOOD STUDS @ 16" O.C. TO BOTTOM OF TRUSSES ABOVE. INSTALL SOUND INSULATION AND 1/2" GYPSUM BOARD BOTH SIDES OF STUD

A2 = 2 X 6 WOOD STUDS @ 16" O.C. TO BOTTOM OF TRUSSES ABOVE. INSTALL R-19 BATT INSULATION AND 1/2" GYPSUM BOARD BOTH SIDES OF STUD

NOTE: ALL WALLS ARE TYPE A1 UNLESS OTHERWISE NOTED. ALL WINDOWS ARE TYPE A UNLESS OTHERWISE NOTED.

PRIEST ARCHITECTURE

PRIEST ARCHITECTURE, PLLC
1704 THE COMMONS, SUITE 100, CHARLOTTE, NC 28205
PHONE: 704.376.1400, FAX: 704.376.1400, MOBILE: 803.253.8600
EMAIL: PRIESTARCHITECT@BELLSOUTH.NET

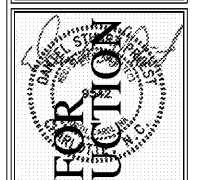

REVISIONS	
NO.	DATE

BH PECAN, LLC

904 PECAN AVENUE
CHARLOTTE, NORTH CAROLINA 28205

Project No: 1923

Scale:

Date Drawn:

Sheet Title: **FIRST FLOOR PLAN**

A-1