

TOTAL DISTURBED AREA:
0.99 AC.

GENERAL EROSION CONTROL CONSTRUCTION SEQUENCE

THE FOLLOWING CONSTRUCTION SEQUENCE IS FURNISHED AS A GENERAL GUIDE FOR PREPARATION OF A SEQUENCE OF CONSTRUCTION EVENTS. ADDITIONS, DELETIONS, AND MODIFICATIONS SHOULD BE MADE AS APPROPRIATE.

- PHASE 1:**
- OBTAIN GRADING/EROSION CONTROL PLAN APPROVAL FROM THE JOHNSTON COUNTY PUBLIC UTILITIES DEPARTMENT.
 - THE CONTRACTOR SHALL SET UP AN ON-SITE PRE-CONSTRUCTION CONFERENCE WITH TOWN EROSION CONTROL INSPECTOR TO DISCUSS EROSION CONTROL MEASURES. FAILURE TO SCHEDULE SUCH CONFERENCE 48 HOURS PRIOR TO ANY LAND DISTURBING ACTIVITY IS A VIOLATION AND IS SUBJECT TO FINE.
 - INSTALL SWPPP SIGN AND TEMPORARY CONSTRUCTION ENTRANCE.
 - CONTRACTOR TO INSTALL CONSTRUCTION ENTRANCE, SILT FENCE, AND TEMPORARY CHECK DAMS AS SHOWN ON PLANS, CLEARING ONLY AS NECESSARY TO INSTALL THESE DEVICES.
 - SCHEDULE AN ON-SITE INSPECTION BY COUNTY INSPECTOR. WHEN APPROVED, INSPECTOR ISSUES THE GRADING PERMIT AND CLEARING AND GRUBBING MAY BEGIN.
 - THE CONTRACTOR SHALL DILIGENTLY AND CONTINUOUSLY MAINTAIN ALL EROSION CONTROL DEVICES AND STRUCTURES.
- PHASE 2:**
- BEGIN EARTHWORK/GRADING ACTIVITIES. MAINTAIN AND VERTICALLY ADJUST ALL CHECK DAMS, DITCHES, AND SILT FENCE THROUGHOUT GRADING ACTIVITIES. MAINTAIN DRAINAGE PATTERNS. CONTRACTOR TO ENSURE ALL EROSION CONTROL MEASURES DO NOT ADVERSELY AFFECT CONSTRUCTIBILITY OF PROJECT.
 - AS EARTHWORK ALLOWS, BEGIN INSTALLING STORM DRAINAGE STRUCTURES AND UTILITIES. AS STORM DRAINAGE IS INSTALLED, CONTRACTOR SHALL PLACE INLET PROTECTION ON ALL STORM STRUCTURES AND REMOVE INLET PROTECTION WHEN THE EXISTING STORM DRAINAGE IS REMOVED. NO PIPES SHALL BE LEFT EXPOSED AT THE CLOSE OF BUSINESS EACH DAY.
 - DILIGENTLY AND CONTINUOUSLY MAINTAIN ALL EROSION CONTROL DEVICES AND STRUCTURES TO MINIMIZE EROSION. THE CONTRACTOR SHALL MAINTAIN CLOSE CONTACT WITH THE COUNTY INSPECTOR SO THAT PERIODIC INSPECTIONS CAN BE PERFORMED AT APPROPRIATE STAGES OF CONSTRUCTION.
 - SHADED SLOPES AND FILLS ARE TO BE PLANTED OR PROVIDED WITH PROTECTIVE COVER SUFFICIENT TO RESTRAIN EROSION WITHIN 7 CALENDAR DAYS AFTER THE COMPLETION OF ANY PHASE OF GRADING. ALL AREAS UPON WHICH NO FURTHER LAND DISTURBING ACTIVITY WILL BE UNDERTAKEN ARE TO BE PLANTED OR PROVIDED WITH PROTECTIVE COVER WITHIN 14 CALENDAR DAYS.
 - ALL EROSION CONTROL MEASURES SHALL BE CONSTRUCTED IN ACCORDANCE WITH THE N.C. EROSION AND SEDIMENT CONTROL PLANNING AND DESIGN MANUAL, U.S. DEPT. OF AGRICULTURE, JOHNSTON COUNTY EROSION CONTROL ORDINANCE, AND THE JOHNSTON COUNTY LAND DEVELOPMENT STANDARDS MANUAL.
 - AS AREAS ARE BROUGHT TO FINISHED GRADE, CONTRACTOR TO INSTALL FINAL GRASSING AND STABILIZE ALL SLOPES PER THE EROSION CONTROL NOTES AND DETAILS AND LANDSCAPE PLAN AND DETAILS.
 - CONTRACTOR SHALL COORDINATE WITH THE EROSION CONTROL INSPECTOR PRIOR TO REMOVAL OF EROSION CONTROL MEASURES.

GENERAL NOTES:

- SEE SHEET C0-1 GENERAL NOTES FOR GENERAL EROSION CONTROL NOTES.
- CONTRACTOR SHALL ENSURE THAT ALL BORROW AND WASTE DISPOSAL SITES MEET ALL LOCAL AND STATE EROSION CONTROL AND PERMIT REQUIREMENTS.
- TEMPORARY SEEDING TO BE PROVIDED PER TEMPORARY SEEDING SCHEDULE ON EROSION CONTROL DETAILS. SEE SHEET C1-2.
- PERMANENT SEEDING TO BE PROVIDED PER SPECIFICATIONS ON LANDSCAPE PLAN. SEE SHEET L1-0.
- SEE SHEET C1-3 FOR INFORMATION ON SELF INSPECTION AND MONITORING REQUIREMENTS PER NCDEQ REGULATIONS.
- SEE SHEET C1-4 FOR INFORMATION ON STABILIZATION AND POLLUTION PREVENTION REQUIREMENTS PER NCDEQ REGULATIONS.

EROSION CONTROL LEGEND

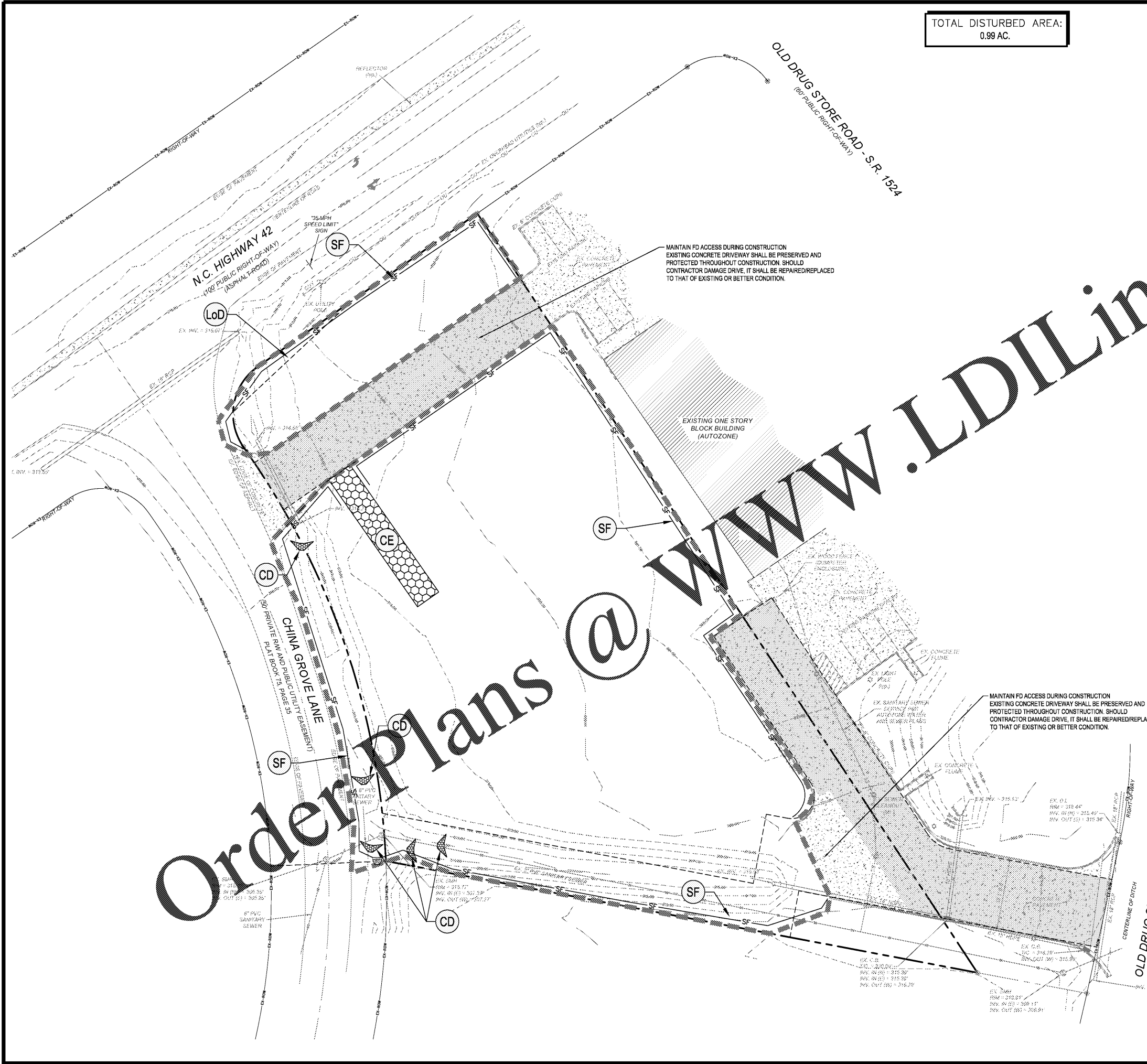
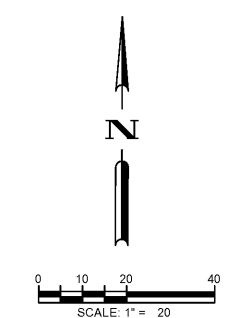
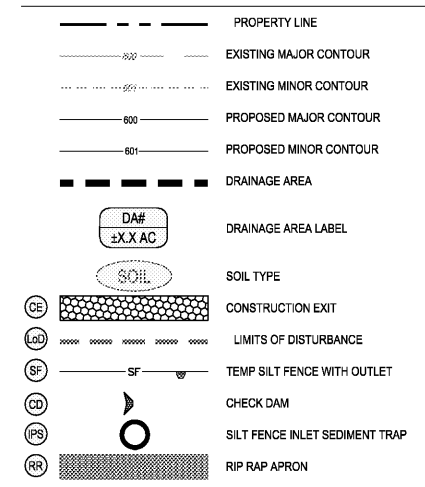

DESIGNED BY: DMH	REVIEWED BY: ECH
DATE: 10/22/19	REVISED PER STAFF COMMENTS
DESCRIPTION	

121 W. TRADE STREET, SUITE 1030
 CHARLOTTE, NC 28202
 www.bceinc.com
 © 2019
 NC LICENSE #C-437

ROCK PROPERTIES, INC.
 145 LINCOLN AVENUE, SUITE B
 WINTER PARK, FL 32789
 GARNER, JOHNSTON COUNTY, NC 27529

EROSION CONTROL
 PLAN PHASE 1

FILE NUMBER:
 6191-01
 DATE: 07/24/19
 C1-0