

- KEYNOTES**
- ① PIPING W/ SHUT-OFF VALVE DN IN WALL OR CHASE TO FIXTURE(S), SIZE AS NOTED.
 - ② 1/2" VALVED HW TO DW CONNECTION W/WATER HAULING ARRESTOR (SIOUX CHIEF 'MINI-RESTER', SERIES 660, SIZE 1/2").
 - ③ 1/2" CW TO TRAP PRIMER (TP-A) WITH 1/2" TP LINE TO DRAIN.

CROSSFIELDS
CHIROPRACTIC OFFICE DESIGN

3265 Brannan Parkway, Suite 3015
Duluth, GA 30116
Office: 770.424.9220
Web: www.ChiropracticOfficeDesign.com



THIS DRAWING IS THE PROPERTY OF CROSSFIELDS, INC. AND ANY REPRODUCTION OR COPYING OF THIS DRAWING, IN WHOLE OR PART IS PROHIBITED WITHOUT WRITTEN PERMISSION.

INNOVATION
COMPOUNDING
DR. SHAWN HODGES
6095 PINE MOUNTAIN RD., SUITE 104
KENNESAW, GA 30152

REVISIONS:

NO.	DATE	DESCRIPTION

DRAWN BY: DS
CHECKED BY: MR
DATE: 09.24.19
PROJECT NUMBER: 17125-IC
SHEET NO:

P1.2B

ISSUED FOR PERMITTING

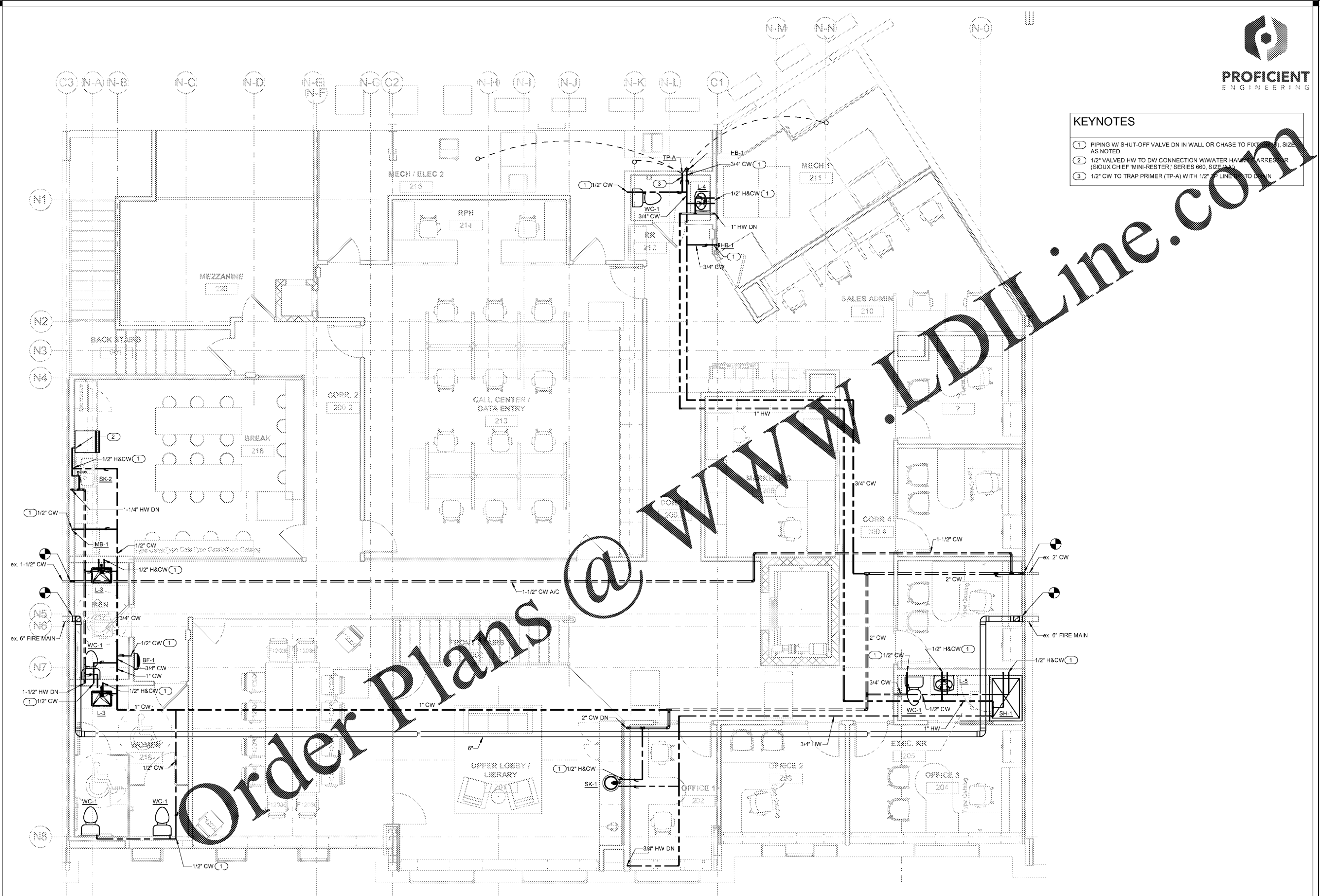

1 2ND FLOOR PLAN - SUPPLY
P1.2B 1/4" = 1'-0"

Order Plans @ www.LDILine.com