



THIS DRAWING IS THE PROPERTY OF CROSSFIELDS, INC. AND ANY REPRODUCTION OR COPYING OF THIS DRAWING, IN WHOLE OR PART IS PROHIBITED WITHOUT WRITTEN PERMISSION.

**INNOVATION
COMPOUNDING
DR. SHAWN HODGES**
6095 PINE MOUNTAIN RD. SUITE 104
KENNESAW, GA 30152

REVISIONS:

NO.	DATE	DESCRIPTION

DRAWN BY: **AT** CHECKED BY: **BA**
DATE: **09.24.19**
PROJECT NUMBER: **17125-IC**
SHEET NO:

E3.1

ISSUED FOR PERMITTING

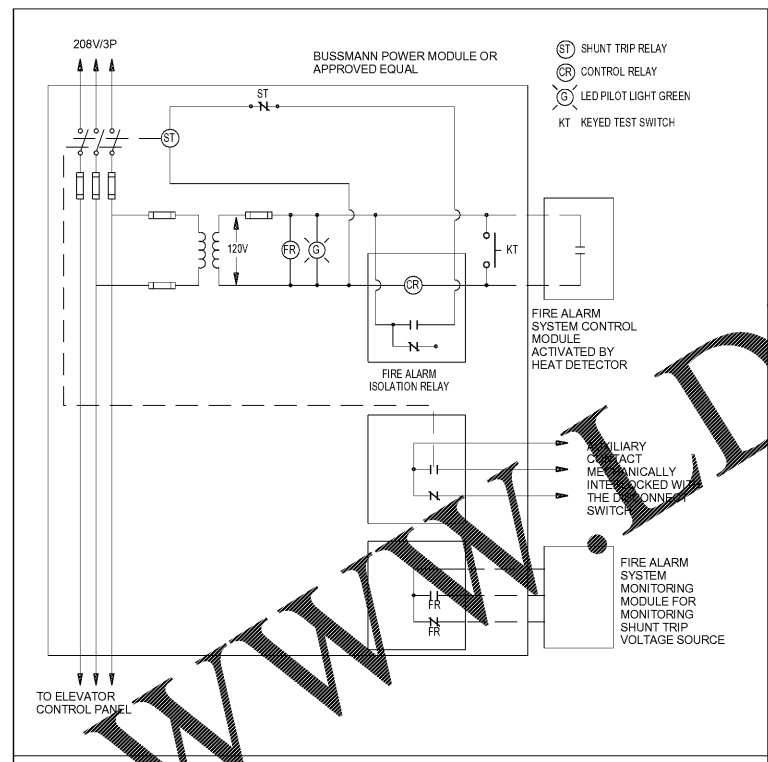

GENERAL NOTES

ALL ELECTRICAL DEVICES, FOR THEIR SIZES AND LOCATIONS, ASSOCIATED WITH ELEVATOR EQUIPMENT SHALL BE COORDINATED WITH ELEVATOR MANUFACTURER PRIOR TO INSTALLATION.

B. CONTRACTOR SHALL PROVIDE ALL LIGHTS, DISCONNECTS AND CONNECTIONS AS REQUIRED BY ELEVATOR MANUFACTURER FOR ELEVATOR EQUIPMENT INSTALLATION.

C. CONTRACTOR SHALL COORDINATE ALL FINAL VOLTAGE, AMPACITY AND PHASE REQUIREMENTS WITH THE ELEVATOR MANUFACTURER.

KEYNOTES

- GFCI DUPLEX RECEPTACLE. PROVIDE ONE AT THE PIT AND ANOTHER AT THE TOP OF THE SHAFT.
- LIGHTING SHALL NOT BE CONNECTED TO LOAD SIDE OF GFCI RECEPTACLE. PROVIDE LIGHTING FIXTURES AT THE PIT AND AT THE TOP OF THE SHAFT.
- ELEVATOR CONTROL PANEL.
- 30A/1P/NEMA 1 DISCONNECT SWITCH WITH 20 AMP FUSE FOR ELEVATOR CAB LIGHTING AND FAN.
- 3P, 208VAC 20HP ELEVATOR MOTOR. COORDINATE WITH ELEVATOR MANUFACTURER EXACT MODEL AND FINAL RECOMMENDED FUSE SIZE. COORDINATE EXACT LOCATION IN FIELD.
- 100A/3P/NEMA 3R EQUIPMENT DISCONNECT SWITCH AND 80 AMP FUSE FOR ELEVATOR MOTOR. COORDINATE WITH ELEVATOR MANUFACTURER FOR FINAL RECOMMENDED FUSE SIZE.
- PROVIDE LIGHT SWITCHES AT PIT LEVEL AND AT TOP OF THE SHAFT. EACH SWITCH SHALL CONTROL EACH RESPECTIVE LIGHT FIXTURE.
- POWER FOR SUMP PUMP. SEE PLUMBING DRAWINGS FOR ADDITIONAL REQUIREMENTS.

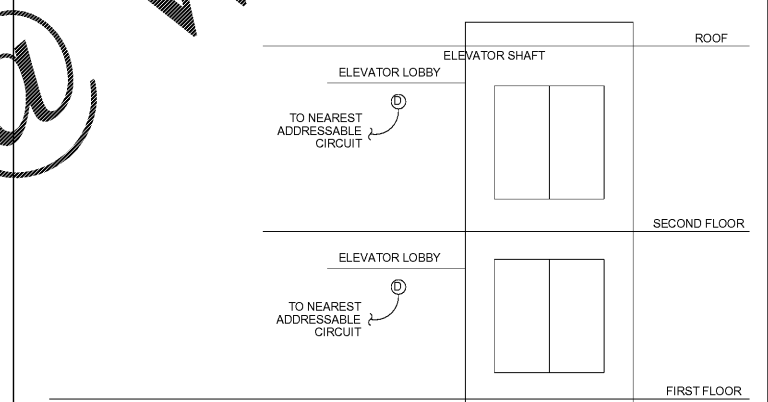

SEQUENCE KEYNOTES:

- FIRE ALARM SYSTEM MODULE MONITORING SHUNT TRIP VOLTAGE SOURCE.

RISER NOTES:

- ELEVATOR RECALL PHASE 1
 - CONTROL MODULE 1: RECALL ELEVATOR TO ALTERNATE FLOOR IF SMOKE DETECTOR IN LOBBY OF DESIGNATED FLOOR IS IN ALARM.
 - CONTROL MODULE 2: RECALL ELEVATOR TO DESIGNATED FLOOR.
- ELEVATOR SHUTDOWN
 - CONTROL MODULE 3: RECALL ELEVATOR TO NEAREST SAFE FLOOR. ACTIVATED BY SMOKE DETECTORS IN ELEVATOR EQUIPMENT ROOM AND/OR HOIST WAY.
 - CONTROL MODULE 4: SHUT DOWN POWER TO ELEVATOR. ACTIVATED BY HEAT DETECTORS IN ELEVATOR EQUIPMENT ROOM AND/OR HOIST WAY.
- VERIFY ALL CONTROL MODULE PROGRAMMING INCLUDING ALTERNATE AND DESIGNATED FLOOR WITH AHJ.

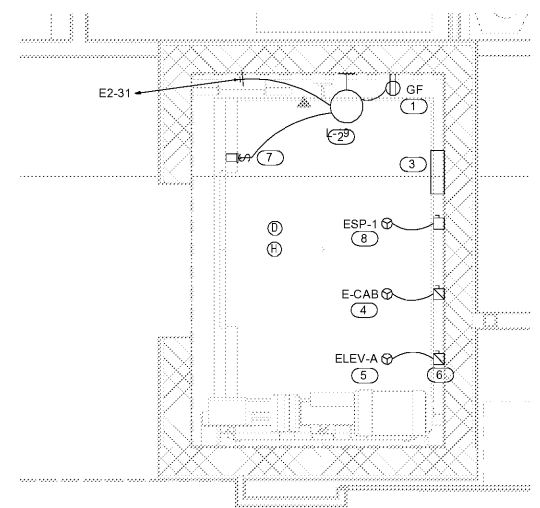

1 ELEVATOR
1/2" = 1'-0"

Order Plans @ www.Dine.com