

COMPONENTS & CLADDING WIND PRESSURES
1/16" = 1'-0"

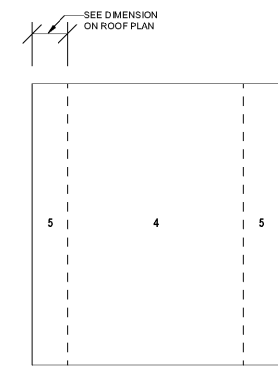

TYPICAL WALL ELEVATION

WIND DESIGN PRESSURES FOR COMPONENTS & CLADDING (PSF)					
	ZONE	Effective Wind Area (ft ²)			
		10	20	50	100
ROOF	1	-28	-28	-27	-26
	2	-47	-42	-36	-30
	3	-71	-59	-42	-30
	OVERHANG	-55	-44	-29	-18
CANOPY	-70	-58	-42	-30	
WALL	4	-30	-29	-28	-26
	5	-38	-35	-32	-29

* Wind loads shown are strength level, multiply by 0.6 to obtain service level loads.

WIND PRESSURES FOR COMPONENTS & CLADDING1
1/2" = 1'-0"

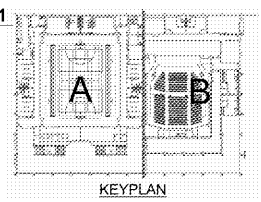

Order Plans @

WWW.LDILine.com

SA&E PROJECT NUMBER	01-615-056
BID PACKAGE	BP-1
ISSUED FOR CONSTRUCTION	10/15/2019
Southern AE 7951 Troon Circle Austell, Ga 30168 (770) 819-7777 architects & engineers	REVISIONS
	R # Doc # Date
FACILITY CODE NUMBER: 674-0110 GYMNASIUM/AUDITORIUM FOR: HEARD COUNTY SCHOOLS 545 MAIN STREET, FRANKLIN, GA 30217 HEARD COUNTY SCHOOL SYSTEM FRANKLIN, GEORGIA	
COMPONENTS & CLADDING PLAN	
	DRAWING NUMBER
	S601