

LEGEND TO WALLS:

- LEGEND TO WALLS PROVIDES INFORMATION ON INTERIOR WALLS AND WALL RATINGS. REFER ALSO TO FLOOR PLANS, BUILDING SECTIONS, WALL SECTIONS AND WALL DETAILS FOR ADDITIONAL INFORMATION ON INTERIOR WALLS. REFER TO ELEVATIONS, BUILDING SECTIONS, WALL SECTIONS AND WALL DETAILS FOR INFORMATION ON EXTERIOR WALLS.
- REFER TO DRAWING A701 FOR FIRESTOPPING DETAILS.
- REFER TO DRAWING A702 & A703 FOR TYPICAL U.L. DESIGN DETAILS.
- CONTRACTOR SHALL CONSTRUCT ALL WALLS AS INDICATED ON DRAWINGS. CHANGES TO WALL DESIGN IS NOT ALLOWED WITHOUT APPROVAL OF ARCHITECT.

- ENVIRONMENTAL WALLS - - - - -
- SMOKE RATED WALLS - - - - -
- ONE HOUR RATED WALLS - - - - -
- TWO HOUR RATED WALLS - - - - -

LEGEND TO REFLECTED CEILING PLAN:

- Acoustic Panel Ceilings
- 2' x 4' Recessed Fluorescent Fixture
- 2' x 4' Recessed Fluorescent Emergency Fixture
- Surface Mounted Fluorescent Fixture
- 2' x 2' Recessed Fluorescent Fixture
- Fluorescent Strip Fixture
- Pendant Mount Hi-Bay Fixture
- Emergency Light Fixture
- Exit Light Fixture
- 2' x 2' HVAC Return Air Grille
- 2' x 2' HVAC Supply Diffuser
- Ceiling Unit Heater
- HVAC Exhaust Fan
- Ceiling Speaker Unit
- Public Address System
- Ceiling Spot Elevation
See also Finish Schedule

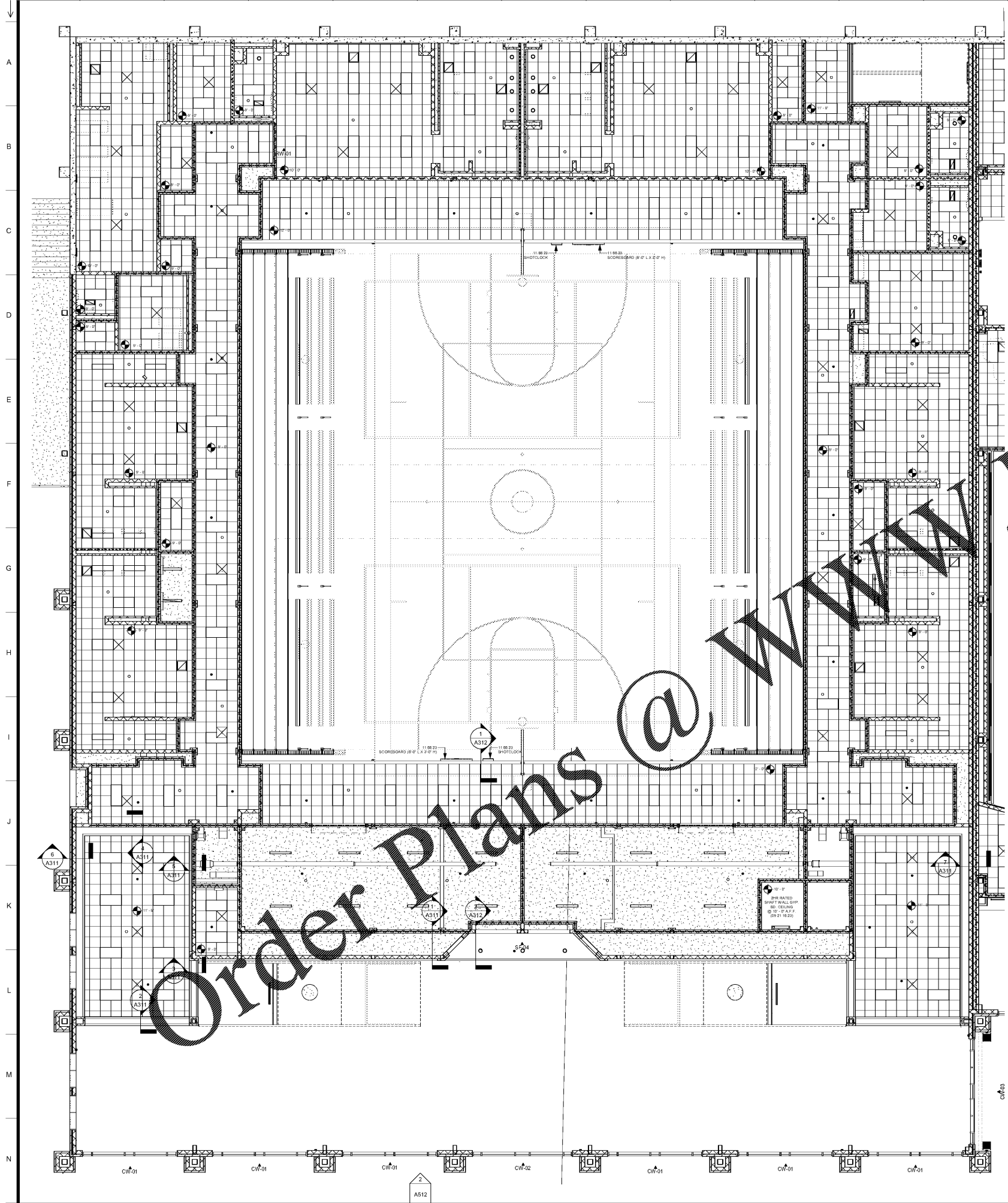

Order Plans @ www.LDILine.com

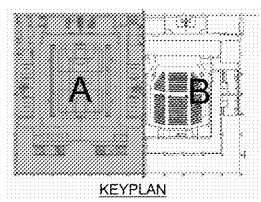
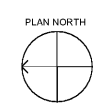

| SA&E PROJECT NUMBER | 01-615-056 | | | | | |
|---|--|-----------|-------|------|---|-----|
| BID PACKAGE | BP-1 | | | | | |
| ISSUED FOR CONSTRUCTION | 10/15/2019 | | | | | |
| Southern AE 7951 Tricon Circle Austell, Ga 30168 (770) 819-7777 architects & engineers | REVISIONS | | | | | |
| | <table border="1"> <thead> <tr> <th>R #</th> <th>Doc #</th> <th>Date</th> </tr> </thead> <tbody> <tr> <td>1</td> <td>AD1</td> <td>11.4.2019</td> </tr> </tbody> </table> | R # | Doc # | Date | 1 | AD1 |
| R # | Doc # | Date | | | | |
| 1 | AD1 | 11.4.2019 | | | | |
| FACILITY CODE NUMBER: 674-0110 GYMNASIUM/AUDITORIUM FOR: HEARD COUNTY SCHOOLS 545 MAIN STREET, FRANKLIN, GA 30217 HEARD COUNTY SCHOOL SYSTEM FRANKLIN, GEORGIA | | | | | | |
| REFLECTED CEILING PLAN - LEVEL 01 - GYMNASIUM | | | | | | |
| | DRAWING NUMBER | | | | | |
| | A105 | | | | | |

REFLECTED CEILING PLAN - LEVEL 01 - GYMNASIUM
1/8" = 1'-0"