

- STORM DRAINAGE NOTES:**
1. ALL HEADWALLS SHALL BE ENERGY DISSIPATING HEADWALLS.
 2. CONTRACTOR SHALL INSTALL RIP-RAP OUTLET PROTECTION AT ALL HEADWALLS UNLESS NOTED OTHERWISE.
 3. ALL STORM GRATES IN A CONCRETE/PEDESTRIAN CONCOURSE AREA SHALL BE ADA COMPLIANT STORM GRATES.
 4. ALL STORM PIPE SHALL BE HDPE DOUBLE WALLED SMOOTH INTERIOR STORM PIPES UNLESS NOTED OTHERWISE.
 5. CONTRACTOR SHALL COORDINATE WITH SEWER, WATER, GAS ETC. INSTALL ON ALL CROSSINGS.
 6. ALL STORM PIPE SHALL BE INSTALLED PER MANUFACTURER RECOMMENDATIONS.

- GRADING NOTES:**
1. GRADES SHOWN REPRESENT FINISH ELEVATIONS.
 2. CONTRACTOR TO DEDUCT FOR SUB-GRADE ELEVATIONS.
 3. CONTRACTOR TO SEED ALL AREAS DISTURBED IN CONSTRUCTION AREA, INCLUDING AREAS WITHOUT TOPSOIL.
 4. CONTRACTOR TO STRIP TOPSOIL AND STOCK PILE ON-SITE FOR USE IN THE LANDSCAPED/SEEDED AREAS.
 5. CONTRACTOR SHALL BE DISPOSE OF ALL EXCESS MATERIAL OFF-SITE IF THIS SITE DOES NOT BALANCE.
 6. CONTRACTOR SHALL BE RESPONSIBLE FOR BACKFILLING CURBS AND SPREADING TOPSOIL IN SAME AREA. ANY EXCESS SOIL SHALL BE DISPOSED OF OFF-SITE, SPREAD, SMOOTHED AND GRASSED. ANY ADDITIONAL SOIL NEEDED FOR BACKFILLING SHALL BE OBTAINED FROM ON-SITE (COORDINATE WITH OWNER).
 7. EROSION CONTROL MEASURES SHALL BE IN PLACE PRIOR TO THE COMMENCEMENT OF ANY GRADING OR CLEARING.
 8. ALL GRATES, MANHOLE COVERS, RINGS AND OTHER ACCESSORIES SHOWN ON DETAILS SHALL BE PROVIDED UNLESS MARKED N.I.C.
 9. ALL PIPES SHALL BE GROUTED INSIDE AND OUTSIDE OF STRUCTURES. PIPES SHALL BE GROUTED OUTSIDE STRUCTURE PRIOR TO BACK-FILLING.
 10. CONTRACTOR TO GRADE GRASSED AREAS TO MATCH GRADES SHOWN AND MAINTAIN BUILDING AND PAVED AREA GRADES.
 11. ANY SOIL NOT RE-SPREAD ON-SITE SHALL BE DISPOSED OF OFF-SITE.
 12. ALL SPOT GRADES ALONG CURB AND GUTTER ARE TO BOTTOM OF CURB UNLESS OTHERWISE NOTED. (NOT SUBGRADE ELEVATION).

GRADING LEGEND:

	BUILDING
	CURB & GUTTER
	EXISTING CONTOURS
	PROPOSED CONTOURS
	PROPOSED SPOT ELEVATIONS
	GRATE INLET
	JUNCTION BOX
	OUTLET CONTROL STRUCTURE
	DRAINAGE SLOPE
	CONSTRUCTION/CLEARING LIMITS
	TOP OF WALL
	BOTTOM OF WALL (NOT TOP OF FOOTING)



SA&E PROJECT NUMBER	01-615-056	
BID PACKAGE/PHASING	BP-1	
ISSUED FOR CONSTRUCTION	10/15/2019	
REVISIONS		
R #	Doc #	Date
1	AD1	11.4.2019

FACILITY CODE NUMBER: 674-0110
 GYMNASIUM/AUDITORIUM FOR:
HEARD COUNTY SCHOOLS
 545 MAIN STREET, FRANKLIN, GA 30217
HEARD COUNTY SCHOOL SYSTEM
 FRANKLIN, GEORGIA

STORM DRAINAGE PLAN

DRAWING NUMBER
C104

CAUTION:

THE UTILITIES SHOWN ARE SHOWN FOR THE CONTRACTOR'S CONVENIENCE ONLY. OTHER UTILITIES MAY BE PRESENT BUT NOT SHOWN ON THESE DRAWINGS. THE ARCHITECT & ENGINEER ASSUME NO RESPONSIBILITY FOR THE UTILITY LOCATIONS SHOWN, AND IT SHALL BE THE CONTRACTOR'S RESPONSIBILITY TO DETERMINE THE EXACT LOCATIONS OF ALL UTILITIES WITHIN THE LIMITS OF THE WORK. ALL DAMAGE MADE TO THE EXISTING UTILITIES BY THE CONTRACTOR SHALL BE REPAIRED TO A "LIKE NEW" CONDITION. THE CONTRACTOR SHALL BEAR THE SOLE RESPONSIBILITY FOR ANY LOSSES THAT OCCUR FROM DAMAGES TO THE EXISTING UTILITIES.

Know what's below.
 Call before you dig.
Dial 811.
GEORGIA
 811 or 1-800-282-7411
 www.Georgia811.com

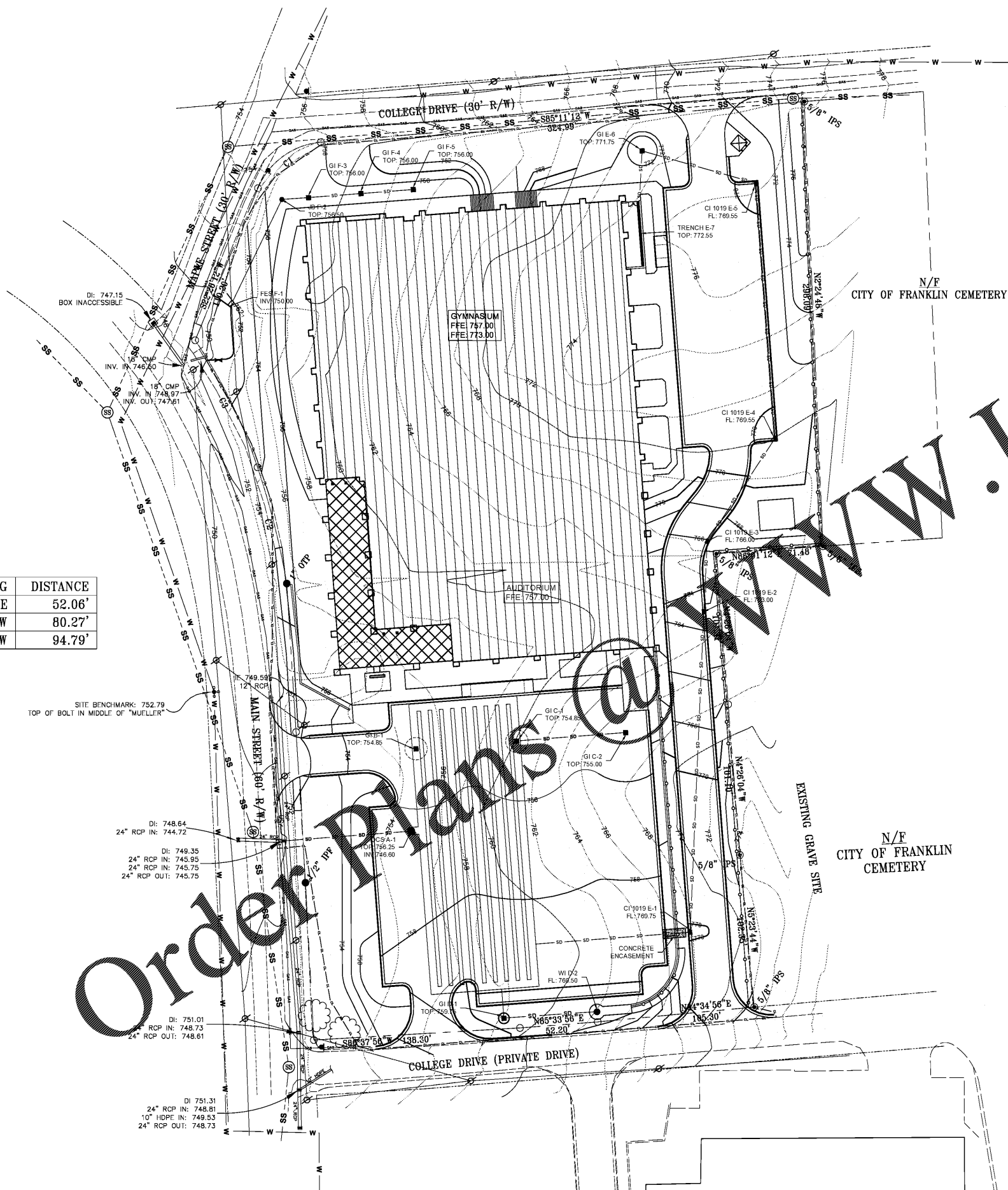

BEARING	DISTANCE
S56°37'30"E	52.06'
N11°17'27"W	80.27'
S23°20'24"W	94.79'

Order Plans @ www.LDILine.com