

INTERIOR FINISH SCHEDULE

| ROOM NUMBER | ROOM NAME           | FLOOR FINISH         | BASE FINISH          | WALL FINISH   | WAINSCOTT/WALL ACCENTS | CEILING FINISH         | Ceiling Height | COMMENTS                                  |
|-------------|---------------------|----------------------|----------------------|---------------|------------------------|------------------------|----------------|---|
| 101         | MR. KAY             | CARPET TILE          | RUBBER               | PAINTED       |                        | 2x2 ACOUST. TILE       | 9'-0"          |   |
| 102         | CLOSET              | CARPET TILE          | RUBBER               | PAINTED       |                        | 2x2 ACOUST. TILE       | 9'-0"          |   |
| 103         | T.L.T.              | RESINOUS VINYL FLAKE | RESINOUS VINYL FLAKE | EPOXY PAINTED |                        | MOISTURE RESISTANT ACT | 9'-0"          |   |
| 104         | CONFERENCE          | LVT                  | RUBBER               | PAINTED       |                        | 2x2 ACOUST. TILE       | 9'-0"          |   |
| 105         | MIKE                | CARPET TILE          | RUBBER               | PAINTED       |                        | 2x2 ACOUST. TILE       | 9'-0"          |   |
| 106         | MARIANNE            | CARPET TILE          | RUBBER               | PAINTED       |                        | 2x2 ACOUST. TILE       | 9'-0"          |   |
| 107         | SHERI               | CARPET TILE          | RUBBER               | PAINTED       |                        | 2x2 ACOUST. TILE       | 9'-0"          |   |
| 108         | SJSAN               | CARPET TILE          | RUBBER               | PAINTED       |                        | 2x2 ACOUST. TILE       | 9'-0"          |   |
| 109         | SABRINA             | CARPET TILE          | RUBBER               | PAINTED       |                        | 2x2 ACOUST. TILE       | 9'-0"          |   |
| 110         | MELISSA             | CARPET TILE          | RUBBER               | PAINTED       |                        | 2x2 ACOUST. TILE       | 9'-0"          |   |
| 111         | LADONNA             | CARPET TILE          | RUBBER               | PAINTED       |                        | 2x2 ACOUST. TILE       | 9'-0"          |   |
| 112         | CLOS.               | CARPET TILE          | RUBBER               | PAINTED       |                        | 2x2 ACOUST. TILE       | 9'-0"          |   |
| 113         | STAIR               | CONCRETE RISER/TREAD | RUBBER               | PAINTED       |                        | 2x2 ACOUST. TILE       |                |   |
| 115         | MEN                 | RESINOUS VINYL FLAKE | RESINOUS VINYL FLAKE | EPOXY PAINTED |                        | MOISTURE RESISTANT ACT | 9'-0"          |   |
| 116         | WOMEN               | RESINOUS VINYL FLAKE | RESINOUS VINYL FLAKE | EPOXY PAINTED |                        | MOISTURE RESISTANT ACT | 9'-0"          |   |
| 117         | JENNIFER            | LVT                  | RUBBER               | PAINTED       |                        | 2x2 ACOUST. TILE       | 9'-0"          | REFER TO 2/A501 & 3/A602 FOR WALL GRAPHIC |
| 118         | WAITING             | LVT                  | RUBBER               | PAINTED       |                        | 2x2 ACOUST. TILE       | 9'-0"          |   |
| 119         | TAMMY               | LVT                  | RUBBER               | PAINTED       |                        | 2x2 ACOUST. TILE       | 9'-0"          | REFER TO 2/A501 & 3/A602 FOR WALL GRAPHIC |
| 120         | CONFERENCE          | CARPET TILE          | RUBBER               | PAINTED       |                        | 2x2 ACOUST. TILE       | 9'-0"          |   |
| 121         | VEST.               | LVT                  | RUBBER               | PAINTED       |                        | 2x2 ACOUST. TILE       | 9'-0"          |   |
| 122         | BOARD/TRAINING ROOM | LVT                  | RUBBER               | PAINTED       |                        | 2x2 ACOUST. TILE       | 10'-4"         |   |
| 123         | STORAGE             | SEALED CONCRETE      | RUBBER               | PAINTED       |                        | 2x2 ACOUST. TILE       | 9'-0"          |   |
| 124         | DATA                | SEALED CONCRETE      | RUBBER               | PAINTED       |                        | 2x2 ACOUST. TILE       | 9'-0"          |   |
| 125         | ANITA               | CARPET TILE          | RUBBER               | PAINTED       |                        | 2x2 ACOUST. TILE       | 9'-0"          |   |
| 126         | FILES               | CARPET TILE          | RUBBER               | PAINTED       |                        | 2x2 ACOUST. TILE       | 9'-0"          |   |
| 127         | COPY/COFFEE         | LVT                  | RUBBER               | PAINTED       |                        | 2x2 ACOUST. TILE       | 9'-0"          |   |
| 128         | CORRIDOR            | LVT                  | RUBBER               | PAINTED       |                        | 2x2 ACOUST. TILE       | 9'-0"          |   |
| 129         | ELEC.               | SEALED CONCRETE      |                      |               |                        |                        |                |   |
| 130         | MECH.               | SEALED CONCRETE      |                      |               |                        |                        |                |   |
| 201         | MULTI-PURPOSE ROOM  | LVT                  | RUBBER               | PAINTED       |                        | 2x2 ACOUST. TILE       | 12'-0"         |   |
| 202         | KITCHEN             | LVT                  | RUBBER               | PAINTED       |                        | 2x2 ACOUST. TILE       | 9'-0"          |   |
| 203         | STORAGE             | SEALED CONCRETE      | RUBBER               | PAINTED       |                        | 2x2 ACOUST. TILE       | 9'-0"          |   |
| 204         | CUSTODIAL           | SEALED CONCRETE      | RUBBER               | EPOXY PAINTED |                        | MOISTURE RESISTANT ACT | 9'-0"          |   |
| 205         | WOMEN               | RESINOUS VINYL FLAKE | RESINOUS VINYL FLAKE | EPOXY PAINTED |                        | MOISTURE RESISTANT ACT | 9'-0"          |   |
| 206         | MEN                 | RESINOUS VINYL FLAKE | RESINOUS VINYL FLAKE | EPOXY PAINTED |                        | MOISTURE RESISTANT ACT | 9'-0"          |   |
| 207         | MACHINE             | SEALED CONCRETE      | RUBBER               | PAINTED       |                        |                        |                |   |

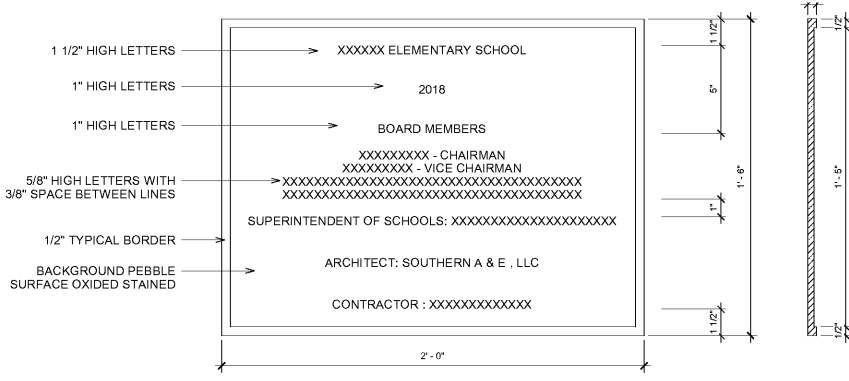

10 14 16. CAST PLAQUE

1 CAST PLAQUE  
3" = 1'-0"

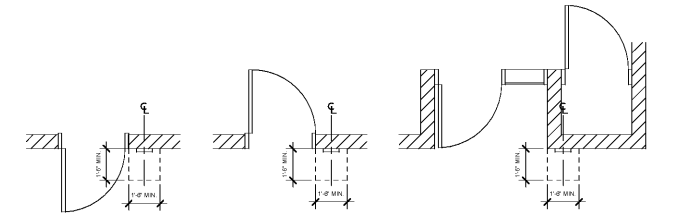

LOCATION OF PANEL SIGNS AT DOORS  
N.T.S.

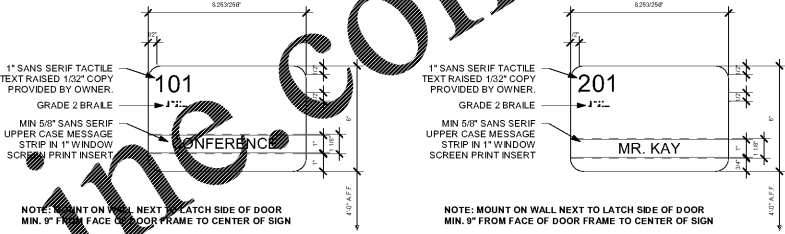

10 14 23. SIGN TYPE "A1"

10 14 23. SIGN TYPE "A2"

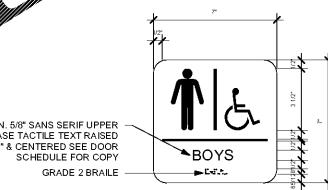

10 14 23. SIGN TYPE "C1"

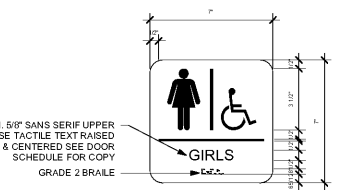

10 14 23. SIGN TYPE "C2"

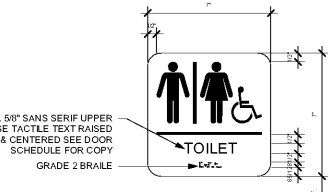

10 14 23. SIGN TYPE "C3"

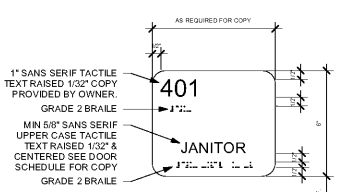

10 14 23. SIGN TYPE "B"

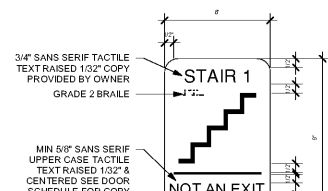

10 14 23. SIGN TYPE "S"

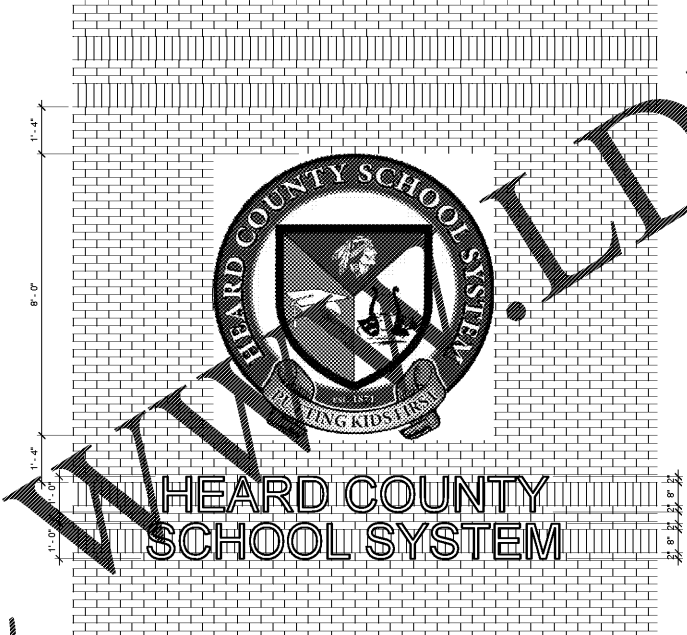

2 EXTERIOR WALL SIGNAGE & DIMENSIONAL LETTERS  
1/2" = 1'-0"

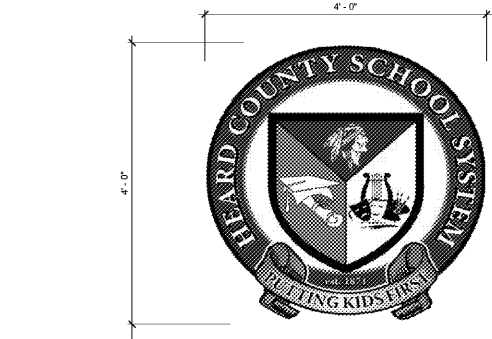

3 INTERIOR RECEPTION WALL GRAPHIC  
1" = 1'-0"

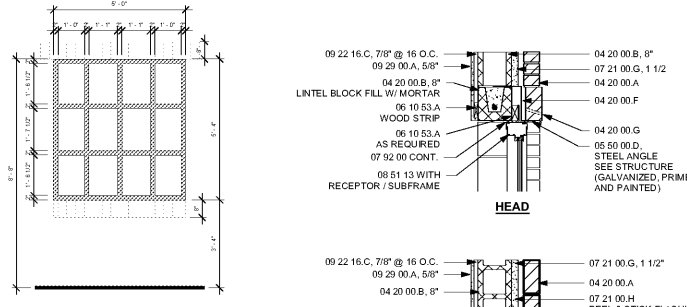

|          |                    |
|----------|--------------------|
| WINDOW   | AL-01              |
| MATERIAL | ALUMINUM           |
| TYPE     | FIXED              |
| RATING   | NONE               |
| SPEC.    | 08 51 13           |
| DETAILS  | 4/A602             |
| GLASS    | INSULATED/TEMPERED |

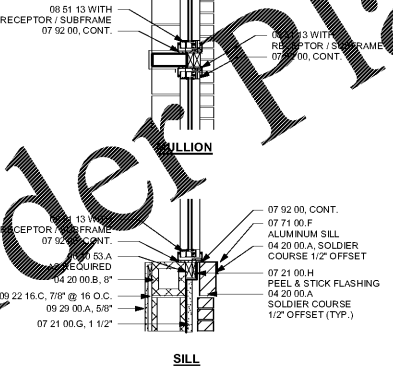

4 ALUMINUM WINDOW DETAILS  
3/4" = 1'-0"

Order Plans @

|  |            |      |
|--|------------|------|
| S&E PROJECT NUMBER   | 01-615-057 |      |
| BID PACKAGE / PHASING  | BP-1       |      |
| ISSUED FOR CONSTRUCTION  | 10/15/2019 |      |
| REVISIONS  |            |      |
| R #  | Doc #      | Date |
| Southern A&E<br>7951 Truon Circle<br>Austell, Ga 30168<br>(770) 519-7777<br>architects & engineers |            |      |

ADD ALTERNATE #1  
BOARD OF EDUCATION OFFICE FOR:  
**HEARD COUNTY SCHOOLS**  
4647 PEA RIDGE ROAD, FRANKLIN, GA 30217  
HEARD COUNTY SCHOOL SYSTEM  
FRANKLIN, GEORGIA

|                |      |
|----------------|------|
| SCHEDULES      |      |
| DRAWING NUMBER | A602 |