

A
B
C
D
E
F
G
H
I
A
K
L
M
N

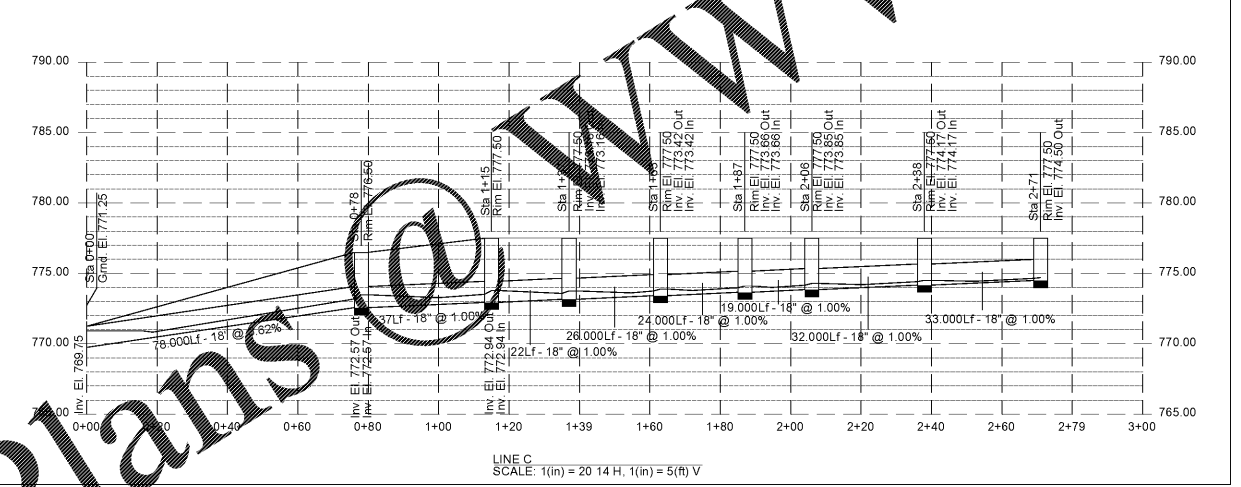
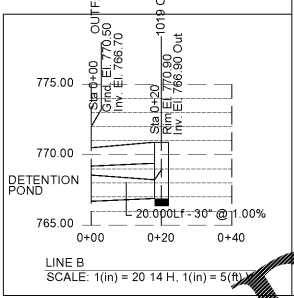
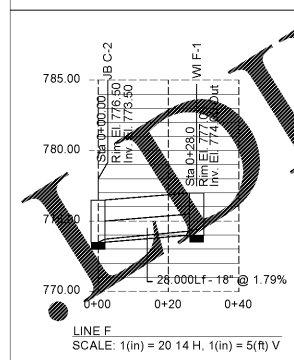
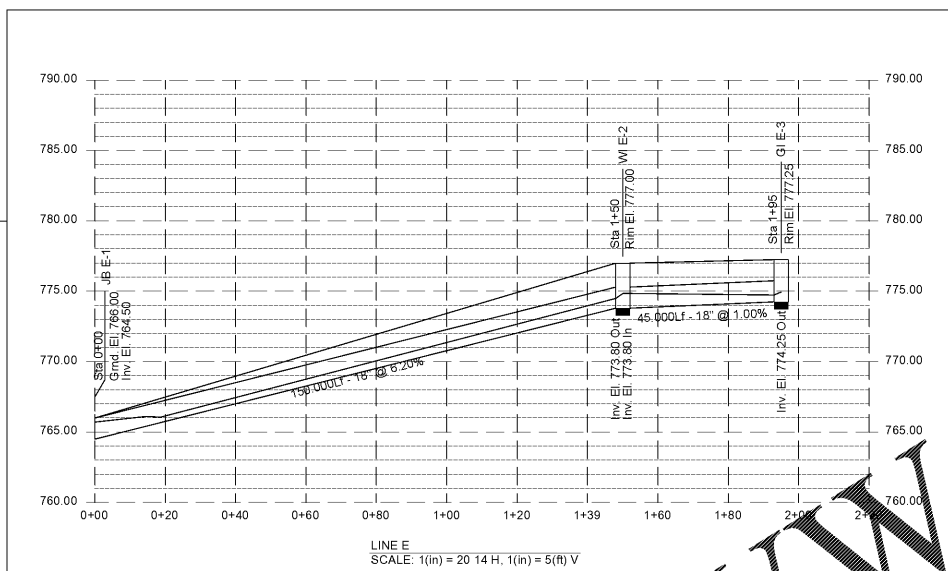
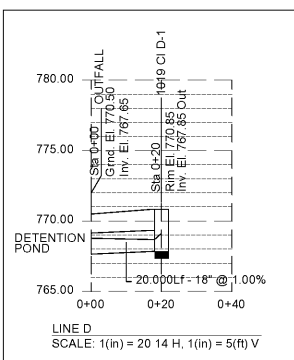

Order Plans @ WWW.LDILine.com

- STORM DRAINAGE NOTES:**
1. ALL HEADWALLS SHALL BE ENERGY DISSIPATING HEADWALLS.
 2. CONTRACTOR SHALL INSTALL RIP-RAP OUTLET PROTECTION AT ALL HEADWALLS UNLESS NOTED OTHERWISE.
 3. ALL STORM GRATES IN A CONCRETE/PEDESTRIAN CONCOURSE AREA SHALL BE ADA COMPLIANT STORM GRATES.
 4. ALL STORM PIPE SHALL BE HDPE DOUBLE WALLED SMOOTH INTERIOR STORM PIPES UNLESS NOTED OTHERWISE.
 5. CONTRACTOR SHALL COORDINATE WITH SEWER, WATER, GAS ETC. INSTALL ON ALL CROSSINGS.
 6. ALL STORM PIPE SHALL BE INSTALLED PER MANUFACTURER RECOMMENDATIONS.

- DRAINAGE NOTES:**
1. ALL PIPE THAT IS PART OF THE ROADWAY DRAINAGE SYSTEM IS TO BE RCP, 14 GAUGE MINIMUM BCCMP.
 2. PIPE IS TO BE INSTALLED PER GA. D.O.T. STD. 1030D.
 3. ALL DROP INLETS ARE TO BE PER GA. D.O.T. STD. OR OTHE ACCEPTABLE DESIGN MODIFIED WITH A RAISED WEIR INLET AND A METAL CLEAN OUT COVER.
 4. ALL HEADWALLS ARE TO BE GA. D.O.T. STD. 1125.
 5. ALL CATCH BASINS ARE TO BE CONSTRUCTED PER GA. D.O.T. STD. 1033D OR 1034D.
 6. ALL FLARED END SECTIONS ARE TO BE PER GA. D.O.T. STD. 1120 CONCRETE.
 7. ALL JUNCTION BOXES ARE TO BE PER GA. D.O.T. STD. OR OTHER ACCEPTABLE DESIGN MODIFIED WITH A METAL CLEAN OUT COVER.
 8. DRAINAGE EASEMENTS ARE REQUIRED TO PREVENT STORMWATER FLOW FROM ONE LOT ONTO ANOTHER EXCEPT WITHIN DESIGNATED DRAINAGE EASEMENT.
 9. ONLY RCP OR HDPE PIPE IN FLOWING STREAMS/OUTLET DEVICES.

SA&E PROJECT NUMBER	01-615-057
BID PACKAGE/PHASING	BP-1
ISSUED FOR CONSTRUCTION	10/15/2019
REVISIONS	
R #	Doc #
1	AD1
Date	11.4.2019

ADD ALTERNATE #1
BOARD OF EDUCATION OFFICE FOR:
HEARD COUNTY SCHOOL
4647 PEA RIDGE ROAD, FRANKLIN, GA 30127
HEARD COUNTY SCHOOL SYSTEM
FRANKLIN, GEORGIA

STORM PIPE PROFILES

		DRAWING NUMBER
		C301