

NO.	DESCRIPTION	DATE

**DUNLEITH ELEMENTARY SCHOOL**  
RENOVATIONS & MODIFICATIONS  
120 SAINTE DR. SW  
MARIETTA, GA 30008  
**MARIETTA CITY SCHOOLS**

**FLOOR PLAN - BLDG. 200 - POWER**

DATE: 08/30/2019  
PROJECT NO.: 18122

**E1.2**

Order Plans @

WWW.IDIline.com

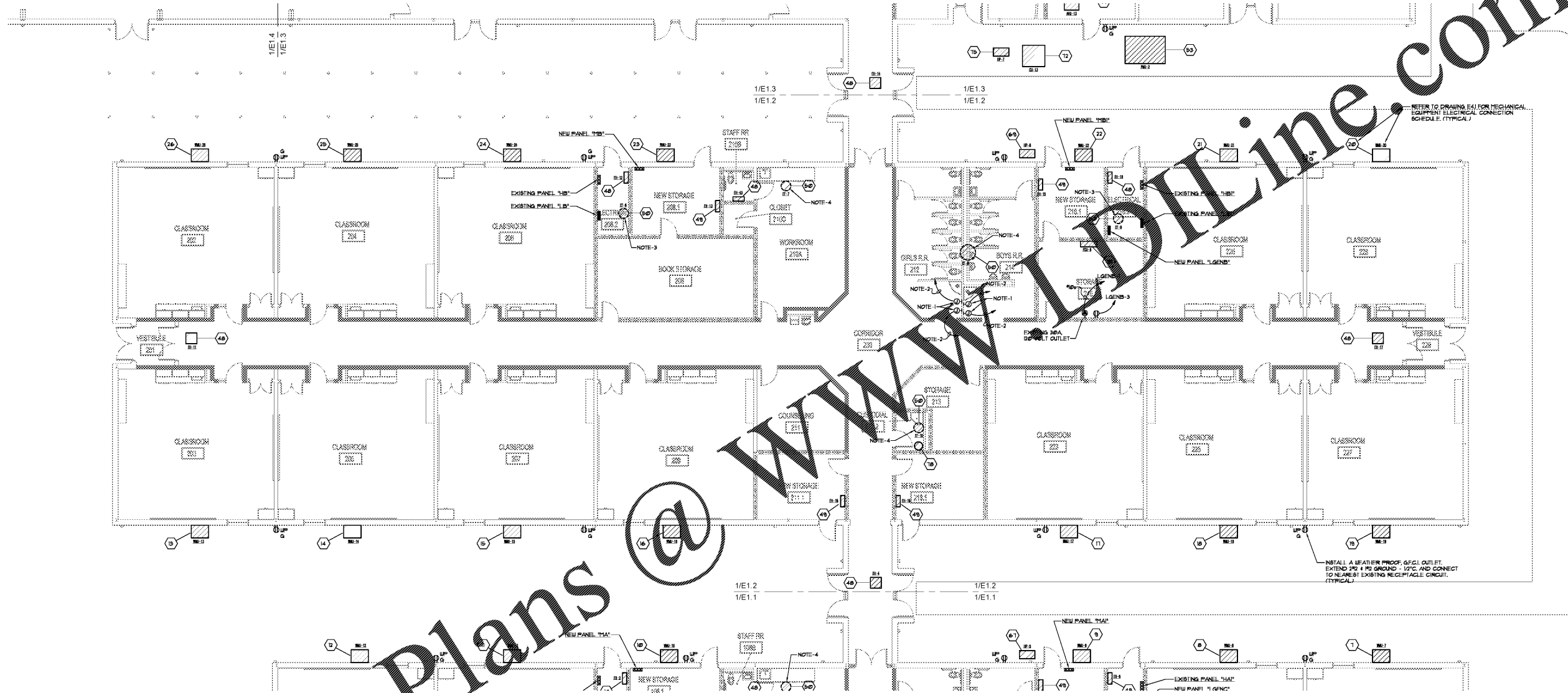

**1**  
E1.2 **FLOOR PLAN - BLDG 200 - POWER**  
SCALE: 1/8" = 1'-0"

**ELECTRICAL NOTES**

- INSTALL JUNCTION BOX TO ACCOMMODATE WALL MOUNTED HAND DRYER. COORDINATE EXACT LOCATION AND MOUNTING HEIGHT WITH ARCHITECT. FURNISH AND INSTALL A JUNCTION BOX AND HAND DRYER.
- EXTEND 2# 14 PG GROUND - 12"IC AND CONNECT TO A NEW 250V/1P GFCL TYPE BREAKER IN NEAREST EXISTING DISTRIBUTION PANELBOARD. NEW BREAKER SHALL BE OF SAME MANUFACTURER AS EXISTING PANEL AND MATCH AIC RATING OF EXISTING BREAKERS. PROPERLY UPDATE PANEL DIRECTORY.
- INSTALL A NEW LINE VOLTAGE T-STAT FURNISHED BY DIVISION 23.
- INSTALL A RELAY TO ALLOW 50 WGT.1 FAN TO BE CONTROLLED BY 277VOLT CORRIDOR LIGHTING. FAN SHALL ENERGIZE WHEN NON-EMERGENCY CORRIDOR LIGHTS ARE ENERGIZED.

KEY PLAN

