

0 1/4 1 2 3 4
Inches

Users: PEEB-816
G:\PROJECTS\10060192 - CF - Micco - Micco Rd & US-1\10 CAD\CFG07.2 OFFSITE IMPROVEMENTS - HWY US 1 PLAN AND PROFILE.dwg

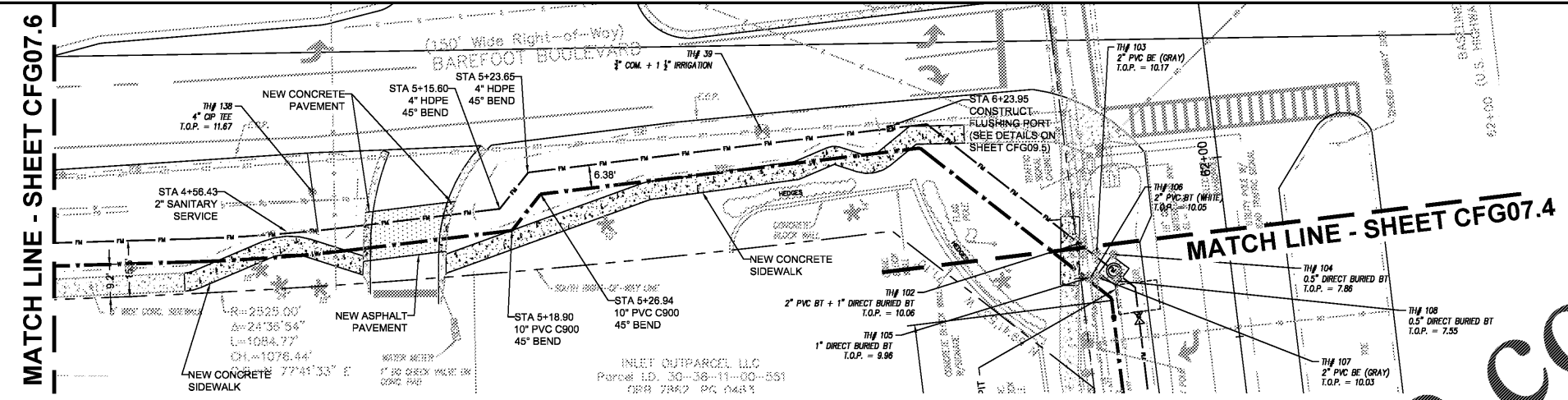

US HWY 1 - OFFSITE UTILITY AND SITE PLAN

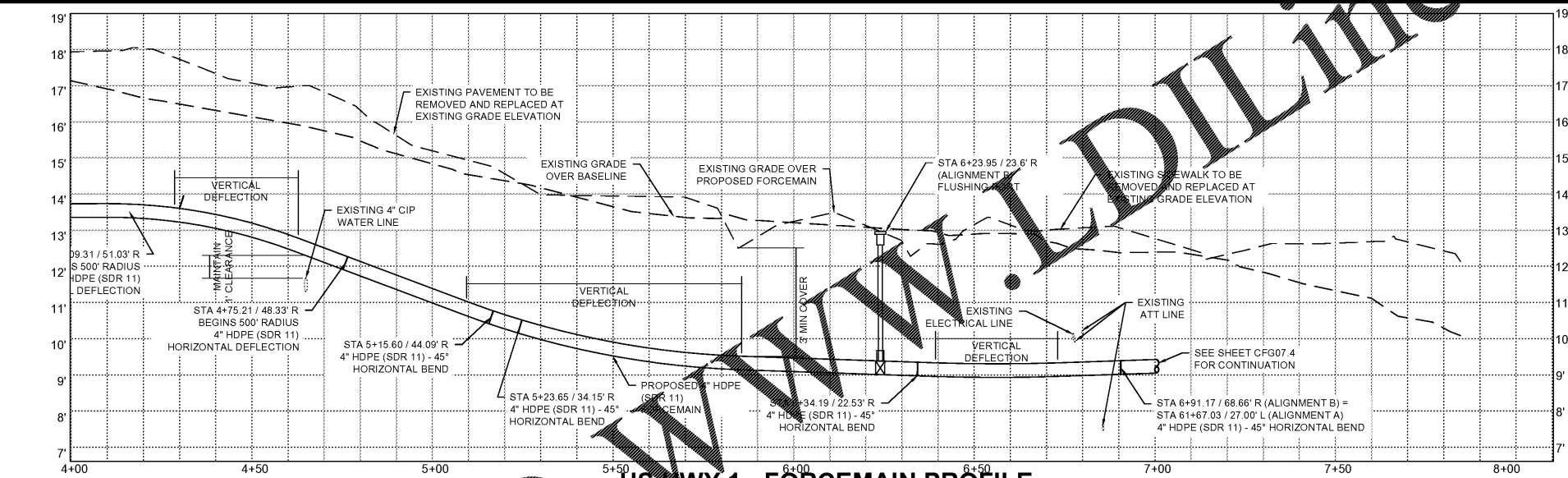

US HWY 1 - FORCEMAIN PROFILE

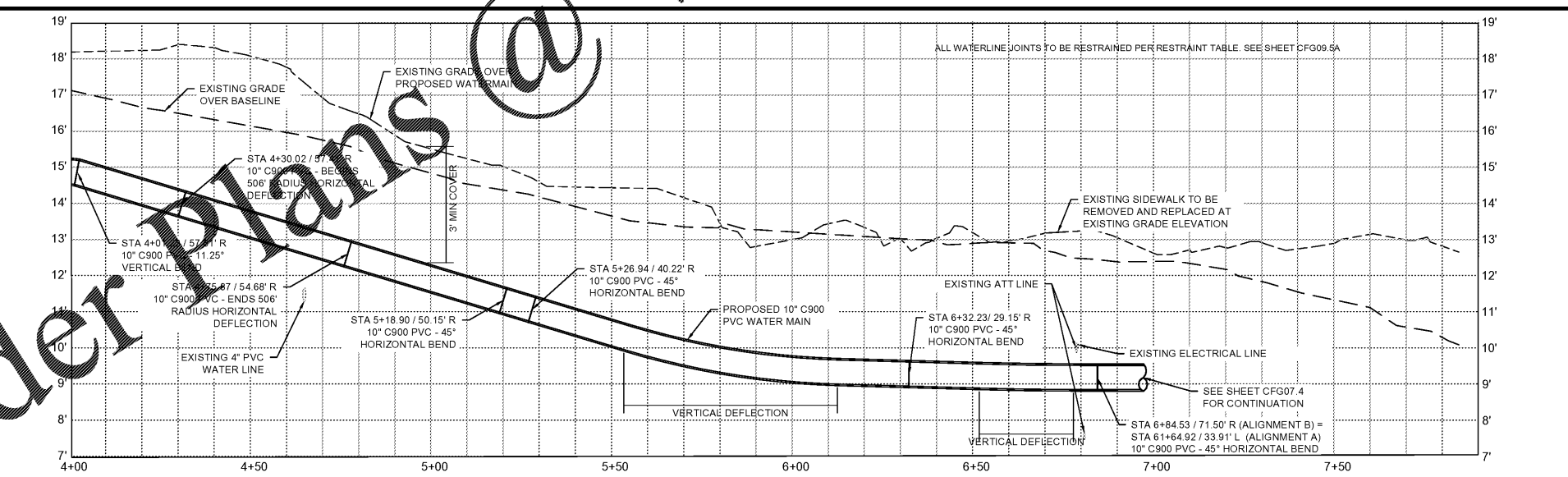

US HWY 1 - WATERMAIN PROFILE

- CONSTRUCTION NOTES**
1. WATER AND SEWER CONSTRUCTION WILL BE BY OPEN TRENCH UNLESS OTHERWISE NOTED.
 2. SEE SHEET CFG07.7 FOR CONTROL POINT TABLE, SECTIONS, AND PAVEMENT DESIGN.
 3. WATER AND WASTEWATER UTILITIES CONSTRUCTED IN THE RIGHT OF WAY SHALL BE IN ACCORDANCE WITH LATEST BREVARD COUNTY TECHNICAL UTILITY SPECIFICATIONS.

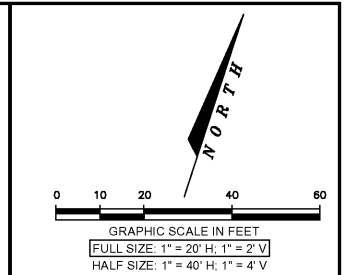
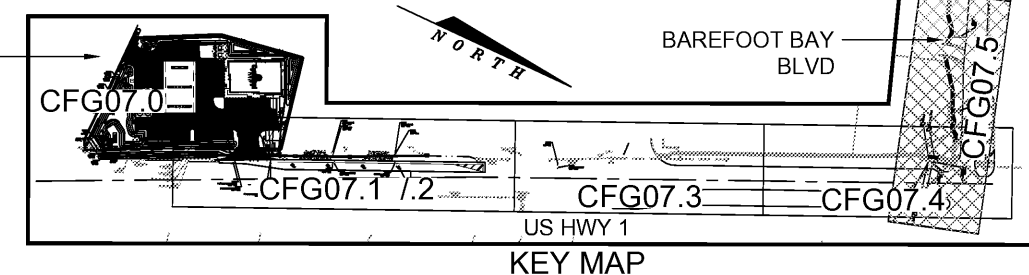

LEGEND

- Proposed Concrete Driveway Section (See Detail Sheet CFG09.5)
- Proposed FDOT AC Roadway Section (See Detail Sheet CFG07.7)
- Proposed Forcemain
- Proposed Water Service
- Existing Asphalt

ABBREVIATIONS:

- BFP - BACKFLOW PREVENTER
- AHJ - AUTHORITY HAVING JURISDICTION
- T.O.P. - TOP OF PIPE
- TYP. - TYPICAL
- C.O. - CLEANOUT
- CONC. - CONCRETE
- D.I.P. - DUCTILE IRON PIPE
- P.A.V. - PAVING, GRADING & DRAINAGE
- ROD - ROD
- N.F.V. - NOT FIELD VERIFIED

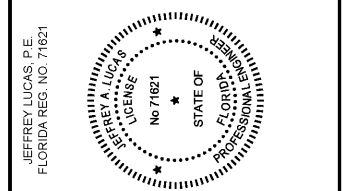

NOTICE:
The information in this document was prepared by ATKINS, Inc. While ATKINS has taken all reasonable steps to assure the accuracy of the information contained in this document, it cannot guarantee that changes or alterations to this document will not be made by persons other than ATKINS personnel after the document leaves the possession of ATKINS. Changes or alterations may be safety related and result in damage to property, personal injury or death. Verification of the information contained in this document is needed, contact should be made directly with ATKINS.

This document must be compared to the original hard copy, with certified raised seal if applicable, in order to insure the accuracy of the information contained therein and to further insure that no changes, alterations or modifications have been made to the document. No reliance should be made on a document transmitted or received by computer or other electronic means unless it is first compared to the original. ATKINS makes no warranties, express or implied, concerning the accuracy of the information contained in any document transmitted or received by computer or other electronic means.

Rev.	Date	Description	By	Checked
1	11/7/18	BREVARD COUNTY COMMENTS	df	fw
2	12/10/18	BREVARD COUNTY COMMENTS	df	fw
3	03/04/19	BREVARD COUNTY COMMENTS	df	fw
4	03/24/19	BREVARD COUNTY COMMENTS	df	fw
5	09/30/19	PER CLIENT COMMENTS	df	fw

Drawing Status	Submittal
FOR PERMITTING	\$0

ATKINS
CORPORATE OFFICE: 4030 W. BOY SCOUT BLVD, TAMPA, FLORIDA 33607
LOCAL OFFICE: 7175 MURRELL ROAD, MELBOURNE, FL 32940
TEL. 321.242.4942 FAX. 321.242.6101
www.atkinsglobal.com
Copyright © Atkins Limited (2017)

Cumberland Farms
CUMBERLAND FARMS INC.
16 FLAMERS ROAD
WINDSOR, MA 01091

Project Title: MICCO ROAD & US-1 BREVARD COUNTY, FL 100060192

Drawing Title: OFFSITE IMPROVEMENTS BAREFOOT BLVD PLAN AND PROFILE

Scale	Designed	Drawn	Checked	Authorized
	JL	DF		
Original Size	Date	Date	Date	Date
ARCH D				
Drawing Number				Revision
CFG07.5				