

User: PEEZ4816 C:\PROJECTS\100060192 - CF - Micco - Micco Rd & US-1\10 CAD\CFG07.1 OFFSITE DEMOLITION.dwg

MATCH LINE - SHEET CFG03.0

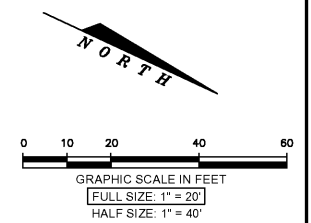
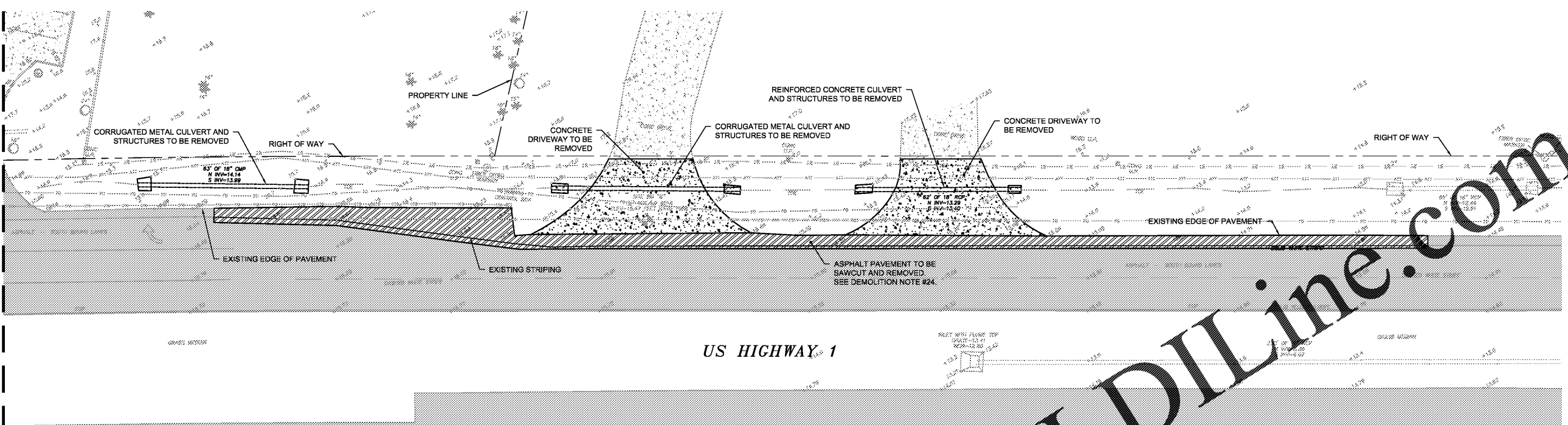

**ABBREVIATIONS:**

RCP	REINFORCED CONCRETE PIPE
AHJ	AUTHORITY HAVING JURISDICTION
T.O.P.	TOP OF PIPE
TYP.	TYPICAL
C.O.	CLEANOUT
C.C.	CONCRETE
D.I.P.	DUCTILE IRON PIPE
PGD	PAVING, GRADING & DRAINAGE
NFY	NOT FIELD VERIFIED
INV	INVERT
CMP	CORROGATED METAL PIPE



**NOTICE:**  
The information in this document was prepared by ATKINS, Inc. While ATKINS, Inc. has taken all reasonable steps to ensure the accuracy of the information contained in this document, it cannot guarantee that changes or alterations to this document will not be made by persons other than ATKINS personnel after the document leaves the possession of ATKINS. Changes or alterations may be safety related and result in damage to property, personal injury or death. Verification of the information contained in this document is needed, contact should be made directly with ATKINS.

This document must be compared to the original hard copy, with certified raised seal if applicable, in order to insure the accuracy of the information contained therein and to further ensure that no changes, alterations or modifications have been made to the document. No reliance should be made on a document transmitted or reviewed by computer or other electronic means unless it is first compared to the original. ATKINS makes no warranties, express or implied, concerning the accuracy of the information contained in any document transmitted or reviewed by computer or other electronic means.

Rev.	Date	Description	By	Checked
1	11/7/18	BREVARD COUNTY COMMENTS	cp	fw
2	12/10/18	BREVARD COUNTY COMMENTS	cp	fw
3	03/04/19	BREVARD COUNTY COMMENTS	cp	JA
4	03/24/19	BREVARD COUNTY COMMENTS	cp	JA
5	06/30/19	PER CLIENT COMMENTS	cp	cp JA

Drawing Status	Submittal
<b>FOR PERMITTING</b>	<b>\$0</b>

**ATKINS** CORPORATE OFFICE: 4030 W. BOY SCOUT BLVD TAMPA, FLORIDA 33607  
 LOCAL OFFICE: 7175 MURRELL ROAD MELBOURNE, FL 32940  
 TEL. 321.242.4942 FAX. 321.242.6101 www.atkinsglobal.com  
 Copyright © Atkins Limited (2017)

**Cumberland Farms**  
 CUMBERLAND FARMS INC.  
 10000 LINDSEY ROAD  
 WASHINGTON, MA 01891

Project Title  
**MICCO ROAD & US-1  
 BREVARD COUNTY, FL  
 100060192**

Drawing Title  
**OFFSITE IMPROVEMENTS  
 HWY US 1 DEMOLITION  
 PLAN**

Scale	Designed	Drawn	Checked	Authorized
Original Size	Date	Date	Date	Date
ARCH D				
Drawing Number	Revision			
<b>CFG07.1</b>				

**OFFSITE DEMOLITION NOTES**

- BOLDED ITEMS DENOTE DEMOLITION.**
- EXISTING UTILITIES SHOWN ON THIS DRAWING ARE FROM THE BEST AVAILABLE INFORMATION. ACTUAL LOCATIONS AND ELEVATIONS MAY VARY. CONTRACTOR TO VERIFY ALL UTILITIES BEFORE PROCEEDING WITH WORK.
- CONTRACTOR TO COORDINATE WITH THE VARIOUS UTILITIES TO REMOVE, CAP, RELOCATE, BYPASS, OR OTHERWISE ENSURE THAT THE UTILITY SERVICES WILL NOT BE INTERRUPTED DURING CONSTRUCTION/DEMOLITION.
- ALL ITEMS NOT IDENTIFIED FOR REMOVAL SHALL BE PROTECTED AND REMAIN UNDISTURBED TO THE BEST EXTENT PRACTICAL.
- STRIPPING (CLEARING AND GRUBBING) BY THE CONTRACTOR SHALL BE PERFORMED TO THE MINIMUM EXTENT PRACTICAL TO COMPLETE WORK. THE CONTRACTOR SHALL GENERALLY BE WITHIN THE LIMITS OF CONSTRUCTION AND STRIP SURFACES OF VEGETATION, STUMPS, DEBRIS, ORGANIC TOP SOIL (ORGANIC CONTENT > 5%) OR OTHER DELETERIOUS MATERIALS AS ENCOUNTERED.
- CONTRACTOR TO COORDINATE AND OBTAIN ALL NECESSARY CONSTRUCTION PERMITS FROM LOCAL, STATE, AND FEDERAL AGENCIES HAVING JURISDICTION OVER THE SITE OR REGULATING CONSTRUCTION OPERATIONS.
- REMOVE OR RELOCATE EXISTING TREES PER LANDSCAPE PLAN AND BREVARD COUNTY STANDARDS.
- CONTRACTOR SHALL REFER TO GENERAL NOTES SHEET FOR OTHER DEMOLITION CONSIDERATIONS.
- CONTRACTOR SHALL COORDINATE WITH OWNER AND ELECTRICAL/TELECOM SERVICE PROVIDER ON SALVAGING OF ELECTRICAL COMPONENTS (LAMP FIXTURES, PULL BOXES, SERVICE LEADS, CONDUITS, ETC) DURING/PRIOR TO REMOVAL ACTIVITIES. ELECTRICAL/TELECOM DEMO AND SERVICES PROVISIONS ARE NOT WITHIN THE CIVIL ENGINEERS SCOPE OF WORK. ELECTRICAL/TELECOM CONSULTANT SHALL BE AT THE CONTRACTOR'S EXPENSE AS NEEDED.
- SAWCUT PAVEMENT AT PAVEMENT DEMO LIMITS.
- PHASED DEMOLITION, MAINTENANCE OF TRAFFIC AND LOGISTICS RELATING TO CIVIL ENGINEERING ACTIVITIES SHALL BE MANAGED BY THE CONTRACTOR AND COORDINATED WITH THE OWNER AND ENGINEER. CONSTRUCTION FENCING LIMITS ARE AT THE DISCRETION OF THE CONTRACTOR.
- SEE SURVEY FOR EXISTING CONDITIONS. (BY OTHERS)
- CONSTRUCTION SEQUENCING AND SCHEDULING SHALL BE BY THE CONTRACTOR. COORDINATE WITH OWNER AND ENGINEER.
- CONTRACTOR SHALL REVIEW THE SITE GEOTECHNICAL REPORT PRIOR TO CONDUCTING ANY EARTHWORK. IT SHALL BE THE CONTRACTOR'S RESPONSIBILITY TO PROCURE A GEOTECHNICAL REPORT FOR THEIR PURPOSES OF COMPACTION, FILL REQUIREMENTS, ETC. AS NECESSARY.
- UTILITY COVERS WITHIN THE LIMITS OF CONSTRUCTION SHALL BE ADJUSTED TO MEET EXISTING OR PROPOSED GRADES RESPECTIVELY.
- ANY SHORING OR BRACING SHALL BE BY THE CONTRACTORS MEANS AND METHODS. BRACING DOES NOT PRECLUDE STRUCTURAL ENGINEERING PROCUREMENT AT THEIR OWN EXPENSE AS NEEDED DURING DEMOLITION WORK ADJACENT TO ITEMS SUCH AS WALLS, UTILITY POLES, ETC.
- REMOVAL OF DRIVEWAY, SIDEWALK, AND CURB SHALL BE FROM JOINT TO JOINT.
- REFER TO SURVEY FOR EXISTING ITEMS LEGEND NOT INCLUDED HEREIN.
- ALL ITEMS NOT IDENTIFIED FOR REMOVAL SHALL BE PROTECTED AND REMAIN UNDISTURBED TO THE BEST EXTENT PRACTICAL.
- REMOVE STRIPING BY GRINDING.
- SEE SHEET CFG09.3 FOR MAINTENANCE OF TRAFFIC (MOT). ADDITIONAL MOT NOTES CAN ALSO BE FOUND ON CFG01.1 UNDER THE "ROADWAY & MOT NOTES" HEADING.
- ALL AREAS OF EXISTING ASPHALT DRIVEWAYS IN THE FDOT RIGHT-OF-WAY ARE TO HAVE ALL LIMEROCK MATERIALS REMOVED AND SUITABLE SOIL MATERIAL REPLACED AND SODDED.
- SAW CUT AND REMOVE PAVED SHOULDER ALONG BACKSIDE OF WHITE EDGE LINE. DO NOT DISTURB MAINLINE BASE UNDER WHITE EDGE LINE.

**OFFSITE GENERAL NOTES**

- ALL WORK PERFORMED WITHIN THE FDOT RIGHT-OF-WAY SHALL BE IN ACCORDANCE WITH THE LATEST EDITIONS OF THE FDOT STANDARD PLANS, SPECIFICATIONS FOR ROAD AND BRIDGE CONSTRUCTION, AND THE UTILITY ACCOMMODATION MANUAL.
- PERMITTEE SHALL NOT BEGIN A DIRECTIONAL BORE ACROSS A STATE ROAD UNTIL AN FDOT INSPECTOR IS PRESENT AT THE JOB SITE AND AGREES THAT PROPER PREPARATIONS HAVE BEEN MADE.
- CONTRACTOR TO NOTIFY FDOT 48HRS IN ADVANCE OF STARTING PROPOSED WORK BY WORK INITIATION IN ONE STOP PERMITTING.
- ALL DISTURBED UNPAVED AREA WITHIN FDOT RIGHT OF WAY SHALL BE SODDED PER FDOT 2018/19 FDOT STANDARDS PLAN INDEX #570-010.
- ALL SIDEWALK TO BE REMOVED AND REPLACED FROM JOINT TO JOINT AND HAVE 12" EXPANSION JOINTS (PERFORMED JOINT FILLER) PLACED BETWEEN OLD AND NEW SIDEWALK.
- ALL RAISED PAVEMENT MARKERS (RPM) INSTALLED WITHIN FDOT RIGHT OF WAY AND PROPOSED DRIVEWAY CONNECTION SHALL BE IN ACCORDANCE WITH FDOT 2018/19 STANDARD PLANS INDEX #706-001.
- ALL PAVEMENT MARKINGS IN THE FDOT RIGHT-OF-WAY AND PROPOSED DRIVEWAY CONNECTION SHALL BE THERMOPLASTIC.
- CONTRACTOR SHALL CONTACT FDOT AND SET UP A PRE-CONSTRUCTION MEETING PRIOR TO STARTING ANY WORK WITHIN THE FDOT RIGHT-OF-WAY.
- ALL EXCAVATIONS WITHIN TEN (10) FEET OF THE TRAVEL LANES AND GREATER THEN THREE (3) INCHES DEEP MUST BE FILLED IN OR HAVE A SHOULDER TREATMENT PLACED AT THE DROP-OFF PER INDEX #102-600 OF FDOT 2018/19 STANDARD PLANS INDEXES AT END OF WORK.
- CONTRACTOR SHALL BID 8 CROSSING CONFLICTS-4-45° BENDS, DEWATERING AROUND EX. UG UTILITIES (4-10"; 4-4")

**LEGEND**

	EXISTING CONCRETE		EXISTING UNDERGROUND FIBER OPTICS LINE
	CONCRETE TO BE REMOVED		EXISTING UNDERGROUND AT&T LINE
	EXISTING ASPHALT		EXISTING GROUND CONTOUR
	ASPHALT PAVEMENT TO BE REMOVED		EXISTING SPOT ELEVATION
	SOFT DIG LOCATION & I.D. NUMBER SEE RESULT LISTS NEAR EACH LOCATION		PROPOSED SPOT ELEVATION
	PROPOSED FORCE MAIN		WOOD UTILITY POLE
	PROPOSED WATER MAIN		COMMUNICATIONS RISER
	EXISTING FORCE MAIN		CONCRETE UTILITY POLE W/ LIGHT
	EXISTING UNDERGROUND COMMUNICATIONS LINE		CONCRETE UTILITY POLE
	EXISTING WATER LINE		GATE VALVE
	EXISTING OVERHEAD UTILITY LINE		
	EXISTING SANITARY SEWER LINE		
	EXISTING UNDERGROUND ELECTRIC LINE		

