

0 1 2 3 4
Inches
User: PERE4816
G:\PROJECTS\100060192 - CF - Micco - Micco Rd. & US-1\1.D CAD\CFG07.0A PHASING PLAN.dwg

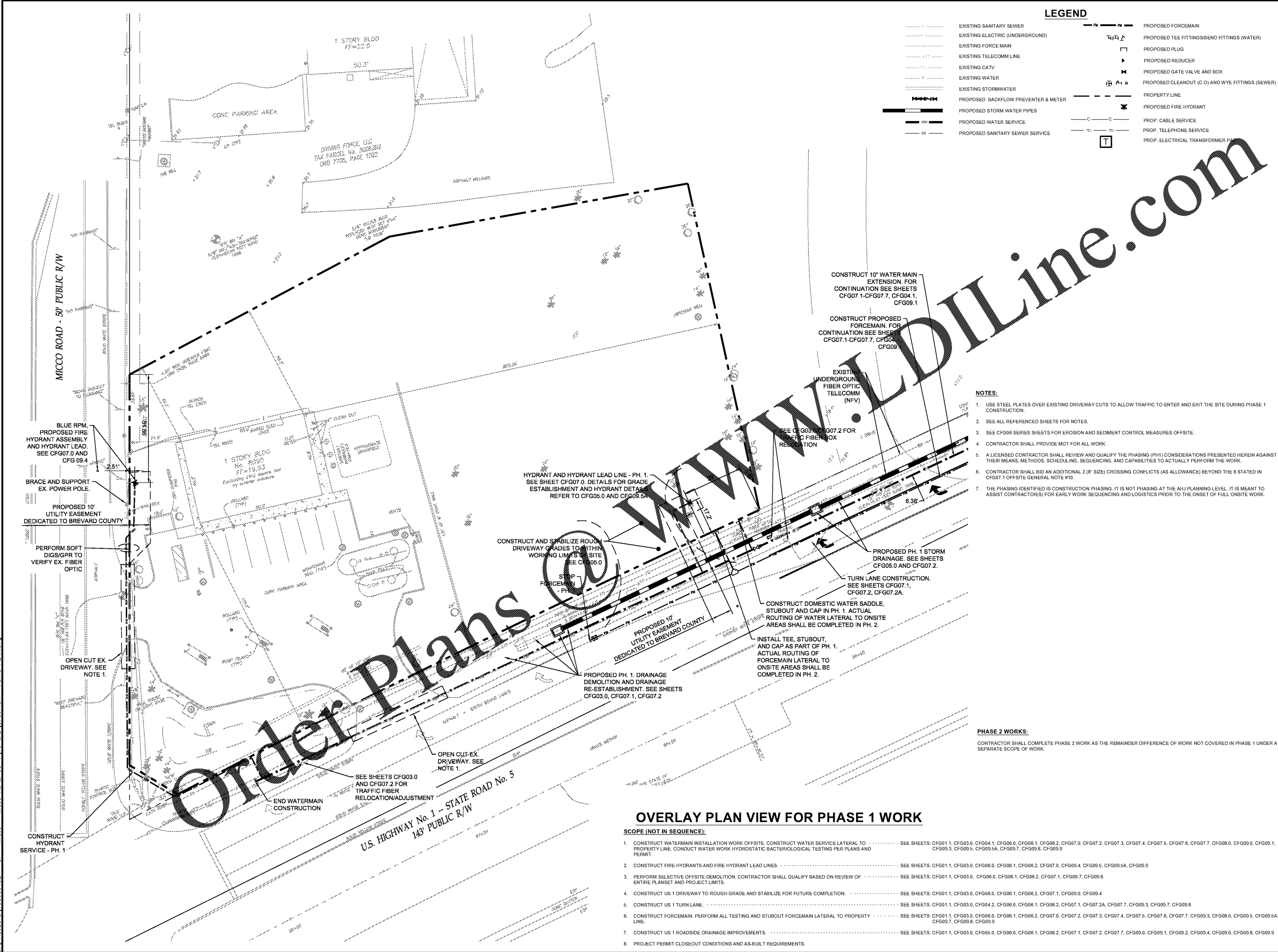

LEGEND

- EXISTING SANITARY SEWER
- EXISTING ELECTRIC (UNDERGROUND)
- EXISTING FORCE MAIN
- EXISTING TELECOMM LINE
- EXISTING CATV
- EXISTING WATER
- EXISTING STORMWATER
- PROPOSED BACKFLOW PREVENTER & METER
- PROPOSED STORM WATER PIPES
- PROPOSED WATER SERVICE
- PROPOSED SANITARY SEWER SERVICE
- PROPOSED FORCEMAIN
- PROPOSED TEE FITTINGS/BEND FITTINGS (WATER)
- PROPOSED PLUG
- PROPOSED REDUCER
- PROPOSED GATE VALVE AND BOX
- PROPOSED CLEANOUT (C.O.) AND WYE FITTINGS (SEWER)
- PROPERTY LINE
- PROPOSED FIRE HYDRANT
- PROP. CABLE SERVICE
- PROP. TELEPHONE SERVICE
- PROP. ELECTRICAL TRANSFORMER P

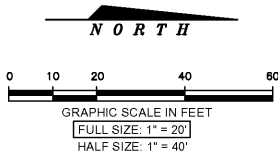

- #### ABBREVIATIONS:
- BFP - BACKFLOW PREVENTER
 - AHJ - AUTHORITY HAVING JURISDICTION
 - T.O.P. - TOP OF PIPE
 - TYP. - TYPICAL
 - C.O. - CLEANOUT
 - C.N.C. - CONCRETE
 - D.I.P. - DUCTILE IRON PIPE
 - PGD - PAVING, GRADING & DRAINAGE
 - NFV - NOT FIELD VERIFIED
 - E.K. - EXISTING
 - PH. - PHASE
 - RPM - REFLECTIVE PAVEMENT MARKER

FOR INFORMATIONAL PURPOSES ONLY. CONTRACTOR SHALL QUALIFY ACTUAL WORK.

NOTES:

- USE STEEL PLATES OVER EXISTING DRIVEWAY CUTS TO ALLOW TRAFFIC TO ENTER AND EXIT THE SITE DURING PHASE 1 CONSTRUCTION.
- SEE ALL REFERENCED SHEETS FOR NOTES.
- SEE CFG06 SERIES SHEETS FOR EROSION AND SEDIMENT CONTROL MEASURES OFFSITE.
- CONTRACTOR SHALL PROVIDE MOT FOR ALL WORK.
- A LICENSED CONTRACTOR SHALL REVIEW AND QUALIFY THE PHASING (PH) CONSIDERATIONS PRESENTED HEREIN AGAINST THEIR MEANS, METHODS, SCHEDULING, SEQUENCING, AND CAPABILITIES TO ACTUALLY PERFORM THE WORK.
- CONTRACTOR SHALL BID AN ADDITIONAL 2 (2) SIZE CROSSING CONFLICTS (AS ALLOWANCE) BEYOND THE 8 STATED IN CFG07.1 OFFSITE GENERAL NOTE #10.
- THE PHASING IDENTIFIED IS CONSTRUCTION PHASING. IT IS NOT PHASING AT THE AHJ PLANNING LEVEL. IT IS MEANT TO ASSIST CONTRACTOR(S) FOR EARLY WORK SEQUENCING AND LOGISTICS PRIOR TO THE ONSET OF FULL ONSITE WORK.

NOTICE: The information in this document was prepared by ATKINS, Inc. While ATKINS has taken all reasonable steps to ensure the accuracy of the information contained in this document, it does not guarantee that changes or alterations to this document will not be made by anyone other than ATKINS personnel after the document leaves the possession of ATKINS. Changes or alterations may be safely relied on and result in damage to property, personal injury or death. Verification of the information contained in the document is required, contact should be made directly with ATKINS.

This document must be compared to the original hard copy, with certified raised seal if applicable, in order to insure the accuracy of the information contained therein and to insure that no changes, alterations or modifications have been made to the document. No reliance should ever be made on a reproduction transmitted or received by computer or other electronic means unless it is first compared to the original. ATKINS makes no warranties, express or implied, concerning the accuracy of the information contained in any document transmitted or received by computer or other electronic means.

Rev.	Date	Description	By	Checked

Drawing Status	Submittal
FOR PERMITTING	\$0

ATKINS
CORPORATE OFFICE:
4030 W. BOY SCOUT BLVD
TAMPA, FLORIDA 33607
FIBER CERTIFICATE OF AUTHORIZATION NO.24

LOCAL OFFICE:
7175 MURRELL ROAD
MELBOURNE, FL 32940
TEL. 321.242.4942
FAX. 321.242.6101
www.atkinsglobal.com

Copyright © Atkins Limited (2017)

Cumberland Farms
CUMBERLAND FARMS INC.
150 PLAINFIELD ROAD
WESTBOROUGH, MA 01581

Project Title:
**MICCO ROAD & US-1
BREVARD COUNTY, FL
100060192**

Drawing Title:
**OFFSITE UTILITY AND
PARTIAL SELECTIVE
PHASE 1 WORK PLAN**

Scale	Designed	Drawn	Checked	Authorized
Original Size	JL	DF		
ARCH D	Date	Date	Date	Date
Drawing Number	CFG07.0A			Revision

OVERLAY PLAN VIEW FOR PHASE 1 WORK

SCOPE (NOT IN SEQUENCE):

- CONSTRUCT WATERMAIN INSTALLATION WORK OFFSITE. CONSTRUCT WATER SERVICE LATERAL TO PROPERTY LINE. CONDUCT WATER WORK HYDROSTATIC BACTERIOLOGICAL TESTING PER PLANS AND PERMIT. SEE SHEETS: CFG01.1, CFG03.0, CFG04.1, CFG06.0, CFG08.1, CFG08.2, CFG07.0, CFG07.2, CFG07.3, CFG07.4, CFG07.5, CFG07.6, CFG07.7, CFG08.0, CFG09.0, CFG09.1, CFG09.3, CFG09.5, CFG09.5A, CFG09.7, CFG09.8, CFG09.9
- CONSTRUCT FIRE HYDRANTS AND FIRE HYDRANT LEAD LINES. SEE SHEETS: CFG01.1, CFG03.0, CFG06.0, CFG08.1, CFG08.2, CFG07.0, CFG09.4, CFG09.5, CFG09.5A, CFG09.9
- PERFORM SELECTIVE OFFSITE DEMOLITION. CONTRACTOR SHALL QUALIFY BASED ON REVIEW OF ENTIRE PLANS SET AND PROJECT LIMITS. SEE SHEETS: CFG01.1, CFG03.0, CFG06.0, CFG08.1, CFG08.2, CFG07.1, CFG09.7, CFG09.8
- CONSTRUCT US 1 DRIVEWAY TO ROUGH GRADE AND STABILIZE FOR FUTURE COMPLETION. SEE SHEETS: CFG01.1, CFG03.0, CFG06.0, CFG08.1, CFG08.2, CFG07.1, CFG09.0, CFG09.4
- CONSTRUCT US 1 TURN LANE. SEE SHEETS: CFG01.1, CFG03.0, CFG04.2, CFG06.0, CFG08.1, CFG08.2, CFG07.1, CFG07.2A, CFG07.7, CFG09.3, CFG09.7, CFG09.8
- CONSTRUCT FORCEMAIN. PERFORM ALL TESTING AND STUBOUT FORCEMAIN LATERAL TO PROPERTY LINE. SEE SHEETS: CFG01.1, CFG03.0, CFG06.0, CFG08.1, CFG08.2, CFG07.0, CFG07.2, CFG07.3, CFG07.4, CFG07.5, CFG07.6, CFG07.7, CFG09.3, CFG08.0, CFG09.5, CFG09.5A, CFG09.7, CFG09.8, CFG09.9
- CONSTRUCT US 1 ROADSIDE DRAINAGE IMPROVEMENTS. SEE SHEETS: CFG01.1, CFG03.0, CFG05.0, CFG06.0, CFG08.1, CFG08.2, CFG07.1, CFG07.2, CFG07.7, CFG09.0, CFG09.1, CFG09.2, CFG09.4, CFG09.0, CFG09.8, CFG09.9
- PROJECT PERMIT CLOSEOUT CONDITIONS AND AS-BUILT REQUIREMENTS.