

STIPULATION FOR REUSE
 THE DRAWING WAS PREPARED FOR THE PROJECT AND SITE AT THE LOCATION LISTED BELOW, AND IS NOT TO BE REUSED FOR ANY OTHER PROJECT SITE OR A REPRINT OF THIS DRAWING FOR ANY PURPOSE. THE USER OF THIS DRAWING FOR ANY OTHER PURPOSE, WITHOUT THE WRITTEN PERMISSION OF HARRISON FRENCH & ASSOCIATES, LTD., IS AT THEIR OWN RISK. HARRISON FRENCH & ASSOCIATES, LTD. IS NOT RESPONSIBLE FOR ANY REUSE OF THIS DRAWING FOR ANY OTHER PROJECT. THIS DRAWING IS THE PROPERTY OF HARRISON FRENCH & ASSOCIATES, LTD. AND IS NOT TO BE REPRODUCED OR TRANSMITTED IN ANY FORM OR BY ANY MEANS, ELECTRONIC OR MECHANICAL, INCLUDING PHOTOCOPYING, RECORDING, OR BY ANY INFORMATION STORAGE AND RETRIEVAL SYSTEM, WITHOUT THE WRITTEN PERMISSION OF HARRISON FRENCH & ASSOCIATES, LTD.

Cumberland
 A N M S
 Store # TBD
 VSH # TBD
 Oracle # FL8513
 SR50 AND SOUTH STREET
 TITUSVILLE, FL 32780
 JOB NUMBER: 41-17-00190

ISSUE BLOCK	
CLIENT REVIEW	08/30/19
100%	09/27/19

CHECKED BY: GGB
 DRAWN BY: AHM

DUMPSTER ENCLOSURE PLAN AND DETAILS
 SHEET: **S104**

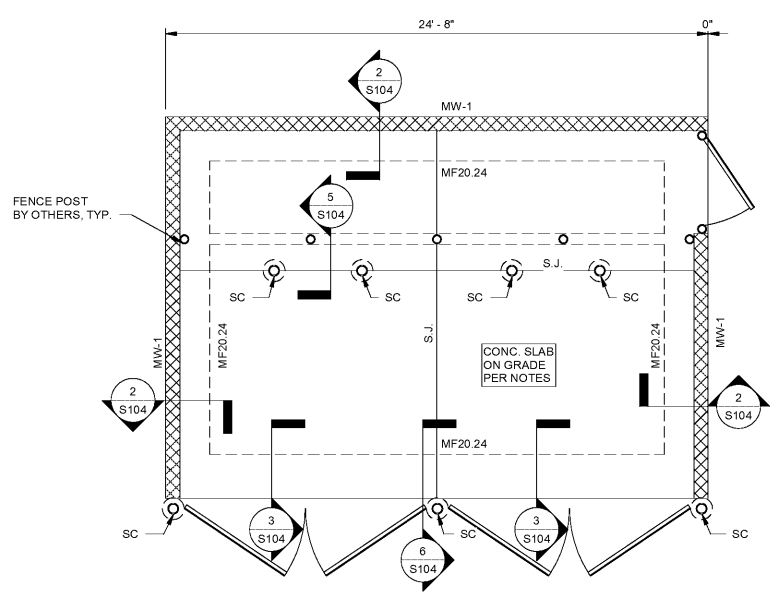

- NOTES**
- MW-1 DENOTES 8" C.M.U. WALL WITH #6 VERTICAL REINFORCING AT 16" O.C.
 - MF20.24 DENOTES MONOLITHIC CONCRETE FOOTING, 2'-0" x 24" DEEP x CONT. W/(3) #5 CONT. BOTTOM AND #5 TRANSVERSE AT 48" O.C.
 - SEE ARCH AND MECH FOR ALL SLEEVES, PIPES AND EMBEDDED ITEMS
 - SEE ARCH FOR DIMENSIONS NOT SHOWN.
 - CONCRETE SLAB ON GRADE SHALL BE 6" THICK REINF. W/ #4 AT 12" O.C. MAX. MID-DEPTH, ON PREPARED SUB-GRADE PER GEOTECHNICAL ENGINEER'S RECOMMENDATIONS.
 - S.J. DENOTES SAW JOINT, SEE DETAIL 4 / S104
 - SC DENOTES 6" DIAMETER SCHEDULE 40 PIPE FOR BOLLARD AND GATE POSTS, SEE ARCH FOR LOCATIONS AND EXTENTS. FILL PIPE BOLLARDS WITH FC=3000 PSI CONCRETE.

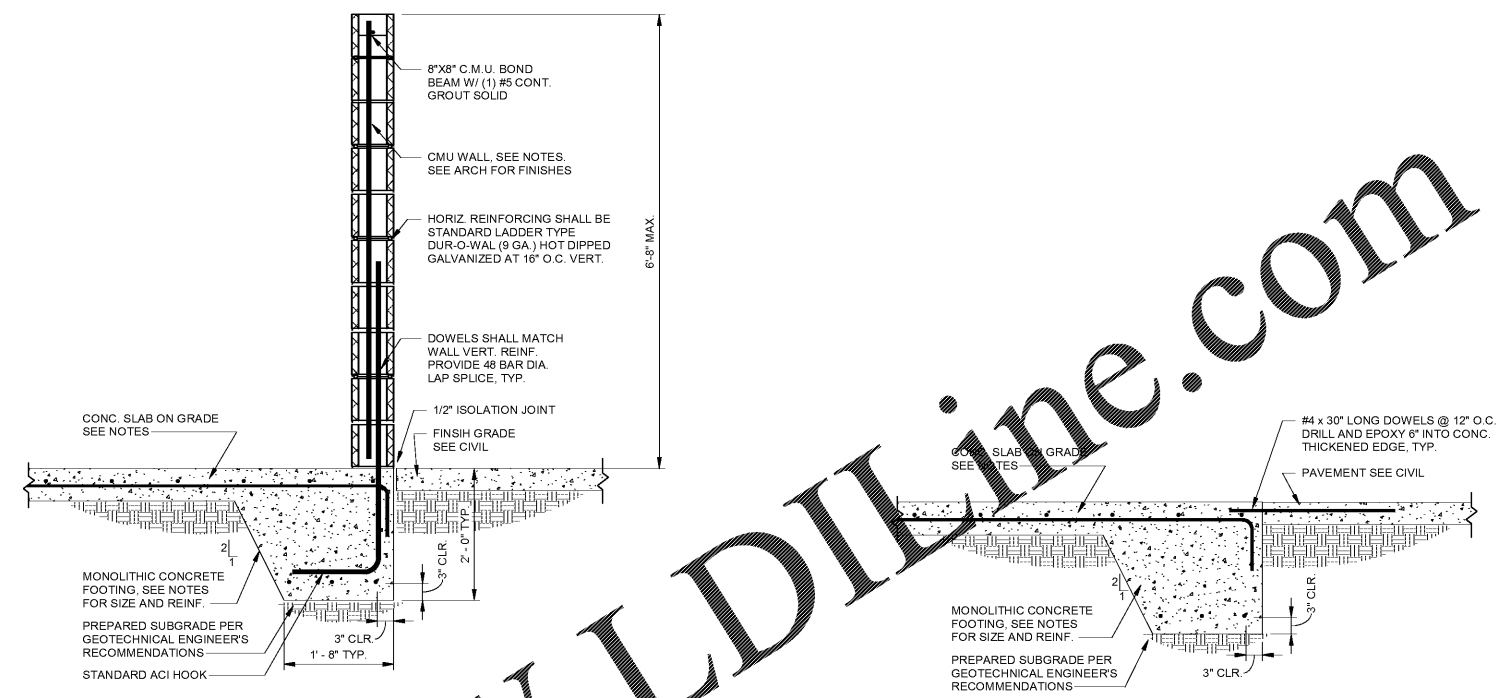

2 MASONRY WALL SECTION
 3/4" = 1'-0"

3 HAUNCHED SLAB SECTION
 3/4" = 1'-0"

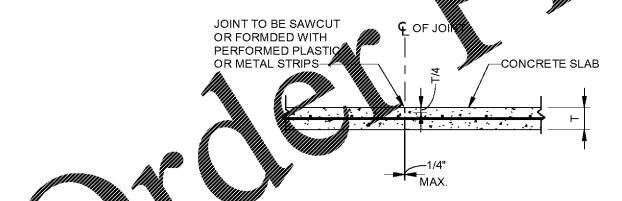

4 TYPICAL SLAB SAWCUT JOINT
 1/2" = 1'-0"

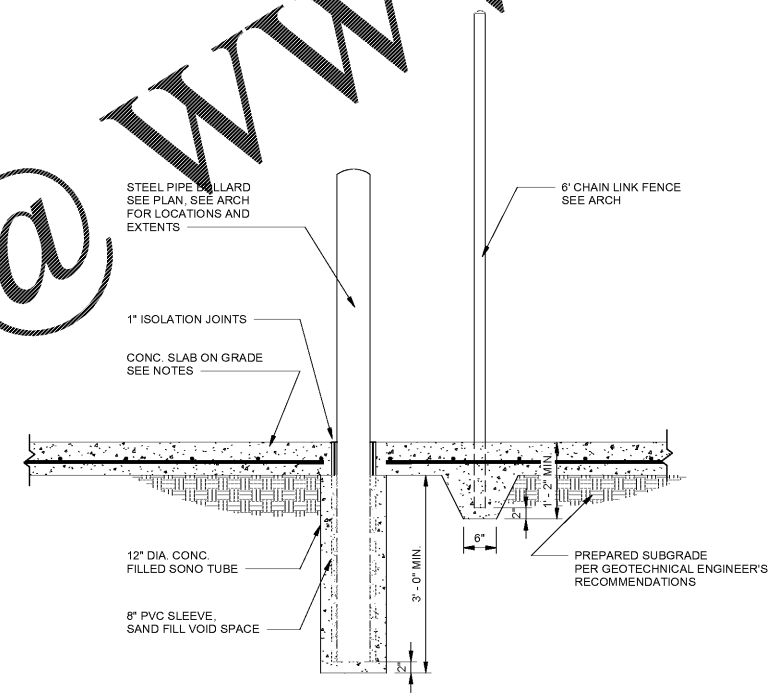

5 BOLLARD AND FENCE POST FOUNDATION SECTION
 3/4" = 1'-0"

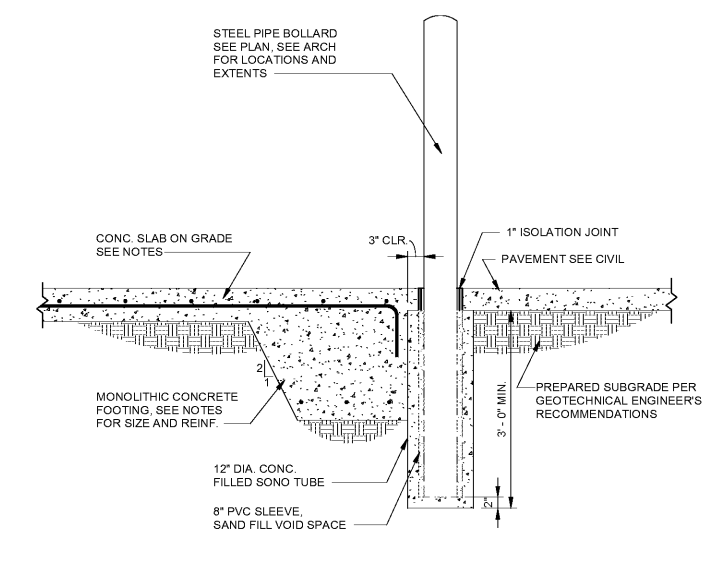

6 HAUNCHED SLAB AND BOLLARD FOUNDATION SECTION
 3/4" = 1'-0"

Order Plans @ www.LDOnline.com