

Order Plans @ WWW.LDILLINE.COM

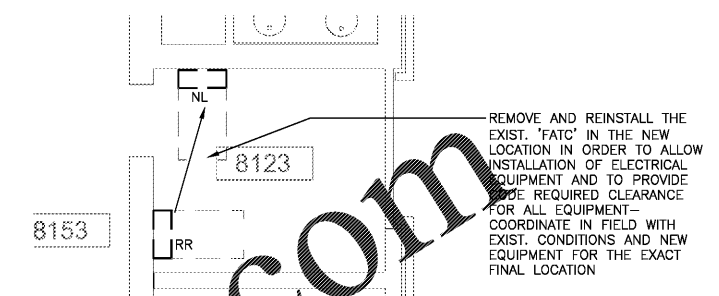
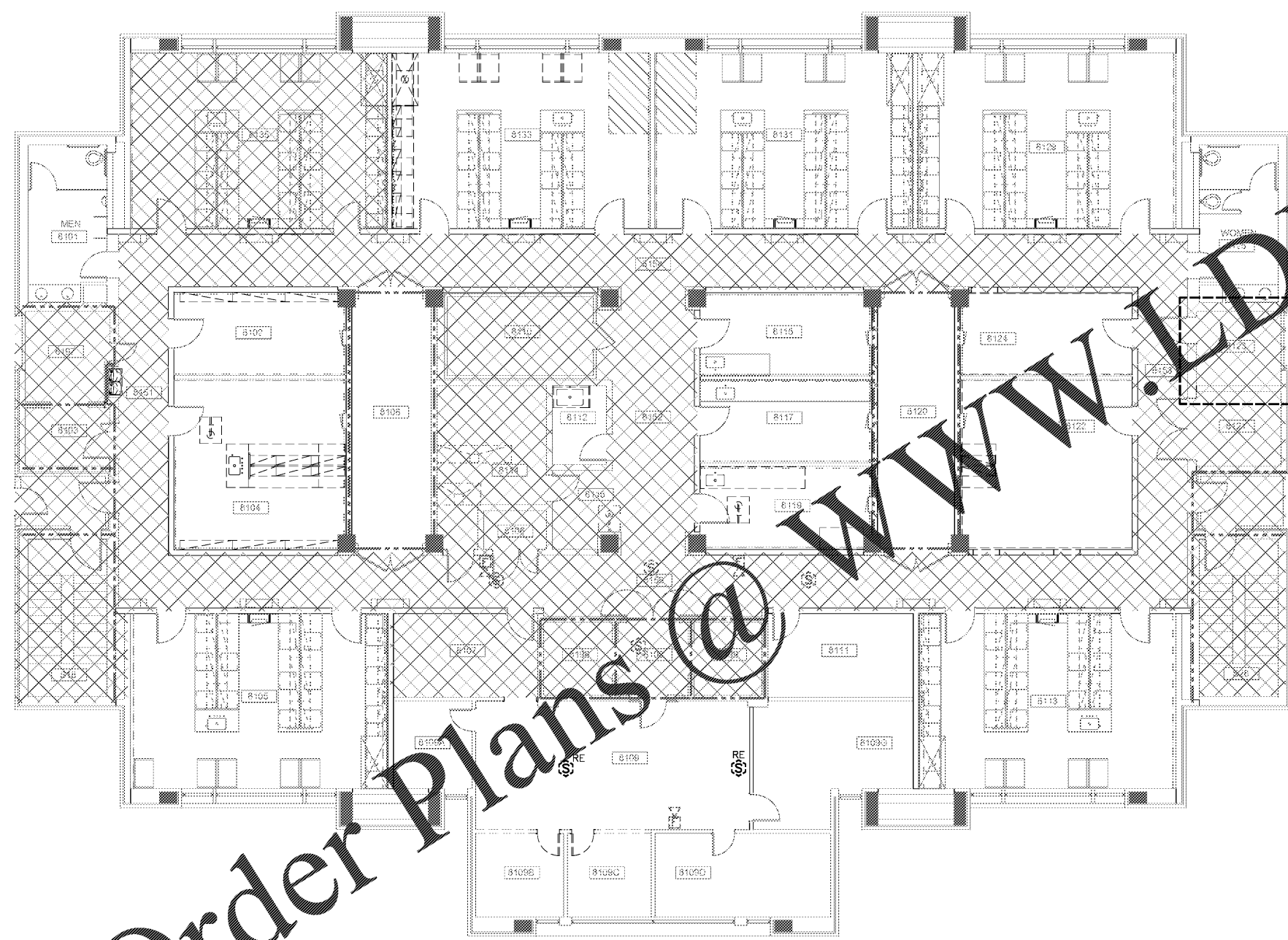

REMOVE AND REINSTALL THE EXIST. "FATC" IN THE NEW LOCATION IN ORDER TO ALLOW INSTALLATION OF ELECTRICAL EQUIPMENT AND TO PROVIDE THE REQUIRED CLEARANCE FOR ALL EQUIPMENT—COORDINATE IN FIELD WITH EXIST. CONDITIONS AND NEW EQUIPMENT FOR THE EXACT FINAL LOCATION

2 ENLARGED FLOOR PLAN — RM 8123
ED138 SCALE: 1/4"=1'-0"

1 EIGHTH FLOOR PLAN — FIRE ALARM — DEMOLITION
ED138 SCALE: 1/8"=1'-0"

PARTITION AND WALL LEGEND	
	1-HOUR FIRE BARRIER
	2-HOUR FIRE BARRIER
	3-HOUR FIRE BARRIER

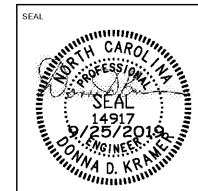
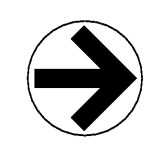

LORD AECK SARGENT
A KATERRA COMPANY

Kramer Engineering Services
5517 Cascade Dr.
Chapel Hill, NC 27514
TEL: (919) 953-3350
email: donna@kesapl.com
Firm License P-1089

REVISION:

SHEET TITLE: EIGHTH FLOOR PLAN-FIRE ALARM-DEMOLITION
SCALE (IN.): 1/8" = 1'-0"
16 FT
8 FT
0

UNC SCHOOL OF MEDICINE
NEUROSCIENCES RESEARCH BUILDING
7th & 8th FLOORS FOR DERMATOLOGY
LOCATION: 5 Wilson Farm Road, Campus, Box 7250
Chapel Hill, North Carolina 27599-7250

ISSUE DATE: 9/25/2019
JOB NO: 10761-00
DWG NO: ED138

BID SET