

K
J
H
G
F
E
D
C
B
A

Order Plans @ www.LDILine.com

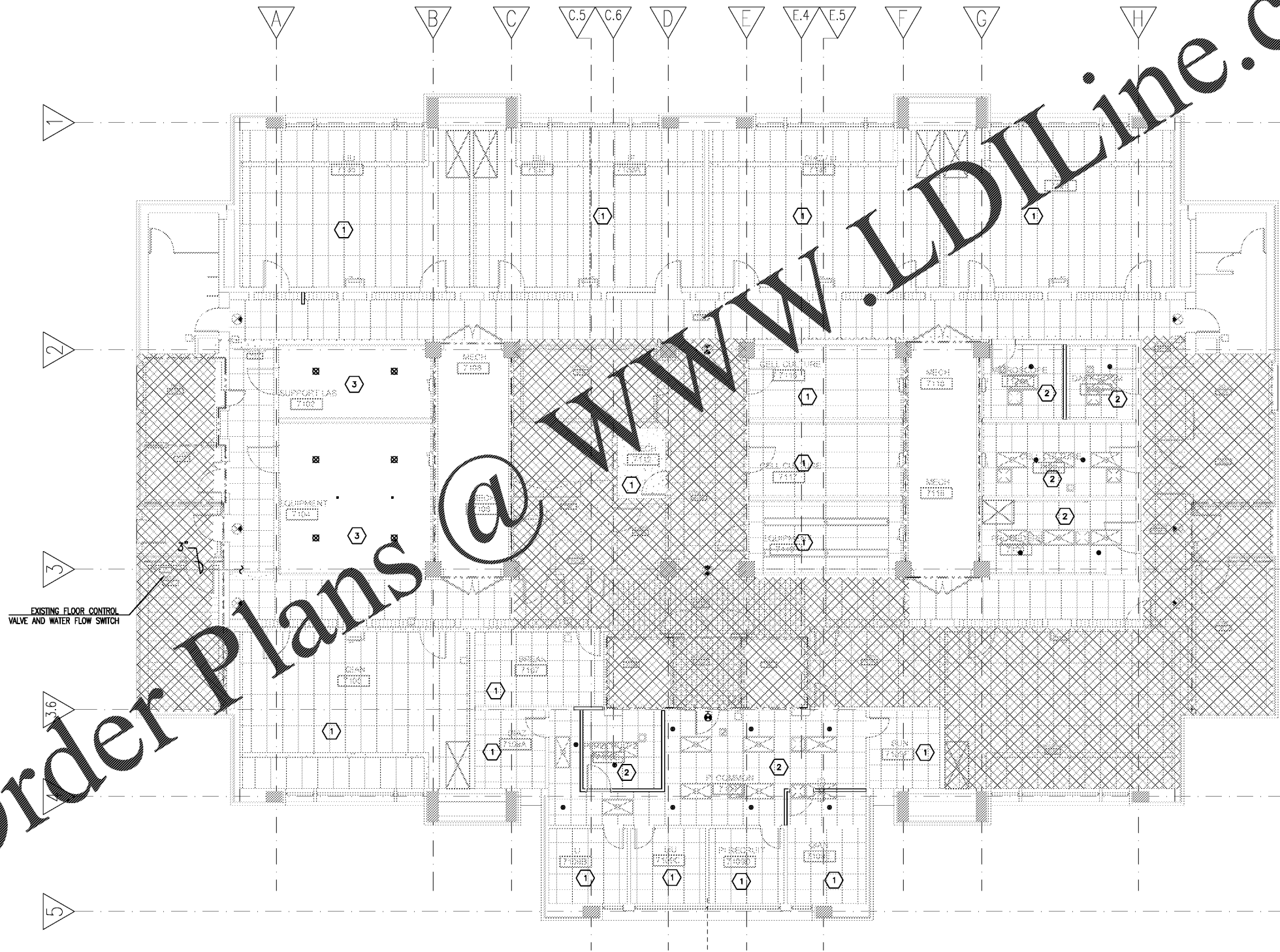

- GENERAL NOTES**
- BRANCH PIPING SHALL BE INSTALLED TO MATCH CONTRACTOR WORKING DRAWINGS AND SHALL BE RE-WORKED AS NEEDED TO COORDINATE WITH DUCTWORK, REHEAT COILS, LIGHT FIXTURES, ETC.
 - SPRINKLER HEADS SHALL BE CENTERED IN CEILING TILES.
 - REFER ALSO TO ARCHITECT'S REFLECTED CEILING PLAN, SHEET A407.
 - FLEXIBLE PIPE SPRINKLER CONNECTORS SHALL NOT BE UTILIZED UNLESS HYDRAULIC CALCULATIONS ARE COMPLETED.

- SHEET KEYED NOTES:**
- NO SPRINKLER WORK THIS ROOM.
 - REMOVE AND REPLACE EXISTING PENDANT SPRINKLERS WITH NEW, PENDANT SPRINKLERS IN THIS ROOM. SPRINKLERS SHALL BE CENTERED IN CEILING TILES. RE-WORK BRANCH PIPING AS NEEDED TO COORDINATE WITH OTHER TRADES INCLUDING LIGHT FIXTURES, DIFFUSERS, AND DUCTWORK.
 - REMOVE AND REPLACE EXISTING PENDANT SPRINKLERS WITH NEW, UPRIGHT SPRINKLERS IN THIS ROOM. RE-WORK BRANCH PIPING AS NEEDED TO COORDINATE WITH OTHER TRADES INCLUDING LIGHT FIXTURES, FAN COIL UNIT, AND DUCTWORK. SPRINKLER HEADS SHALL BE LOCATED SO THAT DUCTWORK, FAN COIL UNIT, AND LIGHTS DO NOT OBSTRUCT SPRINKLER FLOW.

PARTITION AND WALL LEGEND

	1-HOUR FIRE BARRIER
	2-HOUR FIRE BARRIER

1 SEVENTH FLOOR PLAN - FIRE PROTECTION
 FP107 1/8" = 1'-0"

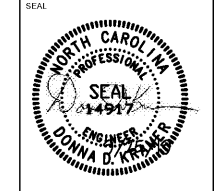

LORD AECK SARGENT
 A KATERRA COMPANY

Kramer Engineering Services, plc
 5517 Cascade Dr.
 Chapel Hill, NC 27514
 TEL: (919) 933-3350
 email: Donna@KESplc.com
 Firm License: P-1099

UNC SCHOOL OF MEDICINE
 NEUROSCIENCES RESEARCH BUILDING
 7th & 8th FLOORS FOR DERMATOLOGY
 LOCATION:
 115 Mason Farm Road, Campus Box 7250
 Chapel Hill, North Carolina 27598-7250

ISSUE DATE: 09/25/2019
 JOB NO: 10761-00
 DWG. NO: FP107

SCALE: 1/8" = 1'-0"
 0 4 8 16 FT

BID SET