

LAB CASEWORK MENU

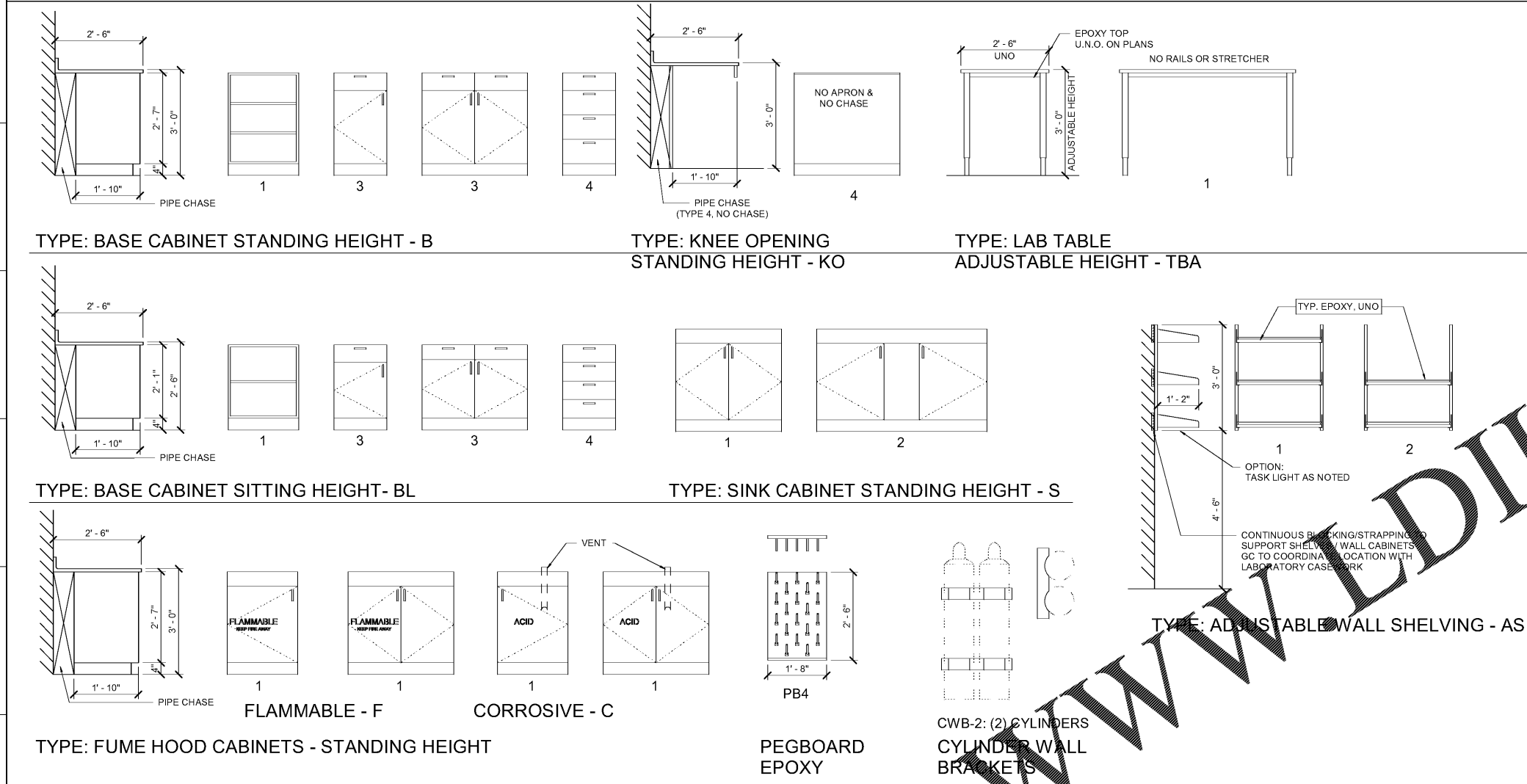

CASEWORK KEY LEGEND

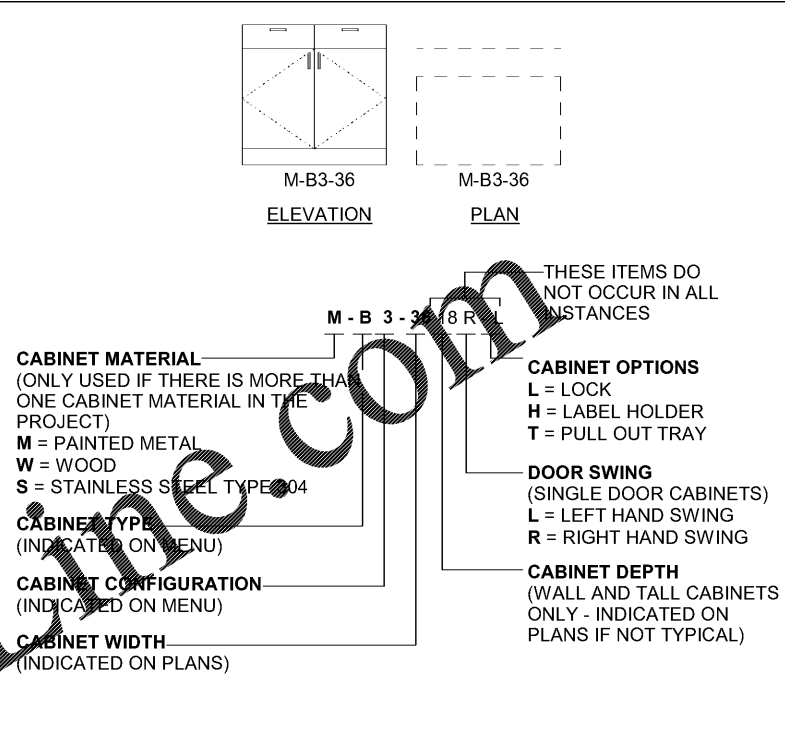

LAB CASEWORK SYMBOL AND FIXTURE LEGEND

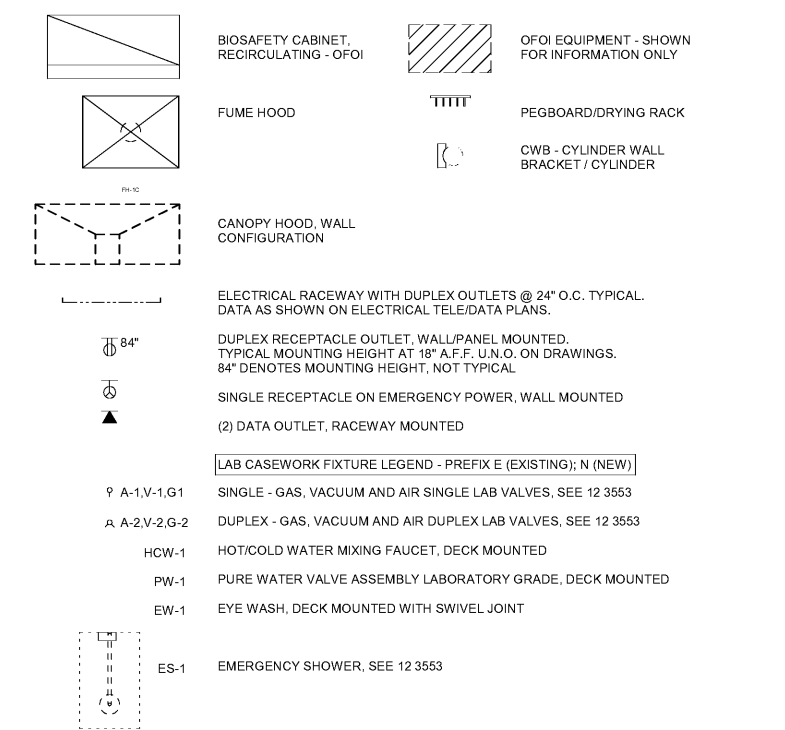

LAB CASEWORK GENERAL NOTES

- THIS PROJECT IS A RENOVATION WORK AND MOST OF THE LAB CASEWORK IS EXISTING. PRIOR TO COMMENCING WORK, CONTRACTOR SHALL CAREFULLY EXAMINE THE EXISTING LABORATORY CASEWORK AND DRAWINGS TO COORDINATE THE WORK.
- FIELD VERIFY ALL DIMENSIONS BEFORE FABRICATION.
- OVERALL LENGTH OF TOPS SHALL BE DETERMINED BY CASEWORK AND/OR DIMENSIONS AS INDICATED ON LC DRAWINGS. SUCH LENGTHS SHALL REMAIN CONSTANT REGARDLESS OF MANUFACTURER'S STANDARDS. TOPS SHALL OVERHANG 1 INCH AT EACH END AND 1 INCH FROM THE FRONT OF BASE CABINET OR HORIZONTAL RAIL U.N.O. IF OVERALL DIMENSIONS ARE GIVEN, THE 1 INCH OVERHANG IS INCLUDED.
- OVERALL HEIGHT OF BASE CABINET TOPS MUST BE MAINTAINED AS SHOWN ON DRAWINGS (NOMINAL HEIGHT).
- INSTALLATION OF CASEWORK SHALL BEGIN AT THE HIGH POINT OF THE ROOM WITH LEVELERS SCREWED IN AS FAR AS POSSIBLE.
- WORK SURFACES AND SPLASHES SHALL BE SCRIBED TO MATCH IRREGULARITIES AND CONTOURS OF WALLS.
- ALL EXPOSED-TO-VIEW COUNTERTOP EDGES, BACKS OF SPLASHES, ALL EDGES OF TABLES, BACKS OF COUNTERTOPS AND SPLASHES HELD AWAY FROM WALL SHALL BE FILLED, SEALED, AND FINISHED. CAULK ALL BACK SPLASHES AND COUNTERTOPS TO WALL WITH SEALANT AS SPECIFIED.
- FILLER PANELS SHALL BE USED BETWEEN BACK OF CABINETS OR HOODS AND WALLS AT EXPOSED ENDS AND WHEN BASE CABINETS AND/OR HOODS ARE SET BACK-TO-BACK. FILLER SHALL OCCUR EVEN WHERE NO BASE CABINET OCCURS BUT BENCH IS PRESENT.
- ALL CASEWORK, FUME HOODS AND ANY OTHER FURNISHINGS WITH EXPOSED-TO-VIEW BACKS AND SIDES SHALL BE FINISHED.
- UNLESS OTHERWISE NOTED, ALL UNISTRUT BRACKETS AND FITTINGS INDICATED ON LABORATORY CASEWORK DRAWINGS SHALL BE SUPPLIED BY LABORATORY CASEWORK MANUFACTURER. ALL UNISTRUT OR OTHER PIPE SUPPORT BRACKETS AND SYSTEMS TO BE PREFINISHED; COLOR TO BE SELECTED BY ARCHITECT TO MATCH CASEWORK COLOR.
- FOR PLUMBING SERVICE FITTING TYPES, LOCATIONS AND ORDER, SEE LC SERIES FLOOR PLANS AND DETAILS. THESE FITTINGS SHALL BE SUPPLIED AND INSTALLED FINGER TIGHT IN THE PROPER LOCATION BY LABORATORY CASEWORK INSTALLER FOR FINAL CONNECTION BY PLUMBER.
- ALL LABORATORY SINKS AND CUP SINKS SHALL BE FURNISHED AND INSTALLED BY LABORATORY CASEWORK INSTALLER.
- ALL PENETRATIONS THROUGH WORK SURFACES SHALL BE CAULKED AND SEALED AS NEEDED.
- ARCHITECT SHALL SELECT COLORS FOR ALL COMPONENTS OF CASEWORK INDICATED ON THESE DRAWINGS. COLOR SELECTION SHALL BE FROM MANUFACTURER'S STANDARD COLOR.
- FUME HOODS ARE TO BE PRE-WIRED AND PRE-PLUMBED.
- FUME HOOD SUPPLIER TO PROVIDE TRANSITION COLOR FOR CONNECTION TO EXHAUST DUCT.
- ALL CASEWORK TOPS THAT ABUT WALLS, FUME HOODS OR TALL STORAGE CABINETS SHALL HAVE BACKSPLASH AND/OR SIDESPLASH. EXCEPTION SHALL BE AT MOVABLE TABLES THAT ABUT WALLS OR FUME HOODS.
- AT WALL CASEWORK LOCATIONS, MOUNT SERVICE FIXTURES CENTERED WITH THE CABINET BELOW AND SHELVING ABOVE, U.N.O. WHERE MULTIPLE SERVICE FIXTURES OCCUR, SPACE 6 INCHES APART.
- CENTER ALL SINKS IN SINK CABINET U.N.O. ON LABORATORY DETAILS. PROVIDE MARINE EDGE WORK SURFACE AT INTEGRAL STAINLESS STEEL SINK.
- ALL SHELVING SUPPORT STANDARDS, BRACKETS, AND FITTINGS INDICATED ON LABORATORY CASEWORK DRAWINGS SHALL BE PROVIDED AND PAINTED AS SPECIFIED.

LAB SINK SCHEDULE

SINK TYPE	DESCRIPTION	FIXTURE 1	FIXTURE 2	FIXTURE 3
SK-1	EPOXY RESIN SURFACE SINK 22" L x 16" W x 11" D	HCW-1	EW-1	
SK-2	STAINLESS STEEL WORK SURFACE WITH INTEGRAL 22" L x 16" W x 11" D SINK	HCW-1	EW-1	PW-1

LORD AECK SARGENT
A KATERA COMPANY
© 2018 Lord Aeck Sargent. All rights reserved. This document is the property of Lord Aeck Sargent and is to be returned upon demand. The information herein is confidential and may not be used or divulged without the written permission of Lord Aeck Sargent.



SHEET TITLE
LAB CASEWORK MENU, NOTES AND LEGEND
SCALE (N/A)

UNC SCHOOL OF MEDICINE
NEUROSCIENCES RESEARCH BUILDING
SCO PROJECT ID: 11-09861-02G
7th & 8th FLOORS FOR DERMATOLOGY
LOCATION
115 Mason Farm Road, Campus Box 7250
Chapel Hill, North Carolina, 27599-7250

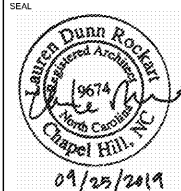

ISSUE DATE
09/25/2019
JOB NO.
10761-00
DWG. NO.
LC001

BID SET