

PLUMBING FIXTURE SCHEDULE

TAG	FIXTURE	MANUFACTURER	MODEL	DESCRIPTION	QUANTITY	CONNECTION SIZES			SUBTOTAL FIXTURE UNITS		
						HW	CW	WASTE	HW	CW	SAN
ET-1	EXPANSION TANK	AMTROL	ST-5	2 GALLON CAPACITY	1		3/4"		0	0	0
ET-2	EXPANSION TANK	AMTROL	WX-200	34.0 GALLON PRE-CHARGED EXPANSION TANK WITH 4.1 GALLON ACCEPTANCE FROM 60 TO 40 PSI	1		3/4"		0	0	0
FD-1	FLOOR DRAIN	SILOX CHIEF	842-2-PNR	ADJUSTABLE FLOOR DRAIN, ROUND POLISHED METAL RING AND STRAINER	1			2"	0	0	2
LV-1	RESTROOM LAVATORY	WS BATH COLLECTIONS	UNLIMITED 60	ADA COMPLIANT, WALL MOUNTED, PORCELAIN LAVATORY WITH ADA COMPLIANT KOHLER K-13467 CP AUTOMATIC FAUCET WITH 0.5 GPM AERATOR AND INTEGRAL ASH-K1317.1 THERMOSTATIC MIXING VALVE	4	1/2"	1/2"	1 1/2"	4	4	4
P-1	RECIRCULATING PUMP	TACO	003-BC4-PMP	DOMESTIC HOT WATER CARTRIDGE-TYPE CIRCULATOR WITH INTEGRAL TIMER. PROVIDE WITH AQUASTAT SET AT APPROXIMATELY 100° F.	1		1/2"		0	0	0
SK-1	DOMESTIC SINK	FURNISHED BY GC		STAINLESS STEEL SINGLE COMPARTMENT SINK. FURNISHED WITH DECK MOUNTED FAUCET. SEE ARCHITECTURAL DRAWINGS FOR MAKE AND MODEL.	1	1/2"	1/2"	2"	1.5	1.5	1
SK-2	DOMESTIC SINK	FURNISHED BY GC		STAINLESS STEEL SINGLE COMPARTMENT SINK. FURNISHED WITH DECK MOUNTED FAUCET. SEE ARCHITECTURAL DRAWINGS FOR MAKE AND MODEL.	2	1/2"	1/2"	2"	3	3	2
SK-3	DOMESTIC SINK	FURNISHED BY GC		STAINLESS STEEL SINGLE COMPARTMENT SINK. FURNISHED WITH DECK MOUNTED FAUCET. SEE ARCHITECTURAL DRAWINGS FOR MAKE AND MODEL.	2	1/2"	1/2"	2"	3	3	2
WC-1	WATER CLOSET	KOHLER	WC: K-4325-O, SEAT: K-4731-SC-O	ADA COMPLIANT ELONGATED WALL MOUNT 1.28 GPF FLUSH VALVE TOILET. INSTALL WITH SEAT HEIGHT SET AT 17" AFF. PROVIDE WITH KOHLER K-7531 BATTERY-POWERED AUTOMATIC FLUSH VALVE AND DURIN ZN1203-NA (ZURN ZN1203-NBA FOR BACK-TO-BACK APPLICATIONS) SERIES WATER CLOSET CARRIER. ADJUST FLUSH VALVE HEIGHT TO AVOID GRAB BARS PER THE MANUFACTURER'S INSTALLATION INSTRUCTIONS.	4		1"	3"	0	20	24
WF-1	WF-1	ELKAY	LZSRWSP	ENHANCED ED120 BOTTLE FILLING STATION AND SINGLE ADA COOLER	1		1/2"	1 1/4"	0	1	0.5
Grand total									11.5	32.5	35.5

WATER HEATER SCHEDULE

TAG	DESCRIPTION	MANUFACTURER	MODEL	STORAGE	INPUT KW	RECOVERY RATE (GPH)	TEMP. RISE	WATER CONN.	WEIGHT	TANK DIAMETER	NOTES
DWH-1	COMMERCIAL ELECTRIC WATER HEATER	A. O. SMITH	DEL-40-6KW	40 gal	6	29	83 °F	3/4"	150	24"	20R/11B

PLAN NOTES

- CONNECT TO EXISTING 1-1/4" WATER SERVICE. COORDINATE INSTALLATION AND ANY METERING REQUIREMENTS WITH LANDLORD AND WATER COMPANY.
- 1-1/4" DOMESTIC WATER LINE AND SHUTOFF VALVE.
- PROVIDE WATER HAMMER ARRESTOR ON WATER SUPPLY PIPE TO WATER CLOSET.
- PROVIDE WATER HEATER DUCT PER DET-1/P300.
- PROVIDE HOT WATER CONNECTION FOR DOMESTIC DISHWASHER, AT 24" AFF. DISHWASHER TO BE SUPPLIED WITH INTEGRAL VACUUM BREAKER.
- PROVIDE PROVIDE ACCESSIBLE SHUTOFF VALVE IN LINE AS SHOWN.
- PROVIDE COLD WATER CONNECTION FOR REFRIGERATOR AT 24" AFF. DISHWASHER TO BE SUPPLIED WITH TUBULAR AIR GAP.
- PROVIDE TEE OFF OF WATER CONNECTIONS FOR SK-1, SK-2, SK-3, AND WF-1. PROVIDE TEE OFF OF WATER CONNECTIONS FOR SK-1, SK-2, SK-3, AND WF-1. PROVIDE TEE OFF OF WATER CONNECTIONS FOR SK-1, SK-2, SK-3, AND WF-1. PROVIDE TEE OFF OF WATER CONNECTIONS FOR SK-1, SK-2, SK-3, AND WF-1.

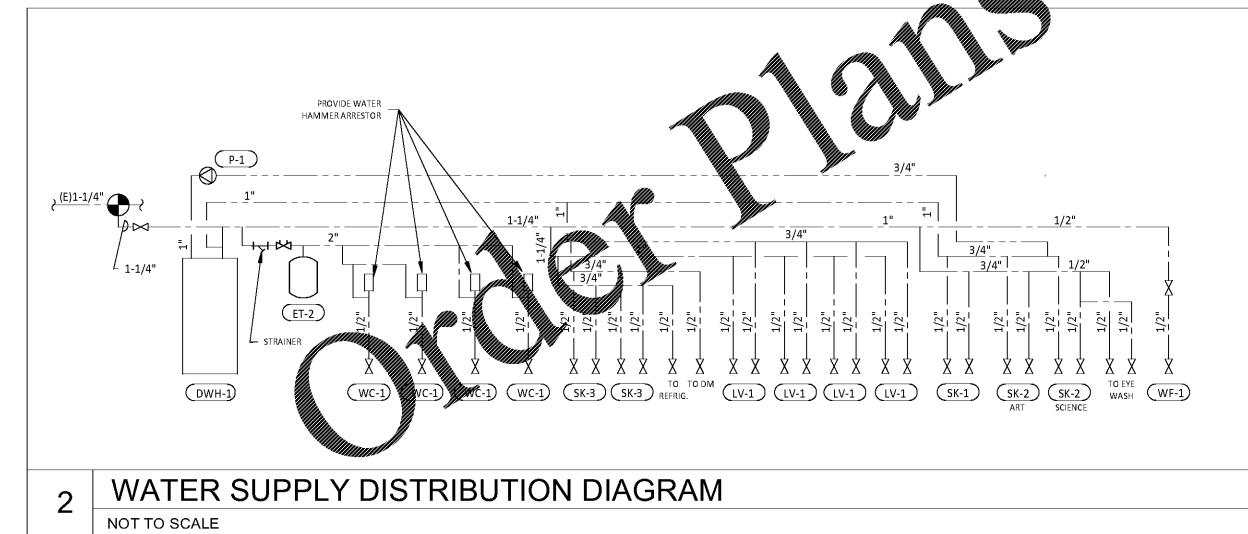

2 WATER SUPPLY DISTRIBUTION DIAGRAM
NOT TO SCALE

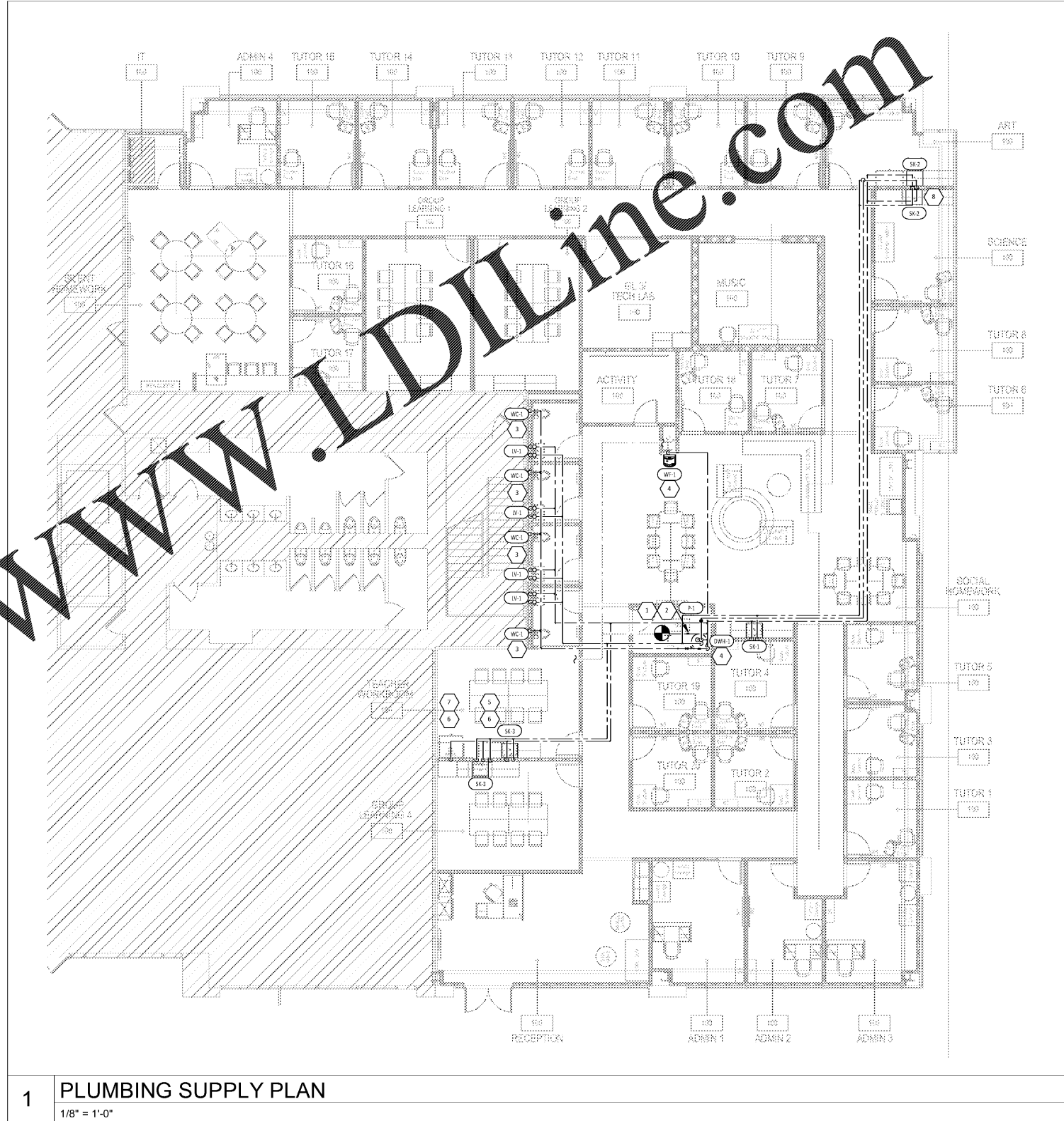

1 PLUMBING SUPPLY PLAN
1/8" = 1'-0"

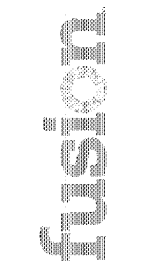

FUSION ACADEMY - Charlotte, NC
3540 TORINGDON WAY, SUITE 100
CHARLOTTE, NC 28277

788 Morrison Road
Columbus, Ohio 43230
Phone: (614) 751-9670
Fax: (614) 552-5240
Contact: Rich Jones
(614) 328-2022
RT.Jones@NationalEngineering.com



ISSUANCE/REVISIONS

- ISSUE FOR PERMIT 08/19/19
- REV 1 PER CITY 08/21/19
- REV 2 PER CITY 08/21/19
- REV 3 PER CITY 08/26/19
- REV 4 PER CITY 08/29/19
- REV 5 PER CLIENT AND ISSUE FOR BID 08/30/19



North Carolina Firm Registration
NCBOE: P-0612
Sec of State: 0909178

COPYRIGHT 2019
THIS DRAWING IS AN INSTRUMENT OF SERVICE AND AS SUCH REMAINS THE PROPERTY OF NATIONAL ENGINEERING, LTD. PERMISSION FOR USE OF THIS DOCUMENT IS LIMITED AND CAN BE EXTENDED ONLY BY WRITTEN AGREEMENT WITH NATIONAL ENGINEERING, LTD.

Drawn By: KAT
Checked By: RTJ
Scale: As indicated
Date: 07.23.2019
Job No.: 1902037
Sheet No.: P100

