

GENERAL NOTES:

- REFER TO FINISH SCHEDULE FOR FLOOR COVERING AND FINISH CODES AND SPECIFICATIONS.
- TILE IS SHOWN FOR FIELD RUN AND PATTERN ONLY. REFER TO COLOR AND FINISH SCHEDULE FOR MATERIAL SPECIFICATIONS.
- ALL PAINTED AND WALL COVERING SURFACES SHALL BE PRIMED. SEE ARCHITECT'S SPECIFICATION SHEET AND PAINT MANUFACTURER SPECIFICATIONS.
- WHERE APPLICABLE, ALL METAL SURFACES TO BE PAINTED WITH LOW GLOSS OIL BASE PRIMER AND OIL BASE FINISH COATS IN COLOR INDICATED ON DRAWING.
- PAIN ON ALL GYP. BD. SURFACES TO BE APPLIED WITH A HEAVY KNAP ROLLER.
- GROUT TO BE SEALED PER MANUFACTURER'S RECOMMENDATIONS. CLEAN SEALER OFF THE ADJACENT FLOOR FINISHES.
- ENSURE PROPER ENVIRONMENTAL CONDITIONS ARE MET FOR THE INSTALLATION OF ALL INTERIOR FINISHES.
- FOR TILE CONTROL JOINTS, FOLLOW TILE MANUFACTURER'S RECOMMENDATIONS.
- FLOOR FINISHES TO CONTINUE UNDER GYP. BD. GYP. BD. TO BE HELD UP FROM FLOOR SLAB. IF GYP. BD. DOES NOT ALLOW FINISH UNDERNEATH, HOLD FLOOR FINISH AS TIGHT AS POSSIBLE TO GYP. BD.
- G.C. TO TOUCH UP PAINT PRIOR TO SCHOOL OPENING.
- G.C. SHALL FURNISH AND INSTALL TWO LAYERS OF CRAFT PAPER OVER ALL TILE AND GROUT ON FLOORS. TAPE DOWN AND STAGGER SEAMS BY HALF THE PAPER WIDTH ON THE SECOND LAYER.
- FLOOR COVERINGS ARE TO BE SLIP RESISTANT THROUGHOUT THE MEANS OF EGRESS.
- EXISTING CONCRETE SUBFLOOR TO BE FLASH PATCHED AS REQUIRED TO PROVIDE LEVEL SURFACE FOR SMOOTH, LEVEL FINISH FLOOR.
- ALL WALLS AND GYP. BD. CEILINGS SHALL RECEIVE ONE COAT PRIMER & TWO COATS FINISH.
- ALL HOLLOW METAL DOOR FRAMES SHALL RECEIVE ONE COAT PRIMER & TWO COATS P-9, MINIMUM.

MARK	ROOM	FLOOR		WALLS (REFER TO PLAN NORTH)				CEILING		REMARKS
		FINISH	BASE	NORTH	EAST	SOUTH	WEST	FINISH	HEIGHT	
100	RECEPTION	CPT-1	CPT-1	P-2	P-1	P-1	P-2	ACT-1	10'-8"	
101	ADMIN 1	CPT-1	CPT-1	P-1	P-1	P-1	P-1	ACT-1	10'-8"	
102	ADMIN 2	CPT-1	CPT-1	P-1	P-1	P-1	P-1	ACT-1	10'-8"	
103	ADMIN 3	CPT-1	CPT-1	P-1	P-1	P-1	P-1	ACT-1	10'-8"	
104	TUTOR 1	CPT-1	CPT-1	P-1	P-1	P-1	P-1	ACT-1	10'-8"	
105	TUTOR 2	CPT-1	CPT-1	P-1	P-1	P-1	P-1	ACT-1	9'-0"	
106	TUTOR 3	CPT-1	CPT-1	P-1	P-1	P-1	P-1	ACT-1	10'-8"	
107	TUTOR 4	CPT-1	CPT-1	P-1	P-1	P-1	P-1	ACT-1	9'-0"	
108	TUTOR 5	CPT-1	CPT-1	P-1	P-1	P-1	P-1	ACT-1	10'-8"	
109	HOMEWORK LIBRARY	CPT-1	CPT-1	P-1	P-1, P-2	P-1, P-2	P-1	ACT-1	10'-11 1/2"	ALL WALLS TO BE PAINTED P-1 U.N.O.
110	TUTOR 6	CPT-1	CPT-1	P-1	P-1	P-1	P-1	ACT-1	10'-8"	
111	TUTOR 7	CPT-1	CPT-1	P-1	P-1	P-1	P-1	ACT-1	9'-0"	
112	TUTOR 8	CPT-1	CPT-1	P-1	P-1	P-1	P-1	ACT-1	10'-8"	
113	SCIENCE	VT-1	WB-1	P-1	P-1	P-1	P-1	ACT-1	10'-8"	
114	ART	VT-1	WB-1	P-1	P-1	P-1	P-1	ACT-1	10'-8"	
115	TUTOR 9	CPT-1	CPT-1	P-1	P-1	P-1	P-1	ACT-1	10'-8"	
116	MUSIC	CPT-1	CPT-1	P-2/A-1	P-2/A-1	P-2/A-1	P-2/A-1	GYP. BD.	9'-0"	
117	TUTOR 10	CPT-1	CPT-1	P-1	P-1	P-1	P-1	ACT-1	10'-8"	
118	TUTOR 11	CPT-1	CPT-1	P-1	P-1	P-1	P-1	ACT-1	10'-8"	
119	GL 3 / TECH LAB	CPT-1	WB-2	P-7	P-7	P-7	P-2	ACT-2	9'-0"	INTERIOR SIDE OF DOOR AND WINDOW FRAME TO BE PAINTED P-6
120	TUTOR 12	CPT-1	CPT-1	P-1	P-1	P-1	P-1	ACT-1	10'-8"	
121	GROUP LEARNING 2	CPT-1	CPT-1	P-1	P-2	P-1	P-1	ACT-1	9'-0"	
122	TUTOR 13	CPT-1	CPT-1	P-1	P-1	P-1	P-1	ACT-1	10'-8"	
123	GROUP LEARNING 1	CPT-01	CPT-1	P-1	P-1	P-1	P-2	ACT-1	9'-0"	
124	TUTOR 14	CPT-1	CPT-1	P-1	P-1	P-1	P-1	ACT-1	10'-8"	
125	TUTOR 15	CPT-1	CPT-1	P-1	P-1	P-1	P-1	ACT-1	10'-8"	
126	ADMIN 4	CPT-1	CPT-1	P-1	P-1	P-1	P-1	ACT-1	10'-8"	
127	IT	-	-	P-1	P-1	P-1	P-1	ACT-1	10'-8"	
128	SILENT READING LIBRARY	CPT-1	CPT-1	P-1	P-1	P-1, P-2	P-1	ACT-1	9'-0"	ALL WALLS TO BE PAINTED P-1 U.N.O.
129	TUTOR 16	CPT-1	CPT-1	P-1	P-1	P-1	P-1	ACT-1	9'-0"	
130	TUTOR 17	CPT-1	CPT-1	P-1	P-1	P-1	P-1	ACT-1	9'-0"	
131	TUTOR 18	CPT-1	CPT-1	P-1	P-1	P-1	P-1	ACT-1	9'-0"	
132	ACTIVITY	VT-1	WB-1	P-1	P-1	P-1	P-1	ACT-1	9'-0"	
133	STORAGE	-	-	P-1	P-1	P-1	P-1	ACT-1	9'-0"	
134	TUTOR 19	CPT-1	CPT-1	P-1	P-1	P-1	P-1	ACT-1	9'-0"	
135	TEACHER WORKROOM	CPT-1	CPT-1	P-1	P-1	P-1	P-1	ACT-1	9'-0"	
136	TUTOR 20	CPT-1	CPT-1	P-1	P-1	P-1	P-1	ACT-1	9'-0"	
137	GROUP LEARNING 4	VT-1	WB-01	P-1	P-1	P-1	P-2	ACT-1	9'-0"	
138	RESTROOM 1	CT-1	CT-1	P-1	P-6	P-1	CT-1	GYP. BD.	9'-0"	PAINT OFF BY CEILING P-4 FINISH TO BE SMOOTH, EARLY CLEANABLE AND NON-ABSORBENT.
139	RESTROOM 2	CT-1	CT-1	P-1	P-6	P-1	CT-1	GYP. BD.	9'-0"	PAINT OFF BY CEILING P-4 FINISH TO BE SMOOTH, EARLY CLEANABLE AND NON-ABSORBENT.
140	RESTROOM 3	CT-1	CT-1	P-1	P-6	P-1	CT-1	GYP. BD.	9'-0"	PAINT OFF BY CEILING P-4 FINISH TO BE SMOOTH, EARLY CLEANABLE AND NON-ABSORBENT.
141	RESTROOM 4	CT-1	CT-1	P-1	P-6	P-1	CT-1	GYP. BD.	9'-0"	PAINT OFF BY CEILING P-4 FINISH TO BE SMOOTH, EARLY CLEANABLE AND NON-ABSORBENT.
142	CORRIDOR 1	CPT-1	CPT-1	P-1	P-1	P-1	P-1	ACT-1	9'-0"	ALL WALLS TO BE PAINTED P-1 U.N.O.
143	CORRIDOR 2	CPT-1	CPT-1	-	P-1	P-1	P-1	ACT-1	9'-0"	ALL WALLS TO BE PAINTED P-1 U.N.O.
144	CORRIDOR 3	CPT-1	CPT-1	P-1	P-1	-	-	ACT-1	9'-0"	ALL WALLS TO BE PAINTED P-1 U.N.O.
145	CORRIDOR 4	CPT-1	CPT-1	P-1	P-1	P-1	-	ACT-1	9'-0"	ALL WALLS TO BE PAINTED P-1 U.N.O.
146	CORRIDOR 5	CPT-1	CPT-1	-	P-1	-	P-1	ACT-1	9'-0"	ALL WALLS TO BE PAINTED P-1 U.N.O.

2 ROOM FINISH SCHEDULE

KEY	MAT'L DESCRIPT.	MFG.	SPECIFICATION	REMARKS
A-1	ACOUSTIC TREATMENT	AURALEX	PROKIT-1 OBSIDIAN	INSTALL PER MANUFACTURER SPECIFICATIONS
ACT-1	CEILING	ARMSTRONG	1852 24 x 24 x 9/16"	BEVELED TEG SILH. WHITE 1/2" REVEAL
ACT-2	CEILING	ARMSTRONG	CALLA BLACK 2822 BLACK 24 x 24	TO BE USED IN TECH LAB
CPT-1	CARPET	INTERFACE	CUBIC 1380102500 6395 CONSTRUCTION 19.69" x 19.69"	CARPET TO BE QUARTER TURNED CARPET BASE TO BE 4" HIGH, EDGE BOUND WITH FABRIC BIDDING, TOP EDGE COLOR: 997.
CT-1	CERAMIC TILE	ANATOLIA TILE & STONE	62-735 12" x 12" NATURAL	GROUT LATICRETE #59 - ESPRESSO. TOP TILE TO HAVE BULLNOSE EDGE
P-1	PAIN	SHERWIN WILLIAMS	SW-7015 EXT. WHITE	FOR USE ON ALL WALLS, U.N.O.
P-2	PAIN	SHERWIN WILLIAMS	SW-8839 KIMBLE VIOLET	FOR USE ON ACCENT WALLS
P-4	PAIN	SHERWIN WILLIAMS	SW-7006 EXT. WHITE	FOR USE ON CEILING
P-6	PAIN	SHERWIN WILLIAMS	SW-1222 ANNIVALEGG SHELL	FOR USE ON DOOR WALL
P-7	PAIN	BENJAMIN MOORE	ROCKY COAST 1595x EGG SHELL	FOR USE IN TECH LAB
P-8	PAIN	BENJAMIN MOORE	NIGHTFALL 1596	FOR USE ON INTERIOR SIDE OF DOOR AND WINDOW FRAME OF TECH LAB
P-9	PAIN	SHERWIN WILLIAMS	SW7014 EIDER WHITE	FOR USE ON H.M. DOOR FRAMES
VT-1	LUXURY VINYL TILE	INTERFACE	LEVEL SET COLLECTION A10207 WASHED WHEAT 9.845" x 39.38" INSTALLED ASHLAR	
WB-1	VINYL BASE	JOHNSONITE	MOON ROCK	VINYL COVE
WB-2	VINYL BASE	JOHNSONITE	MILLWORK REVEAL 63 BURNT UMBER 4.25"H	FOR USE IN TECH LAB

1 FINISH SPECIFICATIONS

SCALE: NONE

FINISH KEY

- CPT-1 MAIN CARPET TILE THROUGHOUT. REFER TO FINISH SCHEDULE FOR SPEC.
- CT-1 AT RESTROOMS. REFER TO FINISH SCHEDULE FOR SPEC.
- VT AT SCIENCE, ACTIVITY, IT, ART, AND GROUP LEARNING 2. REFER TO FINISH SCHEDULE FOR SPEC.
- FLOOR MATERIAL TRANSITION. REFER TO DETAIL 8/A3.3 FOR DETAILS

PLAN KEY NOTES:

- LATICRETE HYDRO BARRIER WATERPROOFING REQUIRED AT SINK LOCATIONS
- NOT USED
- WATERPROOF MEMBRANE PER DETAIL 2/A3.3 REQUIRED IN ALL RESTROOMS. REFER TO SHEETS F1.1A AND F1.1B FOR INFORMATION ON MILLWORK, COUNTER TOP, AND BACK SPLASH.
- FINISH WALL TO LEVEL 5 FINISH. PAINT WALL P-2, FLOOR TO CEILING.
- REFER TO DETAIL 8/A3.3
- PAINT WALL P-6, FLOOR TO CEILING.
- G.C. TO INSTALL ROOM SPECIFIC VINYL BASE, CEILING GRID AND TILES, AND WALL TRIM PAINT. REFER TO DETAIL 1 THIS SHEET FOR SPECS.

ROOM #	ROOM NAME	FLOOR FIN.	AREA
113	SCIENCE	VT-1	129 SF
114	ART	VT-1	137 SF
132	ACTIVITY	VT-1	111 SF
137	GROUP LEARNING 4	VT-1	234 SF
138	RESTROOM 1 (FLOOR & WALL)	CT-1	121 SF
139	RESTROOM 2 (FLOOR & WALL)	CT-1	121 SF
140	RESTROOM 3 (FLOOR & WALL)	CT-1	121 SF
141	RESTROOM 4 (FLOOR & WALL)	CT-1	121 SF
-	GENERAL	CPT-1	6,708 SF

NOTE: THESE FIGURES ARE FOR FUSION REFERENCE ONLY AND ARE APPROXIMATES. G.C. TO PERFORM DUE DILIGENCE PRIOR TO ORDERING MATERIAL.

A FINISH PLAN

SCALE: 1/8"=1'-0"

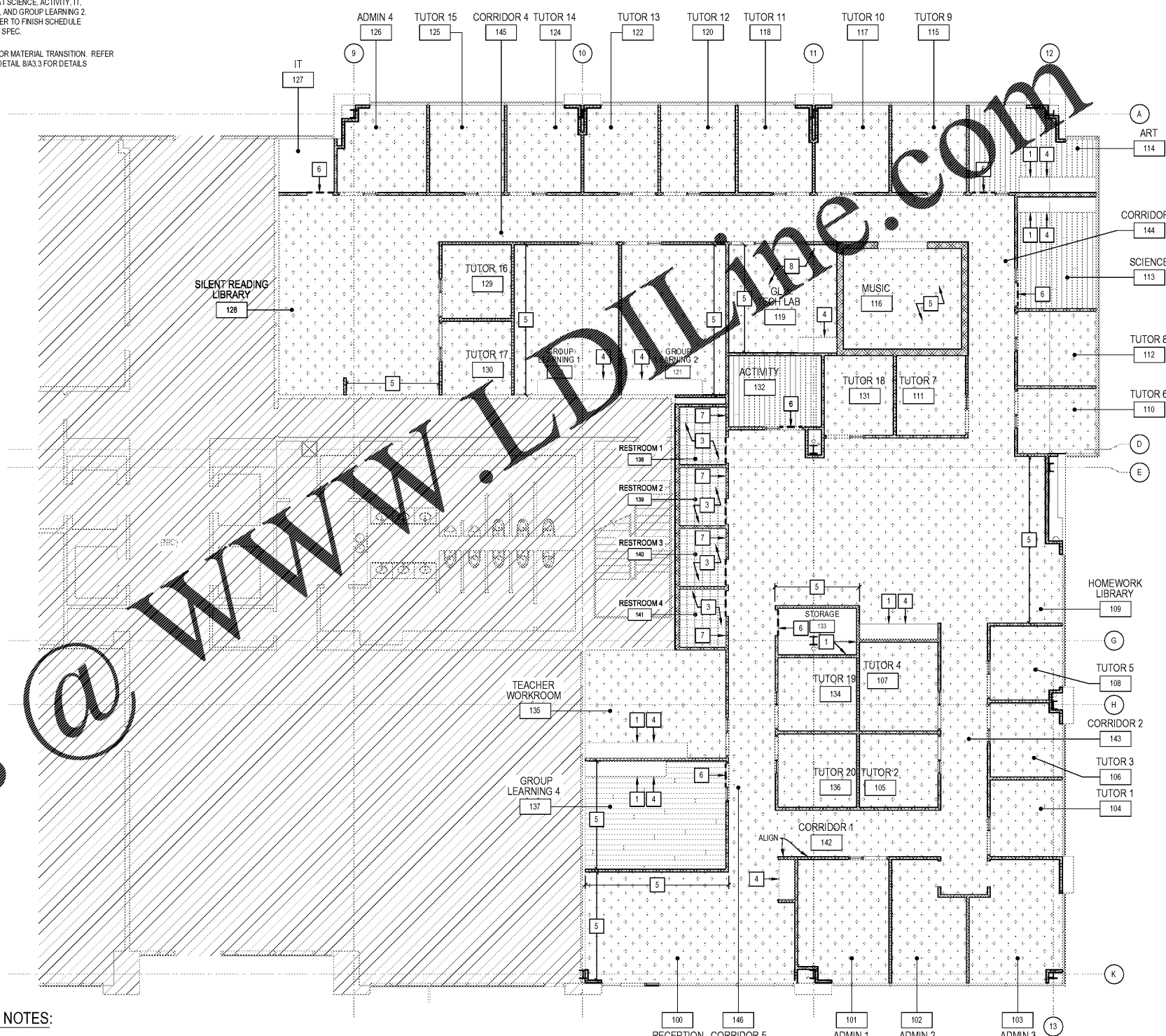

fusion

FUSION ACADEMY
3540 TORRINGTON WAY, STE #100
CHARLOTTE, NC 28277

FLOOR FINISH PLAN, FINISH SCHEDULE & SPECIFICATIONS

CA

CHIPMAN DESIGN ARCHITECTURE INC
JOHN A. CHIPMAN ARCHITECT
1000 W. WILSON AVENUE, SUITE 100
CHARLOTTE, NC 28202
PHONE: 847.798.9950

Revisions

- △ ISSUE FOR PERMIT 08/19/19
- △ REVISION PER CITY 08/21/19
- △ ISSUE FOR CLIENT/LIAISON REVIEW 08/23/19
- △ ISSUE FOR BID 08/30/19

08/19/2019 DATE 06/30/2020 EXPIRATION DATE

Architect: BB Checked By: BW

Scale: AS NOTED Date: 08/19/19

Job No: **18-7842**

Sheet No: **A4.1**