

1 ROOF FRAMING PLAN
SCALE: 1/4" = 1'-0"

NOTE:
ROOF TRUSS DESIGNER TO ADD 10 PSF DL WHEREVER SOFFITS OCCUR. COORDINATE LOCATIONS WITH SHEET A-4.0, "REFLECTED CEILING PLAN".

NOTE:
ALL ROOF TRUSSES SHALL BE DESIGNED FOR A MINIMUM NET UPLIFT OF 8 PSF (UNFACTORED) APPLIED AT THE TOP CHORD OF EACH TRUSS.

TRUSS NOTE:
GENERAL CONTRACTOR IS TO OBTAIN SITE SPECIFIC KITCHEN EQUIPMENT PLAN PRIOR TO ORDERING OR SETTING TRUSSES. ANY DISCREPANCIES ARE TO BE REPORTED PRIOR TO CONSTRUCTION.

NOTE:
ALL DIMENSION ARE TO FACE OF SHEATHING. TRUSS MANUFACTURER TO DEDUCT SHEATHING THICKNESS WHEN FIGURING OUT TRUSS LENGTH.

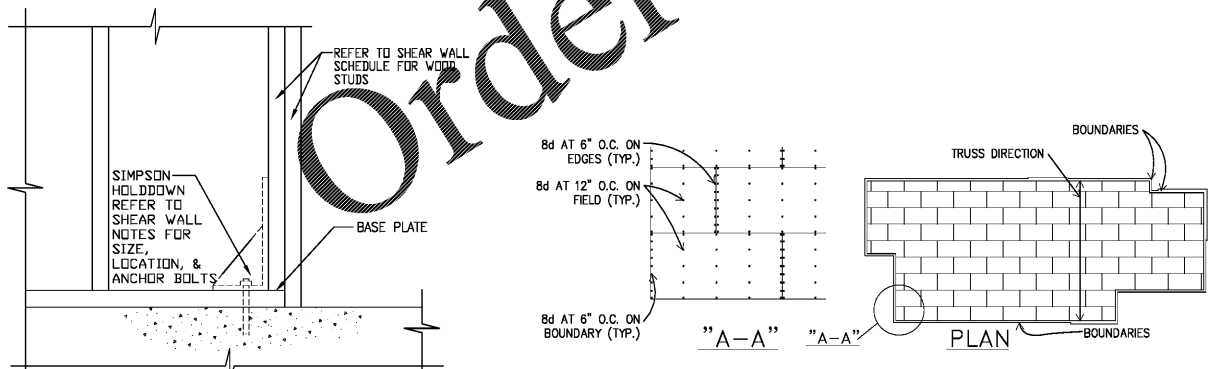

2 TYP. HOLD DOWN DETAIL
SCALE: N.T.S.

3 ROOF DIAPHRAGM NAILING PATTERN
SCALE: N.T.S.

NOTE TO GENERAL CONTRACTOR:
WHERE THE CEILING IS NOT TO BE ATTACHED DIRECTLY TO THE UNDERSIDE OF THE TRUSSES, THE TRUSSES SHALL BE Laterally BRACED WITH CONTINUOUS 1" x 4" MEMBERS NAILED TO THE UPPER SIDE OF THE BOTTOM CHORD AT A MAXIMUM OF 6'-0" ON CENTER WITH TWO(2)-16d COMMON NAILS AT EACH INTERSECTION. THIS LATERAL BRACING SHALL BE RESTRAINED AT EACH END AND AT 20'-0".

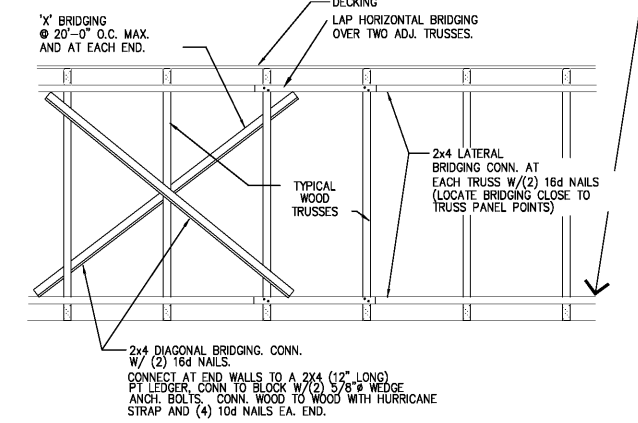

4 BRIDGING DETAIL
SCALE: N.T.S.

GENERAL NOTES:

- A. ROOF OPENINGS FOR A/C UNITS: CONTRACTOR SHALL BE RESPONSIBLE FOR COORDINATION WITH MFR. AND SUPPLY SHOP DRAWINGS FOR INSTALLATION.
- B. IF REMOTE COMPRESSORS ARE USED, CONTRACTOR SHALL COORDINATE INSTALLATION WITH EQUIPMENT MANUFACTURER.
- C. SEE SHEET A-5.0 FOR DETAIL OF SCUPPERS, ROOF DRAINS, ROOF PENETRATIONS AND PITCH PANS.
- D. REFERENCE MECHANICAL SHEETS FOR RTU MOUNTING DETAILS.
- E. STRUCTURAL DESIGN CRITERIA: REFERENCE GENERAL NOTES ON SHEET S-3.0.
- F. TRUSS MANUF. TO SUBMIT SHOP DRAWINGS FOR APPROVAL, PRIOR TO FABRICATION.
- G. REFERENCE SHEETS S-3.0 FOR DETAILS OF TRUSS PROFILES.
- H. ALL HORIZ. FRAMING LUMBER, INCLUDING 2x JOISTS, BEAMS AND HEADERS SHALL BE DENSE NO. 2 DOUGLAS FIR-LARCH OR BETTER.
- I. ALL WOOD STUDS SHALL BE STRUCTURAL NO. 2 DOUGLAS FIR-LARCH OR BETTER.
- J. ALL BEAM SPLICES SHALL OCCUR OVER SUPPORT COLUMNS.
- K. VERIFY EXACT LOCATIONS OF MECHANICAL UNITS WITH MECHANICAL CONTRACTOR.
- L. ROOF TRUSSES TO BE 2" MIN. DEPTH. DEEPER ROOF TRUSSES ARE REQUIRED, NOTIFY ARCHITECT IMMEDIATELY.
- M. WHERE MULTIPLE TRUSSES INDICATED, TOP CHORDS SHALL BE BOLTED WITH #2 IN 1" O.C. OR AS SPECIFIED BY THE TRUSS MANUFACTURER.
- N. REFERENCE SHEET S-3.0 FOR STRUCTURAL NOTES.
- O. PROVIDE 2x6 BRACING BETWEEN TOP TRUSS CHORDS AT WEATHING PANEL ENDS AS NECESSARY.

KEYED NOTES:

- 1 5/8" CDX PLYWOOD SHEATHING OR OPTIONAL WAFERBOARD (UBC STD 25-25) TYPICAL, REFER TO ROOF DIAPHRAGM NAILING NOTE IN SHEAR WALL SCHEDULE
- 2 PREFAB. WOOD TRUSSES AT 2'-0" O.C. MAX. (TYP) UNLESS NOTED OTHERWISE
- 3 ROOF OPENING FOR MECHANICAL SYSTEMS, REF. TO MECH. SHEETS FOR SIZE OF ROOF PENETRATIONS.
- 4 (2) 2x8 BETWEEN TRUSSES WITH U24 SIMPSON JOIST HANGER EACH END
- 5 WOOD BRIDGING. REFERENCE DETAIL 4/S-2.0
- 6 REFER TO M-2 FOR A/C CURB MOUNTING DETAIL.
- 7 WOOD HEADER WITH 1/2" PLYWOOD SPACER WITH DOUBLE STUDS AT EACH END OF OPENING (4" MIN. BEARING) REFER TO HEADER SCHEDULE THIS SHEET FOR BEAM SIZES.
- 8 PROVIDE 2x6 FRAMED RETURN WALL AT RAISED PARAPET TOWER ELEMENT. PROVIDE 2x6 BLOCKING WITH SIMPSON JOIST HANGER AT EACH END BETWEEN ROOF TRUSSES TO SUPPORT WALLS.
- 9 CENTER LINE OF 16" I.D. EXHAUST DUCT. VERIFY LOCATION IN FIELD. VERIFY DUCT SIZE WITH MANUFACTURER.
- 10 ALL WALL FRAMING TO BE 2x6 WOOD STUDS @ 16" O.C. (U.O.N.)
- 11 WOOD HEADER LVL WITH PACKED STUDS AT ALL BEARING POINTS. BEAR A MINIMUM OF 4" AT EACH END. USE SIMPSON HUC0610-SDS HANGER. REFER TO HEADER SCHEDULE THIS SHEET FOR BEAM SIZES.
- 12 DIAGONAL PARAPET WALL BRACING BY G.C. SEE WALL SECTIONS.
- 13 2x6 BLOCKING BETWEEN TRUSSES AT DIAGONAL BRACING
- 14 METAL FRAMING WALL. SEE SHEET A-1.0, AND WALL SECTION 3/A-6.0.

HEADER SCHEDULE:

| LABEL | SIZE & MATERIAL | NOTES |
|-------|--------------------------|--------------------------|
| BM-1 | (3) - 1 3/4"x11 3/8" LVL | HIGH BEAM |
| BM-2 | (3) - 2x10 W/3/4" PLY. | LOW BEAM |
| BM-3 | (3) - 1 3/4"x9 1/2" LVL | D/T HEADER |
| BM-4 | (3) - 1 3/4"x9 1/2" LVL | HIGH & LOW BEAM |
| BM-5 | (3) - 1 3/4"x14" LVL | IMAGE ELEMENT SIDE ENTRY |
| BM-6 | W12X22 (HIGH) | MOMENT FRAME; SEE S-2.1 |
| BM-7 | WBX18 (LOW) | MOMENT FRAME; SEE S-2.1 |
| BM-8 | (3) - 2x10 SYP #2 | DOOR/WINDOW HEADER |

SHEAR WALL NOTES:

- ▶ INDICATES SHEAR WALL HOLDDOWN
- SW1 & HD1**
USE APA RATED 7/16" SHEATHING ATTACHED TO BLOCKED STUDS W/1-1/2" LONG 16g STAPLES AT 6" O.C. AT ALL PANEL EDGES AND AT 12" O.C. IN THE FIELD OF THE PANEL. PROVIDE DOUBLE STUDS AT THE END OF ALL SHEARWALLS. PROVIDE SIMPSON DT12Z-SDS2.5 HOLD-DOWNS AT ENDS OF SHEARWALLS. ATTACH HOLD-DOWN TO CONCRETE W/1/2" HDG THREADED ROD W/4-1/2" EMBEDMENT, ADHERE WITH SIMPSON "SET" ADHESIVE.
- SW2 & HD2**
USE APA RATED 7/16" SHEATHING ATTACHED TO BLOCKED STUDS W/1-1/2" LONG 16g STAPLES AT 6" O.C. AT ALL PANEL EDGES AND AT 12" O.C. IN THE FIELD OF THE PANEL. PROVIDE DOUBLE STUDS AT THE END OF ALL SHEARWALLS. PROVIDE SIMPSON HDU4-SDS2.5 HOLD-DOWNS AT ENDS OF SHEARWALLS. ATTACH HOLD-DOWN TO CONCRETE W/5/8" HDG THREADED ROD W/4-1/2" EMBEDMENT, ADHERE WITH SIMPSON "SET" ADHESIVE.
- SW3 & HD3**
USE APA RATED 7/16" SHEATHING ATTACHED TO METAL STUDS W/NO. 8 x 1-1/2" FLAT HEAD, SHARP POINT, SELF DRILLING SCREWS AT 6" O.C. AT ALL PANEL EDGES AND AT 12" O.C. IN THE FIELD OF THE PANEL. PROVIDE 2 STUDS BACK TO BACK AT ENDS OF SHEARWALLS. PROVIDE SIMPSON S/HDU4 HOLD-DOWN AT EACH END OF SHEARWALL.

ROOF DIAPHRAGM
USE 5/8" APA RATED T&G BLUE RIBBON RATED GEORGIA PACIFIC OSB SHEATHING, WITH 10d NAILS AT 6" ON CENTER AT PANEL EDGES AND INTERMEDIATE SUPPORTS.

B1916

| DATE | RELEASE |
|----------|------------------|
| 08.26.19 | FOR CONSTRUCTION |
| | |
| | |
| | |
| | |
| | |
| | |
| | |
| | |

CHECKED BY: AK
DRAWN BY: CY

NOTICE: THESE DRAWINGS ARE THE PROPERTY OF ARIE KOHN ARCHITECTS, P.C. AND SHALL NOT BE USED, REPRODUCED, AND/OR MODIFIED WITHOUT WRITTEN CONSENT FROM ARIE KOHN ARCHITECTS, P.C.

DRAWINGS FOR:
BRUCE DANIELS
CAROLINA RE HOLDINGS, LLC
P.O. BOX 711
GREENWOOD, SC 29649
646-462-5481

ARIE KOHN ARCHITECTS, P.C.
74 WOODSTOCK ROAD ROSWELL, GA 30075
TEL (770) 642-9030 FAX (770) 642-3785
EMAIL: arie@akarch.com

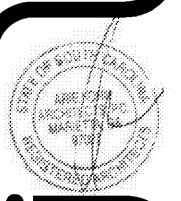

PROJECT: B1916
DATE: 07/22/2019

BURGER KING RESTAURANT

206 LONGSTREET ST.
KINGSTREE, SC 29556

ROOF FRAMING PLAN

S-2.0