

**NOTE:**  
 - THIS IS PROPRIETARY TO EIS. ANY UNAUTHORIZED USE OR REPRODUCTION IS STRICTLY PROHIBITED.  
 - FINISHES ON FINISH PLAN ARE RESPONSIBILITY OF G.C. TO COMPLETE.  
 - FINISH TAGS ON PLAN ARE MAIN WALL FINISHES ONLY - SEE ELEVATION FOR MORE FINISH INFORMATION

**NOTE:**  
 - THIS PLAN IS DESIGNED UTILIZING WALL TILE. IT IS THE RESPONSIBILITY OF THE GENERAL CONTRACTOR/OWNER OPERATOR/CUSTOMER/ARCHITECT TO VERIFY ALL LOCAL AND STATE TILE REFLECTIVITY CODES AS THEY PERTAIN TO THE USE OF ANY TILE ON ANY VERTICAL SURFACE. DUE TO CARING STATE AND REGIONAL CODES, INTERIOR SYSTEMS WILL NOT BE RESPONSIBLE FOR MEETING THESE TILE REFLECTIVITY CODES. THE USE OF THE TILES SPECIFIED IN THESE PLANS IS AT THE SOLE DISCRETION OF THE CUSTOMER.

WALL FINISH LEGEND	
	BR-2G
	CT-25G
	CT-27G
	CT-28G
	CT-30G
	CT-31G
	P-15G, TR-1G, CT-28G
	PL-18G
	EIS HALF WALL
	NEW G.C. FULL HT. WALL
	F.S.C. TO FILL IN EXISTING WINDOW

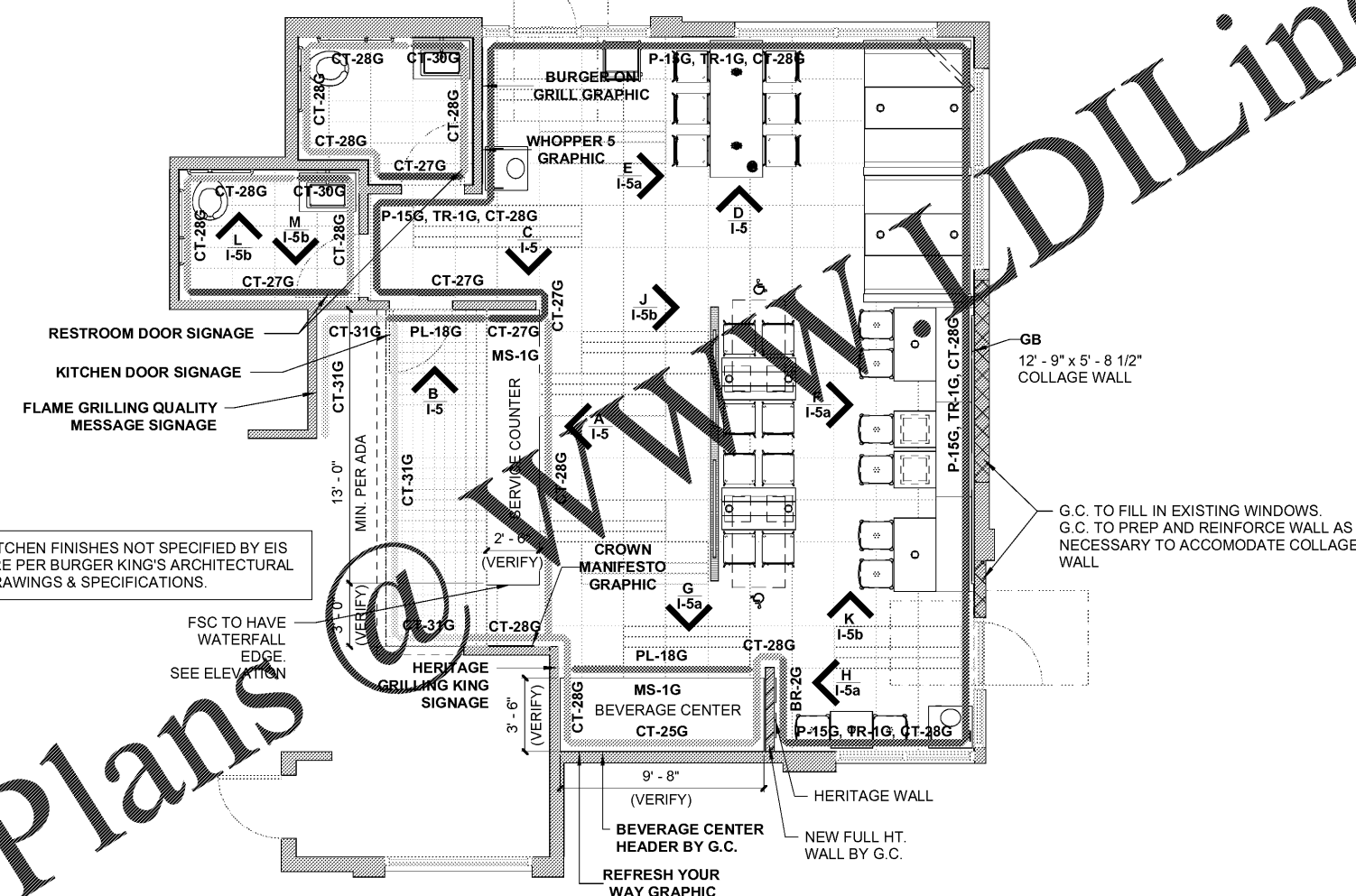

KITCHEN FINISHES NOT SPECIFIED BY EIS ARE PER BURGER KING'S ARCHITECTURAL DRAWINGS & SPECIFICATIONS.

FSC TO HAVE WATERFALL EDGE. SEE ELEVATION

(A) Finish Plan  
 3/16" = 1'-0"

Order Plans

WWW.DILine.com

**BURGER KING**  
 National #200397  
 Garden Grill

**Account Executive**  
 Donnie Harrelson  
 706-847-7600  
 donnie.harrelson@elkay.com

**Contact**  
 Bruce Daniels  
 646-462-5481  
 bruce.daniels@carolfranchiseholdings.com

**Location**  
 Beech Island Drive and Atomic Road  
**Beech Island, SC**  
 29842

**Project Manager**  
 Ryan Spannagle  
 414-847-0658  
 ryan.spannagle@elkay.com

**Designer**  
 Stephanie Rutledge  
 414-847-0675  
 stephanie.rutledge@elkay.com

**Drawn By**  
 MS.GRK

**Date:**  
 07/26/2019

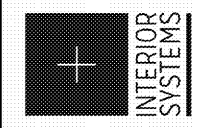

REV	DATE	DESCRIPTION	BY	SR	JC/SR
	8/8/19	Bid Set Created			
	8/9/19	Brand Review Approved			
	8/15/19	Final Plan Set Created			

Project Number  
**113123**

Sheet Title  
**Finish Plan**

Sheet  
**I-2**

