

Drawing name: L250004 - Carolina RE Holdings, LLC - Burger King - Beech Island, SC\ADD\CONSTR\250004_06 - PROFILES.dwg, SANITARY PROFILES, Aug 30, 2019 7:31am, by: michael.bohaker

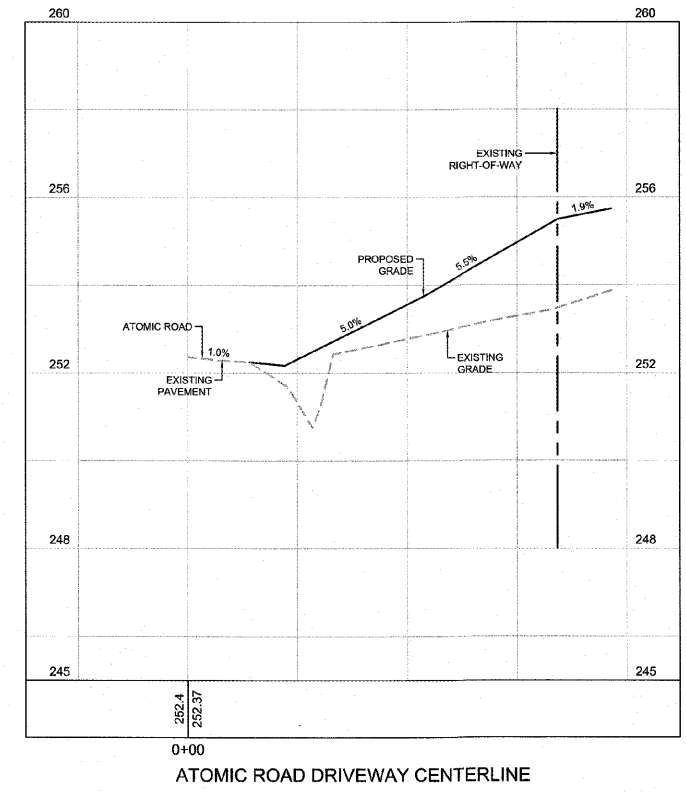
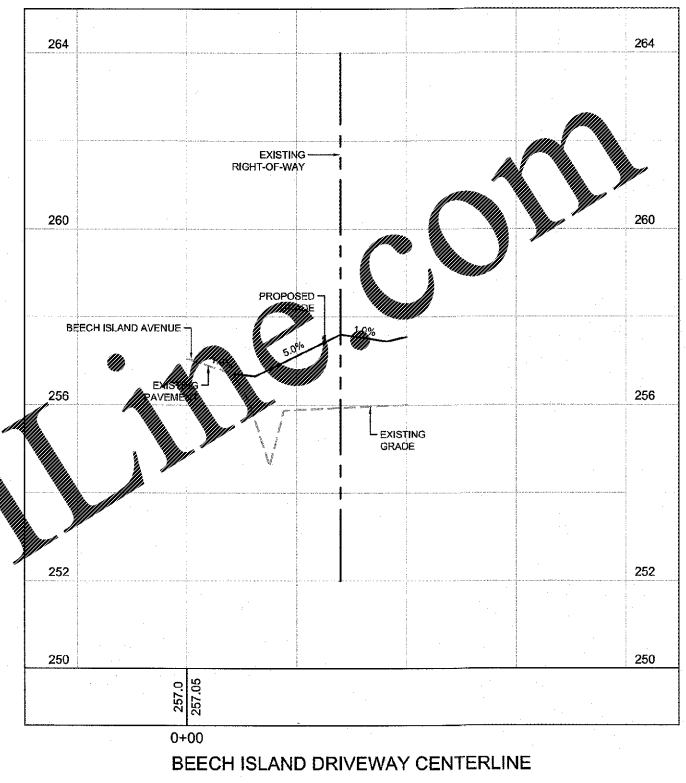
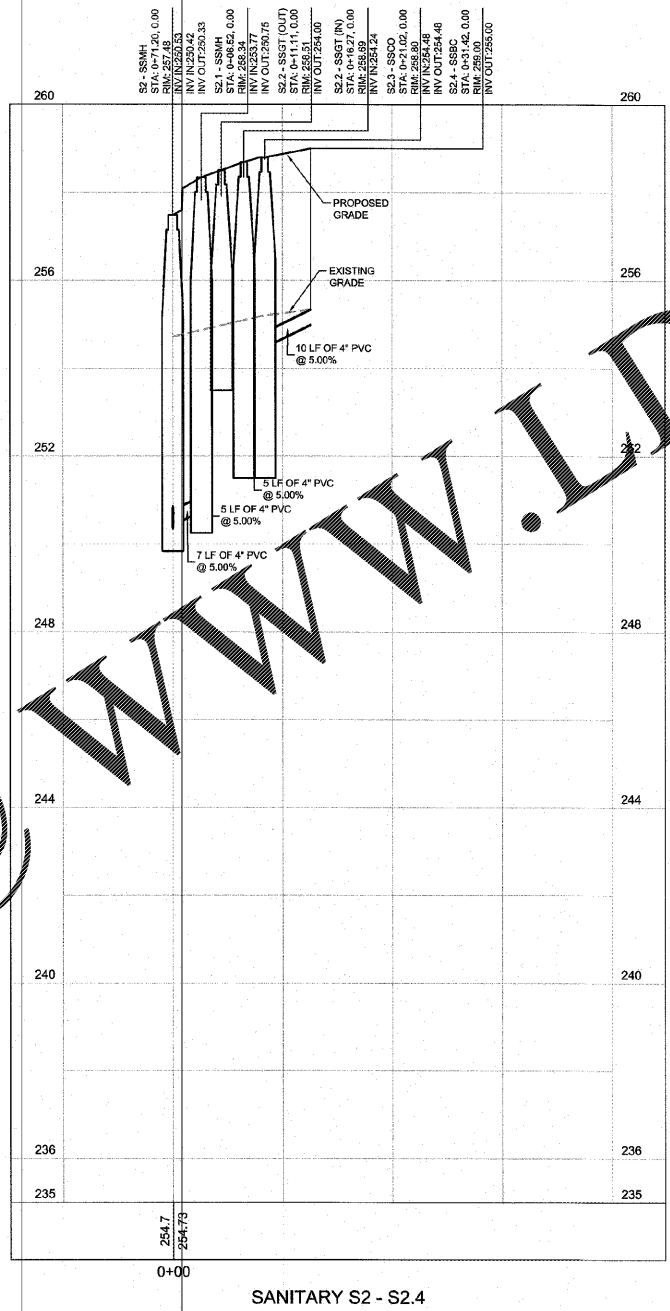
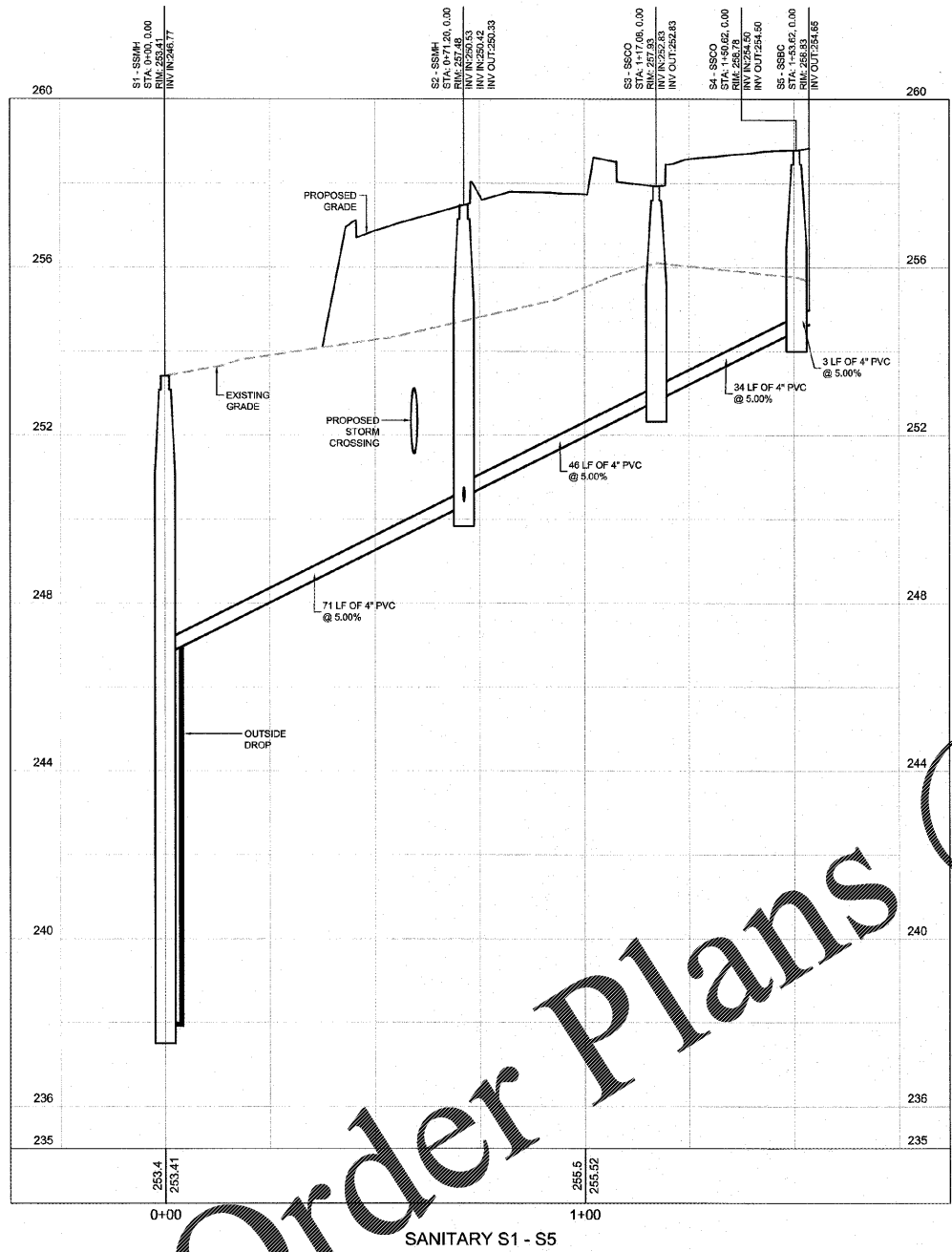

Order Plans @ www.LDILine.com

PREPARED IN THE OFFICE OF
LECRAW ENGINEERING
 ENGINEERING, INC.
 3475 COLLETT DRIVE, SUITE 100
 DULUTH, GA 30096
 PHONE - 678-548-8100
 FAX - 770-441-0288
 WWW.LECRAWENGINEERING.COM
 CDR - 1460

REV #	DATE	DRAWN	CHECKED	BY
1		MAT	MSL	
2		MAT	MSL	

CLIENT
 CAROLINA RE HOLDINGS, LLC
 300 GALLERIA PARKWAY - ATLANTA, GA 30039

PROJECT
 BURGER KING - BEECH ISLAND, SC
 BEECH ISLAND AVENUE & ATOMIC DRIVE
 AIKEN COUNTY, SOUTH CAROLINA

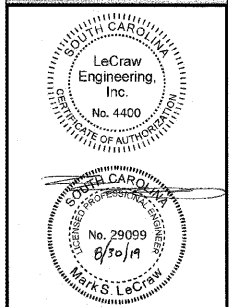

DESIGN TEAM:
 DRAWN BY: MAT
 DESIGNED BY: MAT
 REVIEWED BY: MSL



SCALE & NORTH ARROW:

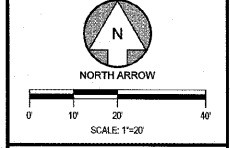

JOB #: 250004
 DATE: JULY 18, 2019
SANITARY PROFILES

C-6.1