

Drawing name: L:\2019\04 - Carolina RE Holdings, LLC - Burger King - Erosion Control Plan - PHASE 1 - Aug 28, 2019 1:58pm by michael.tombler

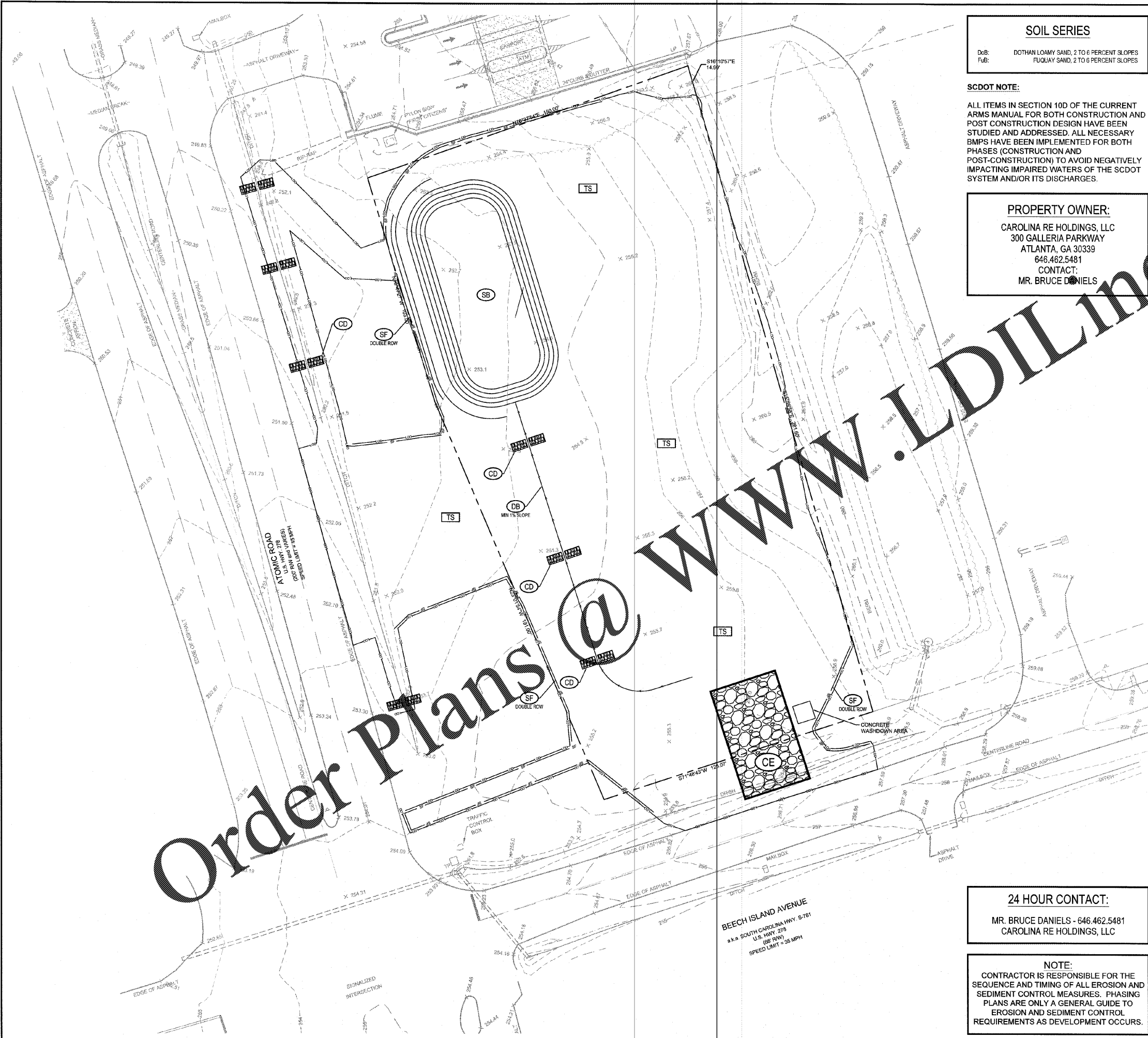

**SOIL SERIES**

DoB: DOTHAN LOAMY SAND, 2 TO 6 PERCENT SLOPES  
 FuB: FUYUAY SAND, 2 TO 6 PERCENT SLOPES

**SCDOT NOTE:**

ALL ITEMS IN SECTION 10D OF THE CURRENT ARMS MANUAL FOR BOTH CONSTRUCTION AND POST CONSTRUCTION DESIGN HAVE BEEN STUDIED AND ADDRESSED. ALL NECESSARY BMPs HAVE BEEN IMPLEMENTED FOR BOTH PHASES (CONSTRUCTION AND POST-CONSTRUCTION) TO AVOID NEGATIVELY IMPACTING IMPAIRED WATERS OF THE SCDOT SYSTEM AND/OR ITS DISCHARGES.

**PROPERTY OWNER:**

CAROLINA RE HOLDINGS, LLC  
 300 GALLERIA PARKWAY  
 ATLANTA, GA 30339  
 646.462.5481  
 CONTACT:  
 MR. BRUCE DANIELS

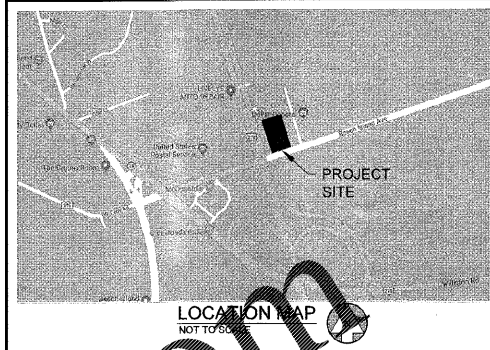

**GENERAL SITE NOTES**

- 1.) ALL BEST MANAGEMENT PRACTICES ARE TO BE IN ACCORDANCE WITH THE MANUAL FOR EROSION AND SEDIMENT CONTROL IN SOUTH CAROLINA.
- 2.) BOUNDARY SURVEY: BENCHMATIC SURVEY BY GEOSURVEY, LTD., DATED MARCH 5, 2019. BENCHMARK: 1000 SURVEY.
- 3.) SOIL TYPES FOR ENTIRE DISTURBED AREA IS DOB & FUB PER NRCS WEB SOIL SURVEY.
- 4.) THE ESCAPE OF SEDIMENT FROM THE SITE SHALL BE PREVENTED BY THE INSTALLATION OF EROSION AND SEDIMENTATION CONTROL MEASURES AND PRACTICES SHALL BE INSTALLED PRIOR TO OR CONCURRENT WITH LAND DISTURBING ACTIVITIES.
- 5.) EROSION AND SEDIMENTATION CONTROL MEASURES AND PRACTICES SHALL BE MAINTAINED AT ALL TIMES. IF FULL IMPLEMENTATION OF THE APPROVED PLAN DOES NOT PROVIDE FOR EFFECTIVE EROSION CONTROL, ADDITIONAL EROSION AND SEDIMENTATION CONTROL MEASURES SHALL BE IMPLEMENTED TO CONTROL OR TREAT THE SEDIMENT SOURCE. ADDITIONAL EROSION AND SEDIMENTATION CONTROL MEASURES AND PRACTICES SHALL BE INSTALLED IF DEEMED NECESSARY BY ON-SITE INSPECTION.
- 6.) SEDIMENT STORAGE MAINTENANCE INDICATORS MUST BE INSTALLED IN SEDIMENT STORAGE STRUCTURES, AS REQUIRED, INDICATING THE 1/3 FULL VOLUME.
- 7.) MAINTENANCE OF ALL SOIL EROSION AND SEDIMENTATION CONTROL MEASURES AND PRACTICES, WHETHER TEMPORARY OR PERMANENT, SHALL BE AT ALL TIMES THE RESPONSIBILITY OF THE PROPERTY OWNER.
- 8.) WASHOUT OF CONCRETE DRUM AT CONSTRUCTION SITE IS PROHIBITED AND NOT ALLOWED IN WASH AREAS.

TOTAL SITE AREA = 0.966 ACRES  
 TOTAL DISTURBED AREA = 1.30 ACRES

CODE	PRACTICE	DETAIL	MAP SYMBOL	DESCRIPTION
CD	CHURNING			A small temporary barrier or dam constructed across a road, driveway, or area of concentrated flow.
CE	CONSTRUCTION EXIT			A channel slope protected on the upstream side which provides a path for runoff and sediment during construction activities.
DB	DIAPHRAGM			An earth diaphragm or diaphragm placed across a road, driveway, or area of concentrated flow to prevent erosion.
SF	SOIL FURROW			A series of parallel furrows spaced at intervals to slow down runoff and allow sediment to settle.
IF	INLET PROTECTION			Blocks over the inlet, is installed to prevent sediment from entering the storm drain. The installation should be done before the structure is placed in the ground.
SB	TEMPORARY SEDIMENT BASIN			A basin intended to capture or store sediment. The basin should be installed before the start of construction.

CODE	PRACTICE	DETAIL	MAP SYMBOL	DESCRIPTION
M	DESTABILIZED AREA STABILIZATION (WITH MULCH)			Establishing temporary protection for disturbed areas where seeding may not have a suitable growing season to produce an erosion reducing cover.
TS	DESTABILIZED AREA STABILIZATION WITH TEMPORARY VEGETATION			Establishing temporary vegetation cover with fast growing seedlings on disturbed areas.
PS	DESTABILIZED AREA STABILIZATION WITH PERMANENT VEGETATION			Establishing permanent vegetation cover such as trees, shrubs, or grasses which requires an undisturbed area.
ECB	EROSION CONTROL MATTING AND BLANKETS			The installation of a protective covering (blanket or mat) stabilization mat on a prepared planting area of a steep slope, channel, or structure.

**EROSION CONTROL CONSTRUCTION SEQUENCE**

1. RECEIVE NPDES COVERAGE FROM DHEC
2. NOTIFY THE STORM WATER UTILITY OFFICE 48 HOURS PRIOR TO BEGINNING LAND-DISTURBING ACTIVITIES
3. PRE-CONSTRUCTION MEETING
4. INSTALLATION OF CONSTRUCTION ENTRANCES
5. CLEARING & GRUBBING ONLY AS NECESSARY FOR INSTALLATION OF PERIMETER CONTROLS
6. INSTALLATION OF PERIMETER CONTROLS (E.G., SILT FENCE)
7. CLEARING & GRUBBING ONLY IN AREAS OF BASING TRAPS/PONDS
8. INSTALLATION OF BASING TRAPS/PONDS; OUTLET STRUCTURES MUST BE COMPLETELY INSTALLED AS SHOWN ON THE DETAILS BEFORE PROCEEDING TO NEXT STEP. AREAS DRAINING TO THESE STRUCTURES CANNOT BE DISTURBED UNTIL THE STRUCTURE IS COMPLETELY INSTALLED
9. CLEARING & GRUBBING OF SITE OR DEMOLITION (SEDIMENT & EROSION CONTROL MEASURES FOR THESE AREAS MUST ALREADY BE INSTALLED)
10. ROUGH GRADING
11. INSTALLATION OF STORM DRAIN SYSTEM AND PLACEMENT OF INLET PROTECTION AS EACH INLET IS INSTALLED
12. FINE GRADING, PAVING AND INSTALLATION OF POST-PAVE PROTECTION, ETC.
13. PERMANENT FINAL STABILIZATION
14. CLEAN-OUT OF DETENTION BASINS THAT WERE USED AS SEDIMENT CONTROL STRUCTURES AND RE-GRADING OF DETENTION POND BOTTOMS; IF NECESSARY, MODIFICATION OF SEDIMENT BASIN RISER TO CONVERT TO DETENTION BASIN OUTLET STRUCTURE
15. REMOVAL OF TEMPORARY SEDIMENT & EROSION CONTROL MEASURES AFTER ENTIRE AREA DRAINING TO THE STRUCTURE IS FINALLY STABILIZED (THE SCSWV RECOMMENDS THAT THE PROJECT OWNER/OPERATOR HAVE THE SWPPP PREPARED OR REGISTRATION EQUIVALENT APPROVE THE REMOVAL OF TEMPORARY STRUCTURES.)

- NOTE: MAINTENANCE OF SEDIMENT AND EROSION CONTROL MEASURES MUST CONTINUE UNTIL THE SITE IS PERMANENTLY STABILIZED AND THE CONTROLS ARE REMOVED
- NOTE: INSTALLATION OF SOME PERMANENT WATER QUALITY DEVICES SHOULD OCCUR AFTER THE SITE IS STABILIZED. INCLUDE THIS IN THE SEQUENCE. CLEANOUT OF OTHER WATER QUALITY DEVICES THAT WERE USED DURING CONSTRUCTION SHOULD OCCUR AFTER SITE STABILIZATION.
- NOTE: IF FLOWS FROM OFFSITE AREAS WILL BE DIVERTED AROUND THE SITE AND THE ON-SITE STRUCTURES ARE NOT DESIGNED TO HANDLE FLOWS FROM THE OFFSITE AREAS, THEN THE DIVERSION PIPING FOR THE OFFSITE FLOWS MUST BE INSTALLED BEFORE LAND-DISTURBING ACTIVITIES BEGIN ON THE SITE. INCLUDE THIS IN THE SEQUENCE.

ESTIMATED STARTING DATE IS WITHIN TWO (2) WEEKS AFTER RECEIVING ALL NECESSARY PERMITS FROM LOCAL AUTHORITIES. ESTIMATED TIME OF COMPLETION IS FIVE (5) MONTHS AFTER THE START OF CONSTRUCTION.

**24 HOUR CONTACT:**

MR. BRUCE DANIELS - 646.462.5481  
 CAROLINA RE HOLDINGS, LLC

**NOTE:**

CONTRACTOR IS RESPONSIBLE FOR THE SEQUENCE AND TIMING OF ALL EROSION AND SEDIMENT CONTROL MEASURES. PHASING PLANS ARE ONLY A GENERAL GUIDE TO EROSION AND SEDIMENT CONTROL REQUIREMENTS AS DEVELOPMENT OCCURS.

**LECRAW ENGINEERING**  
 PREPARED IN THE OFFICE OF:  
 © 2019 LECRAW ENGINEERING, INC.  
 3475 CORPORATE WAY, SUITE A  
 DULUTH, GA 30096  
 PHONE: 770.444.0030  
 FAX: 770.444.0033  
 WWW.LECRAWENGINEERING.COM  
 CCA 4400

NO.	DATE	BY	REVISION
1	08/28/19	MSL	CHECKED
1		MSL	DRAWN
1		MSL	REV.

**CLIENT:**  
 CAROLINA RE HOLDINGS, LLC  
 300 GALLERIA PARKWAY - ATLANTA, GA 30339

**PROJECT:**  
 BURGER KING - BEECH ISLAND, SC  
 BEECH ISLAND AVENUE & ATOMIC DRIVE  
 AIKEN COUNTY, SOUTH CAROLINA

**LeCraw Engineering, Inc.**  
 No. 4100  
 STATE OF SOUTH CAROLINA  
 REGISTERED PROFESSIONAL ENGINEER  
 No. 29099  
 8/28/19  
 Mark S. LeCraw

**DESIGN TEAM:**  
 DRAWN BY: MAT  
 DESIGNED BY: MAT  
 REVIEWED BY: MSL

**811**  
 Know what's below.  
 Call before you dig.

**SCALE & NORTH ARROW:**

**SCALE:** 1"=20'

**NORTH ARROW:**

**JOB #:** 259004  
**DATE:** JULY 16, 2019  
**EROSION CONTROL PLAN - PHASE 1**  
**C-2.0**