

NOTE: GC TO RELOCATE HVAC AS NEEDED TO ACCOMMODATE SOFFIT/PENDANT/DÉCOR PLACEMENT

NOTE: G.C TO CONTACT EIS IMMEDIATELY IF CEILING HEIGHT ARE MISREPRESENTED OR HAVE CHANGED DUE TO SITE CONDITIONS. IN THE EVENT THAT EIS IS NOT NOTIFIED OF CEILING HEIGHT DISCREPANCIES AND PRODUCT IS REQUIRED TO BE MODIFIED ON SITE, EIS RESERVES THE RIGHT TO BILL FOR EXTRA COSTS INCURRED

NOTE: G.C. TO SUPPLY LIGHT FIXTURE AND CUT OUT FOR ALL SOFFITS.

NOTE: G.C. RESPONSIBLE FOR INSTALLATION OF THE LIGHT FIXTURES AND TO PROVIDED AND INSTALL THE APPROPRIATE BULBS. ALL OTHER LIGHTING IS TO BE SUPPLIED AND INSTALLED BY G.C.

NOTE: PLEASE REFER TO BK ARCHITECTURAL PROVIDED LIGHTING PLAN FOR GENERAL LIGHTING LAYOUT. THIS PLAN SHOWS ONLY SUGGESTED PENDANT LIGHT LOCATIONS AND SOFFITS. EIS WILL NOT BE HELD LIABLE FOR ADDITIONAL COSTS DUE TO ADJUSTMENTS TO LIGHTING QUANTITIES OR LOCATIONS FOR PERSONAL REFERENCE, OR LOCAL CODES.

*ALL LIGHT BULBS TO BE SUPPLIED & INSTALLED BY THE G.C.
 *G.C. TO CONTACT BURGER KING'S CONSTRUCTION ENGINEER FOR THE FINAL HVAC PLACEMENT.
 *ALL ELECTRICAL FIXTURES, WIRING, & INSTALLATIONS TO BE UL APPROVED
 *JUNCTION BOXES REQUIRED FOR ALL WALL SCNCES
 *G.C. TO NOTE AREA ABOVE THE CEILING TO BE KEPT CLEAR FOR EIS DÉCOR BLOCKING
 *ALL NEON TUBES & WIRING TO BE SUPPLIED & INSTALLED BY AN UL APPROVED SUPPLIER
 *TRANSFORMERS FOR NEON LIGHTING TO BE LOCATED ABOVE THE SUSPENDED CEILING

REFLECTED CEILING PLAN KEY	
SYMBOL	TAG
	11
	12
	13a
	13b
	14
	15
	16
	17

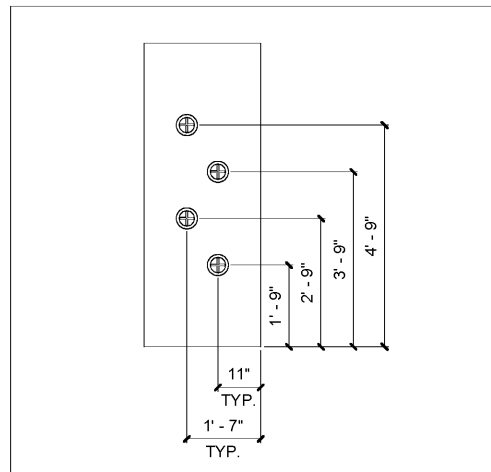

① COMMUNITY TABLE PENDANTS LOCATION
 3/8" = 1'-0"

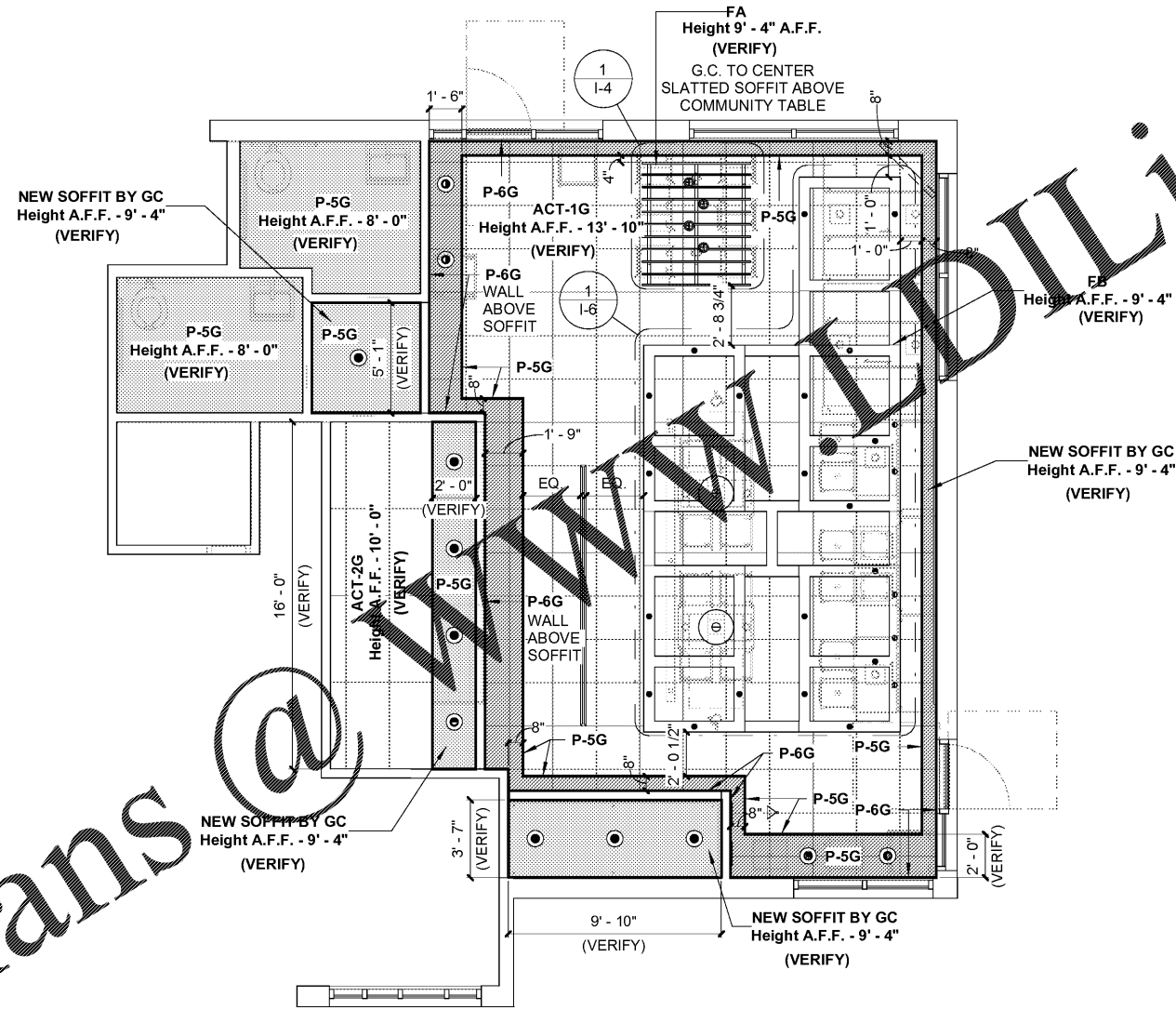

Ⓐ Reflected Ceiling Plan
 3/16" = 1'-0"

NOTE: GC TO REFER TO BURGER KING LIGHTING SPECIFICATIONS FOR ALL LIGHT FIXTURE SPECIFICATION. REFER BK LIGHTING STANDARDS FOR ILLUMINANCE, TEMPERATURE AND CONTRAST FOR LIGHTING.

GENERAL LIGHTING SHALL BE COORDINATED WITH ARCHITECT TO MEET REQUIRED LIGHTING LEVELS. HEIGHT REQUIRED INFORMATION

Lighting Schedule							
Tag	BK Code	Item	Finish	Supplier	Contact	Type	Comments
11	A	BK304 & SP30S-18-60D-927-03	Faux Cast Aluminum Finish	Nautical Furnishings LLC	Michael Hoglund (954) 771-1100 or mhoglund@nauticalfurnishings.com	Shaker Pendant Light	--
12	B	BK305 & LED 8W Edison Incandescent	Antique Bronze	Nautical Furnishings LLC	Michael Hoglund (954) 771-1100 or mhoglund@nauticalfurnishings.com	Bronze Cage Pendant Light	--
13a	G	SP34378B-9-F1-SSN	Satin Nickel	Juno Lighting Group	Brett D. Kinzler (847) 813-8350 or brett.kinzler@acuitybrands.com	2" Diameter Down Light	--
13b	G1	SP34378A-930-F1-SN	Satin Nickel	Juno Lighting Group	Brett D. Kinzler (847) 813-8350 or brett.kinzler@acuitybrands.com	2" Diameter Wall Wash Light	--
14	C4w	SP36671-WHTRM	White	Juno Lighting Group	Brett D. Kinzler (847) 813-8350 or brett.kinzler@acuitybrands.com	4" Diameter White Recessed Downlight	To be used with GWB Ceiling
15	E	R600L3KNBZ	Bronze	Juno Lighting Group	Brett D. Kinzler (847) 813-8350 or brett.kinzler@acuitybrands.com	Track Light	--
16	D4w	SP36671G2 / 39 WWH	White	Juno Lighting Group	Brett D. Kinzler (847) 813-8350 or brett.kinzler@acuitybrands.com	4" Diameter White Recessed Downlight + Wallwash	To be used with GWB Ceiling
17	F	PR1-BBD35A16SSM06	Aluminum	Hermitage Lighting	Wyatt Culver (615) 843-3379 or wyattc@hlg.com	Fluxwerx 12" Aluminum Finish	--

FINAL PLANS

National #200382
Garden Grill

Account Executive: **Donnie Harrelson**
 706-604-7800
 donnie.harrelson@elkay.com

Drawn By: **DP**
 Date: **06/11/2019**

Contact: **Bruce Daniels**
 646.462.5481
 bruce.daniels@carolinefranchiseholdings.com

Designer: **Grace Schneider**
 414.847.0748
 grace.schneider@elkay.com

Location: **406 E Main Street
 Andrews, SC
 29510**

Project Manager: **Ryan Spannagle**
 414.847.0668
 ryan.spannagle@elkay.com

BY: GS
 GS
 GS/KD

DATE DESCRIPTION
 06/11/19 Bid Set Created
 06/14/19 Brand Review Approved
 06/18/19 Final Set Created

Project Number: **112893**

Sheet Title: **Reflected Ceiling Plan**

Sheet: **I-4**