

**NOTE:**  
 - THIS IS PROPRIETARY TO EIS. ANY UNAUTHORIZED USE OR REPRODUCTION IS STRICTLY PROHIBITED.  
 - FINISHES ON FINISH PLAN ARE RESPONSIBILITY OF G.C. TO COMPLETE.  
 - FINISH TAGS ON PLAN ARE MAIN WALL FINISHES ONLY - SEE ELEVATION FOR MORE FINISH INFORMATION

**NOTE:**  
 - THIS PLAN IS DESIGNED UTILIZING WALL TILE. IT IS THE RESPONSIBILITY OF THE GENERAL CONTRACTOR/OWNER OPERATOR/CUSTOMER/ ARCHITECT TO VERIFY ALL LOCAL AND STATE TILE REFLECTIVITY CODES AS THEY PERTAIN TO THE USE OF ANY TILE ON ANY VERTICAL SURFACE. DUE TO CARING STATE AND REGIONAL CODES, INTERIOR SYSTEMS WILL NOT BE RESPONSIBLE FOR MEETING THESE TILE REFLECTIVITY CODES. THE USE OF THE TILES SPECIFIED IN THESE PLANS IS AT THE SOLE DISCRETION OF THE CUSTOMER.

FLOOR TILE KEY		
	6" x 6"	CT-10G
	24" x 24"	CT-25G
	12" x 24"	CT-27G
	12" x 24"	CT-27G
	6" x 24"	CT-28G
	6" x 24"	CT-29G

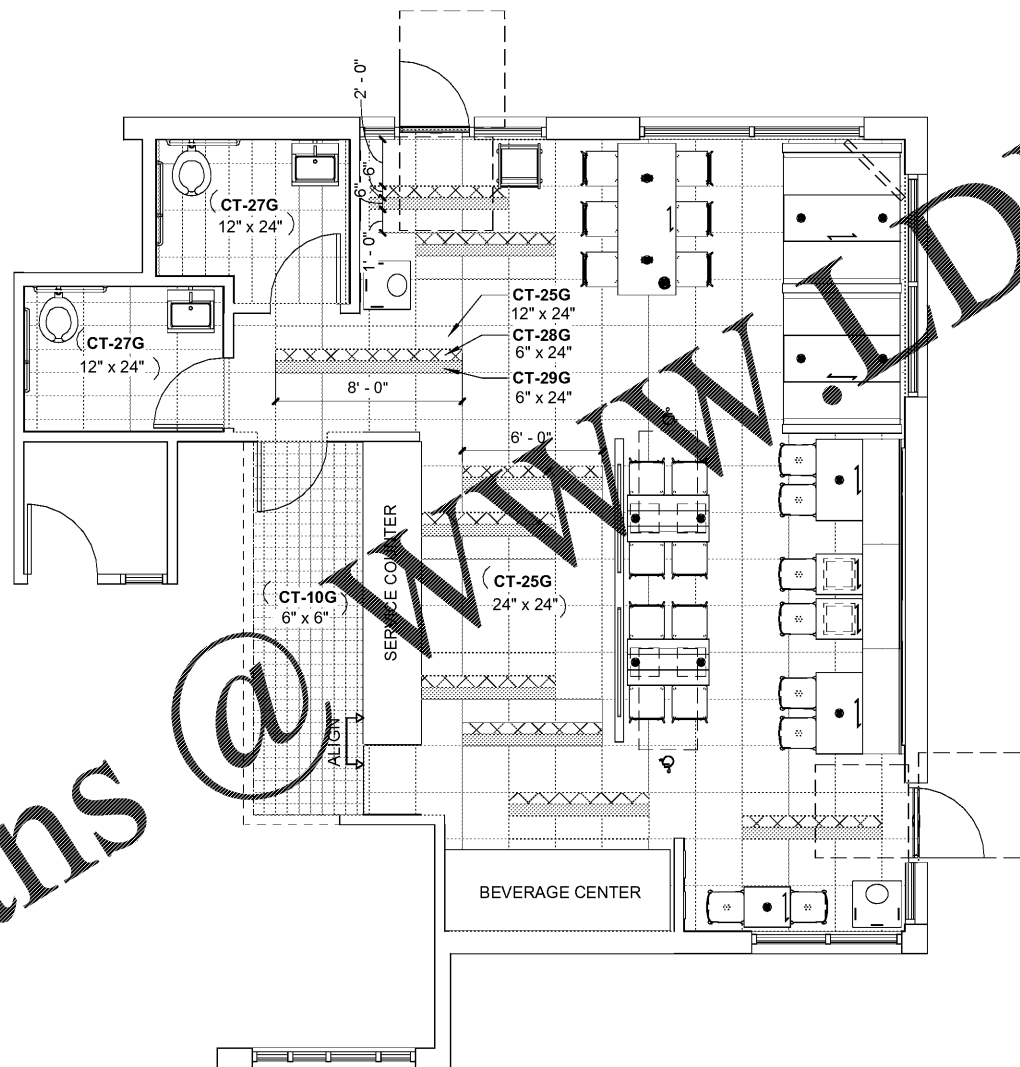

(A) Floor Tile Plan With Furniture  
 3/16" = 1'-0"

Order Plans @

WWW.DILine.com

**Account Executive**  
 Donnie Harrison  
 706-604-7680  
 donnie.harrison@eikay.com

**Drawn By**  
 DP  
 Date: 06/11/2019

**National #200382**  
 Garden Grill

**Contact**  
 Bruce Daniels  
 646-462-5481  
 bruce.daniels@carolinatranchis Holdings.com

**Designer**  
 Grace Schneider  
 414-847-0748  
 grace.schneider@eikay.com

**Location**  
 406 E Main Street  
 Andrews, SC  
 29510

**Project Manager**  
 Ryan Spannagle  
 414-847-0658  
 ryan.spannagle@eikay.com

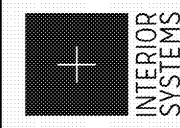

REV	DATE	DESCRIPTION	BY
	06/11/19	Bid Set Created	GS
	06/14/19	Brand Review Approved	GS
	06/18/19	Final Set Created	GS/KD

Project Number  
**112893**

Sheet Title  
**Floor Tile Plan  
 With Furniture**

Sheet  
**I-3**

