

GAS LOAD SCHEDULE		
EQUIPMENT		BTUH INPUT
P-6	WATER HEATER	199,000
(24.02)	BROILER	75,000
(RT1)	ROOFTOP UNIT-1	180,000
(RT2)	ROOFTOP UNIT-2	115,000
(RT3)	ROOFTOP UNIT-3	115,000
(RT4)	ROOFTOP UNIT-4	180,000
TOTAL USAGE		900,000
APPROX. DISTANCE FROM REGULATOR TO FARTHEST TAKE OFF 100' (VERIFY ON SITE)		
GAS TYPE:		NATURAL GAS
DELIVERY PRESSURE:		7" W.C.

- GAS LINE SIZING NOTES:**
1. GAS LINES HAVE BEEN SIZED PER TABLE 402.4(2) OF THE 2015 INTERNATIONAL GAS CODE - INLET PRESSURE OF LESS THAN 2 PSI AND A 0.5" W.C PRESSURE DROP AND 0.60 SPECIFIC GRAVITY.

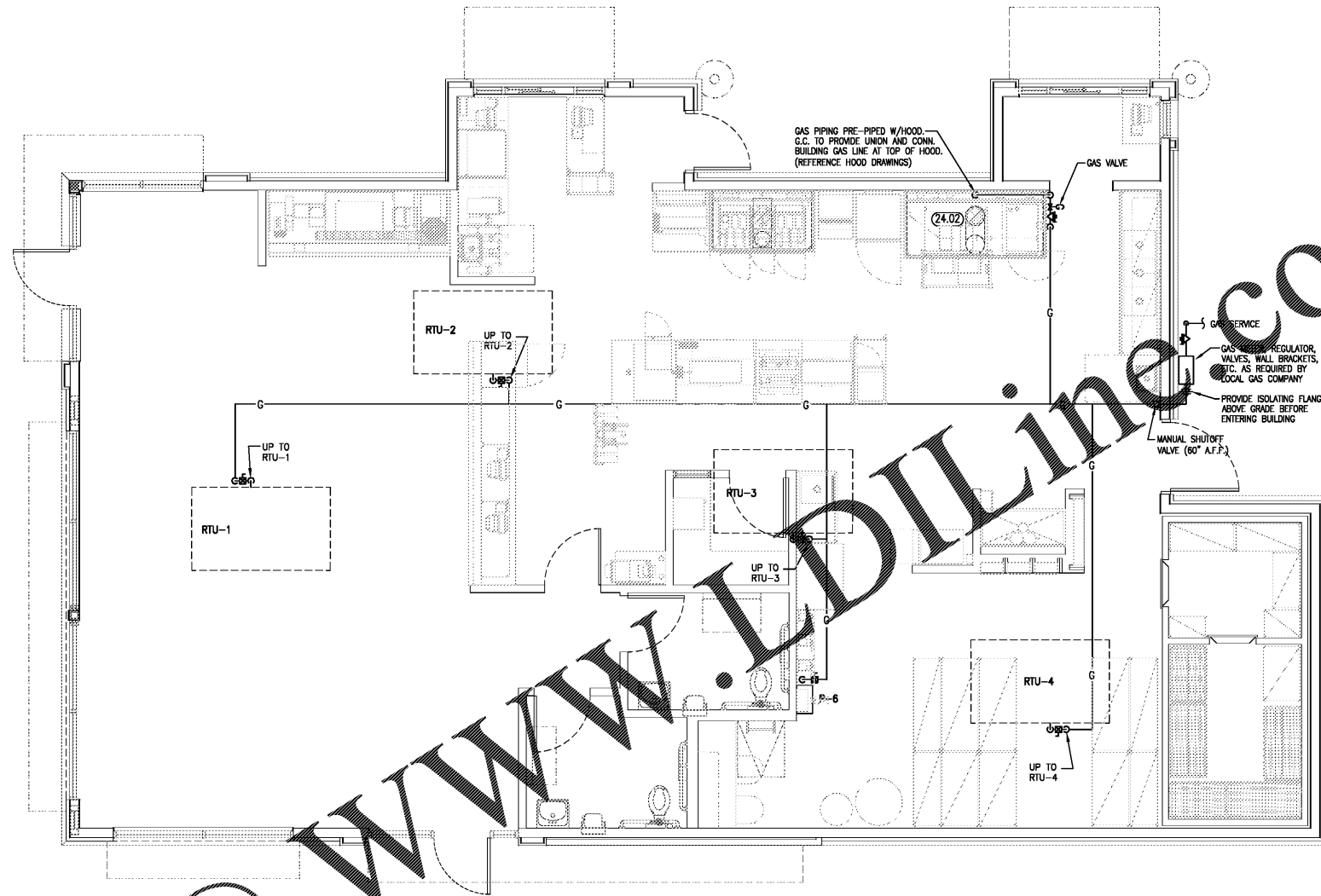

GAS PLAN
SCALE: 1/4" = 1'-0"

Order Plans @

B1914	
DATE	RELEASE
08.26.19	FOR CONSTRUCTION

CHECKED BY:
DRAWN BY:

NOTE:
THESE DRAWINGS ARE THE PROPERTY OF ARIE KOHN ARCHITECTS, P.C. AND SHALL NOT BE USED, REPRODUCED, AND/OR MODIFIED WITHOUT WRITTEN CONSENT FROM ARIE KOHN ARCHITECTS, P.C.

DRAWINGS FOR:
BRUCE DANIELS
CAROLINA RE HOLDINGS, LLC
P.O. BOX 711
GREENWOOD, SC 29649
646-462-5481



AKA
ARIE KOHN ARCHITECTS, PC
74 WOODSTOCK ROAD, ROSWELL, GA 30075
TEL: (770) 642-9030 FAX: (770) 642-3765
EMAIL: arie@akohmarch.com



PROJECT: B1914
DATE: 07/22/2019

BURGER KING RESTAURANT
#08-0008-021-00-00
GAS PLAN & RISER



P-3

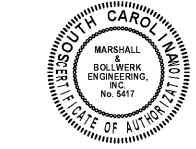

MARSHALL & BOLLWERK ENGINEERING, INC.
8881 Highway 92, Suite 400
Woodstock, Ga. 30189
p: (678) 795-0333, f: (678) 325-4558
e: mbe@mbenc.net