



Pate Design Group, Inc.

Architecture / Interiors

4168 Abbotts Bridge Road
Duluth, Georgia 30097

(p) 770.814.0885
(f) 770.814.0886

Kirby@patedesigngroup.com

F-2 UNIT
WISTERIA RIDGE
Will-O-War LLC
75 North Main Street
Watkinsville, GA 30677

Issue & Revisions:

No.	Date	Description
1	04.01.19	CLARIFICATION

LEVEL TWO
FLOOR
PLAN

Drawn
MBW
Checked
KEP
Contract No.
07-03
Scale
AS NOTED



A12

040119 of sheets

THIS DRAWING IS THE PROPERTY OF PATE DESIGN GROUP AND IS NOT TO BE COPIED, REPRODUCED, OR TRANSMITTED IN ANY FORM OR BY ANY MEANS, ELECTRONIC OR MECHANICAL, INCLUDING PHOTOCOPYING, RECORDING, OR BY ANY INFORMATION STORAGE AND RETRIEVAL SYSTEM, WITHOUT THE WRITTEN PERMISSION OF PATE DESIGN GROUP.

RELEASED FOR CONSTRUCTION

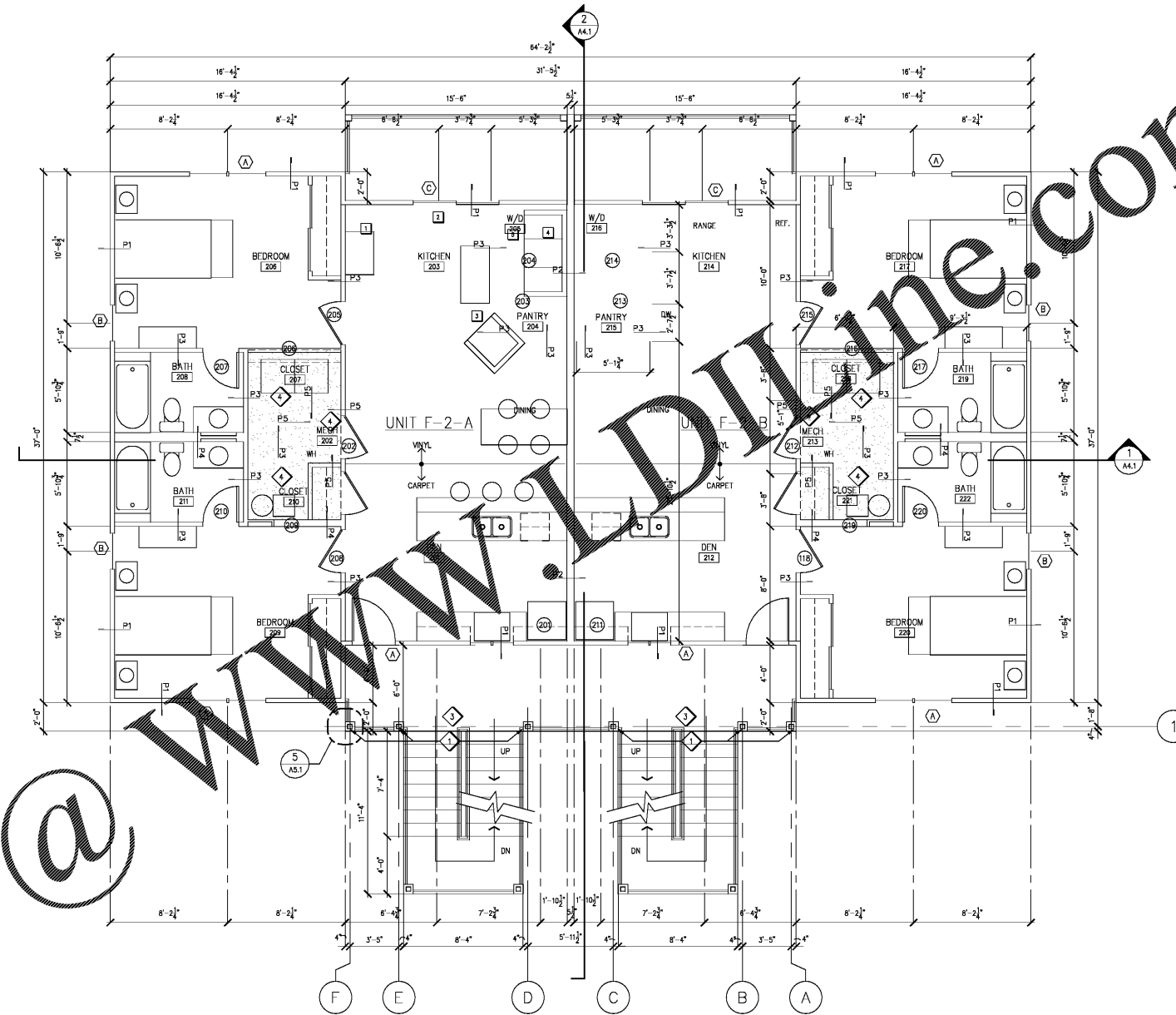

1 FLOOR PLAN: Level Two
SCALE: 1/4"=1'-0"

APPENDIX SCHEDULE:

- 1 GENERAL ELECTRIC, GIL16JCP, 18 CU.FT. TOP-FREEZER REFRIGERATOR WITH ICE/MAKER, "CLEANSTEEL" FINISH
- 2 GENERAL ELECTRIC, JMS0880, "SPACEMAKER" 27" DROP-IN ELECTRIC RANGE, FINISH SELECTED BY OWNER
- 3 GENERAL ELECTRIC, GSM1900A, 18" BUILT-IN DISHWASHER, FINISH SELECTED BY OWNER
- 4 (OPTIONAL) GENERAL ELECTRIC, DBR463SD, 6.0 CU.FT. CAPACITY ELECTRIC DRYER
- 5 (OPTIONAL) GENERAL ELECTRIC, WSR2080D, 3.2 CU.FT. CAPACITY WASHER

CONSTRUCTION NOTES:

- 1 6x6 P.I. WOOD POST W/ WOOD TRIM - SEE STRUCTURAL DRAWINGS
- 2 PREFINISHED METAL DOWNSPOUTS, FINAL LOCATION TO BE APPROVED BY OWNER PRIOR TO INSTALLATION.
- 3 METAL PAN STAIRS, COORDINATE WITH FINAL GRADE.
- 4 GYP. SOFFIT ABOVE. SEE A2.1, A4.1 FOR DETAILS.

GENERAL NOTES:

- 1) GENERAL CONTRACTOR (G.C.) SHALL SURVEY JOB SITE PRIOR TO COMMENCING WORK AND SHALL VERIFY ALL DIMENSIONS AND NOTE ALL CONDITIONS WHICH WILL AFFECT OR BE AFFECTED BY WORK ON THIS PROJECT; AND SUCH CONDITIONS OR DISCREPANCIES SHALL BE REPORTED IMMEDIATELY TO THE ARCHITECT.
- 2) ALL WORK SHALL CONFORM TO THE REQUIREMENTS OF THE APPLICABLE CODES, LAWS, RULES AND REGULATIONS OF ALL CONSTITUTED PUBLIC AUTHORITIES HAVING JURISDICTION.
- 3) CONTRACTOR SHALL BE RESPONSIBLE FOR A COMPLETE BUILDING WITH INTERIOR SPACES FINISHED TO A RESIDENTIAL STANDARD.
- 4) CONTRACTOR IS TO NOTIFY OWNER AND GOVERNING AUTHORITIES PRIOR TO INTERRUPTION OF UTILITY SERVICES, INCLUDING BUT NOT LIMITED TO WATER, ELECTRICITY AND GAS. NOTIFICATION IS TO BE A MINIMUM 24 HOURS IN ADVANCE TO UTILITY OUTAGE.
- 5) OWNER IS TO BE CONTACTED FOR SCOPE AND EXTENT OF WORK IN COORDINATING WITH CIVIL-RELATED WORK.
- 6) ALL INTERIOR DIMENSIONS ARE TO FACE OF STUD UNLESS NOTED OTHERWISE.
- 7) SIGNS ARE NOT APPROVED WITHIN THE SCOPE OF THIS BUILDING PERMIT. A SEPARATE SIGN LOCATION PERMIT IS REQUIRED FOR EACH SIGN.
- 8) CONTRACTOR SHALL PERMANENTLY IDENTIFY ALL RATED WALLS AND SHIELD ENCLOSURES BY INSTALLING A METAL SIGN STATING "1 HR. FIRE AND SMOKE BARRIER - PROTECT ALL OPENINGS". IDENTIFICATIONS SHALL BE SPACED NO MORE THAN 12" ON CENTER, 2" MIN. LETTER SIZE SHALL BE ON A CONTRASTING BACKGROUND (SEC 7035 OF THE 2002 GEORGIA STATE AMENDMENTS).
- 9) INSULATION SHALL HAVE A FLAME SPREAD INDEX OF NOT MORE THAN 25 AND SMOKE-DEVELOPED INDEX OF NOT MORE THAN 450 AS DETERMINED BY ASMT E-84.
- 10) DRYWALL TO BE FINISHED TO USG LEVEL 4 UNLESS NOTED OTHERWISE.
- 11) SEE SHEET A6.1 FOR PARTITION DETAILS AND NOTES.
- 12) SEE SHEET A7.1 FOR DOOR AND WINDOW DETAILS AND SCHEDULES.
- P1 INDICATES PARTITION TYPE. SEE DETAILS A6.1
- 18 INDICATES DOOR NUMBERS. SEE SCHEDULE AND DETAILS ON SHEET A7.1

BUILDING FOOTAGES	UNIT FOOTAGES	UNIT TOTALS
MAIN LEVEL AREA: 2,180 SF.	2 BR UNIT GROSS AREA: 1090 SF.	2 BR UNITS: 6 / bldg
LEVEL TWO AREA: 2,180 SF.	2 BR UNIT NET AREA: 1050 SF.	TOTAL UNITS: 42
LEVEL THREE AREA: 2,180 SF.		
TOTAL BUILDING AREA: 6,540 SF.		
TOTAL BUILDING AREA: 45,780 SF. (7 BLDGS)		

Order Plans @