



NEW CORPORATE HANGAR
AIRPORT ROAD
PORT, NC 28461



ARCHITECT
W
THE WILSON GROUP
P.O. BOX 5515
CHARLOTTE, NC 28226
(704) 371-6747

PROJECT MANAGER / CIVIL ENGINEER
TALBERT & BRIGHT

4811 BELLEVIEW DRIVE
WILSONVILLE, NC 28045
(919) 703-5350

STRUCTURAL ENGINEER
STEWART
101 N. TRYON ST., SUITE 1400
CHARLOTTE, NC 28202
(704) 969-3623

MECHANICAL, ELECTRICAL, PLUMBING &
FINE PROTECTION ENGINEER
SABER ENGINEERING
2923 S. TRYON ST., SUITE 200
CHARLOTTE, NC 28253
(704) 373-0068

WATER & SEWER ENGINEER
MCGILL ASSOCIATES
712 VILLAGE ROAD SW, SUITE 103
SHALLOTTE, NC 28410
(919) 756-5872

REVISIONS

DATE: AUGUST 2019
PROJECT NUMBER: 2102-1801

SHEET TITLE
SITE LAYOUT PLAN

SHEET NUMBER
C3.01

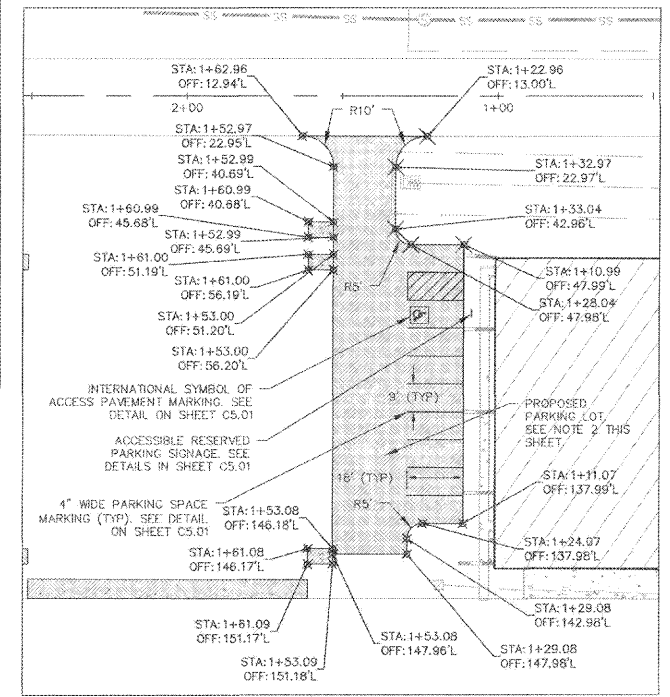
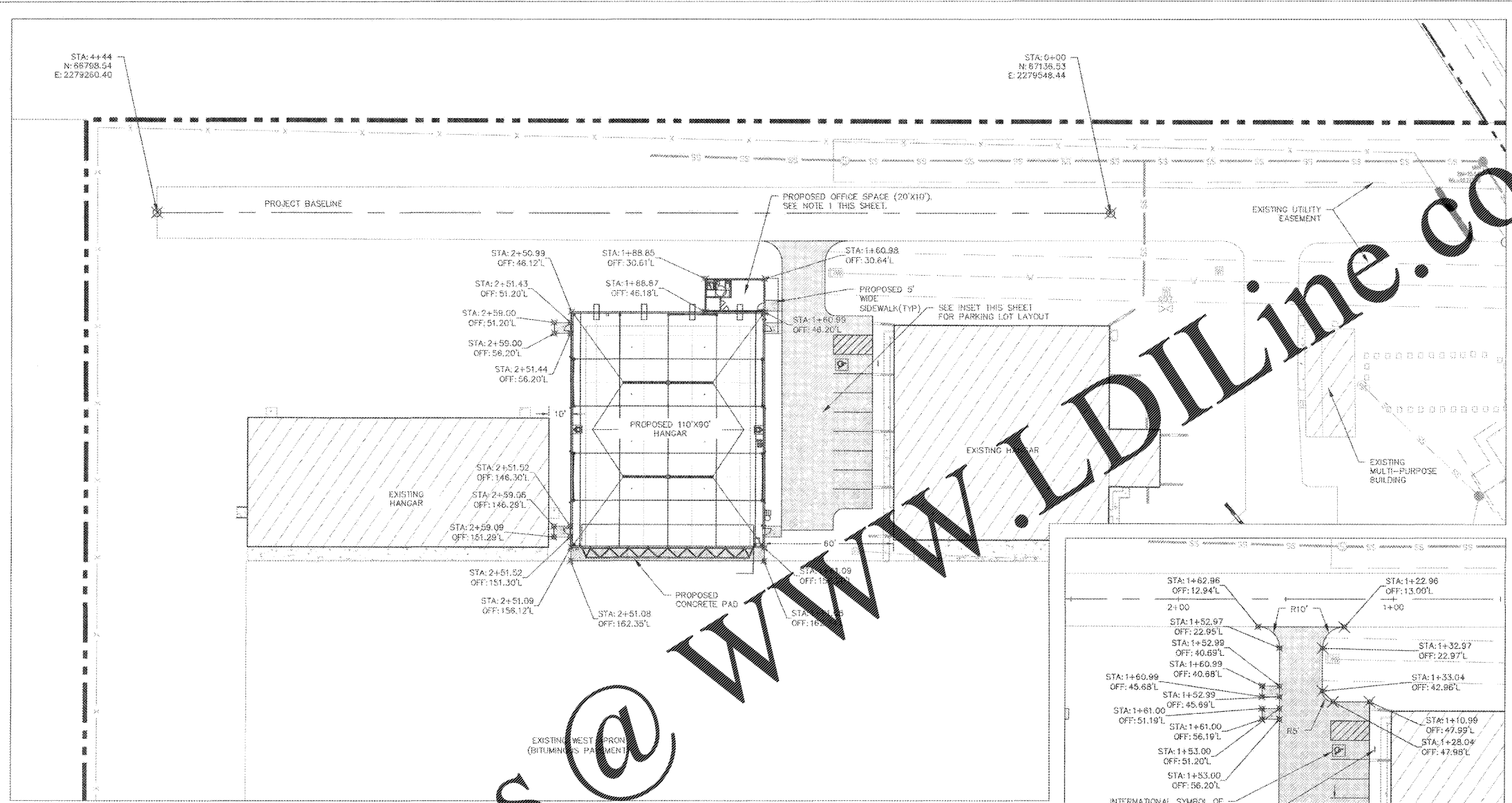

- GENERAL NOTES:**
1. THE PROPOSED 20'X10' OFFICE SPACE SHALL BE BID AS AN ADD-ALTERNATE ITEM.
 2. SURFACE AND BASE COURSE MATERIAL FOR PARKING LOT SHALL BE BID AS AN ADD-ALTERNATE ITEM. SEE SECTION-95.
 3. FOR THE WATER & SEWER UTILITY PLAN SEE SHEET WS-301.

LEGEND

	PROPOSED CONCRETE PAVEMENT
	PROPOSED BITUMINOUS PAVEMENT
	EXISTING WATER METER
	EXISTING UNDERGROUND ELECTRIC
	EXISTING AIRPORT BUILDING
	EXISTING AUTOMATIC FLUSHING DEVICE
	EXISTING FENCE
	EXISTING AIRPORT PROPERTY LINE
	EXISTING PIPE
	EXISTING SANITARY SEWER
	EXISTING SANITARY SEWER MANHOLE
	EXISTING REDUCED PRESSURE ZONE

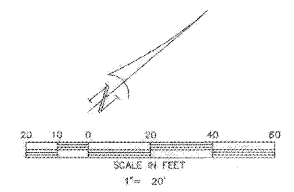

Order Plans @ www.LDILine.com