

01 ENLARGED FIRE HOUSE POWER PLAN
E-4 1" = 30'-0"

02 ENLARGED HANGER #2 POWER PLAN
E-4 1" = 30'-0"

03 ENLARGED HANGER #1 POWER PLAN
E-4 1" = 30'-0"

SYMBOL LEGEND

SYMBOL	DESCRIPTION	REMARKS
T	PAD MOUNTED EXISTING SERVICE TRANSFORMER	SEE SPECIFICATIONS
G	208/120 VAC STANDBY N.G. GENERATOR	SEE SPECIFICATIONS
ATS	SERVICE ENTRANCE, 4-POLE OPEN ATS	SEE SPECIFICATIONS
LB	LOAD BANK	SEE SPECIFICATIONS
□	EXISTING PANEL	SEE SPECIFICATIONS

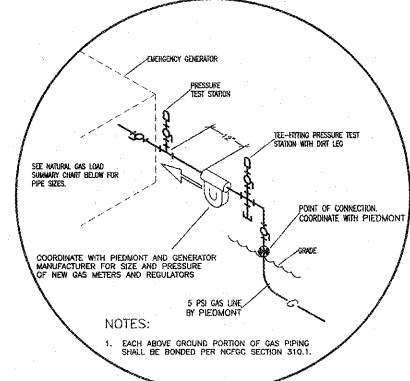

04 GENERATORS GAS CONNECTION
E-4 1/8" = 1'-0"

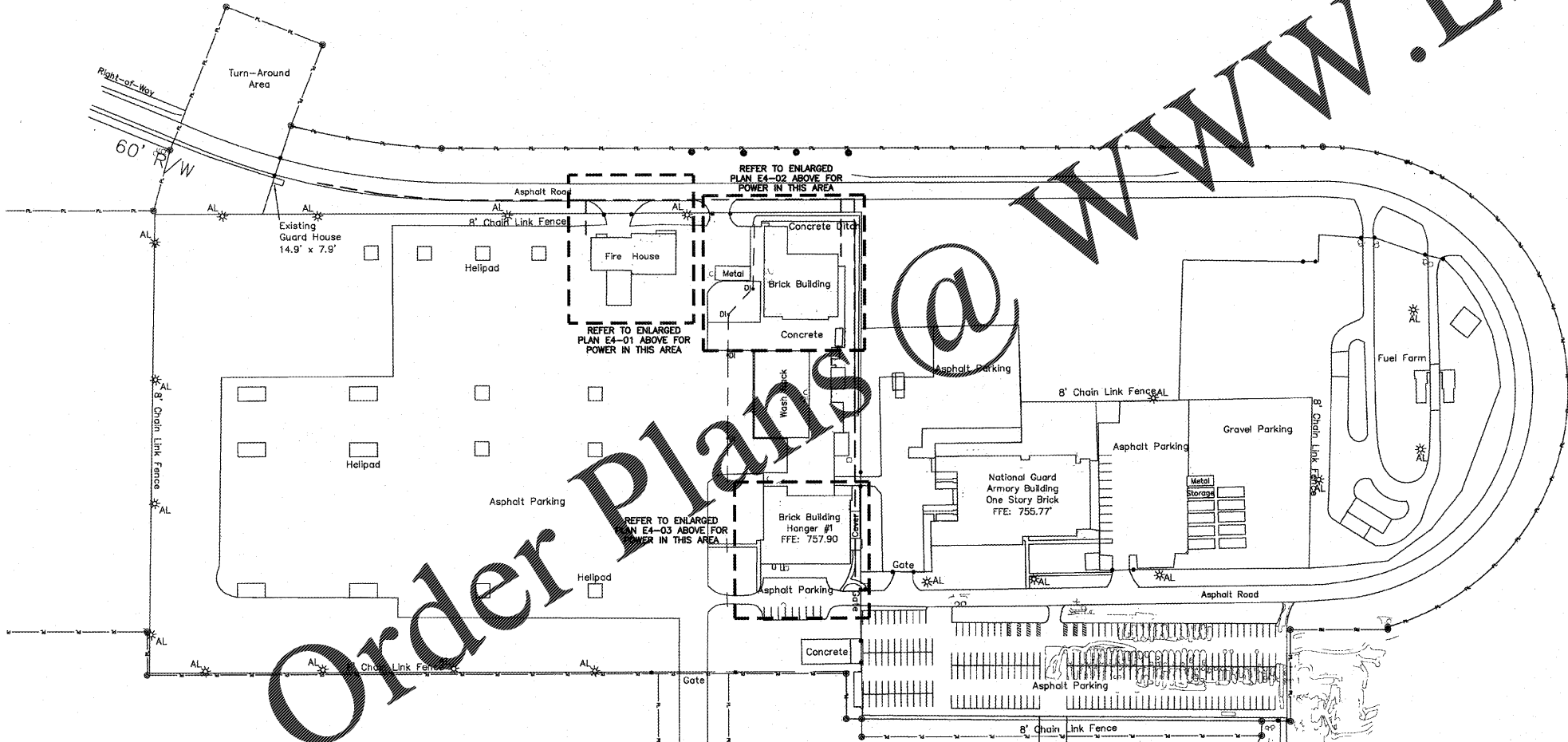

05 OVERALL SITE PLAN
E-4 1" = 100'-0"

- GENERAL NOTE:** REFER TO RISER DIAGRAM FOR ADDITIONAL INFORMATION
- NOTES:** (AS INDICATED ON THIS PLAN BY A NUMBER IN A CIRCLE)
- PROVIDE NEW GENERATOR ON CONCRETE BASE IN ACCORDANCE WITH MANUFACTURER'S PUBLISHED RECOMMENDATIONS. REFER TO RISER DIAGRAM FOR ADDITIONAL INFORMATION. ANCHOR AS NECESSARY FOR SEISMIC RESTRAINT. COORDINATE FUEL PIPING INSTALLATION WITH OTHER TRADES.
 - PROVIDE A NEW AUTOMATIC TRANSFER SWITCH (REFER TO RISER DIAGRAM FOR ADDITIONAL INFORMATION). LOCATION SHOWN IS APPROXIMATE. COORDINATE WITH OWNER'S REPRESENTATIVE AND EXISTING UNDERGROUND UTILITIES. REFER TO RISER DIAGRAM FOR ADDITIONAL INFORMATION.
 - PROVIDE A NEW DUCT BANK. LOCATION SHOWN IS APPROXIMATE. COORDINATE WITH OWNER'S REPRESENTATIVE AND EXISTING UNDERGROUND UTILITIES. REFER TO RISER DIAGRAM FOR ADDITIONAL INFORMATION.
 - EXISTING UTILITY TRANSFORMER. LOCATION SHOWN IS APPROXIMATE. FIELD VERIFY PRIOR TO PURCHASING MATERIAL. COORDINATE ACCESS AND DEENERGIZATION WITH UTILITY COMPANY.
 - EXISTING DUCT BANK. LOCATION SHOWN IS APPROXIMATE. VERIFY IN FIELD. INTERCEPT AND PREPARE FOR CONNECTION TO THE NEW DUCT BANK. REMOVE UNUSED PORTION COMPLETELY. BACKFILL TRENCH AS NECESSARY, COMPACTING IN LAYERS AND RESTORE GRADE TO ORIGINAL CONDITION.
 - PROVIDE NEW DUCT BANK FROM AUTOMATIC TRANSFER SWITCH TO MDP. ROUTE TO AVOID EXISTING UNDERGROUND UTILITIES. REFER TO RISER DIAGRAM FOR ADDITIONAL INFORMATION.
 - ALL SERVICE EQUIPMENT SHALL BE S.E. RATED.
 - PROVIDE MATERIALS AND MAKE CONNECTION TO UNDERGROUND GAS PIPING INSTALLED BY OTHERS. PROVIDE UNION, SHUTOFF VALVE, DIRT LED AND PRESSURE REGULATOR TO DROP 5 PSI GAS TO 7" WATER COLUMN PRESSURE (7" - 11" W.C.). PROVIDE SUPPORTS AND MAKE FINAL CONNECTION TO GENERATOR AS REQUIRED. CONSULT GENERATOR MANUFACTURER'S REQUIREMENTS PRIOR TO START OF WORK.
 - CONNECT SERVICE GROUND TO METER, WATER PIPE, BLDG. STEEL, GROUND RODS AND SERVICE NEUTRAL CONDUCTOR PER NEC 250.
 - PROVIDE PAINTED CODE-SIZED NEMA 3R JUNCTION BOX ON EXTERIOR OF BUILDING. PROVIDE 1" GRCS FROM JUNCTION BOX TO NEW DUCT BANK. FASTEN CONDUIT TO EXTERIOR OF BUILDING WITH 1-HOLE STRAPS AND ANCHORS SUITABLE FOR WALL CONSTRUCTION. SUPPORT JUNCTION BOX AS RECOMMENDED BY THE MANUFACTURER.
 - (BASE BID) DISCONNECT EXISTING FEEDER, CONNECT NEW. TEST EXISTING PANEL FOR ELECTRICAL INTEGRITY. RETORQUE ALL CONNECTIONS TO MANUFACTURER'S SPECIFIED LEVELS. REPLACE ANY DEFECTIVE COMPONENTS AS NECESSARY. DISCONNECT SERVICE ENTRANCE GROUND. (ADD ALTERNATE) PROVIDE NEW MAIN DISTRIBUTION PANEL IN EXISTING PANEL LOCATION. PANEL KVAIC TO BE SUFFICIENT TO WITHSTAND THE FAULT CURRENT LEVEL AVAILABLE FROM THE UTILITY TRANSFORMER.
 - CONTRACTOR SHALL COORDINATE WITH OWNER & PIEDMONT FOR LOCATION OF NEW GAS METERS AND REGULATORS.
 - CONTRACTOR SHALL CUT AND PATCH EXISTING PAVEMENT TO MATCH.
 - CONTRACTOR SHALL GRADE & SEED.

NATURAL GAS LOAD SUMMARY

ITEM	MBH	PIPE SIZE
FIRE STATION BUILDING GENERATOR	730	1 1/2"
HANGER #1 BUILDING GENERATOR	1965	3"
HANGER #2 BUILDING GENERATOR	1511	2 1/2"
FUTURE HVAC	3600	
TOTAL FUTURE LOAD @ 5 PSI	7806	



Progressive Design Collaborative, Ltd.

3101 Poplarwood Court, Suite 300
Raleigh, North Carolina 27604
919-790-9989

License# C-9183
pdc@pdcengineers.com



08/27/19
MRIAHP@PDCENGINEERS.COM

DRAWN BY: CDG CHECKED BY: MRR

PDC 19039 08/27/2019

REVISIONS

NUMBER	DATE	DESCRIPTION

BID SET

**DEPARTMENT OF PUBLIC SAFETY
NATIONAL GUARD - SALISBURY AASF2
ENERGY SECURITY GENERATOR INSTALLATION
SCO# 18-19692-01A**

NORTH CAROLINA NATIONAL GUARD
1235 NATIONAL GUARD RD, SALISBURY, NC 28147

ELECTRICAL ENLARGED,
OVERALL SITE PLAN,
ENLARGED SITE PLANS

E-4