

DEMOLITION NOTES	
GENERAL NOTES	
<ol style="list-style-type: none"> ALL SALVAGEABLE EQUIPMENT AND MATERIALS SUBJECT TO DEMOLITION SHALL BE OFFERED TO THE OWNER. ALL SALVAGEABLE EQUIPMENT AND MATERIALS DECLINED BY THE OWNER SHALL BE PROPERLY DISPOSED OF BY THE ELECTRICAL CONTRACTOR. ALL UNSALVAGEABLE DEMOLISHED EQUIPMENT AND MATERIALS SHALL BE PROPERLY DISPOSED OF BY THE ELECTRICAL CONTRACTOR. DISCONNECTION OF ALL ELECTRICAL MOTORS SHALL BE BY THE ELECTRICAL CONTRACTOR. ELECTRICAL CONTRACTOR SHALL TAKE STEPS TO PROTECT EXISTING FINISHES FROM DAMAGE AND SHALL BE RESPONSIBLE FOR DAMAGE REPAIR. ELECTRICAL CONTRACTOR SHALL VERIFY ALL CIRCUITS PRIOR TO BEGINNING DEMOLITION. DURING CONSTRUCTION PHASE E.C. IS RESPONSIBLE FOR MAINTAINING UNINTERRUPTED POWER AND COMMUNICATIONS CONNECTIONS TO UNDEMOLISHED ELECTRICAL DEVICES. E.C. SHALL REROUTE WIRING AND CABLING AS REQUIRED. ELECTRICAL CONTRACTOR SHALL DEMOLISH ALL ABANDONED WIRING AND ALL SURFACE MOUNTED ABANDONED CONDUIT. ABANDONED HOMERUNS SHALL BE DEMOLISHED TO PANEL AND BREAKERS SPARED. ELECTRICAL CONTRACTOR SHALL DEMOLISH ABANDONED SURFACE MOUNTED JUNCTION BOXES. ABANDONED JUNCTION BOXES RECESSED IN EXISTING WALLS SHALL REMAIN - PROVIDE BLANK STAINLESS STEEL COVER PLATES FOR UNUSED JUNCTION BOXES. ABANDONED CONDUITS THAT CANNOT BE PHYSICALLY REMOVED (AND NOT ASSOCIATED WITH JUNCTION BOXES IN NOTE B) SHALL BE CUT OFF FLUSH AND FILLED WITH GROUT. COORDINATE WITH THE ARCHITECTURAL DRAWINGS FOR EXTENT OF DEMOLITION. IT IS THE INTENT OF THIS DRAWING TO ILLUSTRATE EQUIPMENT AND MATERIALS TO BE REMOVED UNDER THIS CONTRACT. SHOULD ANY ITEM BE INADVERTENTLY OMITTED IT IS THE RESPONSIBILITY OF THE ELECTRICAL CONTRACTOR TO REMOVE THIS ITEM(S) AT NO ADDITIONAL COST TO THE OWNER. 	
SYMBOL	NOTES
---	WALLS AND OTHER STRUCTURAL ELEMENTS THAT ARE TO BE DEMOLISHED ARE SHOWN WITH HEAVY DASHED LINE. E.C. IS RESPONSIBLE FOR REMOVING ALL RECEPTACLES, SWITCHES, AND OTHER ELECTRICAL DEVICES FROM WALLS THAT ARE TO BE DEMOLISHED. E.C. SHALL REROUTE EXISTING WIRING IN DEMOLISHED WALLS AS REQUIRED TO MAINTAIN POWER AND COMMUNICATIONS CONNECTIONS TO ALL UNDEMOLISHED ELECTRICAL DEVICES.
○ □	SCOPE OF DEMOLITION - LIGHTING DEMOLISH ALL EXISTING LIGHT FIXTURES AND CONTROLLING SWITCHES.
⊕ GF, WP	ALL EXISTING RECEPTACLES WILL BE DEMOLISHED UNLESS NOTED OTHERWISE.
⊗	REFERENCE THE FOLLOWING DEMOLITION NOTES ON PLAN: A. TELEPHONE BOX - E.C. SHALL COORDINATE WITH OWNER TO DETERMINE REQUIRED DEMOLITION OF TELEPHONE BOXES. E.C. SHALL DETERMINE IF TELEPHONE SERVICE ENTRANCE IS PROPERLY GROUNDED AND CORRECT ANY GROUNDING ERRORS. B. DEMOLISH EXISTING RECEPTACLE AND WIRE. PRESERVE CONDUIT IN BOXES FOR INSTALLATION OF NEW RECEPTACLES.

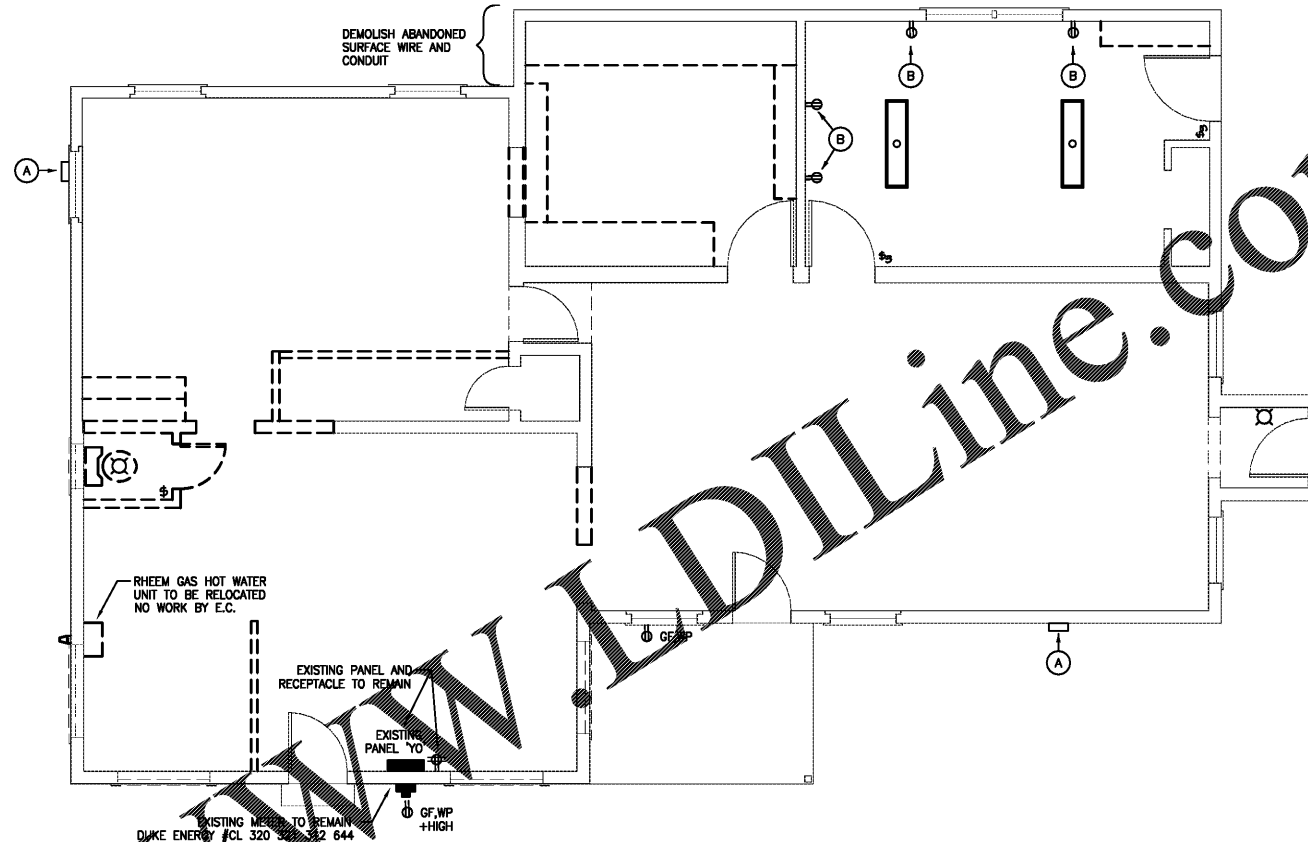

WWW.LDILine.com

1 YARD OFFICE- ELECTRICAL DEMOLITION PLAN
 ED.1
 SCALE: 1/4" = 1'-0"
 SCALE: 1/4" = 1'
 0 2 4 8 12 16

Order Plans @

**YARD OFFICE
ELECTRICAL
DEMOLITION
PLAN**

2106 East Holly Grove Road
P.O. Box 1256
Lexington, N.C. 27283
Design Engineering, Inc. 336/224-0100
336/224-0099 (fax)

**HISTORIC
SPENCER
SHOPS
YARD OFFICE**

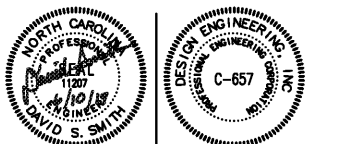

MCE DRAWN BY DSS CHECKED BY APRIL, 2014 DATE	SHEET NO. ED.1 OF 4
---	----------------------------------