

**NORTH CAROLINA TRANSPORTATION MUSEUM
HISTORIC SPENCER SHOPS**

NORTH CAROLINA TRANSPORTATION HISTORY CORPORATION

Site Plan
SCALE: 1"=100'

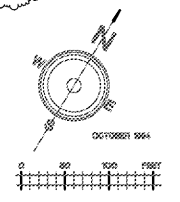

**2018 APPENDIX B
BUILDING CODE SUMMARY FOR ALL COMMERCIAL PROJECTS
(EXCEPT 1 AND 2-FAMILY DWELLINGS AND TOWNHOUSES)**
(Reproduce the following data on the building plans sheet 1 or 2.)

Name of Project: NC Transportation Museum - Historic Spencer Shops - Yard Office
Address: 411 S. Salisbury Avenue, Spencer, North Carolina Zip Code: 28159
Owner/Authorized Agent: Kelly Alexander Phone: (704) 638-2889 E-Mail: kelly.alexander@rbsarch.com
Owned By: City/County Private State
Code Enforcement Jurisdiction: City County State

CONTACT: Bill Burgin (RBSA)
DESIGNER: FIRM: Ramsay Burgin Smith Architects NAME: William R. Burgin, AIA LICENSE # 3513 TELEPHONE # (704) 658-9121 E-MAIL: wburgin@rbsarch.com
City: Electrical: Design Engineering David S. Smith, PE 11207 (336) 224-9100 ds@smithsdesign.com
Plumbing: Collins Engineering Samuel E. Collins, PE 31024 (704) 638-6337 saec@collinseng.com
Mechanical: Collins Engineering Samuel E. Collins, PE
Sprinkler-Standpipe: Structural: Retaining Walls >5' High: Other:

2018 NC BUILDING CODE: New Building Addition 1* Time Interior Completions
 Shell/Core* Phased Construction*

2018 NC EXISTING BUILDING CODE: Prescriptive Alteration Level I Historic Property
 Repair Alteration Level II Change of Use
 Chapter 14 Alteration Level III

CONSTRUCTED: (date) Early 1900s CURRENT OCCUPANCY(S) (Cb. 3): BUSINESS
RENOVATED: (date) PROPOSED OCCUPANCY(S) (Cb. 3): No Change
OCCUPANCY CATEGORY (Table 1604.5): Current: II Proposed: No Change

BASIC BUILDING DATA
Construction Type: I-A I-B II-A II-B III-A III-B IV V-A V-B
Sprinklers: No Partial NFPA 13 NFPA 13R NFPA 13D
Standpipes: No Class I II III Wet Dry
Primary Fire District: No Yes Flood Hazard Area: No Yes
Special Inspections Required: Yes No If special inspections are required, contact the local inspection jurisdiction for additional procedures and requirements.

Gross Building Area Table			
FLOOR	EXISTING (SQ. FT.)	NEW (SQ. FT.)	SUB-TOTAL
3 rd Floor			
2 nd Floor			
Mezzanine			
1 st Floor	1571 (Yard Office)		
Basement			
TOTAL	1571		

*ABBREVIATED CODE SUMMARY - EXISTING CONSTRUCTION WITH NO CHANGE IN AREA OR USE

DRAWING INDEX

- ARCHITECTURAL**
A1.1 SITE PLAN/LIFE SAFETY
A1.2 YARD OFFICE PLANS
A1.3 ENLARGED TOILET PLANS
- PLUMBING**
P1.1 PLUMBING PLAN - YARD OFFICE
P2.1 PLUMBING DETAILS
- MECHANICAL**
M1.1 MECHANICAL PLAN - YARD OFFICE
M2.1 MECHANICAL DETAILS
M3.1 MECHANICAL SCHEDULES
M4.1 MECHANICAL SPECIFICATIONS
- ELECTRICAL**
E1.1 ELECTRICAL DEMOLITION PLAN - YARD OFFICE
E2.1 ELECTRICAL SCHEDULES
E3.1 ELECTRICAL PLANS - YARD OFFICE
E4.1 ELECTRICAL RISERS

REVISION #1 5/29/2019

**HISTORIC
SPENCER
SHOPS
YARD OFFICE**

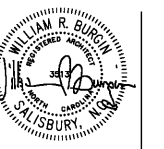

PLC
DRAWN BY
MRB
CHECKED BY
APRIL 2019
DATE
9/2/21
CONS. NO.

SHEET NO.
A1.1
OF 3

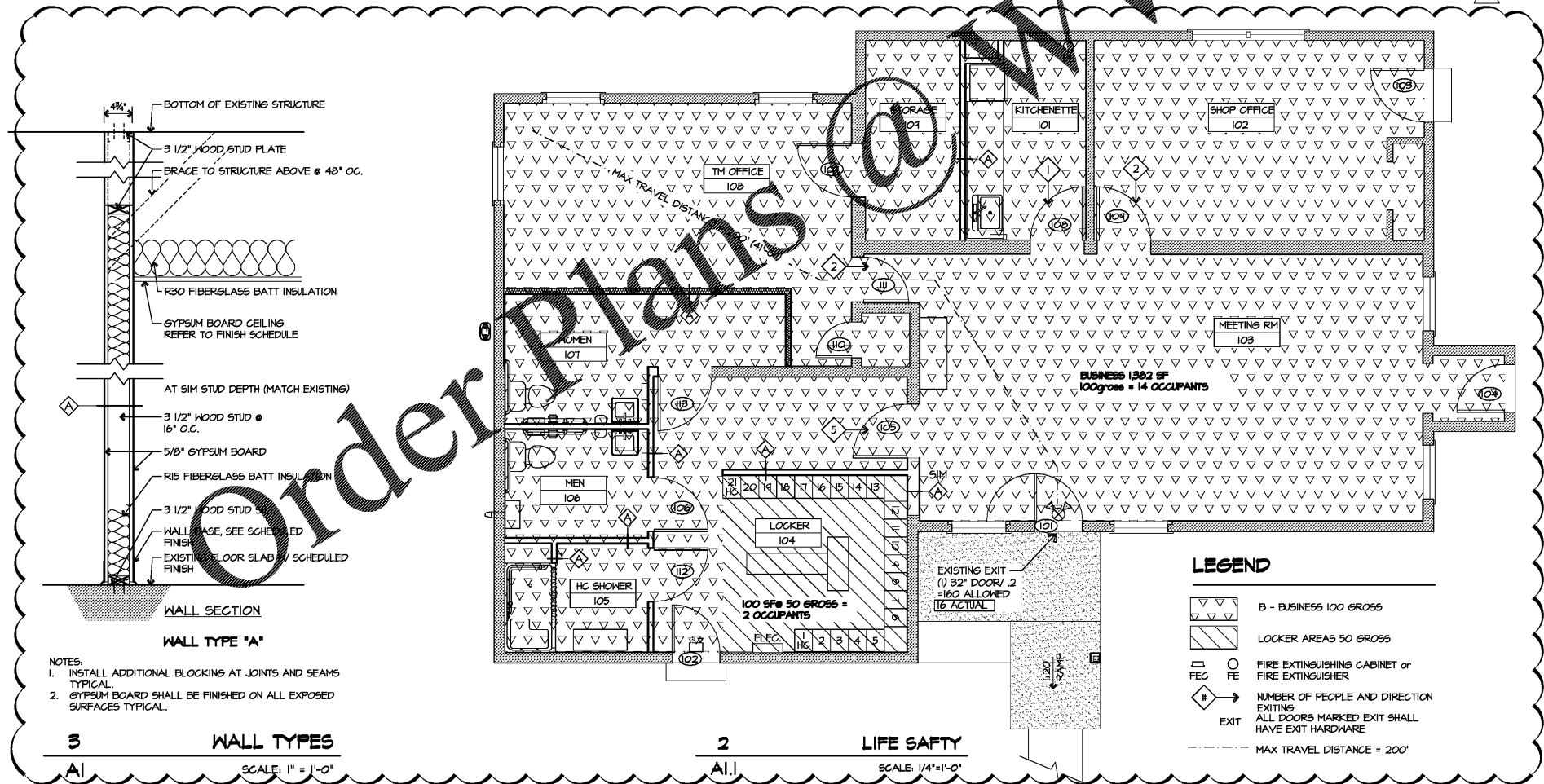

3 WALL TYPES
SCALE: 1"=1'-0"

2 LIFE SAFETY
SCALE: 1/4"=1'-0"