

KEYNOTES

- 1. 1/2" CW 4 1/2" HW VALVED 4 TO MANIFOLD SYSTEM MFS-1, MOUNTED ABOVE CEILING ON CORRIDOR WALL.
- 2. 1/2" CW 4 1/2" HW RISER
- 3. 1/2" HW R UP
- 4. 1/2" CW DN, PROVIDE BACKFLOW PREVENTER BFP-2 AT FINAL CONNECTION.
- 5. 4" ST 4 1/2" EST STACKS
- 6. 1/2" CW 4 1/2" HW UP FROM BELOW
- 7. 2" V DN
- 8. 1" CONDENSATE RISER, CONNECT CONDENSATE FROM MFCU OVER DOOR
- 9. 3" ST 4 1/2" EST STACKS
- 10. NATURAL GAS UP

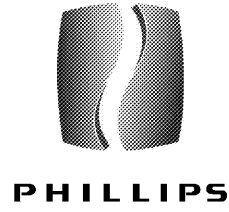
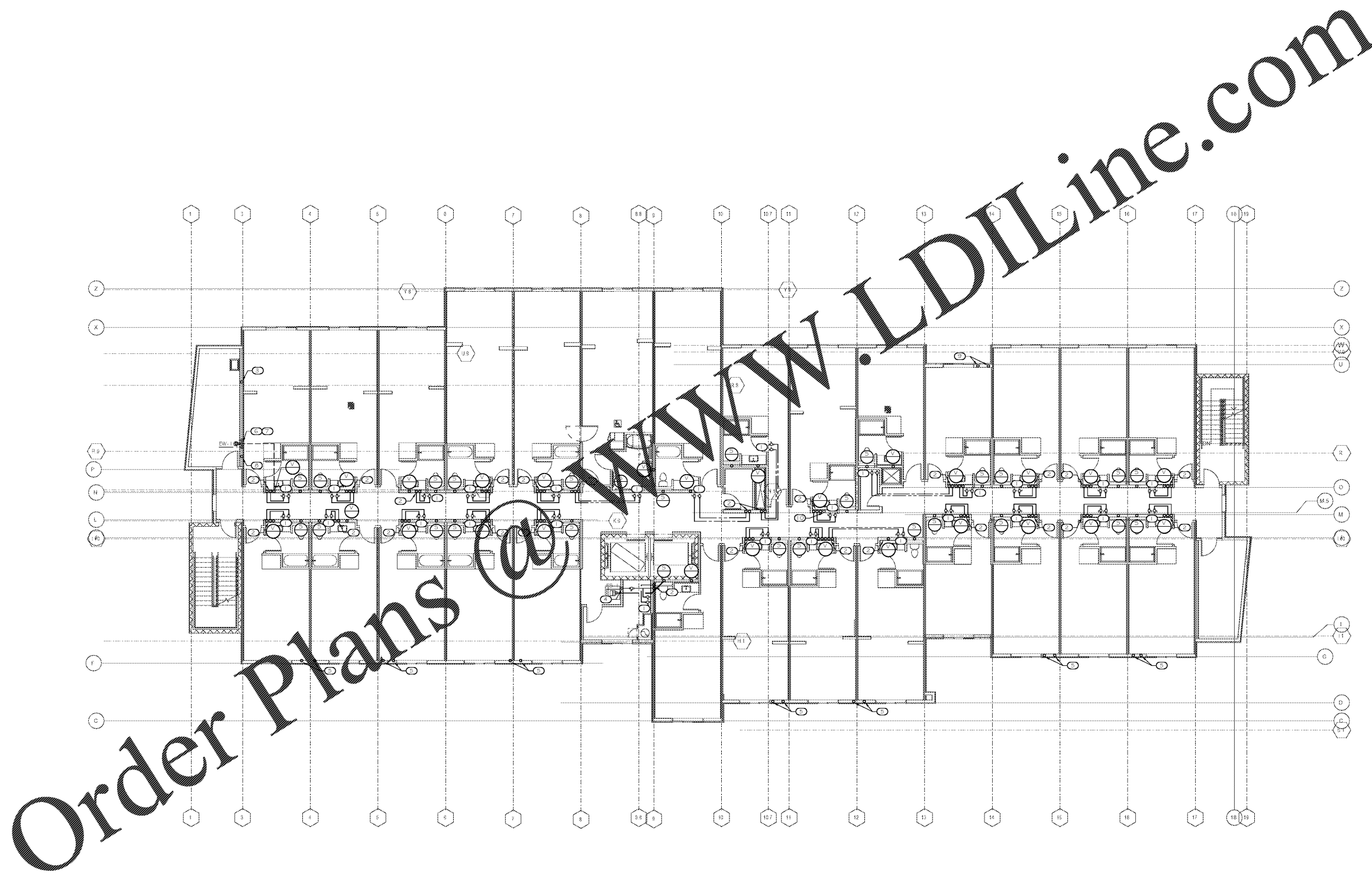

KEYPLAN

CONSULTANT

PROFICIENT ENGINEERING
 6591 Peachtree Industrial Blvd Building 700
 Peachtree Corners, Georgia 30092
 404.333.9759
 PROJECT # 110288



ISSUE & REVISION RECORD

#	DATE	DESCRIPTION
	06.10.2019	30% DESIGN REVIEW SET
	08.15.2019	90% REVIEW SET
	08.23.2019	PERMIT SET

This document is © Phillips Partnership, PC and is considered an Instrument of Service and is solely for use with respect to the project as indicated herein. All rights reserved. This document may not be reproduced without the prior written consent of Phillips Partnership, PC.

PROJECT

Fairfield BY MARRIOTT INN & SUITES

DAWSONVILLE, GEORGIA

PROTOTYPE VERSION 2016
REV 7.12.21.16

4 STORY, 92 UNITS
w/ INDOOR POOL

FAIRFIELD DAWSON FOREST ROAD DAWSONVILLE, GA 30534

CLIENT

RIMROCK COMPANIES
 10000 RIVERSIDE AVE
 SUITE 32201
 JACKSONVILLE, FL 32204

PHILLIPS JOB NUMBER 1972101

ISSUE DATE 08/23/2019

DRAWN BY/CHECKED BY SA MR

DRAWING TITLE

FLOOR PLAN LEVEL 3

SHEET NUMBER

P-1.3

5901 PEACHTREE DUNWOODY RD.
 BUILDING A, SUITE 450
 ATLANTA, GEORGIA 30328
 PHILLIPS PART. COM 770-394-1616